

Periodic Gabor Functions with Biorthogonal Exchange: A Highly Accurate and Efficient Method for Signal Compression

Asaf Shimshovitz and David J. Tannor

Department of Chemical Physics, Weizmann Institute of Science, Rehovot, 76100 Israel

(Dated: September 23, 2021)

We propose a new formalism for signal compression based on the Gabor basis set. By convolving the conventional Gabor functions with Dirichlet functions we obtain a periodic version of the Gabor basis set (pg). The pg basis is exact for functions that are band-limited with finite support, bypassing the Balian-Low theorem. The calculation of the pg coefficients is trivial and numerically stable, but the representation does not allow compression. However, by exchanging the pg basis with its biorthogonal basis and using the localized pg basis to calculate the coefficients, large compression factors are achieved. We illustrate the method on three examples: a rectangular pulse, an audio signal and a benchmark example from image processing.

PACS numbers:

I. INTRODUCTION

In 1946, Gabor suggested using a lattice of Gaussians in time-frequency space for signal representation [1]. (Essentially the same lattice was introduced by von Neumann in quantum mechanics in 1931 [2]). The Gabor functions are constructed by shifting a synthesis function in time and frequency such that each basis function $g_{n,m}(t)$ has the form:

$$g_{n,m}(t) = g(t - na) \exp(jmbt) \quad (1)$$

for $n, m \in Z$ where a and b represent time and frequency sampling intervals. By choosing the synthesis function $g(t)$ to be concentrated in both time and frequency (e.g. a Gaussian as in Gabor's original proposal), each one of the Gabor functions is localized in a different region of the time-frequency plane. Gabor's original motivation was to use these localized $g_{n,m}(t)$ functions as a basis set for the expansion of a signal $s(t)$:

$$s(t) = \sum_{n,m} c_{n,m} g_{n,m}(t). \quad (2)$$

For an arbitrary signal, Eq.2 has a solution only if $ab \leq 2\pi$; for the case $ab = 2\pi$, called critical sampling, the solution is unique. This expansion is potentially very efficient for signals that contain different frequency components at different time intervals. Due to the localization of the basis set, one expects that only the basis functions in the active time-frequency regions are required for the expansion and therefore the representation of $s(t)$ should be very efficient.

The Gabor basis set has been widely adopted in signal analysis, where it is known as the Short Time Fourier Transform, but it is rarely used for signal compression and reconstruction. In fact, it is generally regarded as unstable for critical sampling [3]. The reason for the disparity between the concept and the practice can be traced to the non-orthogonality of the basis set. Balian and Low proved that the $g_{n,m}(t)$ cannot be made orthonor-

mal without sacrificing the locality of $g(t)$ in either time or frequency [4, 5]. In addition, the non-orthogonality of the basis makes the calculation of the Gabor coefficients $c_{n,m}$ non trivial. In this regard, a major advance was made by Bastiaans [6] who showed that the coefficients can be represented as the inner product between the signal $s(t)$ and a basis set $\gamma_{n,m}(t)$ that is bi-orthogonal to $g_{n,m}(t)$. However, in most cases Bastiaans's approach just transforms the non-trivial problem of finding $c_{n,m}$ to the non-trivial problem of finding $\gamma_{n,m}(t)$. For the few special cases where $\gamma_{n,m}(t)$ can be calculated analytically, the Gabor coefficients are found to be delocalized.

About ten years after Bastiaans's work, Wexler and Raz developed a discrete version of the Gabor expansion (henceforth 'DGE') that overcomes many of the earlier difficulties [7]. The DGE applies to sequences $s[k]$ with period N_l . In this formalism, the Gabor functions in Eq.1 turn into the discrete sequences

$$\tilde{g}_{n,m}[k] = \tilde{g}[k - na] \exp\left(\frac{2\pi j}{N_l} mbk\right) \quad (3)$$

for $n = 0, \dots, N - 1$, $m = 1, \dots, M - 1$, where a and b are the time and frequency sampling intervals respectively and obey the relation: $Na = Mb = N_l$. The synthesis sequence is now a periodic extension of some window sequence $\tilde{g}[k] = \sum_l g[k + lN_l] = \tilde{g}[k + N_l]$. Analogous to Eq.2, the expansion of $s[k]$ is given by:

$$s[k] = \sum_{n=0}^{N-1} \sum_{m=0}^{M-1} c_{n,m} \tilde{g}_{n,m}[k]. \quad (4)$$

The coefficients $c_{n,m}$ exist for $MN \geq N_l$ and can be found by taking inner products between $s[k]$ and a biorthogonal basis set $\tilde{\gamma}_{n,m}[k]$. For critical sampling $NM = N_l$ the coefficients $c_{n,m}$ and $\tilde{\gamma}_{n,m}[k]$ are unique and in contrast to the continuous-time case, can be obtained simply by solving a set of linear equations. Nevertheless, some of the drawbacks of the Gabor basis persist in this formalism. To understand why, recall that the Gabor representation is expected to be efficient because

of the time-frequency localization of the Gabor basis, $\tilde{g}_{n,m}[k]$. But this expectation is based on the assumption that only the Gabor functions in the active time-frequency window are required for the expansion Eq.(4). It turns out that this key assumption is incorrect: the non-orthogonality of the basis leads to the counterintuitive phenomenon that even Gabor functions localized where the signal s vanishes are required for the expansion in Eq.4. This delocalization of the Gabor coefficients has been overlooked in many studies [15–17]; in other cases, the phenomenon was addressed by oversampling i.e. $MN > N_l$ [7–9]. When the oversampling is increased sufficiently, the bi-orthogonal set $\tilde{\gamma}_{n,m}[k]$ become similar to the Gabor set $\tilde{g}_{n,m}[k]$ and the coefficients become more localized. However, oversampling is inefficient in the sense that a time-frequency region that was previously overlapped by one Gabor function in is now overlapped by many, and all of them need to be taken into account in the expansion in Eq.4.

As a result of these difficulties, a different approach for localized time-frequency expansion was developed called the “wavelet” expansion [3], in which the time-frequency localization is achieved by scaling the synthesis function in addition to shifting. The great advantage of this approach is that it allows one to construct a localized basis set that is orthogonal, and therefore bypass the problems of the Gabor expansion.

In this work, we return to the original Gabor formulation and introduce two modifications that make the representation both stable and highly efficient. The method can also be combined with wavelet or pyramidal scaling, although this will be addressed in a separate publication. The first modification is that that Gabor functions are ‘convolved’ with a Dirichlet kernel (a periodic sinc function), giving a periodic, Gabor-like basis that is guaranteed to be stable since it spans exactly the time-frequency space to which Nyquist’s theorem applies. (In the final expressions, all that appears are the original Gabor functions at the sample points.) Second, the non-locality of the coefficients is overcome by exchanging the role of the Gabor basis and its bi-orthogonal basis set. Specifically, the localized periodic-Gabor functions are used to calculate the coefficients rather than as the basis. We call the combination of the two innovations the “periodic Gabor method with biorthogonal exchange”, or pgb. In [10, 11] we applied the pgb to quantum mechanics with great success [22]; here we show here that the method can provide large savings for signal compression as well.

II. THE PERIODIC GABOR BASIS

The original proposal by Gabor was to use Gaussian functions on a time-frequency grid with critical sampling [1, 2]. Under these conditions Eq.1 turns into:

$$g_{n,m}(t) = \left(\frac{2\alpha}{\pi}\right)^{\frac{1}{4}} \exp(-\alpha(t-t_n)^2 + j\omega_m(t-t_n)) \quad (5)$$

where n and m are integers. Each basis function is a Gaussian centered at $(t_n, \omega_m) = (na + t_0, \frac{2\pi m}{a} + \omega_0)$ in time-frequency space, where t_0 and ω_0 are arbitrary shifts. The parameter $\alpha = \frac{\sigma_\omega}{2\sigma_t}$ controls the FWHM of each Gaussian in t and ω space. Taking $\Delta t = a$ and $\Delta\omega = 2\pi/a$ as the spacing between neighboring Gaussians in t and ω space respectively, we note that $\Delta t \Delta\omega = 2\pi$ so we have exactly one basis function per unit cell in phase space, so-called critical sampling. Assuming that the grid extends over the infinite time-frequency grid, the Gabor basis is complete as shown in [12].

However, in any numerical calculation, n and m take on only a finite number of values. Consider a basis consisting of N Gaussian functions $\{g_i(t)\}$, $i = 1 \dots N$, one per unit cell. Since the size of one Gabor unit cell is 2π , the phase space area covered by the truncated Gabor lattice is:

$$S^{\text{Gabor}} = 2\pi N. \quad (6)$$

However, it turns out that there is a difference between

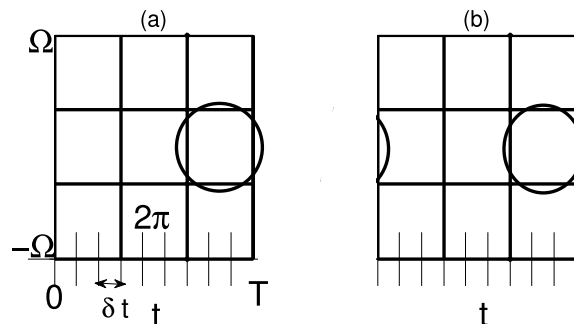

FIG. 1: (a) $N = 9$ coordinate grid points and $N = 9$ Gabor unit cells cover the same area in phase space, $S = 2\pi N$. Shown also is a typical Gabor function. Note that its boundary conditions are not appropriate for the rectangular area. (b) The periodic Gabor (pg) basis is a complete set for the truncated space. The pg basis functions are loosely speaking, periodic Gaussians whose centers are located at the center of each unit cell.

the truncated Gabor lattice and the truncated Gabor *basis*: The latter is not complete for the Hilbert space defined by the rectangular area $S^{\text{Gabor}} = 2\pi N$ because the boundary conditions are not appropriate.

In order to develop a truncated Gabor-like basis set that is complete on the rectangular area in Eq.6 (Fig.1) we introduce a variant on the Gabor basis set with periodic boundary conditions. Consider $x(t)$ to be a periodic signal with period T and band limited in Ω . By sampling

$x(t)$ at the Nyquist rate $\delta t = \frac{\pi}{\Omega}$ at $N = \frac{T}{\delta t}$ sampling points $\{t_i\}$, $x(t)$ can be expressed in terms of its samples by:

$$x(t) = \sum_{i=1}^N x(t_i)D(t - t_i) \quad (7)$$

where $D(t)$ are the Dirichlet or periodic sinc functions[13]:

$$\begin{aligned} D(t) &= \frac{\sin(N\Omega t/2)}{N \sin(\Omega t/2)} \\ &= \frac{1}{N} \sum_{m=-(N-1)/2}^{(N-1)/2} \exp(jm\Omega t). \end{aligned} \quad (8)$$

Therefore the set $\{D_i(t)\} = D(t - t_i)$ for $i = 1, \dots, N$ comprises a complete basis set for the time-frequency rectangular space $S^D = 2T\Omega = 2N\delta t \frac{\pi}{\delta t} = 2\pi N$.

By combining the Dirichlet and Gabor basis functions we can generate a finite ‘‘Gabor-like’’ basis set that is complete on the truncated space given in Eq.6:

$$\tilde{g}_m(t) = \sum_{i=1}^N g_m(t_i)D(t - t_i) \quad (9)$$

for $m = 1, \dots, N$. The new basis set is in some sense, the Gabor functions with periodic boundary conditions (henceforth, the periodic Gabor or ‘pg’ basis). We can write eq.(9) in matrix notation as: $\tilde{\mathbf{G}} = \mathbf{D}\mathbf{G}$ where $G_{ij} = g_j(x_i)$. By taking the width parameter $\alpha = \frac{\Delta\omega}{2\Delta t}$ (and locating a Gaussian function at the center of each unit cell) we can guarantee that the Gabor functions have no linear dependence and that the matrix \mathbf{G} is invertible, that is $\tilde{\mathbf{G}}\mathbf{G}^{-1} = \mathbf{D}$.

The invertibility of \mathbf{G} implies that both the Dirichlet and the pg bases span the same space (Fig.1). Therefore, $x(t)$ can be expanded as:

$$x(t) = \sum_{m=1}^N \tilde{g}_m(t)c_m. \quad (10)$$

To find the coefficients a_m we first define the overlap matrix, \mathbf{S} , as the inner product between pg functions:

$$\begin{aligned} S_{ij} &= \langle \tilde{g}_i, \tilde{g}_j \rangle = \int_0^{T_0} \tilde{g}_i^*(t)\tilde{g}_j(t)dt \\ &= \sum_{n=1}^N \sum_{m=1}^N g_i^*(t_n)g_j(t_m) \int_0^{T_0} D^*(t - t_n)D(t - t_m)dt \\ &= \sum_{n=0}^{N-1} g_i^*(t_n)g_j(t_n) \end{aligned} \quad (11)$$

or

$$\mathbf{S} = \mathbf{G}^\dagger \mathbf{G}. \quad (12)$$

Using the completeness relationship for non-orthogonal bases [21], $x(t)$ can be expressed as

$$x(t) = \sum_{n=1}^N \sum_{m=1}^N \tilde{g}_m(t)(S^{-1})_{mn} \langle \tilde{g}_n, x \rangle, \quad (13)$$

where, similar to Eq.11, the inner product

$$\langle \tilde{g}_n, x \rangle = \sum_{n=1}^N g_i^*(t_n)x(t_n). \quad (14)$$

Comparing Eq. (13) with Eq.(10) we find that

$$c_m = \sum_{n=1}^N (S^{-1})_{mn} \langle \tilde{g}_n, x \rangle \quad (15)$$

for $m = 1, \dots, N$. Although the \mathbf{S} matrix is localized, \mathbf{S}^{-1} is not; hence, Eq. 15 indicates that basis functions \tilde{g}_m that are distant in time-frequency from the signal x , still contribute to the expansion because of \mathbf{S}^{-1} .

Equation 15 can be written in an alternative way:

$$x(t) = \sum_{m=1}^N \tilde{g}_m(t) \langle \tilde{b}_m, x \rangle, \quad (16)$$

where

$$\langle \tilde{b}_m, x \rangle \equiv \sum_{n=1}^N (S^{-1})_{mn} \langle \tilde{g}_n, x \rangle, \quad (17)$$

for $m = 1, \dots, N$. We will call the $\{\tilde{b}_m\}$ basis the biorthogonal Gabor or ‘bg’ basis since the pg and bg bases taken by themselves are non-orthogonal but are orthogonal to each other. This can be shown easily by:

$$\begin{aligned} \langle \tilde{b}_i, \tilde{g}_j \rangle &= \sum_{n=1}^N b_i^*(t_n)g_j(t_n) \\ &= \sum_{m=1}^N \sum_{n=1}^N g_m^*(t_n)g_j(t_n)(S^{-1})_{im} \\ &= \sum_{m=1}^N S_{mj}(S^{-1})_{im} = \delta_{ij}. \end{aligned} \quad (18)$$

This biorthogonality property was used to great advantage by Bastiaans on the infinite basis set, but here the biorthogonality property holds on a truncated rectangular region in the time-frequency space.

So far the pg basis set provides two great advantages over the traditional Gabor basis set. First, in the original Gabor basis N functions give a very inaccurate expansion of $x(t)$ [5], whereas the periodicity of the pg basis makes the expansion exact for functions that are band-limited with finite support, bypassing the Balian-Low theorem. Second, the coefficients in the original Gabor

basis require knowledge of the bi-orthogonal basis, which in most cases is non-trivial to calculate. In the pg basis, no knowledge of the bi-orthogonal basis is necessary (Eq.15). Nevertheless, the compression is still problematic since, as discussed at Eq. 15, basis functions that are distant in time-frequency from the signal still contribute to the expansion.

III. ACHIEVING COMPRESSION: THE PERIODIC GABOR BASIS WITH BIORTHOGONAL EXCHANGE

We now turn to the issue of compression. Gabor's original idea was to exploit the time-frequency localization of the basis functions to reduce the size of basis. This intuitively appealing idea translates to the statement that a significant fraction of the basis will fulfill the relation: $\langle \tilde{g}_n, x \rangle = 0$, $n = 1, \dots, M$. However, there is an important subtlety — we cannot simply eliminate the states \tilde{g}_n , since as noted at Eq. 15, even pg functions that are remote from the signal can contribute to the expansion. Nevertheless, we can take advantage of the near-vanishing $\langle \tilde{g}_n, x \rangle$, if we exchange the roles of the bg and pg bases, allowing the delocalized bg functions to serve as the basis set for $x(t)$. Then Eq.13 becomes:

$$x(t) = \sum_{n=1}^N b_n(t) d_n = \sum_{n=1}^N b_n(t) \langle \tilde{g}_n, x \rangle. \quad (19)$$

By assumption, M of the $\langle \tilde{g}_n, x \rangle$ are zero, hence in order to represent $x(t)$ in the bg basis set we need only $N' = N - M$ basis functions. To emphasize, although the basis $\{b_n(t)\}$ has played a central role in Gabor theory since 1980, it has always been used for finding the *coefficients* of the Gabor basis. Equation 19 is a radical departure from the existing literature since the roles of the (periodic) Gabor and the biorthogonal (periodic)Gabor bases have been exchanged, with the bi-orthogonal functions now actually serving as the *basis* for the expansion of the signal and the localized original functions used for the calculation of the coefficients. Hence the name of the method, “periodic Gabor theory with biorthogonal exchange”, or pgb.

As discussed above, a large number of the coefficients in the pgb method are expected to be close to zero. After eliminating the small coefficients by quantization or entropy compression, one can use the remaining coefficients and the corresponding bg functions to obtain an approximate reconstruction of the original signal. We have found that the accuracy of the reconstruction, although quite good, can be further improved using a method developed by Porat[14]. The first step in Porat's method is to find a basis that is biorthogonal to the contracted bg set, i.e. by repeating the procedure of Eq.11 and Eq.17 but with the role of the N pg functions played by the N' bg set. In particular, the \mathbf{S} matrix is now defined in terms of the contracted set only. Then the desired coefficients are ob-

tained by the inner product between this new biorthogonal set and the original signal. We will show results using the Porat correction below.

IV. DISCRETE FORMULATION OF THE PGB METHOD

The pgb method can be formulated for discrete sequences as well as for continuous signals. Consider a discrete sequence $x[n]$ of length N , which can be viewed as samples taken at $t_i = 0, 1, \dots, N - 1$ of an N periodic signal $x(t)$ that is band limited in the interval $[-\pi, \pi]$. Let the Gabor grid consist of N_t and N_ω Gaussians in t and ω spaces respectively such that $N_t N_\omega = N$. The parameters that define the Gabor functions in Eq.5 are $\alpha = \frac{\Delta\omega}{2\Delta t} = \frac{\pi}{(N_\omega)^2}$, $t_0 = -\frac{\Delta t}{2}$, $\omega_0 = -\frac{2\pi + \Delta\omega}{2}$, $n = 1, \dots, N_t$ and $l = 1, \dots, N_\omega$. The pgb representation of the sequence is given by:

$$x(n) = \sum_{i=1}^N b_i(n) d_i, \quad (20)$$

or in matrix notation:

$$\mathbf{x} = \mathbf{B}\mathbf{d}, \quad (21)$$

where \mathbf{x} is the length N column vector of the sequence of values, \mathbf{B} is the $N \times N$ matrix with elements $B_{ni} = b_i(n)$ and \mathbf{d} is the coefficient vector given by Eq.14. Using Eq.17 and the fact that $\tilde{g}(n) = g(n)$, we find that:

$$b_i(n) = \sum_{j=1}^N g_j(n) (S^{-1})_{ji}. \quad (22)$$

or in matrix form:

$$\mathbf{B} = \mathbf{G}\mathbf{S}^{-1} = (\mathbf{G}^\dagger)^{-1}, \quad (23)$$

where we have used Eq. (12). Equation 23 can be written succinctly as $\mathbf{B}\mathbf{G}^\dagger = \mathbf{1}$. The related equation $\mathbf{G}\mathbf{B}^\dagger = \mathbf{1}$ is also correct, but has a completely different physical significance — it corresponds to the expansion of the signal in terms of the original Gabor basis, without the exchange of roles with the biorthogonal basis; in other words it corresponds to a discrete pg representation. It turns out that this discrete pg representation is fully equivalent to the DGE. In fact, the equation $\mathbf{G}\mathbf{B}^\dagger = \mathbf{1}$ appears in [7], albeit for just one column of the matrix.

V. RESULTS

We first address the difference in accuracy between the standard Gabor basis and the pg basis set without exchange. Consider the chirped Gaussian $s(t) = \left(\frac{2\text{Re}(\alpha)}{\pi}\right)^{\frac{1}{4}} \exp(-\alpha(t-t_0)^2 + iw_0(t-t_0))$ with $\alpha = 0.135(1+$

$i)$, $t_0 = 31.5$ and $w_0 = \frac{\pi}{3}$. We will compare the reconstruction using 64 Gabor and 64 pg functions. Both basis sets consist of Gaussian functions on an 8×8 time-frequency lattice. The Gabor coefficients were calculated using the procedure in [14]. Figure 2(a) shows the real part of the original signal and the reconstructions obtained using both bases. Figure 2(b) shows the difference between the reconstructed and the original signal. The norm of the error is 0.0347 for the Gabor basis and $1.8e^{-5}$ for the pg basis.

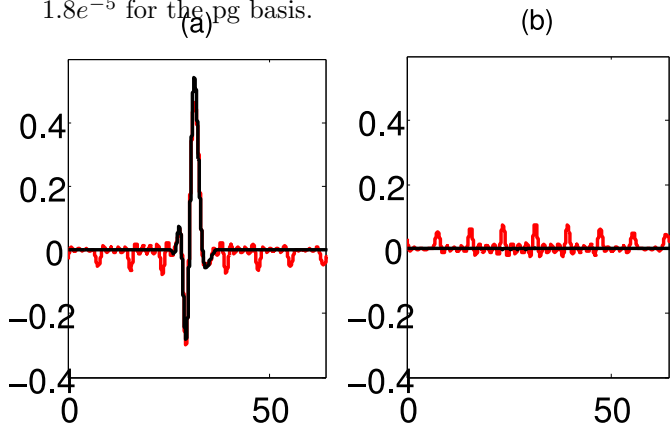

FIG. 2: (a). Reconstruction of a chirped Gaussian function using 64 standard Gabor (red) and 64 pg (black) functions. The pg result is virtually indistinguishable from the exact result. (b) Deviation between the reconstructed and the original signal using standard Gabor (red) and pg (black) functions.

We now turn to compression using the pgb method. (By compression we mean using only a small subset of the coefficients for the reconstruction.) We present three examples. The first is a 1-d rectangular pulse, an important example for signal processing. The second is the 2-d ‘‘Lena’’ picture, a benchmark for image processing. The third is an audio signal corresponding to a ‘splat’ sound. For each example, we compress the signal using a small subset of the coefficients and present the reconstruction from this subset.

The rectangular pulse was studied previously by Wexler and Raz[7]. Following those authors we consider a rectangular pulse represented by a discrete sequence of 64 points, compressed using 25 coefficients. The reconstruction obtained with the pg basis is essentially identical to the one reported by Wexler and Raz using the DGE [7] (see the discussion below Eq. 23). However, with the pgb method the reconstruction is improved by essentially an order of magnitude (L^2 norm of the error is 0.3989 in the DGE and 0.0469 in the pgb method). Comparison of the spectrum in the DGE and the pgb methods (Fig.4) demonstrates the much higher localization of the pgb coefficients, specifically in the time coordinate (the signal is inherently delocalized in frequency).

Several works have extended the DGE to two dimension in order to apply it to image compression[17–20]. Although the 2-d DGE reduces the entropy of an image, the entropy can be reduced much further using the pgb

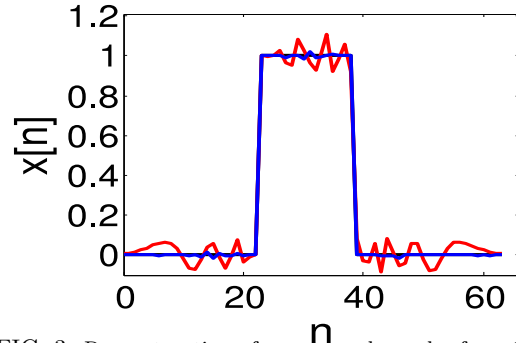

FIG. 3: Reconstruction of a rectangular pulse from 25 coefficients using the DGE method (red) and the pgb method (blue).

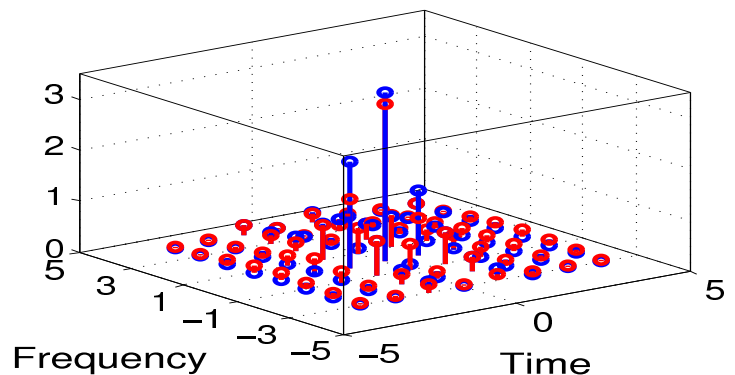

FIG. 4: The coefficients for representing a rectangular pulse in the DGE (red) and in the pgb method (blue).

method. We will demonstrate this on the Lena image (Fig. 5(a)), which is a benchmark for image compression. The original image contains 512×512 pixels. Figure 5 shows the reconstruction of the image using only the 2621 largest coefficients ($\approx 1\%$ of the coefficients), using the DFT (b), the DGE method (c) and the pgb method (e). The mean-square-error of the reconstructed image is 417 in the DGE and 327 in the pgb method, but the difference in visual quality is far more significant than these numbers indicate. Figure 5(d,f) shows the reconstruction of the image using 2621 coefficients when Porat’s correction is applied to both methods. The mean-square-error of the reconstructed image is 279 in the DGE and 144 in the pgb method. Again, the difference in visual quality is far more significant than these numbers indicate. The pgb result with Porat’s correction is better than the DFT (mean-square-error of 173) with the same number of coefficients (Fig. 5(b)).

Finally, we consider an example of an audio signal, which demonstrates the advantage of the pgb representation over the time and frequency representations. The original audio signal is sampled at 10000 sampling points. We used the pgb method on a grid of 100×100 unit cells in time-frequency space. Figure(6) shows the signal in the time, frequency and pgb representations. We recon-

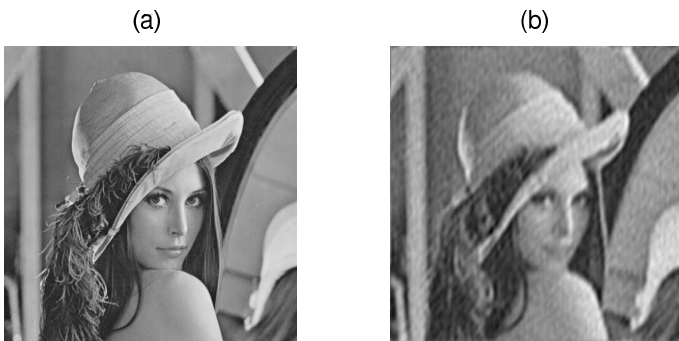

FIG. 5: Reconstruction of the Lena image using about $\approx 1\%$ (2621) of the coefficients. (a) original picture. (b) DFT. (c) DGE method. (d) DGE with Porat's correction. (e) pgb method. (f) pgb method with Porat's correction.

constructed the signal for various basis set sizes and calculated the norm of the error (the difference between the original and the reconstructed signal) using both the original pgb coefficients also the pgb coefficients after Porat's correction. The results are shown in Fig. (7). For comparison, we show results retaining the same number of DFT coefficients. Clearly, the pgb method allows much

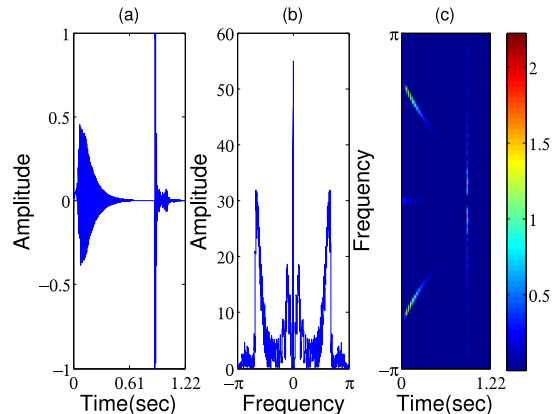

FIG. 6: The splat signal in time, frequency and pgb representations.

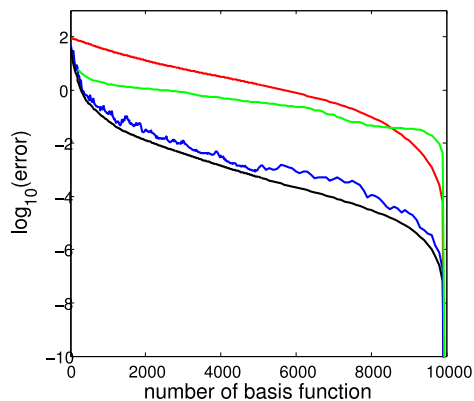
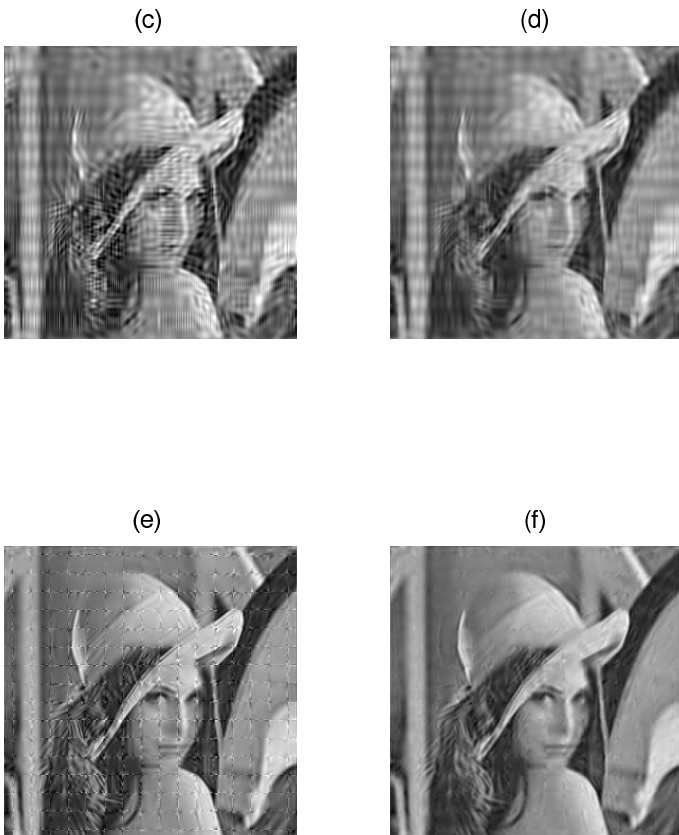

FIG. 7: The norm of the error of the reconstructed signal as a function of the number of basis functions using the DFT (red), the DGE with Porat's correction (green), the pgb (blue), and the pgb with Porat's correction (black).

more compression than the DFT, but introduces some residual roughness. This roughness may be removed using Porat's correction, although the latter involves some additional computational cost.

VI. SUMMARY

We introduced a new basis set called the periodic Gabor or pg basis which is effectively a 'convolution' of the Gabor and Dirichlet (periodic sinc) functions. The original Gabor basis is complete for the infinite space but incomplete, and actually unstable for a truncated rectangular region in time-frequency space. In contrast, the pg basis provides a complete and stable representation for a truncated rectangular area in time-frequency space, i.e. for the Hilbert space spanned by functions that are band-limited with finite support. Moreover, the coefficients in the pg representation may be calculated by simple matrix multiplication (Eq.15).

We noted that although the pg functions are localized, the corresponding biorthogonal bg basis functions that determine the coefficients are not. By exchanging the roles of the pg and bg bases, (“periodic Gabor method with bi-orthogonal exchange” or ‘pgb’) the coefficients become localized, leading to large compression factors. The pgb formalism is trivially adapted to the case of discrete signals. We provided three examples of finite sequences, and showed the large compression factors achievable using the pgb coefficients.

Although we have not exploited it here, Eq. (9) combined with Eq. (6) allows the freedom to choose Gaussian basis functions of different widths and spacings. That means that in principle we can combine the time-frequency shifting with a scaling transformation, simi-

lar to what is done in the wavelet approach and in the pyramidal Gabor function. In fact, the formalism is not restricted to Gaussians — it can be extended to any localized basis functions as long as the unit cell area obeys $\Delta t \Delta \omega = 2\pi$. More research will be required on how to optimize the basis for a given signal.

We fully expect that the pgb method and its generalizations, with its combination of simplicity, flexibility, accuracy, stability and efficiency, will provide a competitive alternative to wavelet methods.

This work was supported by the Israel Science Foundation Grant 807/08 and the US-Israel Binational Science Foundation. It was made possible in part by the historic generosity of the Harold Perlman family.

-
- [1] D.Gabor, J. Inst. Elect. Eng. **93**, 429 (1946)
 - [2] J.von Neumann, Math. Ann. **104**, 570 (1931).
 - [3] I. Daubechies, IEEE Trans. Information Theory **36**, 961 (1990)
 - [4] R. Balian, C. R. Acad. Sci. III **292**, 1357 (1981)
 - [5] F. Low, in *A Passion for Physics—Essays in Honor of Geoffrey Chew* (World Scientific, Singapore, 1985), pp.17-22
 - [6] M.J.Bastiaans, Proc. IEEE **68**, 538 (1980)
 - [7] J. Wexler and S. Raz, Signal Processing **21**, 207 (1990)
 - [8] S. Qian and D. Chen, IEEE Trans. Signal Proc. **41**, 2429 (1993).
 - [9] C. G. v. d. Boogaart and R. Lienhart, ICASSP, Toulouse, France **3**, 161 (2006)
 - [10] A. Shimshovitz and D. J. Tannor, Phys. Rev. Lett.(in press); quant-ph arXiv:1201.2299.
 - [11] N. Takemoto, A. Shimshovitz and D. J. Tannor, J. Chem. Phys. (in press).
 - [12] A.M Perelomov, Theor. Math.Phys **11**, 156 (1971).
 - [13] S.R Dooley and A.K. Nandi, IEEE Trans. Signal Proc. **48**, 1201 (2000).
 - [14] T. Genossar and M. Porat, IEEE Trans. Systems, Man and Cybernetics **22**, 449 (1992)
 - [15] J. G. Daugman, IEEE Trans. Signal Proc. **36**, 1169 (1988).
 - [16] M. Porat and Y. Y. Zeevi, IEEE Trans. Pattern Anal. Machine Intell **10**, 452 (1988).
 - [17] T. Ebrahimi and M. Kunt, Optical Engineering **30**, 873 (1991)
 - [18] S. Li, IEEE ICIP-94 Proc. **1**, 810 (1994).
 - [19] J. L. Gouronc and J. Si, IEEE Intl. Symp. on Circuits and Systems **1**, 251 (1993).
 - [20] L. Andras and J. Chmurny, Radioengineering **10**, 5 (2001).
 - [21] D. J. Tannor, *Introduction to Quantum Mechanics: A Time-dependent Perspective* (University Science Books, Sausalito, 2007), eq.8.85.
 - [22] In the context of quantum mechanics we call the method pvb for periodic von Neumann basis with biorthogonal exchange.