

From Exploration to Revelation: Detecting Dark Patterns in Mobile Apps

1st Jieshan Chen

CSIRO's Data61

Australia

Jieshan.Chen@data61.csiro.au

2nd Zhen Wang

CSIRO's Data61

Australia

Jeff.Wang@data61.csiro.au

3rd Jiamou Sun

CSIRO's Data61

Australia

Frank.Sun@data61.csiro.au

4th Wenbo Zou

University of South Wales

Australia

wenbo.zou@student.unsw.edu.au

5th Zhenchang Xing

CSIRO's Data61

Australia

zhenchang.xing@data61.csiro.au

6th Qinghua Lu

CSIRO's Data61

Australia

Qinghua.Lu@data61.csiro.au

7th Qing Huang

Jiangxi Normal University

China

qh@jxnu.edu.cn

8th Xiwei Xu

CSIRO's Data61

Australia

Xiwei.Xu@data61.csiro.au

Abstract—Mobile apps are essential in daily life, yet they often employ dark patterns, such as visual tricks to highlight certain options or linguistic tactics to nag users into making purchases, to manipulate user behavior. Current research mainly uses manual methods to detect dark patterns, a process that is time-consuming and struggles to keep pace with continually updating and emerging apps. While some studies targeted at automated detection, they are constrained to static patterns and still necessitate manual app exploration. To bridge these gaps, we present **AppRay**, an innovative system that seamlessly blends task-oriented app exploration with automated dark pattern detection, reducing manual efforts. Our approach consists of two steps: First, we harness the commonsense knowledge of large language models for targeted app exploration, supplemented by traditional random exploration to capture a broader range of UI states. Second, we developed a static and dynamic dark pattern detector powered by a contrastive learning-based multi-label classifier and a rule-based refiner to perform detection. We contributed two datasets, **AppRay-Dark** and **AppRay-Light**, with 2,185 unique deceptive patterns (including 149 dynamic instances) across 18 types from 876 UIs and 871 benign UIs. These datasets cover both static and dynamic dark patterns while preserving UI relationships. Experimental results confirm that **AppRay** can efficiently explore the app and identify a wide range of dark patterns with great performance.

Index Terms—Dark Pattern, Ethical Design, User Interface

I. INTRODUCTION

People nowadays can conduct many tasks, including shopping, reading, chatting, using their own laptops or mobile apps, between which user interfaces play as an important proxy to connect human and these functionalities. However, many apps unconsciously or intentionally insert some psychological tricks into these user interfaces and try to manipulate end-users, either to seduce them stay longer at their services [1], [2], or deceive them to perform some actions that may not of their best interest [3]–[5]. For instance, in the context of social media, the “never-ending auto-play” function for videos is automatically enabled to capture end-users’ attention and encourage them to continue browsing the app unconsciously [2]. As a result, people feel regretful when they reflected [1]. Additionally, apps often integrate native advertisements seamlessly

with other content, adopting the same visual styles, which can make it difficult for users to distinguish between regular content and advertisements. People may mistakenly click these advertisements and surprisingly find they are ads. These tricks on user interfaces are termed as deceptive patterns (as known as dark patterns)¹ [3], [6].

While people may not be familiar with this term, deceptive patterns are everywhere in our life. Mathur et. al found that 11.1% of 11K shopping websites have dark patterns [7]. Di et al. revealed that 95% of 240 popular mobile apps averagely contain at least seven types of dark patterns [5]. Moreover, researchers are now actively working on recognising and summarising dark patterns from different aspects, such as language differences [8], Home IoT devices [9], cookie banners [4], [10] and video streaming platforms [11]. The prevalence of dark patterns become severe issues but auditors and app markets now mainly rely on manual efforts to identify them, which is quite time-consuming and not generalisable.

Several recent studies have started working on automating the identification of dark patterns using advanced techniques [12], [13]. Mansur et al. [12] introduced AidUI, a tool capable of detecting 10 types of dark patterns across mobile UIs and websites, while Chen et al. [13] presented UIGuard, focusing on 17 dark pattern types within mobile UIs. Nonetheless, their focus remains limited to individual user interfaces, neglecting comprehensive application-wide scrutiny and the relationship among UIs. Consequently, individuals are forced to invest substantial time in manual app exploration, particularly given the intricate nature of app user interfaces. Moreover, as apps keep updating, this manual process becomes more cumbersome and time-consuming. In addition, their singular UI emphasis restricts their capability to identify only static dark patterns (single page related deceptive patterns), leaving dynamic manifestations (interaction related patterns) unattended.

¹We will use dark patterns and deceptive patterns interchangeably in this paper.

On top of that, there are severe drawbacks in the dataset used in the previous study. The existing datasets on dark patterns are either focusing on a subset of dark pattern type (e.g., static dark patterns only [12], [13]) or fail to provide the localisation of the instance within the UIs [5]. However, dynamic dark patterns are an uncovered area and have become prevalent in various mobile app designs. For example, Bait and Switch is a dynamic dark pattern that entices users to click on something, resulting in an unrelated outcome (e.g., clicking a button but getting an ad).

Drive by the previous limitations, in this work, we propose a framework, named AppRay, to automatically collect UIs and detect both static and dynamic dark patterns given an app. Our framework consists of two essential components: (1) an app exploration module that incorporate a LLM-powered app navigator with classical automated app exploration tool; (2) a dark pattern detector that integrates a contrastive learning-based dark pattern classifier, and a rule-based dark pattern refiner.

Given an app under test, our LLM-powered app navigator leverages LLMs to simulate end-users to navigate through the apps to explore and collect diverse UIs. Inspired by Di’s work [5], we instruct LLM to role play as a end-user to conduct the tasks similar to [5] to explore the apps. Additionally, we integrate an automated app exploration tool to further increase UI coverage within the apps.

After obtaining the UIs from the app, we developed a context aware dark pattern detector to automatically detect dark patterns within and across UIs. We first leveraged the mature property extraction module from UIGuard [13] to identify elements and group related elements into different semantic components. Based on this, we proposed a component-level dark pattern detector, powered by a contrastive learning-based multi-label classifier and a rule-based refiner. The multi-label classifier scans each UI page to identify potential dark patterns, while the rule-based refiner checks preceding and subsequent UIs, modeling the UI relationship, to remove false positives and increase precision. In detail, the multi-label classifier employs a Siamese network structure by leveraging a BERT-based model for text features and a ResNet50 to understand the relations between UI components within the UI page. The final output identifies potential dark patterns by considering features from both networks. The rule-based refiner acts as an optimizer to eliminate false positives while preserving true positives. With these specialised designed modules, our detector is able to disambiguate between similar dark patterns (e.g., distinguishing between nagging and disguised ad patterns) with high precision and recall.

To train and test our proposed techniques, we contribute new datasets, AppRay-Dark and AppRay-Light, that addressed the limitations of existing datasets, covering both static and dynamic dark patterns and preserving the relationship among UIs. To this end, we leveraged our collected UIs from our app navigator as a starting point, which captures the action points, screenshots, and relationship among UIs. We conducted three round of annotations. In total, we annotated 19,722 UIs

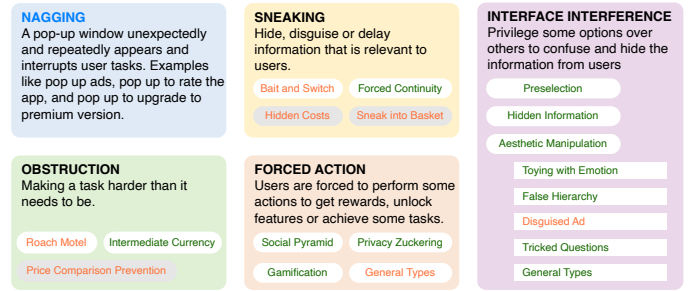

Fig. 1. Dark pattern taxonomy. It consists of five main strategies. We employ black, blue and orange colors to indicate the static, in-between, and dynamic dark patterns

from 100 apps, and identified 2,185 unique deceptive pattern instances of 18 types from 876 UIs. Among these instances, 149 are related to multiple UIs (i.e., dynamic dark patterns) from 48 apps. We termed it as AppRay-Dark dataset. We also collected 871 benign UIs from these collected UIs, termed AppRay-Light for assessing the likelihood of detecting false positives.

We conducted a comprehensive evaluation to evaluate the performance of the proposed system, including modular examination and ablation study (Section VI-A and Section VI-A2), baseline comparison(Section VI-B and Section VI-C) and a user study (Section VI-D). The modular examination and ablation study confirm the effectiveness and critical roles of each module of AppRay. We found that our AppRay achieves 0.77/0.65 in precision, 0.76/0.62 in recall and 0.76/0.62 in F1-score for the macro/micro average performance respectively, effectively covering both static and dynamic dark patterns. Finally, the user study confirms the usefulness of the proposed technique.

In summary, the contribution of our work are as follows:

- We present, AppRay, the first systematic method that addresses the dark patterns detection problem from app exploration to revelation, covering both dynamic and static dark patterns.
- We contributed the first large datasets on dark patterns, capturing both static and dynamic instances with localization. The dataset includes 2,185 unique deceptive patterns (containing 149 dynamic instances) of 18 types from 876 UIs (AppRay-Dark), and 871 benign UIs (AppRay-Light), annotated from 19,722 UIs across 100 apps.
- We conducted comprehensive experiments to verify the effectiveness and usefulness of our proposed AppRay.

II. BACKGROUND

A. Dark Pattern Taxonomy

Many works have been done to summarise the taxonomy for dark patterns in mobile platform. We leveraged the taxonomy from Chen et al. [13] and Mansur et al. [12], which integrate and summarise the existing taxonomies [3], [5], [14] into a unified one. We further merged and reorganised their taxonomies into our used one. As seen in Figure 1, the taxonomy is categorised into five strategies [3], namely nagging,

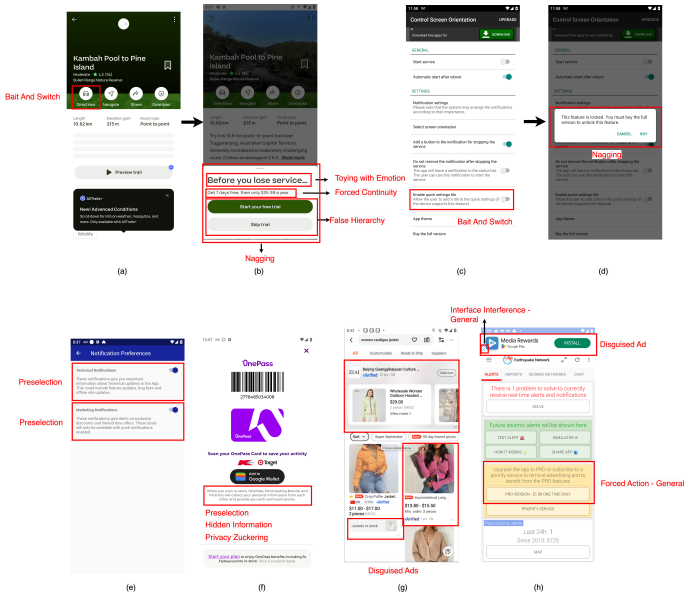

Fig. 2. Examples of deceptive patterns.

obstruction, sneaking, and interface inference. Figure 2 shows some examples.

- **Nagging** disrupt user tasks by suddenly displaying irrelevant windows. For example Examples include Pop-Up Ads appear unexpectedly to promote advertisements, while Pop-Up to Rate and Pop Up to Upgrade ask users to rate the app or to upgrade to the premium version.
- **Obstruction** seeks to unnecessarily complicate tasks. *Roach Motel* facilitates effortless opt-in but presents challenges for opt-out (e.g., easy to subscribe but hard to cancel it). *Intermediate Currency* introduces virtual currency, blurring the distinction between virtual and actual money. *Price Comparison Prevention* creates obstacles when attempting to compare product prices across different applications or websites.
- **Sneaking** hides, disguises or delays relevant information to the current user task. *Hidden Costs* reveals significant expenses such as shipping fees belatedly. *Forced Continuity* automatically prolongs subscriptions without noticing the users. *Bait and Switch* entices users to do something but give unrelated outcome (e.g., you click a button but get an ads). *Sneak into Basket* quietly adds additional items to the shopping cart.
- **Forced Action** forces users to perform some actions to get rewards, unlock features or achieve some tasks. *Social Pyramid* allures users to share something with their friends to get rewards or unlock features. *Privacy Zuckering* coerces users into divulging privacy-related information. *Gamification* asks users to perform repetitive actions in exchange for rewards. *General Types* includes other tactics like countdowns on ads, watching ads to unlock features or earn rewards, and paying to eliminate ads.
- **Interface Interference** manipulates the interface to privilege some options over others. *Preselection* enables options

like notifications by default or do not provide an opt-out option. *Hidden Information* makes information relevant to users not intermediately readable or accessible. *Aesthetic Manipulation* alters the user interface in a manner that prioritizes form over function, which includes five sub types. “Toying with Emotion” entails influencing user sentiment to either encourage or discourage certain actions (e.g., activity message, countdown offer). “False Hierarchy” establishes misleading visual prominence. “Disguised Ads” blends advertisements seamlessly with other content by using the same visual effects. “Tricked Questions” utilize linguistic constructs, such as double negations, to obfuscate queries. “General Types” are other tricks, including small close buttons on ads and moving ads button.

Chen et al. [13] further classified these dark pattern types into two types: **static** and **dynamic**, based on whether the dark pattern requires contextual information to be identified. They also introduce the concept of “in-between” dark patterns, which span multiple pages but may be identified on a single page, potentially leading to false positives. We employ green, blue and orange colors to indicate the static, in-between, and dynamic dark patterns in Figure 1.

III. RELATED WORK

Existing research focuses on different aspects of dark patterns, such as dark pattern taxonomies identification and summarization [3], [5]–[7], [11], [14], user perception and impacts [1], [15]–[17], and dark pattern remediation [12], [13], [18], [19].

Dark pattern taxonomies identification and summarization focuses on using manual or semi-manual methods to explore the apps or websites, getting their UIs and then identifying and summarising the contained dark patterns [3], [5]–[11], [14]. In 2010, Harry Brignull [6] defined dark pattern as “a user interface that has been carefully crafted to trick users into doing things, such as buying insurance with their purchase or signing up for recurring bills.” He established the <https://www.darkpatterns.org/> website, which collects various examples from web and mobile apps and categorises them into different types such as confirmation shaming, which triggers uncomfortable emotion to impact user decision. He also provides a Hall of Shame to continuously report the dark patterns used by companies around the world, and created a Twitter account [20] for people to report dark pattern instances. In the academic fields, Gray et al. [3] later refined and extend his taxonomy in terms of five strategies, namely Nagging, Interface Inference, Forced Action, Obstruction and Sneaking. Since then, more researchers put more efforts on identifying dark patterns, summarising and enriching the taxonomies from different aspects, such as game [21], shopping website [7] and mobile apps [5]. Built upon these research methodology and taxonomy, we propose to leverage LLM’s capabilities to simulate human exploration and automatically explore the apps to gather the UI in the apps.

Another stream of dark pattern research focuses on understanding user perception and the impacts of the dark patterns

on the end-users [1], [15]–[17]. For example, Cho et al. [1] analysed the feature-level usage logs of four social media apps (Instagram, Facebook, YouTube, KakaoTalk) from 29 Android users, and investigated when and why people regret. They found that among 4,069 sampled sessions, 26.5% were considered fully or partially regretful as regretful. Sergeeva et al. [16] instead dives into how users think of the persuasive tactics used in permission-based advertising emails. They identified four reactance-triggering factors that caused the negative attitudes towards these advertising emails, and found that participants now had doubts about the effectiveness of these tactics and would even raise some questions on the advertised goods in the emails.

Recognising the severeness of these dark patterns and impacts, researchers start taking actions on remediating the impacts [12], [13], [18], [19]. One way is to directly hide the dark patterns in the app to remove the impacts. Kollnig et al. [18] introduced GreaseDroid for end-users to apply patches from experts to their app, and then use the modified clean app. The patches are manually created by developers, which can modify the code files of the apps to remove the dark patterns. However, this method requires great expertise, hard to generalise, may have impacts on the app functionality or introduces potential privacy risks. Datta et al. [19] later presented GreaseVision that democratise the creation of patches by allowing end-users to provide the screenshots of areas to be modified. Apart from these kinds of method, recent work started working automated detection of dark patterns to warn the developers, end-users of these tricks. Mansur et al. [12] proposed AidUI to automatically detect dark patterns in the current UI/website page using computer vision and template matching techniques. Concurrently, Chen et al. [13] developed UIGuard, which focuses on the mobile UIs, to identify 17 types of static dark patterns. Our work follows the second stream, aiming at automated identifying dark patterns to warn the end-users. Different from existing techniques, we not only focus on a single UI, but also take the interactions into account, which enable the detection on dynamic tricks like sneak into the basket.

IV. METHODOLOGY

As seen in Figure 3, our system comprises an app exploration module and a dark pattern detection module.

A. App Exploration

The app exploration has two phases. We conduct task-oriented exploration based on LLM, following Di Geronimo et al’s methodology [5] to perform tasks that are prone to have potential dark patterns. We then employ existing app exploration tool to collect as many UI status as possible.

1) *Task-Oriented App Exploration*: While random exploration can capture many UI states, it overlooks UI semantics, often getting stuck on certain pages and failing to perform meaningful actions. Unfortunately, certain dark patterns only come to light during logical, sequential exploration of the app. Failing to do any of the steps can not lead to the final page

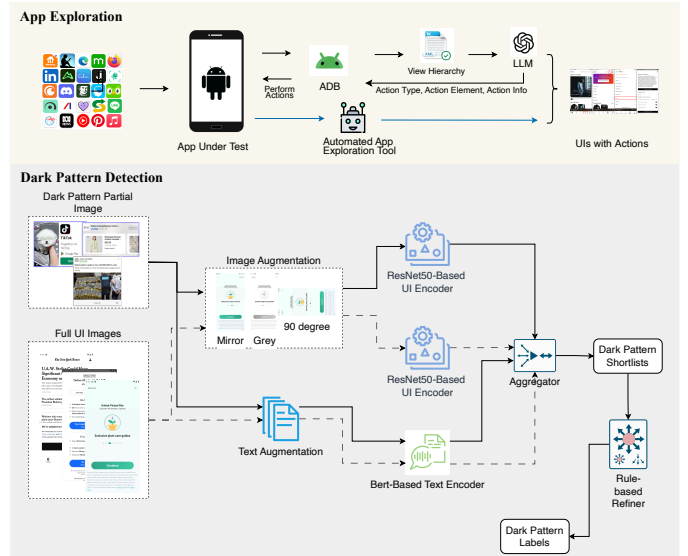

Fig. 3. Overview of AppRay. It consists of two modules: app exploration and dark pattern detection.

that contains dark patterns. Furthermore, some routine tasks can be hotspots for some dark patterns. Simply navigating to the notification settings page might unveil the “Preselection” tactic, where choices are made on behalf of the user without clear consent. Thus, task-oriented exploration, which mirrors human interaction, is essential. To this end, we harness the commonsense knowledge of large language models, i.e. GPT-4 [22], for targeted app exploration.

To this end, we first define a set of common tasks and a feature-specific task. Then, given an app under test and the task, we (1) obtain and process the current UI’s view hierarchy into text; (2) feed this to the LLM to get the next action; (3) perform the action on behalf of LLM and repeat Steps 1-3 until reaching the max step, or LLMs believe the task is finished.

Task Definitions. As seen in Table I, we consider general tasks and feature-based tasks. The general tasks are common tasks that are prone to contain dark patterns [5]. For example, most apps should have notification setting page to control the way the app inform users. Therefore, by setting the task “go to the setting page and turn off all notification”, we can check whether these notifications are enabled by default. Feature-based tasks focus on app-specific functionalities, initially targeting shopping features to reveal potential dark patterns. The primary goal of task-oriented exploration is to delve into more UI states coherently, complementing the limitations of random exploration. Completing these tasks is secondary and inconsequential to the exploration process.

UI Information Extraction. To feed data to GPT-4, we first convert the UI information into textual format. Each user interface is represented as a tree structure with leaf elements like Buttons for interaction, TextViews for conveying textual information, ImageView for displaying images, and layout elements organising the leaf elements into a structure way like LinearLayout for placing the elements in a linear order. Each element has attributes such as text, clickable,

TABLE I
TASK DEFINITIONS, POTENTIAL ASSOCIATED DARK PATTERNS, AND RESULTS

ID	Task	Potential Dark Patterns	Success Rate
T1	Register an account	Preselection, Nagging, Privacy Zuckering	56.41%
T2	Sign in	Preselection, Nagging, False Hierarchy	78.21%
T3	Go to setting page, go through all notification related pages	Preselection	82.83%
T4	Go to setting page, go through all privacy related setting	Preselection, Privacy Zuckering	84.0%
T5	Check if we can subscribe to premium account, if so, read through all contents on the subscription page	False Hierarchy, Preselection, Forced Continuity	83.33%
T6	(Optional) Select any product you like with proper attributes (like size), add to cart, proceed to checkout	Sneak into the Basket, Hidden Costs, Preselection	30.0%
T7	Sign out the app	Roach Motel, False Hierarchy	58.11%

and classname, indicating its properties. We use the Android Debugging Bridge (ADB) to obtain the current UI’s view hierarchy, extract key information, and feed it into the LLM to understand the UI and make decisions. In detail, we extract the following information:

- **Classname** of UI elements indicate their functionalities, such as a Button that allows user interaction.
- **Resource ID** is used as a unique identifier for UI elements, indicating their semantic meaning.
- **Text Content:** Text and Content-description contains the text on elements or the accessibility label for image-based buttons.
- **Action-Related Attributes** including clickable, scrollable, checked, indicates possible actions and the element’s current status. For example, a clickable and checked CheckBox element means it can be clicked and is currently checked.
- **Bounds** specifies the element position on the UI.

Prompt Engineering and Action Space. We adopted the in-context learning with few shot examples to optimise the prompt and facilitate the task-oriented app exploration. We provide overall instructions to GPT, including the expected output, and one example for each action to clarify the task ². We consider five common actions, namely tap, scroll, type, back and stop. Stop is specially designed when LLM finds the task is finished.

Overall Interaction between Device and LLM. For each round, we first obtain the UI information and convert it into text format. We then fill the prompt template with the current task, history actions, UI information, and ask GPT for the next actions. Once we obtain the actions, we extract the action point using the bounds of the target element, and perform the action using ADB. This process is iterative until LLM provides a stop action or the number of steps reach the predefined threshold.

2) *Random Exploration:* We use the state-of-the-art automated app exploration tool FastBot2 [23], developed by ByteDance, to capture as many UI states as possible. FastBot2 employs a probabilistic model and a reinforcement learning model to collaboratively determine the best strategy for uncovering unique UI states. It identifies the optimal action based on the current UI information, available UI widgets, and historical actions, leading to an effective exploration strategy.

Note that this automated tool can be replaced by any other app exploration tool, and it is not our primary contribution.

3) *UI Merging:* After we obtain UIs from both automatic and targeted exploration, we conduct post-processing to merge these obtained UIs by identifying duplicate UIs and UIs that are not related to the apps. For deduplication, we consider two measures, i.e., UI screenshot matching and view hierarchy matching. For UI screenshot matching, we check whether their images are the same by simple pixel matching method. For view hierarchy matching, we extract all the leaf elements of the screen. As some elements are invisible, we check their “visible-to-users” attribute and only keep ones that are visible. Some elements are too small and meaningless, like the divider, so we remove elements that has a width or height less than 5. We only keep the class, resource-id and checked of the elements to avoid saving many UIs with subtle or meaningless differences. For example, some UIs may be dynamic but show a similar meaning, like the music app will recommend different music every time we refresh the list. After filtering, if two view hierarchies are the same, we consider them as duplicates.

B. Dark Pattern Detection

Existing work mainly focus on single UI detection, which are prone to have false negatives and can not deal with dark patterns that related to several UIs. As we incorporate the exploration in our work, our method has the capability to deal with dynamic patterns. Due to the great amount of UIs collected in apps, it is cost-extensive to use LLMs for assessing all UIs one by one and it is also not necessary.

Given a UI under test, we initiate the detection process by extracting properties of the UI elements, grouping them into semantically distinct clusters using heuristic rules. Subsequently, we deploy our proposed component-based dark pattern detector on each identified element or cluster.

1) *UI Information Extraction and Grouping:* We directly leveraged UIGuard’s [13] method for extracting the UI information, including element bounds, types, text and status. We also leveraged their method in grouping checkbox with associated text elements. Based on this, we proposed simple rules to group elements that are semantically relevant (e.g., the elements on a confirmation pop-up should be grouped into a semantic cluster).

2) *Component-Based Dark Pattern Detector:* After we obtain the component need to be tested, we take the component,

²Prompts are provided in the supplementary materials

whole UIs and the UI information as input, and perform our component-based dark pattern detector. To support the detection of both static and dynamic deceptive patterns, our detector comprises two parts: (a) a contrastive learning-based multi-label classifier and (b) a rule-based refiner. Given that each UI page includes text content, UI element attributes, and UI structure, the classifier employs a Siamese architecture with two encoders: (1) BERT-based text encoder and (2) ResNet50-based UI image encoder. As illustrated in Figure 3, the main structure of our dark pattern detector enables two shared-weight UI encoders and one text encoder to encode the text contents in the UI and dark patterns. The aggregator combines the output embeddings from the UI encoders and text encoders using concatenation, which is then passed into a fully connected classifier to shortlist potential dark patterns. The rule-based refiner provides the final output by applying predefined knowledge and contexts. Because of the scarcity and imbalance of dark patterns across classes, with instances ranging from just a few to several hundred, it is essential to address these disparities to improve detection performance. Classes with fewer instances of dark patterns undergo data augmentation operations to enhance their representation in the training set.

3) *Data Augmentation*: Data augmentation includes various image transformations such as rotation, flipping, and color adjustment [24], as well as synthetic text generation methods like paraphrasing, synonym replacement, and back-translation [25]. By augmenting the data, we not only increase the number of training samples for under-represented classes but also introduce variability that helps the classifier generalize better to unseen examples. This approach ensures that the model learns robust features and relationships for each type of dark pattern, ultimately leading to more accurate and reliable detection. As the Figure 3 shows, a sequences (gray, 90 degree rotation and flip, etc) of complex transformation functions $T = [T_1, \dots, T_n]$ applied on the UI images or data pattern images $I' = T_n(T_{n-1}(\dots T_1(I)))$. The textual data augmentation include synonym replacement, random insertion, and random swap. This data augmentation process can be repeated with various combinations of transformations to create a large set of augmented text and images from the original inputs.

4) *Contrastive Learning and Loss Functions*: Our dataset includes 16 classes of deceptive patterns, where presenting various ambiguities that can confuse the classifier. Contrastive learning is a technique used to learn representations by comparing and contrasting samples in a high-dimensional space [26]. This approach is particularly effective in unsupervised and semi-supervised learning scenarios, where labeled data is scarce. The main idea is to bring similar samples closer together and push dissimilar samples further apart in the feature space. For instance, the dark patterns ‘‘Disguised AD’’ and ‘‘Nagging’’ can both be located at the bottom of a UI with similar attributes. However, their main contexts are quite different for the two dark patterns. ‘‘Disguised AD’’ fakes as a normal feature, appearing similar to surrounding components, while ‘‘Nagging’’ repeatedly pops up, obstructing

the user’s normal experience and urging them to agree to something. Without contrastive learning, the model would struggle to distinguish between these two patterns. We will provide detailed comparisons how contrastive learning helps address this issue in Section VI-A2.

Contrastive Loss: Given x_i and x_j are two samples, and $f_w(x_i)$ and $f_w(x_j)$ are their corresponding representations in the latent space, the contrastive distance can be expressed as:

$$L_D = -\log \frac{\exp(D(x_i, x_j) / \tau)}{\sum_{k=1}^N \exp(D(x_i, x_k) / \tau)} \quad (1)$$

where $D(x_i, x_j) = \|f_w(x_i), f_w(x_j)\|_2$ is the similarity between $f_w(x_i)$ and $f_w(x_j)$. $\|\cdot\|$ is a similarity metrics (e.g., Cosine similarity or Euclidean distance), τ is a temperature parameter and N is the number of negative samples. It encourages the representations of positive pairs to be similar and those of negative pairs to be dissimilar. The contrastive loss can be expressed as:

$$L_{contrastive} = (1 - y)L_D^- + yL_D^+ \quad (2)$$

where the term y specifies whether the two given data inputs (x_i and x_j) are similar ($y = 1$) or dissimilar ($y = 0$). The L_D^- term stands for the contrastive distance L_D when the data inputs are from the different classes. The L_D^+ term stands for the contrastive distance L_D when the data inputs are from the same classes.

Cross-entropy loss is used to measures the performance of the final classifier and can be defined as:

$$L_{crossentropy} = -\sum_{i=1}^C y_i \log(\hat{y}_i) \quad (3)$$

Class Weight and Overall Loss: the total loss of our multi-label classifier is:

$$\mathbb{L} = L_{crossentropy} + L_{contrastive} \quad (4)$$

The imbalanced classes in the model training can lead to biased models that perform well on the majority classes but poorly on minority classes. Class-weights is an essential solution in this case. It assigns higher weights to the minority classes and less weights to majority classes so that the model will pay more attention to these minority classes during training. To achieve this, the loss function has to be adjusted the contribution of each class to the overall loss based on their class-weights:

$$\mathcal{L} = \sum_{c=1}^{\|C\|} w_c \mathbb{L} \quad (5)$$

Negative Samples: Negative sampling is crucial for contrastive learning. It helps the model learn to differentiate between distinct classes by providing examples that are not similar to the anchor sample. By learning to correctly identify these dissimilar examples, the model develops a clearer understanding of the boundaries between different classes in the embedding space. Negative sampling strategies in contrastive learning should be task oriented by addressing various

challenges. In the dark pattern detection problem, we applied several strategies:

- 1) Random negative sampling. The negative samples are randomly chosen from the dataset of the other classes, which is simple strategy to warm up the model training.
- 2) Hard negative sampling [27]. Hard negatives are selected based on their similarity to the anchor samples.

$$D^+(x_i, x_j) - D^-(x_i, x_k) > \xi \quad (6)$$

where ξ is a hyperparameter to define the hardness of negative samples relative to positive samples. These negative samples encourages the model to learn better distinctions between the data from similar classes.

- 3) Balanced negative sampling. The number of negative samples is balanced with positive samples, preventing the model from being biased towards one type of sample.

5) *Model Training*: Our multi-label classifier is a Siamese model that consists of two pipelines: an image embedding pipeline and a text embedding pipeline, followed by a final MLP classifier with a sigmoid activation function for the final predictions. Each pipeline processes its respective inputs to generate meaningful embeddings. These embeddings are then combined and fed into the final classifier. Each pipeline is trained independently, and once trained, their weights are frozen. The final classifier is subsequently trained using the outputs from the frozen pipelines. The details of the training process are as follows:

- 1) The input training set comprises images features and text features (extracted from the images using Optical Character Recognition). To address class imbalances and enrich minority classes, the training set will go through data augmentation process to generate positive and negative samples.
- 2) The image inputs are encoded using a ResNet50-based image embedding pipeline. There are two types of image inputs: dark pattern images and their corresponding full UI images. Both types of images pass through the shared-weight image embedding pipeline. To train the pipeline weights, a temporary fully connected classifier is attached to classify the image features. Similarly, a BERT-based text embedding pipeline processes the text features, with a temporary fully connected classifier attached to classify the text features alone.
- 3) Once the image and text embedding pipelines are trained, they will be connected to the final MLP classifier. The weights of these pipelines will be frozen, and their output embeddings will be concatenated to serve as inputs for training the final MLP classifier.
- 4) The entire training process is optimized using the Adam optimizer, with the loss function \mathcal{L} in equation 5

6) *Rule-Based Refiner*: The rule-based refiner operates by applying a set of predefined heuristics and logical rules designed to filter out patterns that do not meet specific criteria. These rules are based on domain knowledge and empirical observations, allowing the refiner to assess the context and

content of each flagged dark pattern more thoroughly. For example, the refiner might check for certain textual cues, layout structures, or interaction patterns that are indicative of certain dark patterns. By leveraging these rules, the refiner enhances the overall precision and reliability of the detection system. In addition to single-page analysis from the model-based classifier, the rule-based refiner extends its capabilities to perform multi-page dynamic dark pattern detection. This involves analysing the flow of dark patterns across multiple pages. The refiner tracks the interactions of static dark patterns across multiple pages to identify dynamic dark patterns. It evaluates sequences of page transitions, and cumulative interface changes to detect patterns such as bait and switch, roach motel or nagging that span multiple steps.

V. RESEARCH QUESTIONS AND DATASETS

A. Research Questions

In this section, we evaluate our proposed system by investigating the following research questions (RQs):

- **RQ1**: How effective is each module (i.e., app exploration and detector modules) in our proposed system?
- **RQ2**: How effective is the proposed method in detecting dark patterns in UIs compared to existing techniques?
- **RQ3**: How often does AppRay detect false positives in UIs that do not contain dark patterns?
- **RQ4**: To what extent, can AppRay assist human in manual exploration and identification given an app under test?

B. Datasets

As mentioned in Section I, existing datasets fall short of providing a dataset that covers both static and dynamic dark patterns with localisation labels. Therefore, in our work, we leverage the data collected through our app exploration module to fill the gap.

1) *App Collection*: We collected 350 trending apps from Google Play Store across 33 app categories, and crawled their metadata including ratings, downloads numbers, app description, app category, app name, app package name. We then use app package name to obtain their latest app package from third-party websites such as AppCombo and AppMirror. Meantime, we saved the app version and app files for future replication. After that, we manually installed and tested each app to check if they are usable in emulator. We excluded game apps that leverage game engine like unity. We stopped until we obtained 105 usable apps. We randomly sampled 1 app from 5 different categories as a *withhold subset for RQ4*, and the rest 100 apps are used in RQ1-RQ3. We notice that most apps require email or phone number verification to register accounts, which are currently not supported by our system and are out of our scope. Therefore, for each app, we first register an account and save the account information for further usage. Such information can be easily provided by the app provider.

2) *UI Collection and Annotation*: We ran our app exploration module on the 100 collected apps and obtained 45,292 UIs. After removing duplicates, we were left with 8,408 unique UIs. To maintain the sequence of explored UIs during

annotation, we included some duplicate UIs, resulting in a total of 19,722 UIs that need to be annotated. Given the large scale of data, we followed the strategies of Di et. al [5] to only annotate UIs that contain unique dark pattern instances, i.e., if the same instance appear before, we would not annotate it.

AppRay-Dark: To conduct annotation, two of the authors first discussed and went through the taxonomy and examples [5], [12], [13] to get a commonsense of the definition of deceptive patterns. They then annotated these 19,722 UIs separately by adding the location and types of the identified instances using the open-source tool LabelImg [28]. We modified LabelImg to show the action on the the UI to assist annotation. For dynamic dark patterns, we added a linker (i.e. a digit) to indicate the connection between pages. After that, we merged the annotations and went through the discrepancies. If the consensus can not be made, we grouped them and involved a third author to have a discussion on that. As a result, we obtained 2,185 unique deceptive pattern instances of 18 types from 876 UIs across 97 apps. Among these instances, 149 of them are related to multiple UIs (i.e. dynamic dark patterns) from 48 apps. We denoted this dataset as AppRay-Dark. This dataset will be used to answer RQ1 and RQ2. We reported the distribution of each deceptive pattern types in Table III.

AppRay-Light: Apart from that, we randomly sampled five consecutive sequences of UIs (length=3) that do not have annotated dark pattern instances from each app. The aim of this dataset is to assess the performance of our tool in reporting false positives while preserving the sequential information. Two of the authors went through these samples, and annotate whether they contain dark patterns or not. In total, we sampled 1,469 UIs, and ended with 871 benign UIs. We denoted this dataset as AppRay-Light. This dataset will be used to answer RQ3.

Given that our detector requires training, we splitted the data into five folds based on the app level, i.e., the instances from the same app will be allocated to a same split/fold. We perform 5-fold cross-validation in all the experiments.

VI. EXPERIMENTS

A. RQ1: Effectiveness of each module in AppRay

This section aims to measure the contribution and effectiveness of each module in our AppRay. We consider the following sub-questions:

- **RQ1.1 App Exploration Module:** How effective is the proposed technique in collecting UIs?
- **RQ1.2 Dark Pattern Detector:** How is the performance of AppRay’s detection part? We conducted an ablation study to examine the contributions of each sub-module.

1) *RQ1.1: Effectiveness of App Exploration Module:* This section assessed the performance of our app exploration module introduced in Section IV-A. We considered two sub-questions:

- **RQ1.1.1:** How effective is the LLM-based app navigator in completing the tasks?

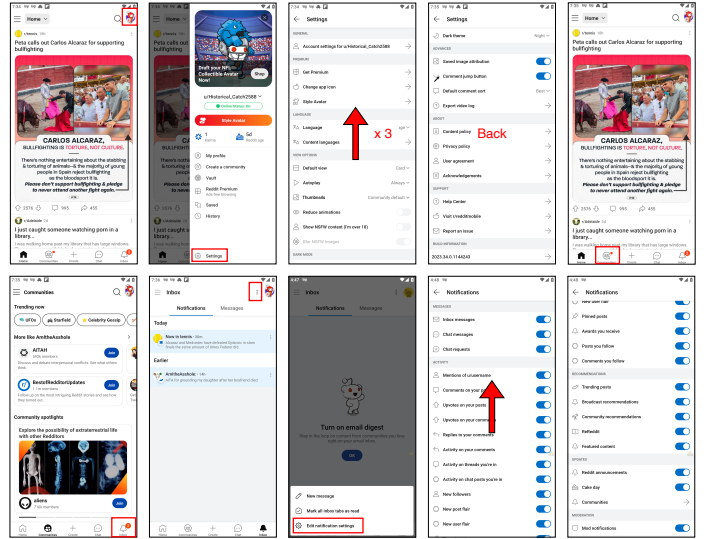

Fig. 4. Our LLM-based task-oriented app navigator employs a trial-and-error strategy to perform Task 3 in Reddit app.

- **RQ1.1.2:** How effective is the proposed technique in collecting UIs from apps?

Setup: We used the 100 apps collected in Section V-B1 in this RQ. For *RQ1.1.1*, We ran all tasks in Table I in these apps using the LLM task-oriented app exploration module. We adopted *Task Completion Rate* to evaluate whether our approach can successfully finish a task. We manually examined each task to see if it is completed or not. Note that whether the task is completed or not is not a key factor in our proposed system. The key goal here is to explore more UI status by logically using the app. For *RQ1.1.2*, We further ran Fastbot on these apps to collect more UIs. Two ablations are considered in this RQ, i.e., Fastbot only and LLM only. We adopt number of unique UI status and UI activity as the metrics.

Results for RQ1.1.1: Among 100 apps, we in total ran 556 tasks, with 11.5 steps on average for each task. The task completion rate is 75.14%, which shows that our approach has certain capabilities to perform dark pattern sensitive tasks. As seen in Table I, the detailed completion rate for T1, T2, T3, T4, T5 and T6 are 56.41%, 78.21%, 82.83%, 84.0%, 83.33%, 30.0% and 58.11% respectively. We observed that our tool has the capabilities to perform tasks in a logical way. For some tasks, it can immediately figure out the relevant UI elements to interact³. Apart from these straight-forward interaction traces, for apps that have different or more complex interaction ways, our tool can also locate the target page via a trial-and-error strategy. This behaviour is similar to human when users are not familiar with the apps. For example, in Figure 4, our tool first goes to the setting page and fail to find the notification setting. Then it goes back, and navigate to other tabs, and finally find the notification setting under the Inbox tab. The main failure reasons are due to missing information in view hierarchy [29], email/phone verification code requirement. Our tool also identified a usability issue during the exploration.

³More examples can be found in supplementary material.

More details on successful and failure reasons can be seen in supplementary materials.

Results for RQ1.1.2: Among these 100 apps, GPT4 performed 6,342 actions and collected 2,575 unique UIs (Mean=25.75, Std=9.73) from 668 activities (Mean=6.68, Std=4.05) and FastBot2 performed in total 33,649 actions and collected 8,680 unique UIs (Mean=59.86, Std=41.51) from 733 activities (Mean=7.33, Std=6.4), and We merged the collected UIs from both modules, and obtained 8,680 unique UIs (Mean=86.8, Std=46.76) from 1,135 activities (Mean=11.35, Std=8.33). Among the 8,680 unique UIs, 1.82% are visited by both modules, 69.37% are unique from FastBot2, and 28.81% are unique from GPT4. Among the 1,135 activities, 23.44% are visited by both modules, 41.15% are unique from FastBot2, and 35.42% are unique from GPT4. From these statistics, we can see that these two modules can complement each other. Fastbot2 is fast and effective, good at collecting many UIs in a short time in an efficient and low-cost way, while GPT4 can go deeper with logical exploration solution and explore unique UI pages.

2) *RQ1.2: Effectiveness of Detector Module:* To understand the effectiveness of each sub-module in our component-based detector (Section IV-B), we conducted an ablation study which aims to evaluate the contributions of different components in our multi-label classification dark pattern detector. It includes an image embedding pipeline, a text embedding pipeline, and a final MLP classifier. Additionally, the study will also assess different optimization methods such as data augmentation, contrastive learning, and class weights. By systematically removing or modifying one factor at a time, we will observe its impact on the overall model performance. Note that we will report the overall results of our detector module in Section VI-B comparing with baselines.

Setup: We utilized the AppRay-Dark dataset, as described in Section V-B2, to evaluate the following ablation variants. The dataset includes full UI images, sub-images of individual elements, and the text contained within those elements. If an element does not contain any text, it is assigned the placeholder “This element does not contain texts.” The data inputs consist of a list of a combination of sub-images, full UI images, and the corresponding text for examination. Each model variant and ablation was trained and tested using the same data split with 5-fold cross-validation. We considered 5 ablation variants, namely **AppRay-ResNet50**, **AppRay-BERT**, **AppRay-RB**, **AppRay-RB+DA**, **AppRay-RB+DA+NS**, and our full model termed as **AppRay-RB+DA+NS+CW**, **AppRay-ResNet50** and **AppRay-BERT** mean the model only use ResNet50 or BERT-based pipeline. **AppRay-RB** indicates the use of both pipelines but do not employ any specific strategy. “DA” stands for data augmentation, “NS” indicates negative sampling with contrastive learning, and “CW” refers to class weighting.

Evaluation metrics: We use precision, recall and F1-score as metrics to evaluate the performance. Specifically, *Precision* is calculated by $Precision = TP / (TP + FP)$, where true positive (TP) indicate the detection is classified

TABLE II
RESULTS FOR ABLATION STUDIES.

Method	Micro Average			Macro Average		
	Precision	Recall	F1	Precision	Recall	F1
AppRay-BERT	0.837	0.805	0.821	0.879	0.729	0.758
AppRay-ResNet50	0.773	0.845	0.808	0.833	0.628	0.640
AppRay-RB	0.867	0.835	0.851	0.797	0.707	0.722
+DA	0.897↑	0.859↑	0.877↑	0.813↑	0.752↑	0.767↑
+DA+NS	0.906↑	0.881↑	0.893↑	0.874↑	0.734	0.770↑
+DA+NS+CW	0.846	0.879	0.852	0.869	0.844↑	0.848↑

as the corrected dark pattern type and false positive (FP) means the detection is wrong predicted. Recall is calculated by $Recall = TP / (TP + FN)$, where FN indicates the ground truth elements that should be predicted but wrongly classified by our model. Finally, F1-score is computed by the harmonic mean of the precision and recall, i.e., $F1-Score = 2 \times Precision \times Recall / (Precision + Recall)$. We calculate the micro average and macro average for all types to illustrate the overall performance.

Results: As seen in Table II, it compares the performance of different model variations in terms of both micro and macro average metrics, including Precision, Recall, and F1-score. AppRay-BERT model shows strong micro-average performance, with a F1-score of 0.821. AppRay-ResNet50 also demonstrates the value of image-based approaches. The combination of both BERT and ResNet50 modules yield a better micro average performance. The addition of each training strategy gradually boost the performance of the dark pattern detector, with AppRay-DA-NS achieves the highest scores across all three micro-average metrics: Precision (0.906), Recall (0.881), and F1-score (0.893). This indicates that the combination of data augmentation and negative sampling with contrastive learning significantly improves the model capability. AppRay-Detector achieves the highest macro-average F1-score (0.848) and Recall (0.844), which indicates its consistent performance across all classes, even those with fewer instances. This suggests that Class Weight helps solve the problem of class imbalance and the highest F1 score in macro-average metric shows that it performs well on minority classes of dark patterns.

B. RQ2: How effective is the proposed method in detecting dark patterns?

In this RQ, we used **AppRay-Dark** to evaluate the performance of our dark pattern detection modules.

Baselines and Metrics: We considered two baselines, UI-Guard [13] and AidUI [12]. Both methods first use some visual techniques to detect UI elements and their attributes on the screenshots, and then use their derived rules to examine the existence of dark patterns. Specifically, **UIGuard** uses Faster-RCNN and Paddle-OCR to detect UI elements and their text contents on the screenshot, and then adopt other computer vision techniques to obtain color and grouping information of the UI elements. Finally, they examine the existence of dark pattern by using rule-based techniques. **AidUI** instead adopt UIED [30], Google OCR and a classifier to obtain the UI element and their text contents. They then classify the color of UI elements into three types, brighter, darker and normal, and

conduct spatial analysis to understand the spatial relationship among UI elements. Finally, they also consider rule-based techniques to determine the existence of dark patterns. We adopted the same metrics, precision, recall and F1-score as mentioned in Section VI-A2.

Results: Table III shows the performance of AppRay, AidUI and UIGuard. Overall, our AppRay delivers exceptional performance in detecting dark patterns in UIs, achieving micro/macro-average precision, recall, and F1 scores of 0.77/0.65, 0.76/0.62, and 0.76/0.62 respectively. To ensure a fair comparison, we evaluated AppRay’s performance relative to the types supported by UIGuard and AidUI. For types supported by AidUI, our method achieved precision, recall, and F1 scores of 0.69/0.54, 0.78/0.56, and 0.73/0.54, marking improvements of 509.14%/349.51% respectively over AidUI in terms of micro/macro average F1 scores. For types supported by UIGuard, our method achieved precision, recall, and F1 scores of 0.70/0.67, 0.81/0.69, and 0.75/0.66, with corresponding increases of 149.22%/165.84% compared to UIGuard in terms of micro/macro average F1 scores. These results demonstrate the superior performance of our proposed techniques.

In terms of detailed type performance, our method significantly outperforms existing approaches. By considering multiple pages, our approach can more accurately identify true nagging dark patterns compared to existing methods. For instance, while the existing methods, AidUI and UIGuard, may classify a pop-up rating UI page as a nagging dark pattern—assuming it nags users to rate the app—our method takes into account the previous UI and user actions, which can reveal such assessments as false positives if users deliberately clicked a rate action. Similarly, for nagging ads and disguised ads, existing rule-based methods struggle to distinguish between them due to their over reliance on rigid, unreliable rules. Our analysis of their confusion matrices reveals that among the instances identified as nagging, 50% are misclassified as disguised ads by AidUI and 44.4% by UIGuard. Our method, employing a contrastive learning-based approach, shows a misclassification rate of 11.3%, demonstrating its ability to discern the subtle differences between these two types of dark patterns.

C. RQ3: How often does AppRay detect false positives in UIs that do not contain dark patterns?

We utilized the **AppRay-Light** dataset to measure the rate of false positives. The average rates at which benign UIs are misidentified as malicious UIs with dark patterns by AppRay, AidUI, and UIGuard are 12%, 14%, and 6%, respectively.

D. RQ4: How is the overall performance compared to manual exploration and identification?

This research question aims to evaluate the usefulness of the proposed technique.

Setup: We randomly selected 5 apps from different app categories as mentioned in Section V-B2. We invited two experts on dark patterns to conduct this study. Both of them are

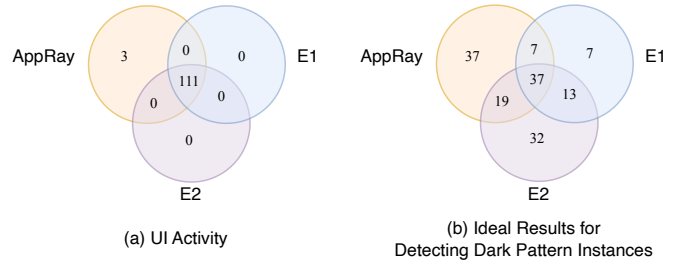

Fig. 5. The Venn diagrams for Expert 1, Expert 2 and AppRay in collected UI activities and identified dark patterns.

asked to conduct an inspection walk-through of these popular apps to obtain as many UIs as possible while exploring the app main features following the recording methodology in Di et al. [5]. In detail, each app is explored by one of the researchers for 15 minutes, and the researchers performed the tasks as mentioned in Table I. They were also encouraged to use the apps for their intended usage. After manually obtaining the UIs from apps, one of the authors manually labeled the potential dark patterns in the collected UIs to ensure annotation consistency as in Section V-B2. On the other hand, we ran our AppRay to gather the UIs and perform detection on the collected UIs. We compare the results obtained from the experts and AppRay. We also annotated our collected UIs to see the effectiveness of our UI exploration module.

Results: In total, AppRay collected in total 2,726 UIs from these 5 apps. After removing duplicates, we obtained 522 unique UIs from 114 Activities, and detected xxx unique dark pattern instances. Upon annotation on these collected UIs, we obtained 100 dark pattern instances from 17 types. For the human experts, E1 collected in total collected 369 unique UIs from 111 unique activity, and identified 64 unique dark pattern instances of 11 dark pattern types. E2 collected in total collected 404 unique UIs from 111 unique activity, and identified 101 unique dark pattern instances of 10 dark pattern types. As illustrated in Figure 5, AppRay, E1, and E2 exhibit significant overlaps in visited UI activity.

VII. CONCLUSION

In this paper, we take the first step in addressing the problem of dark pattern detection from app exploration to revelation, encompassing both dynamic and static dark patterns. We propose and implement AppRay, a fully automated tool that leverages LLMs and automated testing tools to explore app UIs and detect dark patterns, considering the relationships between multiple UIs. Additionally, we contribute large datasets, AppRay-Dark and AppRay-Light, covering dynamic dark patterns and preserving the UI sequential information. Our experiments demonstrate the superior performance of AppRay, showing a significant improvement compared to existing methods. Furthermore, our user study confirms the usefulness of our work in assisting human experts to automatically identify dark patterns in apps.

TABLE III
PERFORMANCE OF APPRAY AND BASELINES IN THE APPRAY-DARK DATASET.

DP Category	#GT (All)	AppRay			AidUI			UIGuard		
		Precision	Recall	F1-Score	Precision	Recall	F1-Score	Precision	Recall	F1-Score
Nagging	190	0.87	0.64	0.74	0.20	0.09	0.12	0.44	0.11	0.18
Bait And Switch	67	0.4	0.17	0.24	-	-	-	-	-	-
Forced Continuity	148	0.69	0.84	0.76	-	-	-	0.0	0.0	0.0
Roach Motel	6	1.0	0.67	0.8	-	-	-	-	-	-
Intermediate Currency	41	0.78	0.88	0.82	-	-	-	-	-	-
Social Pyramid	15	0.88	0.88	0.88	-	-	-	1.0	0.71	0.83
Privacy Zuckering	248	0.76	0.96	0.85	-	-	-	1.0	0.29	0.45
Gamification	10	0	0	0	0.0	0.0	0.0	-	-	-
ForcedAction-General	160	0.63	0.59	0.61	-	-	-	1.00	0.22	0.36
Preselection	681	0.69	0.92	0.79	0.12	0.03	0.05	0.80	0.23	0.35
Hidden Information	307	0.82	0.89	0.86	-	-	-	-	-	-
Toying with Emotion	68	0.63	0.63	0.63	0.53	0.42	0.47	-	-	-
False Hierarchy	83	0.46	0.37	0.41	0.00	0.00	0.00	0.00	0.00	0.00
Disguised Ads	107	0.55	0.82	0.66	0.05	0.10	0.07	0.07	0.10	0.08
Tricked Questions	7	0	0	0	-	-	-	-	-	-
Interface Interference - General	47	0.63	0.26	0.37	-	-	-	0.00	0.00	0.00
Micro Avg.	2,185	0.77	0.76	0.76	0.20	0.08	0.12	0.62	0.19	0.30
Macro Avg.	2,185	0.65	0.62	0.62	0.15	0.11	0.12	0.48	0.18	0.25

REFERENCES

- [1] H. Cho, D. Choi, D. Kim, W. J. Kang, E. K. Choe, and S.-J. Lee, "Reflect, not regret: Understanding regretful smartphone use with app feature-level analysis," *Proceedings of the ACM on human-computer interaction*, vol. 5, no. CSCW2, pp. 1–36, 2021.
- [2] A. Monge Roffarello, K. Lukoff, and L. De Russis, "Defining and identifying attention capture deceptive designs in digital interfaces," in *Proceedings of the 2023 CHI Conference on Human Factors in Computing Systems*, 2023, pp. 1–19.
- [3] C. M. Gray, Y. Kou, B. Battles, J. Hoggatt, and A. L. Toombs, "The dark (patterns) side of ux design," in *Proceedings of the 2018 CHI conference on human factors in computing systems*, 2018, pp. 1–14.
- [4] C. M. Gray, C. Santos, N. Bielova, M. Toth, and D. Clifford, "Dark patterns and the legal requirements of consent banners: An interaction criticism perspective," in *Proceedings of the 2021 CHI Conference on Human Factors in Computing Systems*, 2021, pp. 1–18.
- [5] L. Di Geronimo, L. Braz, E. Fregnan, F. Palomba, and A. Bacchelli, "Ui dark patterns and where to find them: a study on mobile applications and user perception," in *Proceedings of the 2020 CHI conference on human factors in computing systems*, 2020, pp. 1–14.
- [6] H. Brignull. (2010) Deceptive design. [Online]. Available: <https://www.darkpatterns.org/>
- [7] A. Mathur, G. Acar, M. J. Friedman, E. Lucherini, J. Mayer, M. Chetty, and A. Narayanan, "Dark patterns at scale: Findings from a crawl of 11k shopping websites," *Proceedings of the ACM on Human-Computer Interaction*, vol. 3, no. CSCW, pp. 1–32, 2019.
- [8] S. Hidaka, S. Kobuki, M. Watanabe, and K. Seaborn, "Linguistic dead-ends and alphabet soup: Finding dark patterns in japanese apps," in *Proceedings of the 2023 CHI Conference on Human Factors in Computing Systems*, 2023, pp. 1–13.
- [9] M. Kowalczyk, J. T. Gunawan, D. Choffnes, D. J. Dubois, W. Hartzog, and C. Wilson, "Understanding dark patterns in home iot devices," in *Proceedings of the 2023 CHI Conference on Human Factors in Computing Systems*, 2023, pp. 1–27.
- [10] T. T. Nguyen, M. Backes, and B. Stock, "Freely given consent? studying consent notice of third-party tracking and its violations of gdpr in android apps," in *Proceedings of the 2022 ACM SIGSAC Conference on Computer and Communications Security*, 2022, pp. 2369–2383.
- [11] A. Chaudhary, J. Saroha, K. Monteiro, A. G. Forbes, and A. Parnami, "'are you still watching?': Exploring unintended user behaviors and dark patterns on video streaming platforms," in *Designing Interactive Systems Conference*, 2022, pp. 776–791.
- [12] S. H. Mansur, S. Salma, D. Awofisayo, and K. Moran, "Aidui: Toward automated recognition of dark patterns in user interfaces," in *2023 IEEE/ACM 45th International Conference on Software Engineering (ICSE)*. IEEE, 2023, pp. 1958–1970.
- [13] J. Chen, J. Sun, S. Feng, Z. Xing, Q. Lu, X. Xu, and C. Chen, "Unveiling the tricks: Automated detection of dark patterns in mobile applications," *arXiv preprint arXiv:2308.05898*, 2023.
- [14] J. Gunawan, A. Pradeep, D. Choffnes, W. Hartzog, and C. Wilson, "A comparative study of dark patterns across web and mobile modalities," *Proceedings of the ACM on Human-Computer Interaction*, vol. 5, no. CSCW2, pp. 1–29, 2021.
- [15] L. Gak, S. Olojo, and N. Salehi, "The distressing ads that persist: Uncovering the harms of targeted weight-loss ads among users with histories of disordered eating," *arXiv preprint arXiv:2204.03200*, 2022.
- [16] A. Sergeeva, B. Rohles, V. Distler, and V. Koenig, "'we need a big revolution in email advertising': Users' perception of persuasion in permission-based advertising emails," in *Proceedings of the 2023 CHI Conference on Human Factors in Computing Systems*, 2023, pp. 1–21.
- [17] K. Bongard-Blanchy, A. Rossi, S. Rivas, S. Doublet, V. Koenig, and G. Lenzini, "' i am definitely manipulated, even when i am aware of it. it's ridiculous!'—dark patterns from the end-user perspective," in *Designing Interactive Systems Conference 2021*, 2021, pp. 763–776.
- [18] K. Kollnig, S. Datta, and M. Van Kleek, "I want my app that way: Reclaiming sovereignty over personal devices," in *Extended Abstracts of the 2021 CHI Conference on Human Factors in Computing Systems*, 2021, pp. 1–8.
- [19] S. Datta, K. Kollnig, and N. Shadbolt, "Greasevision: Rewriting the rules of the interface," *arXiv preprint arXiv:2204.03731*, 2022.
- [20] H. Brignull. (2010) Twitter: Deceptive design@darkpatterns. [Online]. Available: <https://twitter.com/darkpatterns>
- [21] J. Aagaard, M. E. C. Knudsen, P. Bækgaard, and K. Doherty, "A game of dark patterns: Designing healthy, highly-engaging mobile games," in *CHI Conference on Human Factors in Computing Systems Extended Abstracts*, 2022, pp. 1–8.
- [22] OpenAI, "Gpt-4 technical report," *arXiv preprint arXiv:2303.08774*, 2023.
- [23] Z. Lv, C. Peng, Z. Zhang, T. Su, K. Liu, and P. Yang, "Fastbot2: Reusable automated model-based gui testing for android enhanced by reinforcement learning," in *Proceedings of the 37th IEEE/ACM International Conference on Automated Software Engineering*, 2022, pp. 1–5.
- [24] S. Y. Feng, V. Gangal, J. Wei, S. Chandar, S. Vosoughi, T. Mitamura, and E. H. Hovy, "A survey of data augmentation approaches for NLP," *CoRR*, vol. abs/2105.03075, 2021. [Online]. Available: <https://arxiv.org/abs/2105.03075>
- [25] S. Yang, W. Xiao, M. Zhang, S. Guo, J. Zhao, and F. Shen, "Image data augmentation for deep learning: A survey," 2023. [Online]. Available: <https://arxiv.org/abs/2204.08610>
- [26] A. Jaiswal, A. R. Babu, M. Z. Zadeh, D. Banerjee, and F. Makedon, "A survey on contrastive self-supervised learning," *CoRR*, vol. abs/2011.00362, 2020. [Online]. Available: <https://arxiv.org/abs/2011.00362>
- [27] J. Robinson, C. Chuang, S. Sra, and S. Jegelka, "Contrastive learning with hard negative samples," *CoRR*, vol. abs/2010.04592, 2020. [Online]. Available: <https://arxiv.org/abs/2010.04592>
- [28] tzutalin, "Github - tzutalin/labelimg," <https://github.com/tzutalin/labelimg>, 2021, accessed: 24/09/2021.

- [29] J. Chen, C. Chen, Z. Xing, X. Xu, L. Zhu, G. Li, and J. Wang, "Unblind your apps: Predicting natural-language labels for mobile gui components by deep learning," in *Proceedings of the ACM/IEEE 42nd International Conference on Software Engineering*, 2020, pp. 322–334.
- [30] J. Chen, M. Xie, Z. Xing, C. Chen, X. Xu, L. Zhu, and G. Li, "Object detection for graphical user interface: Old fashioned or deep learning or a combination?" in *proceedings of the 28th ACM joint meeting on European Software Engineering Conference and Symposium on the Foundations of Software Engineering*, 2020, pp. 1202–1214.