

EXISTENCE THEOREMS OF FOLD-MAPS

YOSHIFUMI ANDO *

Abstract

Let N and P be smooth manifolds of dimensions n and p ($n \geq p \geq 2$) respectively. A smooth map having only fold singularities is called a fold-map. We will study conditions for a continuous map $f : N \rightarrow P$ to be homotopic to a fold-map from the viewpoint of the homotopy principle. By certain homotopy principles for fold-maps, we prove that if there exists a fiberwise epimorphism $TN \oplus \theta_N \rightarrow TP$ covering f , then there exists a fold-map homotopic to f , where θ_N is the trivial line bundle. We also give an additional condition for finding a fold-map which folds only on a finite number of spheres of dimension $p - 1$.

Introduction

Let N and P be smooth (C^∞) manifolds of dimensions n and p respectively with $n \geq p \geq 2$. We say that a smooth map germ of (N, x) into (P, y) has a singularity of fold type at x if it is written as $(x_1, \dots, x_n) \mapsto (x_1, \dots, x_{p-1}, \pm x_p^2 \pm \dots \pm x_n^2)$ under suitable local coordinate systems on neighborhoods of $x \in N$ and $y \in P$. A smooth map $f : N \rightarrow P$ is called a *fold-map* if it has only fold singularities. We will study conditions for a given continuous map to be homotopic to a fold-map from the viewpoint of the homotopy principle. Main results of this paper are the following. Let TN , TP and θ_N be the tangent bundles of N , P and the trivial bundle $N \times \mathbf{R}$ respectively.

Theorem 0.1. *Let $n \geq p \geq 2$. Let $f : N \rightarrow P$ be a continuous map. Assume that there exists a fiberwise epimorphism $h : TN \oplus \theta_N \rightarrow TP$ covering f . Then there exists a fold-map $g : N \rightarrow P$ homotopic to f .*

If $n - p + 1$ is odd, then we can easily prove that the converse also holds (Lemma 3.1).

Recently Saeki[Sa2] has given a complete characterization of those 4-dimensional closed orientable manifolds which admit fold-maps into \mathbf{R}^3 . The converse of Theorem 0.1 does not hold for the dimension pair $(n, p) = (4, 3)$.

Corollary 0.2. *Let $n \geq p \geq 2$. Let $f : N \rightarrow P$ be a continuous map. If the structure group of $TN \oplus \theta_N$ is reduced to $O(n - p) \times E_{p+1}$ (this refers to E_{p+1} for the case $n = p$) and if TP is stably trivial, then there exists a fold-map $g : N \rightarrow P$ homotopic to f .*

Here, $O(k)$ is the orthogonal group of degree k and E_k is the unit matrix of degree k . We have another existence theorem of fold-maps.

Theorem 0.3. *Let $n \geq p \geq 2$. Let $f : N \rightarrow P$ be a continuous map. Assume that there exists a vector bundle ξ of dimension $n - p$ over N such that TN is stably equivalent to the vector bundle $f^*(TP) \oplus \xi$. Then f is homotopic to a fold-map $g : N \rightarrow P$ which folds exactly on the boundaries of a finite number of disjointly embedded disks of dimension p within an embedded disk of dimension p in N .*

Corollary 0.4. *Let $n \geq p \geq 2$. Let $f : N \rightarrow P$ be a continuous map. If TN and TP are stably trivial, then there exists a fold-map $g : N \rightarrow P$ homotopic to f which folds exactly on the boundaries of a finite number of disjointly embedded disks of dimension p within an embedded disk of dimension p in N .*

*This research was partially supported by Grant-in-Aid for Scientific Research (No. 11640081), Ministry of Education, Science and Culture, Japan.

Corollary 0.4 should be compared with [E2, 5.1D and 5.4]. For example, any continuous map $f : S^n \rightarrow S^p$ is homotopic to such a fold-map (Corollary 3.4).

Theorem 0.1 is a simple consequence of Theorem 0.5 below, while we need the Phillips Submersion Theorem ([P]) and a further tool in the proof of Theorem 0.3 to apply Theorem 2.4.

We explain the terminology *homotopy principle* used in [G2]. In the 2-jet space $J^2(n, p)$, let $\Sigma^{n-p+1,0}(n, p)$ be the subspace of all jets of germs with fold singularities at the origin and let $\Omega^{n-p+1,0}(n, p)$ be the union of all jets of regular germs and $\Sigma^{n-p+1,0}(n, p)$. In the 2-jet space $J^2(N, P)$ with projection $\pi_N^2 \times \pi_P^2 : J^2(N, P) \rightarrow N \times P$, let $\Sigma^{n-p+1,0}(N, P)$ and $\Omega^{n-p+1,0}(N, P)$ be its subbundles associated with $\Sigma^{n-p+1,0}(n, p)$ and $\Omega^{n-p+1,0}(n, p)$ respectively. A smooth map $f : N \rightarrow P$ is a fold-map if and only if the image of j^2f is contained in $\Omega^{n-p+1,0}(N, P)$ and transverse to $\Sigma^{n-p+1,0}(N, P)$. Let $C_\Omega^\infty(N, P)$ denote the space consisting of all fold-maps equipped with the C^∞ -topology. Let $\Gamma(N, P)$ denote the space consisting of all continuous sections of the fiber bundle $\pi_N^2 | \Omega^{n-p+1,0}(N, P) : \Omega^{n-p+1,0}(N, P) \rightarrow N$ equipped with the compact-open topology. Then there exists a continuous map

$$j_\Omega : C_\Omega^\infty(N, P) \rightarrow \Gamma(N, P)$$

defined by $j_\Omega(f) = j^2f$. It follows from the well-known theorem due to Gromov[G1] that if N is a connected open manifold, then j_Ω is a weak homotopy equivalence. This property is called the homotopy principle.

The existence problem of fold-maps has been first dealt with in [T] and [L1] in dimensions $n \geq p = 2$ from a different viewpoint. In [E1] and [E2] Eliášberg has proved a certain homotopy principle for fold-maps in the existence level for closed smooth manifolds.

We will prove the following theorem in the existence level (see also Theorem 2.4) in §2, where two theorems [G1, 4.1.1 Theorem] and [E2, 4.7 Theorem] will play important roles.

Theorem 0.5. *Let $n \geq p \geq 2$. Let N and P be connected manifolds of dimensions n and p respectively with $\partial N = \emptyset$. Let C be a closed subset of N . Let s be a section of $\Gamma(N, P)$ such that there exists a fold-map g defined on a neighborhood of C into P , where $j^2g = s$. Then there exists a fold-map $f : N \rightarrow P$ such that j^2f is homotopic to s relative to C by a homotopy h_λ in $\Gamma(N, P)$ with $h_0 = s$ and $h_1 = j^2f$.*

Most of the results in the case $n = p$ of this paper except for Theorems 0.3, 2.4 and Proposition 5.7 have already been proved in [An3].

We refer to [B-R], [S-S] and its references in low dimensions (3, 2) and (4, 3) in another line of investigation concerning the existence problem of fold-maps of special generic type, which are closely related to the differentiable structures of manifolds.

In §1 we explain well-known results concerning fold singularities. In §2 we state Theorem 2.4, which is another type of homotopy principle for fold-maps, and Proposition 2.5 without proofs, and prove Theorem 0.5 by using them. In §3 we prove Theorems 0.1 and 0.3 by using Theorems 0.5 and 2.4. In §4 we prove Theorem 2.4. In §5 we prove Proposition 2.5.

The author would like to thank the referee for his kind and helpful comments, which improved the paper.

1 Preliminaries

Throughout the paper all manifolds are smooth of class C^∞ . Maps are basically continuous, but may be smooth (of class C^∞) if so stated. We always work in dimensions $n \geq p \geq 1$.

Given a fiber bundle $\pi : E \rightarrow X$ and a subset C in X , we denote $\pi^{-1}(C)$ by $E|_C$. Let $\pi' : F \rightarrow Y$ be another fiber bundle. A map $\tilde{b} : E \rightarrow F$ is called a fiber map over a map $b : X \rightarrow Y$ if $\pi' \circ \tilde{b} = b \circ \pi$ holds. The restriction $\tilde{b}|(E|_C) : E|_C \rightarrow F$ (or $F|_{b(C)}$) is denoted by $\tilde{b}|_C$. In particular, for a point $x \in X$, $E|_x$ and $\tilde{b}|_x$ are simply denoted by E_x and $\tilde{b}_x : E_x \rightarrow F_{b(x)}$ respectively. When E and F are vector bundles over $X = Y$, $\text{Hom}(E, F)$ denotes the vector bundle over X with fiber $\text{Hom}(E_x, F_x)$, $x \in X$, which consists of all homomorphisms $E_x \rightarrow F_x$. A fiberwise homomorphism, epimorphism and monomorphism $E \rightarrow F$ are

simply called homomorphism, epimorphism and monomorphism respectively. The trivial bundle $X \times \mathbf{R}^k$ is denoted by θ_X^k . In particular, θ_X^1 is often written as θ_X .

We review well-known results about fold singularities (see [B], [L2]). Let $J^k(N, P)$ denote the k -jet space of manifolds N and P . Let π_N^k and π_P^k be the projections mapping a jet to its source and target respectively. The map $\pi_N^k \times \pi_P^k : J^k(N, P) \rightarrow N \times P$ induces a structure of a fiber bundle with structure group $L^k(p) \times L^k(n)$, where $L^k(m)$ denotes the group of all k -jets of local diffeomorphisms of $(\mathbf{R}^m, 0)$. The fiber $(\pi_N^k \times \pi_P^k)^{-1}(x, y)$ is denoted by $J_{x,y}^k(N, P)$.

Let $\pi_1^2 : J^2(N, P) \rightarrow J^1(N, P)$ be the canonical forgetting map. Let $\Sigma^i(N, P)$ denote the submanifold of $J^1(N, P)$ consisting of all 1-jets $z = j_x^1 f$ such that the kernel of $d_x f$ is of dimension i . Let $\Omega^{n-p+1}(N, P)$ denote the union of $\Sigma^{n-p}(N, P)$ and $\Sigma^{n-p+1}(N, P)$ in $J^1(N, P)$. We denote $(\pi_1^2)^{-1}(\Sigma^i(N, P))$ by the same symbol $\Sigma^i(N, P)$ if there is no confusion. For a 2-jet $z = j_x^2 f$ of $\Sigma^i(N, P)$, there has been defined the second intrinsic derivative $d_x^2 f : T_x N \rightarrow \text{Hom}(\text{Ker}(d_x f), \text{Cok}(d_x f))$. Let $\Sigma^{i,j}(N, P)$ denote the subbundle of $J^2(N, P)$ consisting of all jets $z = j_x^2 f$ such that $\dim(\text{Ker}(d_x f)) = i$ and $\dim(\text{Ker}(d_x^2 f | \text{Ker}(d_x f))) = j$. A jet of $\Sigma^{n-p+1,0}(N, P)$ will be called a fold jet. Let $\Omega^{n-p+1,0}(N, P)$ denote the union of $\Sigma^{n-p}(N, P)$ and $\Sigma^{n-p+1,0}(N, P)$ in $J^2(N, P)$. Then $\pi_N^2 \times \pi_P^2 | \Omega^{n-p+1,0}(N, P)$ induces a structure of an open subbundle of $\pi_N^2 \times \pi_P^2$. Let $J_{x,y}^k(N, P)$, $\Sigma_{x,y}^i(N, P)$, $\Omega_{x,y}^{n-p+1}(N, P)$, $\Sigma_{x,y}^{n-p+1,0}(N, P)$, and $\Omega_{x,y}^{n-p+1,0}(N, P)$ denote the respective fibers over (x, y) . In particular, we set $J^k(n, p) = J_{0,0}^k(\mathbf{R}^n, \mathbf{R}^p)$, $\Sigma^i(n, p) = \Sigma_{0,0}^i(\mathbf{R}^n, \mathbf{R}^p)$, $\Omega^{n-p+1}(n, p) = \Omega_{0,0}^{n-p+1}(\mathbf{R}^n, \mathbf{R}^p)$, $\Sigma^{n-p+1,0}(n, p) = \Sigma_{0,0}^{n-p+1,0}(\mathbf{R}^n, \mathbf{R}^p)$, and $\Omega^{n-p+1,0}(n, p) = \Omega_{0,0}^{n-p+1,0}(\mathbf{R}^n, \mathbf{R}^p)$.

Let π_N and π_P be the projections of $N \times P$ onto N and P respectively. We set

$$J^2(TN, TP) = \text{Hom}(\pi_N^*(TN), \pi_P^*(TP)) \oplus \text{Hom}(S^2(\pi_N^*(TN)), \pi_P^*(TP)) \quad (1.1)$$

over $N \times P$, where $S^2(\pi_N^*(TN))$ is the 2-fold symmetric product of $\pi_N^*(TN)$. If we provide N and P with Riemannian metrics, then the Levi-Civita connections induce the exponential maps $\exp_{N,x} : T_x N \rightarrow N$ and $\exp_{P,y} : T_y P \rightarrow P$. In dealing with the exponential maps we always consider the so called convex neighborhoods ([K-N]). We define the bundle map

$$J^2(N, P) \rightarrow J^2(TN, TP) \quad \text{over } N \times P \quad (1.2)$$

by sending $z = j_x^2 f \in J_{x,y}^2(N, P)$ to the 2-jet of $(\exp_{P,y})^{-1} \circ f \circ \exp_{N,x}$ at $\mathbf{0} \in T_x N$, which is regarded as an element of $J^2(T_x N, T_y P) (= J_{x,y}^2(TN, TP))$. The structure group of $J^2(TN, TP)$ is reduced to $O(p) \times O(n)$.

In this paper we often express an element of $J_{x,y}^2(N, P)$ as (α, β) for $\alpha \in \text{Hom}(T_x N, T_y P)$ and $\beta \in \text{Hom}(S^2(T_x N), T_y P)$. For a subspace V in $T_y P$, let $pr(V)$ be the orthogonal projection of $T_y P$ onto V . For an element $(\alpha, \beta) \in \Sigma_{x,y}^{n-p+1}(N, P)$, let β_α denote the homomorphism defined by

$$\beta_\alpha = pr(\text{Im}(\alpha)^\perp) \circ (\beta | S^2 \text{Ker}(\alpha)), \quad (1.3)$$

where the symbol \perp refers to the orthogonal complement. Under the identification (1.2), $\alpha \in J_{x,y}^1(N, P)$ lies in $\Sigma_{x,y}^i(N, P)$ if and only if $\dim \text{Ker}(\alpha) = i$, and $(\alpha, \beta) \in \Sigma_{x,y}^{n-p+1}(N, P)$ lies in $\Sigma_{x,y}^{n-p+1,0}(N, P)$ if and only if β_α is a non-singular quadratic form. Let ι be an integer such that $0 \leq \iota \leq [(n-p+1)/2]$ ($[a]$ refers to the greatest integer not exceeding a). Let $\Sigma^{n-p+1,0}(n, p)^\iota$ denote the subspace which consists of all elements $(\alpha, \beta) \in \Sigma^{n-p+1,0}(n, p)$ such that the index (the number of negative eigen values) of β_α is equal to ι or $n-p+1-\iota$ depending on the choice of the orientation of $\text{Im}(\alpha)^\perp$. Let $\Sigma^{n-p+1,0}(N, P)^\iota$ denote the subspace of $\Sigma^{n-p+1,0}(N, P)$ associated to $\Sigma^{n-p+1,0}(n, p)^\iota$.

By (1.1) and (1.2), $J^2(n, p)$ is canonically identified with

$$\text{Hom}(\mathbf{R}^n, \mathbf{R}^p) \oplus \text{Hom}(S^2 \mathbf{R}^n, \mathbf{R}^p) \quad (1.4)$$

under the canonical bases of \mathbf{R}^n and \mathbf{R}^p . For a jet $z = j_x^2 f \in J^2(\mathbf{R}^n, \mathbf{R}^p)$, we define π_J by $\pi_J(z) = j_0^2(l(-f(x)) \circ f \circ l(x))$, where $l(a)$ denotes the parallel translation defined by $l(a)(x) = x + a$. Let $\pi_\Omega :$

$\Omega^{n-p+1,0}(\mathbf{R}^n, \mathbf{R}^p) \rightarrow \Omega^{n-p+1,0}(n, p)$ be the restriction of π_J . We obtain the canonical diffeomorphisms

$$\pi_{\mathbf{R}^n}^2 \times \pi_{\mathbf{R}^p}^2 \times \pi_J : J^2(\mathbf{R}^n, \mathbf{R}^p) \rightarrow \mathbf{R}^n \times \mathbf{R}^p \times (\text{Hom}(\mathbf{R}^n, \mathbf{R}^p) \oplus \text{Hom}(S^2\mathbf{R}^n, \mathbf{R}^p)), \quad (1.5)$$

$$\pi_{\mathbf{R}^n}^2 \times \pi_{\mathbf{R}^p}^2 \times \pi_\Omega : \Omega^{n-p+1,0}(\mathbf{R}^n, \mathbf{R}^p) \rightarrow \mathbf{R}^n \times \mathbf{R}^p \times \Omega^{n-p+1,0}(n, p). \quad (1.6)$$

Furthermore, we always identify $\text{Hom}(\mathbf{R}^n, \mathbf{R}^p)$ with the space $M_{p \times n}$ of all $p \times n$ matrices and identify $\text{Hom}(S^2\mathbf{R}^n, \mathbf{R}^p)$ with the space of all p -tuples of $n \times n$ symmetric matrices throughout the paper.

Next we review the properties of the submanifolds $\Sigma^{n-p+1}(N, P)$ and $\Sigma^{n-p+1,0}(N, P)$ along the line of [B, §7]. Let \mathbf{D}' denote the induced bundle $(\pi_N^2)^*(TN)$ over $J^2(N, P)$. Recall the homomorphism

$$\mathbf{d}^1 : \mathbf{D}' \rightarrow (\pi_P^2)^*(TP) \quad \text{over } J^2(N, P),$$

which maps an element $\mathbf{v} = (z, \mathbf{v}') \in \mathbf{D}'_z$ with $z = j_x^2 f$ to $(z, d_x f(\mathbf{v}'))$. Here \mathbf{d}^1 is identified with a section of $\text{Hom}(\mathbf{D}', (\pi_P^2)^*(TP))$ over $J^2(N, P)$. Let \mathbf{K} and \mathbf{Q} be the kernel bundle and the cokernel bundle of \mathbf{d}^1 over $\Sigma^{n-p+1}(N, P)$ with $\dim \mathbf{K} = n - p + 1$ and $\dim \mathbf{Q} = 1$ respectively. Then we have the second intrinsic derivative $\mathbf{d}^2 : \mathbf{D}' \rightarrow \text{Hom}(\mathbf{K}, \mathbf{Q})$ over $\Sigma^{n-p+1}(N, P)$. Indeed, for $z = j_x^2 f \in \Sigma^{n-p+1}(N, P)$, the induced homomorphism $((j^2 f)^* \mathbf{d}^2)_x : ((j^2 f)^* \mathbf{D}')_x \rightarrow \text{Hom}(((j^2 f)^* \mathbf{K})_x, ((j^2 f)^* \mathbf{Q})_x)$ is nothing but the homomorphism induced from $d_x^2 f : T_x N \rightarrow \text{Hom}(\text{Ker}(d_x f), \text{Cok}(d_x f))$ by $(\pi_N^2)^*$ and $(\pi_P^2)^*$. As is explained in [B, p. 412], the second intrinsic derivative $\mathbf{d}^2|_{\mathbf{K}}$ is extended to the epimorphism

$$\mathbf{d}^2 : T(J^2(N, P))|_{\Sigma^{n-p+1}(N, P)} \rightarrow \text{Hom}(\mathbf{K}, \mathbf{Q}) \quad \text{over } \Sigma^{n-p+1}(N, P),$$

where \mathbf{K} is regarded as a subbundle of $T(J^2(N, P))|_{\Sigma^{n-p+1}(N, P)}$. Furthermore, on the subset of $\Sigma^{n-p+1}(N, P)$ consisting of all jets $z = j_x^2 f$ such that $d(j^2 f)$ is transverse to $\Sigma^{n-p+1}(N, P)$ at x , \mathbf{D}' is regarded as a subbundle of $T(J^2(N, P))|_{\Sigma^{n-p+1}(N, P)}$ by [B, Theorem 7.15] (see also another interpretation of [An3, §1]). It has been proved in [B, Lemma 7.13] that there exists an exact sequence

$$0 \longrightarrow T(\Sigma^{n-p+1}(N, P)) \xrightarrow{\subset} T(J^2(N, P))|_{\Sigma^{n-p+1}(N, P)} \xrightarrow{\mathbf{d}^2} \text{Hom}(\mathbf{K}, \mathbf{Q}) \longrightarrow 0.$$

Under these notations, a 2-jet $z \in \Sigma^{n-p+1}(N, P)$ lies in $\Sigma^{n-p+1,0}(N, P)$ if and only if $\mathbf{d}^2|_{\mathbf{K}_z}$ is an isomorphism. This implies that $T(\Sigma^{n-p+1}(N, P))_z \cap \mathbf{K}_z = \{0\}$ for any jet $z \in \Sigma^{n-p+1,0}(N, P)$. Hence $\mathbf{K}|_{\Sigma^{n-p+1,0}(N, P)}$ and $\text{Hom}(\mathbf{K}, \mathbf{Q})|_{\Sigma^{n-p+1,0}(N, P)}$ are isomorphic to the normal bundle of $\Sigma^{n-p+1,0}(N, P)$ in $J^2(N, P)$.

Let $C_\Omega^\infty(N, P)$ and $\Gamma(N, P)$ denote the spaces defined in Introduction with the continuous map $j_\Omega : C_\Omega^\infty(N, P) \rightarrow \Gamma(N, P)$. Let $\Gamma^{tr}(N, P)$ denote the subspace of $\Gamma(N, P)$ consisting of all sections s such that s is smooth on some neighborhood of $s^{-1}(\Sigma^{n-p+1,0}(N, P))$ and that s is transverse to $\Sigma^{n-p+1,0}(N, P)$. Throughout the paper, $s^{-1}(\Sigma^{n-p+1,0}(N, P))$ is denoted by $S(s)$. Let $K(s)$ and $Q(s)$ denote $(s|S(s))^*(\mathbf{K})$ and $(s|S(s))^*(\mathbf{Q})$ respectively. Let $d^1 s : TN \rightarrow (\pi_P^2 \circ s)^*(TP)$ and $d^2 s : TN|_{S(s)} \rightarrow \text{Hom}(K(s), Q(s))$ over $S(s)$ denote the homomorphisms induced from \mathbf{d}^1 and $\mathbf{d}^2|_{\mathbf{D}'}$ by s respectively. The map $d^2 s$ induces a symmetric homomorphism $q(s) : S^2 K(s) \rightarrow Q(s)$, which we call the quadratic form associated with $d^2 s$.

Then $ds|(TN|_{S(s)}) : TN|_{S(s)} \rightarrow T(J^2(N, P))|_{\Sigma^{n-p+1,0}(N, P)}$ canonically induces the homomorphism

$$d(s)_\sim : TN|_{S(s)} \rightarrow (s|S(s))^*(T(J^2(N, P))|_{\Sigma^{n-p+1,0}(N, P)}), \quad (1.7)$$

and $\mathbf{d}^2 : T(J^2(N, P))|_{\Sigma^{n-p+1,0}(N, P)} \rightarrow \text{Hom}(\mathbf{K}, \mathbf{Q})$ similarly induces the homomorphism

$$d^2(s)_\sim : (s|S(s))^*(T(J^2(N, P))|_{\Sigma^{n-p+1,0}(N, P)}) \rightarrow \text{Hom}(K(s), Q(s)). \quad (1.8)$$

Throughout the paper, $S(s)^\iota$ denotes the subset consisting of all points $c \in S(s)$ such that the index of the quadratic form $q(s)_c$ is either ι or $n - p + 1 - \iota$. If $\iota \neq (n - p + 1)/2$, then we always provide $Q(s)_c$ with the orientation such that the index of $q(s)_c$ is equal to ι . Furthermore, whenever TP is provided with a metric, \mathbf{Q}_z and $Q(s)_c$ are always identified with a line of $(\pi_P^2)^*(TP)_z$ and a line of $f^*(TP)_c$ respectively.

A homotopy c_λ with $\lambda \in [0, 1]$ refers to a continuous map c of $I = [0, 1]$ into a space. For example, a homotopy h_λ in $\Gamma(N, P)$ relative to a closed subset C of N refers to a continuous map $h : I \rightarrow \Gamma(N, P)$ such that $h_\lambda|C = h_0|C$ for any λ .

2 Homotopy principle for fold-maps

If for any section s of $\Gamma(N, P)$ there exists a fold-map $f : N \rightarrow P$ such that $j^2 f$ is homotopic to s by a homotopy in $\Gamma(N, P)$, then we say that the homotopy principle for fold-maps *in the existence level* holds. In this section we prove Theorem 0.5 as a consequence of Theorems 2.2, 2.4 and Proposition 2.5 below. We also prove another version of Theorem 0.5 as follows.

Theorem 2.1. *Let $n \geq p \geq 2$. Let N, P and C be manifolds and a closed subset of N respectively and let g be a fold-map defined on a neighborhood of C into P . Let s be a section of $\Gamma^{\text{tr}}(N, P)$ such that $j^2 g = s$ on a neighborhood of C and that $Q(s)$ is a trivial bundle. Then there exists a fold-map $f : N \rightarrow P$ such that $j^2 f$ is homotopic to s relative to C by a homotopy h_λ in $\Gamma(N, P)$ such that $h_0 = s$, $h_1 = j^2 f$ and that $Q(j^2 f)$ is a trivial bundle.*

If the closure of no component of $N \setminus C$ is compact, then the assertion of Theorem 0.5 is a direct consequence of [G1, Theorem 4.1.1]. Theorem 0.5 is a relative form of a special case of [An1, Theorem 1]. Its proof given there was sketchy and the proof of Proposition 2.5 below was abbreviated, because it seemed a reformulation of Theorem 2.2 below. However, it turns out that Theorem 0.5 together with Theorem 2.4 is very useful as Corollaries 0.2 and 0.4 show. This is the reason why we give here its proof in detail for the case $n > p$. A proof of Theorem 0.5 for the case $n = p$ is given in [An3, Theorem 4.1].

In the following definition let $S^0, \dots, S^{[(n-p+1)/2]}$ be submanifolds of dimension $p-1$ of N , C be a closed subset of N and let g be a fold-map into P defined on a neighborhood of C .

Let $\mathfrak{M}(N, P; S^0, \dots, S^{[(n-p+1)/2]}, C, g)$ denote the space consisting of all fold-maps $f : N \rightarrow P$, which is equipped with the C^∞ -topology, such that

- (1) $S(j^2 f)^\iota = S^\iota$ for $0 \leq \iota \leq [(n-p+1)/2]$,
- (2) $f = g$ on a neighborhood of C .

Let $\mathfrak{m}(N, P; S^0, \dots, S^{[(n-p+1)/2]}, C, g)$ denote the space consisting of all homomorphisms $h : TN \rightarrow TP$, which is equipped with the compact-open topology, such that

- (1) if $x \in N \setminus (\cup_{\iota=0}^{[(n-p+1)/2]} S^\iota)$, then h_x is of rank p ,
- (2) for any point $c \in S^\iota$, there exists a neighborhood U_c of c in N and a fold-map $f_{U_c} : U_c \rightarrow P$ such that $h|_{TU_c} = df_{U_c}$ and that $S(j^2 f_{U_c})^\iota = U_c \cap S^\iota$,
- (3) for any point $c \in C$, we have $h_c = dg_c$.

Then we have the continuous map

$$\mathbf{d} : \mathfrak{M}(N, P; S^0, \dots, S^{[(n-p+1)/2]}, C, g) \rightarrow \mathfrak{m}(N, P; S^0, \dots, S^{[(n-p+1)/2]}, C, g) \quad (2.1)$$

defined by $\mathbf{d}(f) = df$.

The following theorem due to Èliašberg[E2, 4.7 Theorem] will play an important role in the proof of Theorems 0.5, 2.1 and 2.4.

Theorem 2.2 ([E2]). *Let $n \geq p \geq 2$. Let N and P be connected manifolds of dimensions n and p respectively and let $S^0, \dots, S^{[(n-p+1)/2]}$, C and g be as above. Assume that each connected component of $N \setminus C$ has non-empty intersection with each S^ι ($0 \leq \iota \leq [(n-p+1)/2]$). Let $B : TN \rightarrow TP$ be any homomorphism in $\mathfrak{m}(N, P; S^0, \dots, S^{[(n-p+1)/2]}, C, g)$.*

Then there exist a fold-map $f : N \rightarrow P$ in $\mathfrak{M}(N, P; S^0, \dots, S^{[(n-p+1)/2]}, C, g)$ and a homotopy of homomorphisms $B_\lambda : TN \rightarrow TP$ in $\mathfrak{m}(N, P; S^0, \dots, S^{[(n-p+1)/2]}, C, g)$ such that $B_0 = B$, $B_1 = df$ and $B_\lambda|_C = B|_C$ for any λ .

We begin by preparing several notions and results, which are necessary for the proof of Theorem 0.5. For the fold-map g and the closed subset C in the statement of Theorem 0.5, we take a closed neighborhood $V(C)$ of C such that $V(C)$ is an n -dimensional submanifold with boundary for a while and that g is defined on a neighborhood of $V(C)$, where $j^2 g = s$. Without loss of generality we may assume that $N \setminus \text{Int}V(C)$ is nonempty. Take a smooth function $h_C : N \rightarrow [0, 1]$ such that

$$\begin{cases} h_C(x) = 1 & \text{for } x \in C, \\ h_C(x) = 0 & \text{for } x \in N \setminus \text{Int}V(C), \\ 0 < h_C(x) < 1 & \text{for } x \in \text{Int}V(C) \setminus C. \end{cases} \quad (2.2)$$

By the Sard Theorem ([H2]) there is a regular value r of h_C with $0 < r < 1$. Then $h_C^{-1}(r)$ is a submanifold and we set $U(C) = h_C^{-1}([r, 1])$. We decompose $N \setminus \text{Int}U(C)$ into the connected components, say L_1, \dots, L_j, \dots . It suffices to prove Theorem 0.5 for each $L_j \cup \text{Int}U(C)$. Since $\partial N = \emptyset$, we have that $N \setminus U(C)$ has empty boundary. If L_j is not compact, then Theorem 0.5 holds for $L_j \cup \text{Int}U(C)$ by Gromov's theorem ([G1, Theorem 4.1.1]). Therefore, it suffices to consider the special case where

- (C1) C has closed neighborhoods $U(C)$ and $V(C)$ with $U(C) \subset \text{Int}V(C)$,
- (C2) $N \setminus V(C) \neq \emptyset$ and g is defined on a neighborhood of $V(C)$, where $j^2g = s$,
- (C3) $N \setminus \text{Int}U(C)$ is compact, connected and nonempty,
- (C4) $\partial U(C)$ and $\partial V(C)$ are submanifolds of dimension $n - 1$,
- (C5) there is a smooth function $h_C : N \rightarrow [0, 1]$ satisfying (2.2) such that for a sufficiently small positive real number ε with $r - 2\varepsilon > 0$, $r - t\varepsilon$ ($0 \leq t \leq 2$) are all regular values of h_C , and hence $h_C^{-1}([r - 2\varepsilon, 1])$ is contained in $V(C)$.

We set $V_t = h_C^{-1}(r - (2 - t)\varepsilon)$. There exists an embedding $e_V : V_0 \times [0, 2] \rightarrow N$ such that $e_V(V_0 \times t) = V_t$. We denote, by N_t , the union of $N \setminus \text{Int}(h_C^{-1}([r - 2\varepsilon, 1]))$ and $e_V(V_0 \times [0, t])$. In particular, we have that $N \setminus \text{Int}N_2 = U(C)$. Furthermore, we may assume that

- (C6) $s \in \Gamma^{tr}(N, P)$ and $S(s)$ is transverse to V_0 and V_2 .

Remark 2.3. *If $g : (N, c) \rightarrow (P, g(c))$ is a fold-map germ and if c is a fold singularity, then $d_c^2g : T_cN \rightarrow \text{Hom}(K(j^2g)_c, Q(j^2g)_c)$ coincides with $d_c^2(j^2g)$ and is an epimorphism (see §1). Since $K(j^2g)_c \cap T_c(S(j^2g)) = \{0\}$, we may regard $K(j^2g)$ as the normal bundle of $S(j^2g)$ near c .*

Let s be a section of $\Gamma^{tr}(N, P)$. Recall the homomorphisms in (1.7) and (1.8)

$$\begin{aligned} d(s)_\sim &: TN|_{S(s)} \rightarrow (s|S(s))^*(T(J^2(N, P))|_{\Sigma^{n-p+1,0}(N, P)}), \\ d^2(s)_\sim &: (s|S(s))^*(T(J^2(N, P))|_{\Sigma^{n-p+1,0}(N, P)}) \rightarrow \text{Hom}(K(s), Q(s)). \end{aligned}$$

Since $K(s)$ is a subbundle of $TN|_{S(s)}$, we have the inclusion map $i_{K(s)} : K(s) \rightarrow TN|_{S(s)}$. By Remark 2.3 there exists a normal bundle $\mathcal{N}(s)$ of $S(s)$ in $TN|_{S(s)}$ such that if $c \in S(s) \setminus \text{Int}N_1$, then $\mathcal{N}(s)_c = K(s)_c$ and if $c \in S(s) \cap \text{Int}N_{1/2}$, then $\mathcal{N}(s)_c$ is orthogonal to $T_c(S(s))$. Such a normal bundle is always denoted by $\mathcal{N}(s)$. If $s \in \Gamma^{tr}(N, P)$, then $d^2(s)_\sim \circ d(s)_\sim$ is an epimorphism and $d^2s|K(s)$ is an isomorphism. Then we have the monomorphism $\Phi(s) : \mathcal{N}(s) \rightarrow TN|_{S(s)}$ defined by

$$\Phi(s) = i_{K(s)} \circ (d^2s|K(s))^{-1} \circ d^2(s)_\sim \circ d(s)_\sim|_{\mathcal{N}(s)}. \quad (2.3)$$

Let $i_{\mathcal{N}(s)} : \mathcal{N}(s) \rightarrow TN|_{S(s)}$ be the inclusion. If f is a fold-map, then it follows from the definition of the intrinsic derivative and Remark 2.3 that $i_{\mathcal{N}(j^2f)} = \Phi(j^2f)$, where $\mathcal{N}(j^2f) = K(j^2f)$. Let $\text{Mono}(\mathcal{N}(s), TN|_{S(s)})$ denote the subset of $\text{Hom}(\mathcal{N}(s), TN|_{S(s)})$ consisting of all monomorphisms. Then two monomorphisms $i_{\mathcal{N}(s)}$ and $\Phi(s)$ are regarded as sections of $\text{Mono}(\mathcal{N}(s), TN|_{S(s)})$ over $S(s)$.

For a section $s \in \Gamma^{tr}(N, P)$, let $S(s)^\iota \setminus \text{Int}U(C)$ be decomposed into the connected components $M(s)_1^\iota, \dots, M(s)_j^\iota$ ($0 \leq \iota \leq [(n - p + 1)/2]$), which may have non-empty boundary. Any one of $M(s)_j^\iota$'s will be often denoted by M when we fix it. For each M , the two sections $i_{\mathcal{N}(s)}|_M$ and $\Phi(s)|_M$ satisfy $i_{\mathcal{N}(s)}|_{\partial M} = \Phi(s)|_{\partial M}$, where ∂M may be empty.

We denote the bundle of the local coefficients $\mathcal{B}(\pi_{p-1}(\text{Mono}(\mathcal{N}(s)|_M)_c, (TN|_M)_c))$, $c \in M$, by $\mathcal{B}(\pi_{p-1})$, which is a covering space over M with fiber $\pi_{p-1}(\text{Mono}(\mathcal{N}(s)_c, T_cN))$ defined in [Ste, 30.1]. By the obstruction theory due to [Ste, 36.3], we have the primary difference $d(i_{\mathcal{N}(s)}|_M, \Phi(s)|_M)$ defined in the cohomology group with local coefficients $H^{p-1}(M, \partial M; \mathcal{B}(\pi_{p-1}))$. Since $\text{Mono}(\mathbf{R}^{n-p+1}, \mathbf{R}^n)$ is identified with $GL(n)/GL(p-1)$, it follows from [Ste, 38.2] that

$$\pi_{p-1}(\text{Mono}(\mathbf{R}^{n-p+1}, \mathbf{R}^n)) \cong \begin{cases} \mathbf{Z} & \text{if } p \text{ is odd or } n = p, \\ \mathbf{Z}/2\mathbf{Z} & \text{if } p \text{ is even and } n > p. \end{cases}$$

We should note that if p is even and $n > p$, then the bundle of the local coefficients is trivial. If p is odd or $n = p$, then we have an integer $m(s, M)$ such that

$$H^{p-1}(M, \partial M; \mathcal{B}(\pi_{p-1})) \cong \mathbf{Z}/m(s, M)\mathbf{Z}. \quad (2.4)$$

In the following brief proof of this fact we use the notation used in [Ste, §31]. Consider a triangulation of $(M, \partial M)$ and let $C^i(M, \partial M; \mathcal{B}(\pi_{p-1}))$ be the i -th cochain group. Let $\sigma^{p-2}(M)$ be a $(p-2)$ -simplex of $M \setminus \partial M$ which is a common face of two $(p-1)$ -simplexes $\tau_1^{p-1}(M)$ and $\tau_2^{p-1}(M)$ of M . Let a_σ and a_{τ_i} be base points of $\sigma^{p-2}(M)$ and $\tau_i^{p-1}(M)$ ($i = 1, 2$) respectively. Let $\omega_\sigma \in C^{p-2}(M, \partial M; \mathcal{B}(\pi_{p-1}))$ and $\omega_{\tau_i} \in C^{p-1}(M, \partial M;$

$\mathcal{B}(\pi_{p-1}))$ be the dual $p-2$ cochain and the dual $p-1$ cochains of $\sigma^{p-2}(M)$ and $\tau_i^{p-1}(M)$ respectively, which map them to the respective generators of $\pi_{p-1}(\text{Mono}(\mathcal{N}(s)_{a_\sigma}, T_{a_\sigma}N))$ and $\pi_{p-1}(\text{Mono}(\mathcal{N}(s)_{a_{\tau_i}}, T_{a_{\tau_i}}N))$ ($i = 1, 2$). Let $\delta : C^{p-2}(M, \partial M; \mathcal{B}(\pi_{p-1})) \rightarrow C^{p-1}(M, \partial M; \mathcal{B}(\pi_{p-1}))$ be the coboundary homomorphism. Then we have that

$$\delta(\omega_\sigma)(\tau_i^{p-1}(M)) = \omega_\sigma(\partial(\tau_i^{p-1}(M)))$$

is equal to a generator of $\pi_{p-1}(\text{Mono}(\mathcal{N}(s)_{a_\sigma}, T_{a_\sigma}N))$ and if $\tau(M)$ is one of the other $p-1$ simplexes, then $\delta(\omega_\sigma)(\tau(M)) = 0$. Therefore, we have $\omega_{\tau_1} = \pm \omega_{\tau_2}$ modulo $\text{Im}(\delta)$. This implies (2.4).

For the proof of Theorems 0.5 and 2.1 we need the following theorem and proposition.

Theorem 2.4. *Let $n \geq p \geq 2$. Let N, P, C, s and g be ones given in Theorem 0.5 which satisfy the assumptions (C1) to (C6). Suppose for each ι that $S(s)^\iota \setminus \text{Int}V(C)$ is a non-empty set and that $S(s)^\iota \setminus \text{Int}U(C)$ is decomposed into the connected components $M(s)_1^\iota, \dots, M(s)_{j_\iota}^\iota$ ($0 \leq \iota \leq [(n-p+1)/2]$). Assume that $d(i_{\mathcal{N}(s)}|_{M(s)_j^\iota}, \Phi(s)|_{M(s)_j^\iota}) = 0$ for all j and ι . Then there exist a homotopy s_λ relative to a neighborhood of $U(C)$ in $\Gamma(N, P)$ and a fold-map $f : N \rightarrow P$ satisfying the following.*

- (1) $s_0 = s$ and $s_1 = j^2 f$,
- (2) $S(s_\lambda)^\iota = S(s)^\iota$ for any λ and ι ,
- (3) if $Q(s)$ is a trivial bundle, then $Q(s_1)$ is also a trivial bundle.

Proposition 2.5. *Let $n \geq p \geq 2$. Let N, P, C, s and g be ones given in Theorem 0.5 which satisfy the assumptions (C1) to (C6). Then there exists a homotopy s_λ relative to $V(C)$ in $\Gamma(N, P)$ with $s_0 = s$ such that if $S(s_1)^\iota \setminus \text{Int}U(C)$ is decomposed into the nonempty connected components $M(s_1)_1^\iota, \dots, M(s_1)_{j_\iota}^\iota$, then*

- (1) $s_1 \in \Gamma^{tr}(N, P)$,
- (2) $d(i_{\mathcal{N}(s_1)}|_{M(s_1)_j^\iota}, \Phi(s_1)|_{M(s_1)_j^\iota}) = 0$ for all j and ι ,
- (3) $S(s)^\iota \setminus V(C) \neq \emptyset$ if and only if $S(s_1)^\iota \setminus V(C) \neq \emptyset$,
- (4) if $Q(s)$ is a trivial bundle, then $Q(s_1)$ is also a trivial bundle.

The proofs of Theorem 2.4 and Proposition 2.5 will be given in §4 and §5 respectively.

Here we give a proof of Theorems 0.5 and 2.1. In the proof we use the notation explained above.

Proof of Theorems 0.5 and 2.1. By the above argument, it suffices to prove Theorem 0.5 for the case where (C1) to (C6) are satisfied. If there exists an ι such that $S(s)^\iota \setminus V(C) = \emptyset$, then we have a neighborhood \mathbf{U} in some local chart of N with $\text{Cl}(\mathbf{U}) \subset N \setminus (V(C) \cup S(s))$ and a homotopy $s'_\lambda \in \Gamma(N, P)$ relative to $N \setminus \mathbf{U}$ with $s'_0 = s$ and $s'_1 \in \Gamma^{tr}(N, P)$, which satisfies, for each ι with $S(s)^\iota \setminus V(C) = \emptyset$, the following.

(1) $S(s'_1)^\iota \cap \mathbf{U}$ is nonempty and is the boundary of an embedded p -disk within \mathbf{U} ; these p -disks are mutually disjoint.

(2) $Q(s'_1)|_{S(s'_1)^\iota \cap \mathbf{U}}$ and the normal bundle $\mathcal{N}_{S(s'_1)^\iota \cap \mathbf{U}}$ of $S(s'_1)^\iota \cap \mathbf{U}$ are extended to bundles over the respective p -disks. In particular, they are trivial bundles.

It follows from Proposition 2.5 for s'_1 that there exists a homotopy s''_λ relative to a neighborhood of $V(C)$ in $\Gamma(N, P)$ with $s''_0 = s'_1$ such that $s''_1 \in \Gamma^{tr}(N, P)$ and $d(i_{\mathcal{N}(s''_1)}|_{M(s''_1)_j^\iota}, \Phi(s''_1)|_{M(s''_1)_j^\iota}) = 0$ for all j and ι and that $S(s''_1)^\iota \setminus V(C) \neq \emptyset$ for all ι . By applying Theorem 2.4 to the section s''_1 , we see that there exists a homotopy s'''_λ relative to a neighborhood of $U(C)$ in $\Gamma(N, P)$ with $s'''_0 = s''_1$ such that there exists a fold-map $f : N \rightarrow P$ with $j^2 f = s'''_1$. Thus we obtain a required homotopy s_λ by pasting s'_λ, s''_λ and s'''_λ . This proves Theorem 0.5.

Next we prove Theorem 2.1 by using the above notation. Since $Q(s)$ is trivial, $Q(s'_1)$ is also trivial by (2) above. It follows from Proposition 2.5 (4) that $Q(s''_1)$ is trivial. Therefore, $Q(s'''_1)$ is also trivial by Theorem 2.4 (3). This proves Theorem 2.1. \square

3 Proof of Theorems 0.1 and 0.3

In this section we prove Theorems 0.1 and 0.3.

The following lemma is a consequence of the fundamental properties of fold-maps ([E1, 3.8 and 3.9] and [Sa1, Lemma 3.1]).

Lemma 3.1. *Let $n \geq p \geq 1$. Let $f : N \rightarrow P$ be a fold-map. Assume that either $n - p + 1$ is odd, or if $n - p + 1$ is even, then $Q(j^2 f)$ is a trivial bundle. Then there exists an epimorphism $TN \oplus \theta_N \rightarrow TP$ covering f .*

Proof. Recall the quadratic form $q(j^2 f) : S^2(K(j^2 f)) \rightarrow Q(j^2 f)$. If $n - p + 1$ is odd, then we can provide $Q(j^2 f)$ with an orientation so that this index is less than $(n - p + 1)/2$. Consequently, $Q(j^2 f)$ is a trivial bundle. Choose a Riemannian metric on P . Since $Q(j^2 f)$ is the cokernel bundle of $df|_{S(j^2 f)} : TN|_{S(j^2 f)} \rightarrow TP$, we may regard $Q(j^2 f)$ as a subbundle of $f^*(TP)$ and obtain a monomorphism $\varphi' : Q(j^2 f) \rightarrow TP$ covering $f|_{S(j^2 f)}$. Let $\varphi : \theta_N \rightarrow TP$ covering f be any extended homomorphism such that $\varphi|_{Q(j^2 f)} = \varphi'$. Then define the homomorphism $h : TN \oplus \theta_N \rightarrow TP$ by $h(\mathbf{v}_1 \oplus \mathbf{v}_2) = df(\mathbf{v}_1) + \varphi(\mathbf{v}_2)$. It is easy to see that h is an epimorphism. \square

If $n - p + 1$ is even, then $Q(j^2 f)$ is not necessarily trivial. The motivation of Theorem 0.1 is [E1, 3.10], [An3, Theorem 4.8] and the above lemma. We prove the following refined form of Theorem 0.1.

Theorem 3.2. *Let $n \geq p \geq 2$. Let $f : N \rightarrow P$ be a continuous map. Assume that there exists an epimorphism $h : TN \oplus \theta_N \rightarrow TP$ covering f . Then there exists a fold-map $g : N \rightarrow P$ homotopic to f such that $Q(j^2 g)$ is a trivial bundle.*

Proof of Theorem 3.2. We set $\xi = \text{Ker}(h)$. Let $i_\xi : \xi \rightarrow TN \oplus \theta_N$ be the inclusion. Let $\pi_{\theta_N} : TN \oplus \theta_N \rightarrow \theta_N$ be the canonical projection. Then we have the homomorphism $\pi_{\theta_N} \circ i_\xi : \xi \rightarrow \theta_N$, which we regard as a section of $\text{Hom}(\xi, \theta_N)$ over N . We deform h by homotopy to a smooth epimorphism, denoted by the same letter h , such that $\pi_{\theta_N} \circ i_\xi$ is transverse to the zero-section of $\text{Hom}(\xi, \theta_N)$. Let V be the inverse image of the zero-section of $\text{Hom}(\xi, \theta_N)$ by $\pi_{\theta_N} \circ i_\xi$. Then the normal bundle of V in N is isomorphic to $\text{Hom}(\xi|_V, \theta_V)$. We now consider the homomorphism $h|_{TN} : TN \rightarrow TP$.

Let $x \in N \setminus V$. For any vector $\mathbf{v} \in T_{f(x)}P$, let $\mathbf{v} = h(\mathbf{w}_1 \oplus \mathbf{w}_2)$ with $\mathbf{w}_1 \in T_x N$ and $\mathbf{w}_2 \in (\theta_N)_x$. Since $\pi_{\theta_N} \circ i_\xi : \xi_x \rightarrow (\theta_N)_x$ is surjective, there exists a vector $\mathbf{v}_1 \in \xi_x$ with $\pi_{\theta_N} \circ i_\xi(\mathbf{v}_1) = \mathbf{w}_2$. Let $\mathbf{v}_1 = \mathbf{w}_3 \oplus \mathbf{w}_2$ with $\mathbf{w}_3 \in T_x N$. Then we have

$$\begin{aligned} h(\mathbf{w}_1 - \mathbf{w}_3) &= h(\mathbf{w}_1 \oplus \mathbf{w}_2 - \mathbf{w}_3 \oplus \mathbf{w}_2) \\ &= \mathbf{v} - h(\mathbf{v}_1) \\ &= \mathbf{v}. \end{aligned}$$

Hence, $h|_{T_x N}$ is surjective onto $T_{f(x)}P$.

Let $x \in V$. Since $\pi_{\theta_N} \circ i_\xi$ is a null-homomorphism and since the kernel of π_{θ_N} is $T_x N$, we have $\xi_x \subset T_x N$. Since $\text{Ker}(h) = \xi$, we have $\text{Ker}(h|_{T_x N}) = \xi_x$. Since ξ is of dimension $n - p + 1$, we obtain that $h|_{T_x N}$ is of rank $p - 1$. Therefore, $h|_{TN} : TN \rightarrow TP$ induces a homomorphism $H : TN \rightarrow f^*(TP)$, which is regarded as a section $s' : N \rightarrow \Omega^{n-p+1}(N, P)$. Next we show that the line bundle $\text{Cok}(h|_{TN})|_V$ is isomorphic to θ_V . In fact, the exact sequence

$$0 \rightarrow \xi|_V \rightarrow TN|_V \rightarrow f^*(TP)|_V \rightarrow \text{Cok}(h|_{TN})|_V \rightarrow 0$$

yields

$$\begin{aligned} W_1(\text{Cok}(h|_{TN})|_V) &= W_1(f^*(TP)|_V) - W_1(TN|_V) + W_1(\xi|_V) \\ &= W_1(\theta_V), \end{aligned}$$

where W_1 refers to the first Stiefel-Whitney class. Since $\text{Cok}(h|_{TN})|_V$ and θ_V are line bundles, we obtain the assertion. By choosing a Riemannian metric on P , we regard $\text{Cok}(h|_{TN})|_V$ as a subbundle of $f^*(TP)|_V$.

We take any non-singular symmetric map $\mathbf{b} : \xi|_V \otimes \xi|_V \rightarrow \text{Cok}(h|TN)|_V (\subset f^*(TP)|_V)$. Let $\tilde{\mathbf{b}} : S^2(TN) \rightarrow f^*(TP)$ be any extended homomorphism of \mathbf{b} . Under the identification (1.2), we define the section $s : N \rightarrow \Omega^{n-p+1,0}(N, P)$ as follows. For $x \in N$, set

$$s(x) = \{x, f(x), H_x, \tilde{\mathbf{b}}_x\}.$$

If $x \notin V$, then H_x is nonsingular and if $x \in V$, then $\text{Ker}(H_x) = \xi_x$ and $\tilde{\mathbf{b}}_x$ is nonsingular.

By Theorem 2.1 there exists a fold-map $g : N \rightarrow P$ such that j^2g and s are homotopic as sections in $\Gamma(N, P)$ and that $Q(j^2g)$ is a trivial bundle. In particular, g is homotopic to f , and the theorem is proved. Hence, Theorem 0.1 is also proved. \square

Next we prepare tools necessary for the proof of Theorem 0.3. Let $\Delta(d_1, \dots, d_k)$ be the diagonal $k \times k$ matrix with diagonal components (d_1, \dots, d_k) . In \mathbf{R}^k for any number k , the vector ${}^t(\overbrace{0, \dots, 0}^{i-1}, 1, \overbrace{0, \dots, 0}^{k-i})$ is denoted by \mathbf{e}_i . For a point $y = (y_1, \dots, y_k) \in \mathbf{R}^k$, let $\mathcal{T}^k(y)$ denote the $k \times k$ matrix $(\delta_{ij} - 2y_i y_j)_{1 \leq i, j \leq k}$, where δ_{ij} refers to the Kronecker delta. Let $\mathcal{T}^k : \theta_{\mathbf{R}^k}^k \rightarrow \theta_{\mathbf{R}^k}^k$ denote the homomorphism defined by $\mathcal{T}^k(y, \mathbf{v}) = (y, \mathcal{T}^k(y)(\mathbf{v}))$. The formula $\det \mathcal{T}^k(y) = 1 - 2(y_1^2 + \dots + y_k^2)$ is well known as an exercise in linear algebra. For simplicity we write $\mathcal{T}(y)$ and \mathcal{T} for $\mathcal{T}^n(y)$ and \mathcal{T}^n respectively. Let

$\Delta[a; j]$ be $\Delta(\overbrace{a, \dots, a}^{n-j}, \overbrace{-a, \dots, -a}^j)$. In particular, for $\varepsilon = 1$ or 0 we denote $\Delta[1; \varepsilon]$ by $I_{-\varepsilon}^n$. Let $\mathcal{T}I_{-\varepsilon}^n$ (resp. $I_{-1}^n \mathcal{T}$): $\theta_{\mathbf{R}^n}^n \rightarrow \theta_{\mathbf{R}^n}^n$ be the homomorphism defined by $\mathcal{T}I_{-\varepsilon}^n(y, \mathbf{v}) = (y, \mathcal{T}(y)I_{-\varepsilon}^n(\mathbf{v}))$ (resp. by $I_{-1}^n \mathcal{T}(y, \mathbf{v}) = (y, I_{-1}^n \mathcal{T}(y)(\mathbf{v}))$) and $\mathcal{T}(y)I_{-\varepsilon}^n(\frac{1}{p})$ the $p \times n$ matrix consisting of the first p row vectors of $\mathcal{T}(y)I_{-\varepsilon}^n$. Then we have the homomorphisms $\mathcal{T}I_{-\varepsilon}^n(\frac{1}{p}) : \theta_{\mathbf{R}^n}^n \rightarrow \theta_{\mathbf{R}^p}^p$ and $\mathbf{T}I_{-\varepsilon}^n(\frac{1}{p}) : \theta_{\mathbf{R}^n}^n \rightarrow \theta_{\mathbf{R}^n}^n$ defined by $\mathcal{T}I_{-\varepsilon}^n(\frac{1}{p})(y, \mathbf{v}) = ((y_1, \dots, y_p), (\mathcal{T}(y)I_{-\varepsilon}^n(\frac{1}{p}))\mathbf{v})$ and $\mathbf{T}I_{-\varepsilon}^n(\frac{1}{p})(y, \mathbf{v}) = (y, (\mathcal{T}(y)I_{-\varepsilon}^n(\frac{1}{p}))\mathbf{v})$ respectively, where $y = (y_1, \dots, y_n) \in \mathbf{R}^n$. Let $\mathbf{0}_{n-p}$ be the null vector of degree $n - p$. The subset of \mathbf{R}^n consisting of all points y such that $\mathcal{T}(y)I_{-\varepsilon}^n(\frac{1}{p})$ is of rank $p - 1$ coincides with $S_{1/\sqrt{2}}^{p-1} \times \mathbf{0}_{n-p}$, which is the subspace consisting of all points $y = (y_1, \dots, y_n)$ such that $2(y_1^2 + \dots + y_p^2) = 1$ and $y_{p+1} = \dots = y_n = 0$ (see Lemma 3.3 below). We denote the intrinsic derivatives of $\mathbf{T}I_{-\varepsilon}^n(\frac{1}{p})$ for $n > p$ and $I_{-1}^n \mathcal{T}$ for $n = p$ due to I. R. Porteous (see [B, Lemma 7.4]) by $\mathbf{d}(\mathbf{T}I_{-\varepsilon}^n(\frac{1}{p}))$ and $\mathbf{d}(I_{-1}^n \mathcal{T})$ respectively on $S_{1/\sqrt{2}}^{p-1} \times \mathbf{0}_{n-p}$. In the following lemma we set $\mathbf{c} = {}^t(c_1, \dots, c_p, 0, \dots, 0)$, $\dot{\mathbf{c}} = {}^t(c_1, \dots, c_p)$ and $\mathbf{c}^- = {}^t(c_1, \dots, c_{n-1}, -c_n)$.

Lemma 3.3. (1) $\mathcal{T}(y)I_{-\varepsilon}^n(\frac{1}{p})$ (resp. $I_{-1}^n \mathcal{T}(y)$) is of rank p (resp. rank n) if and only if $y \notin S_{1/\sqrt{2}}^{p-1} \times \mathbf{0}_{n-p}$ (resp. $y \notin S_{1/\sqrt{2}}^{n-1}$).

(2) If $c \in S_{1/\sqrt{2}}^{p-1} \times \mathbf{0}_{n-p}$, then we have

- (2-i) $\mathcal{T}(c)I_{-\varepsilon}^n(\frac{1}{p})$ (resp. $I_{-1}^n \mathcal{T}(c)$) is of rank $p - 1$ (resp. $n - 1$),
- (2-ii) the kernel of $\mathcal{T}(c)I_{-\varepsilon}^n(\frac{1}{p})$ is generated by the vectors $\mathbf{c}, \mathbf{e}_{p+1}, \dots, \mathbf{e}_n$ ($n > p$),
- (2-iii) the kernel of $I_{-1}^n \mathcal{T}(c)$ is generated by the vector \mathbf{c} ($n = p$),
- (2-iv) the cokernel of $\mathcal{T}(c)I_{-\varepsilon}^n(\frac{1}{p})$ is generated by $\dot{\mathbf{c}}$ ($n > p$),
- (2-v) the cokernel of $I_{-1}^n \mathcal{T}(c)$ is generated by \mathbf{c}^- ($n = p$),
- (2-vi) the intrinsic derivatives satisfy

$$\begin{aligned} (\mathbf{d}_c(\mathbf{T}I_{-\varepsilon}^n(\frac{1}{p})))(\mathbf{c})(\mathbf{c}) &= 2(-\dot{\mathbf{c}}), \\ (\mathbf{d}_c(\mathbf{T}I_{-\varepsilon}^n(\frac{1}{p})))(\mathbf{c})(\mathbf{e}_k) &= \mathbf{0} && \text{for } n \geq k \geq p + 1, \\ (\mathbf{d}_c(\mathbf{T}I_{-\varepsilon}^n(\frac{1}{p})))(\mathbf{e}_k)(\mathbf{e}_\ell) &= 2\delta_{k\ell}(-\dot{\mathbf{c}}) && \text{for } n > k \geq p + 1 \text{ and } n \geq \ell \geq p + 1, \\ (\mathbf{d}_c(\mathbf{T}I_{-\varepsilon}^n(\frac{1}{p})))(\mathbf{e}_k)(\mathbf{e}_\ell) &= (-1)^{\varepsilon\delta_{kn}} 2\delta_{k\ell}(-\dot{\mathbf{c}}) && \text{for } n = k \geq \ell \geq p + 1, \\ (\mathbf{d}_c(I_{-1}^n \mathcal{T}))(\mathbf{c})(\mathbf{c}) &= 2(-\mathbf{c}^-) && \text{for } n = p. \end{aligned}$$

Proof. Suppose that $n > p$ and one of y_{p+1}, \dots, y_n is not 0, say $y_{p+1} \neq 0$. Then we have

$$\text{rank} \begin{pmatrix} & -2y_1y_{p+1} \\ (\delta_{ij} - 2y_iy_j) & \vdots \\ & -2y_py_{p+1} \end{pmatrix} = \text{rank} \begin{pmatrix} & y_1 \\ E_p & \vdots \\ & y_p \end{pmatrix} = p,$$

where E_p is the unit matrix of rank p . Next suppose that $y_{p+1} = \dots = y_n = 0$. Since $\det \mathcal{T}^p(y_1, \dots, y_p) = 1 - 2(y_1^2 + \dots + y_p^2)$, $\mathcal{T}(y)I_{-\varepsilon}^n(\frac{1}{p})$ is of rank p if and only if $y \notin S_{1/\sqrt{2}}^{p-1} \times \mathbf{0}_{n-p}$.

If $c \in S_{1/\sqrt{2}}^{p-1} \times \mathbf{0}_{n-p}$, then one of c_1, \dots, c_p is not 0, say $c_p \neq 0$. Then we have

$$\det \mathcal{T}^{p-1}(c_1, \dots, c_{p-1}) = 1 - 2(c_1^2 + \dots + c_{p-1}^2) = 2c_p^2 \neq 0.$$

Hence, $\mathcal{T}(c)(\frac{1}{p})$ is of rank $p-1$. This proves (1) and (2-i) for $n > p$. The assertions (1) and (2-i) for $n = p$ and (2-ii, iii, iv, v) follow from a direct calculation.

We prove the assertion (2-vi). Let $\mathbf{0}_{i \times j}$ be the $i \times j$ null matrix. If $p+1 \leq k \leq n$ and $p+1 \leq \ell \leq n$, then we have

$$\partial/\partial y_k(\mathcal{T}(y)I_{-\varepsilon}^n(\frac{1}{p})) = \begin{pmatrix} & -2(-1)^{\varepsilon\delta_{kn}}y_1 \\ \mathbf{0}_{p \times (k-1)} & \vdots & \mathbf{0}_{p \times (n-k)} \\ & -2(-1)^{\varepsilon\delta_{kn}}y_p \end{pmatrix},$$

and hence,

$$(\partial/\partial y_k(\mathcal{T}(y)I_{-\varepsilon}^n(\frac{1}{p}))) (\mathbf{e}_\ell) = {}^t(-2(-1)^{\varepsilon\delta_{kn}}\delta_{k\ell}y_1, \dots, -2(-1)^{\varepsilon\delta_{kn}}\delta_{k\ell}y_p).$$

Hence, we have

$$(d_c(\mathbf{T}I_{-\varepsilon}^n(\frac{1}{p})))(\mathbf{e}_k)(\mathbf{e}_\ell) = 2(-1)^{\varepsilon\delta_{kn}}\delta_{k\ell}(-\dot{\mathbf{c}}).$$

Furthermore, consider the curve $tc = t(c_1, \dots, c_p, 0, \dots, 0)$ parametrized by t . Then we have

$$\partial/\partial t(\mathcal{T}(tc)I_{-\varepsilon}^n(\frac{1}{p})) = ((-4tc_i c_j)_{1 \leq i, j \leq p} \quad \mathbf{0}_{p \times (n-p)}),$$

and hence, $(d_c(\mathbf{T}I_{-\varepsilon}^n(\frac{1}{p})))(\mathbf{c})(\mathbf{c}) = 2(-\dot{\mathbf{c}})$ and $(d_c(\mathbf{T}I_{-\varepsilon}^n(\frac{1}{p})))(\mathbf{c})(\mathbf{e}_k) = \mathbf{0}$ for $p+1 \leq k \leq n$ follow from

$$\begin{aligned} (\partial/\partial t(\mathcal{T}(tc)I_{-\varepsilon}^n(\frac{1}{p}))|_{t=1})(\mathbf{c}) &= -4\|\mathbf{c}\|^2\dot{\mathbf{c}} = 2(-\dot{\mathbf{c}}), & \text{and} \\ (\partial/\partial t(\mathcal{T}(tc)I_{-\varepsilon}^n(\frac{1}{p}))|_{t=1})(\mathbf{e}_k) &= \mathbf{0} & \text{for } p+1 \leq k \leq n, \end{aligned}$$

respectively.

If $n = p$, then we have, for $I_{-1}^n \mathcal{T}$,

$$\partial/\partial t(I_{-1}^n \mathcal{T}(tc)) = \begin{pmatrix} (-4tc_i c_j)_{\substack{1 \leq i \leq n-1 \\ 1 \leq j \leq n}} \\ 4tc_n c_1, \dots, 4tc_n c_n \end{pmatrix}$$

and hence $(d_c(I_{-1}^n \mathcal{T})(\mathbf{c})(\mathbf{c})) = 2(-\mathbf{c}^-)$ follows from

$$(\partial/\partial t(I_{-1}^n \mathcal{T}(tc))|_{t=1})(\mathbf{c}) = -4\|\mathbf{c}\|^2\mathbf{c}^- = 2(-\mathbf{c}^-).$$

This shows the assertion. \square

It will be plausible to search fold-maps which have spheres as singularities as in Theorem 0.3.

Proof of Theorem 0.3. We may assume that N is connected. Let $\tilde{h}' : TN \oplus \theta_N \rightarrow f^*(TP) \oplus \xi \oplus \theta_N$ over N be an isomorphism. Take a local chart U_P of P diffeomorphic to \mathbf{R}^p with $f^{-1}(U_P) \neq \emptyset$, where we have a trivialization $TP|_{U_P} \cong \theta_{U_P}^p$. Take a point $o \in f^{-1}(U_P) \subset N$ and an embedding $e : \mathbf{R}^n \rightarrow N$ with $e(0) = o$ such that $e(\mathbf{R}^n)$ is contained in a contractible neighborhood U of o in $f^{-1}(U_P)$, which is a local chart of N and ξ . Set $\mathfrak{D} = e(D_1^n)$, where D_1^n is the unit disk in \mathbf{R}^n . Since $O(n+1)/(O(n) \times 1)$ is $(n-1)$ -connected,

there exists a bundle map $h' : TN|_{N \setminus \text{Int}\mathfrak{D}} \rightarrow (f^*(TP) \oplus \xi)|_{N \setminus \text{Int}\mathfrak{D}}$ such that $h' \oplus id_{\theta_{N \setminus \text{Int}\mathfrak{D}}}$ is homotopic to $\tilde{h}'|_{N \setminus \text{Int}\mathfrak{D}}$ by the obstruction theory. If $\pi_{f^*(TP)} : f^*(TP) \oplus \xi \rightarrow f^*(TP)$ and $\pi_\xi : f^*(TP) \oplus \xi \rightarrow \xi$ are the canonical projections, then we have $h' = (\pi_{f^*(TP)} \circ h') \oplus (\pi_\xi \circ h')$.

By applying the Phillips Submersion Theorem ([P]) for $\pi_{f^*(TP)} \circ h'$, we obtain a submersion $g : N \setminus \text{Int}\mathfrak{D} \rightarrow P$ and $\widetilde{dg} : T(N \setminus \text{Int}\mathfrak{D}) \rightarrow TP$ induces a bundle map $\widetilde{dg} : T(N \setminus \text{Int}\mathfrak{D}) \rightarrow g^*(TP)$ such that $\pi_{f^*(TP)} \circ h'$ and \widetilde{dg} are homotopic. Hence, $\widetilde{dg} \oplus (\pi_\xi \circ h') : TN|_{N \setminus \text{Int}\mathfrak{D}} \rightarrow g^*(TP) \oplus \xi|_{N \setminus \text{Int}\mathfrak{D}}$ is homotopic to h' . Therefore, we may assume the following by a routine argument:

(i) $f|(N \setminus \text{Int}\mathfrak{D}) = g$.

(ii) We have a bundle map $h : TN|_{N \setminus \text{Int}\mathfrak{D}} \rightarrow g^*(TP) \oplus \xi|_{N \setminus \text{Int}\mathfrak{D}}$ and an isomorphism $\tilde{h} : TN \oplus \theta_N \rightarrow f^*(TP) \oplus \xi \oplus \theta_N$ such that $h = \widetilde{dg} \oplus (\pi_\xi \circ h')$ (note that $(\pi_\xi \circ h') = (\pi_\xi \circ h)$) and $\tilde{h}|_{N \setminus \text{Int}\mathfrak{D}} = h \oplus id_{\theta_{N \setminus \text{Int}\mathfrak{D}}}$.

Since U is contractible, we have trivializations $t_N : TN|_U \rightarrow \theta_U^n$, $t_P : f^*(TP)|_U \rightarrow \theta_U^p$ and $t_\xi : \xi|_U \rightarrow \theta_U^{n-p}$. We consider the bundle map

$$\Psi = (t_P \oplus t_\xi) \circ h \circ t_N^{-1}|_{U \setminus \text{Int}\mathfrak{D}} : \theta_{U \setminus \text{Int}\mathfrak{D}}^n \rightarrow \theta_{U \setminus \text{Int}\mathfrak{D}}^n,$$

which we regard as a map $U \setminus \text{Int}\mathfrak{D} \rightarrow GL^+(n)$ by choosing appropriate orientations of $TN|_U$ and $f^*(TP)|_U$ ($GL^+(n)$ refers to the group of all $n \times n$ regular matrices with positive determinants). Note that $\Psi \oplus id_{\theta_{U \setminus \text{Int}\mathfrak{D}}}$ is extended to the bundle map

$$\tilde{\Psi} = (t_P \oplus t_\xi \oplus id_{\theta_U}) \circ \tilde{h} \circ (t_N \oplus id_{\theta_U})^{-1},$$

which is regarded as a map $U \rightarrow GL^+(n+1)$. Let $i_{GL^+} : GL^+(n) \rightarrow GL^+(n) \times 1 \subset GL^+(n+1)$ be the inclusion. By construction, we have

$$\tilde{\Psi}|_{U \setminus \text{Int}\mathfrak{D}} = i_{GL^+} \circ \Psi. \quad (3.1)$$

In the following, $[*]$ expresses the homotopy class represented by $*$. It follows from (3.1) that $(i_{GL^+})_* : \pi_{n-1}(GL^+(n)) \rightarrow \pi_{n-1}(GL^+(n+1))$ maps $[\Psi|_{\partial\mathfrak{D}}]$ to 0.

We use the map $\mathbf{i}^j : \partial D_1^n \rightarrow \partial D_1^n$ defined by $(y_1, \dots, y_n) \rightarrow (y_1, \dots, y_{n-1}, (-1)^j y_n)$ ($0 \leq j \leq n-p+1$). In particular, we have that

$$(I_{-1}^n \mathcal{T}) \circ \mathbf{i}^1(y) = I_{-1}^n I_{-1}^n \mathcal{T}(y) I_{-1}^n = \mathcal{T}(y) I_{-1}^n.$$

This implies that if j is odd, then

$$[\mathcal{T} I_{-1}^n |_{\partial D_1^n}] = [(I_{-1}^n \mathcal{T}) \circ \mathbf{i}^j |_{\partial D_1^n}] = -[I_{-1}^n \mathcal{T} |_{\partial D_1^n}]$$

in $\pi_{n-1}(SO(n))$. Let $p^S : SO(n) \rightarrow S^{n-1}$ be the map defined by $p^S(T) = T\mathbf{e}_n$. We have the homomorphisms $\partial_n : \pi_n(S^{n-1}) \rightarrow \pi_{n-1}(SO(n-1))$ and $p_*^S : \pi_{n-1}(SO(n)) \rightarrow \pi_{n-1}(S^{n-1})$. Then the kernel of $(i_{GL^+})_*$ is described as follows (see [Ste, 23.2 Theorem and 23.4 Theorem] and [W, Proposition 4]). If $n = 1, 3, 7$, then $(i_{GL^+})_*$ is an isomorphism and $\pi_2(SO(3)) \cong \pi_6(SO(7)) \cong \{0\}$. If n is odd and $n \neq 1, 3, 7$ (resp. even), then the kernel of $(i_{GL^+})_*$ is generated by

$$[I_{-1}^n \mathcal{T} |_{\partial D_1^n}] = -[\mathcal{T} I_{-1}^n |_{\partial D_1^n}],$$

which is of order two (resp. ∞ , and is mapped onto the twice of a generator of $\pi_{n-1}(S^{n-1})$ by p_*^S). Hence, by identifying $\partial\mathfrak{D}$ and ∂D_1^n with S^{n-1} , we have an integer m such that $[\Psi|_{\partial\mathfrak{D}}] = m[I_{-1}^n \mathcal{T} |_{\partial D_1^n}]$, where $m = 0$ for $n = 3, 7$ and $m = 0$ or 1 for other odd numbers n greater than 2.

Let ℓ be a non-negative integer such that $\ell \geq [(n-p+1)/2]$, which will be defined below. By identifying $\text{Int}\mathfrak{D}$ with \mathbf{R}^n coordinated by (z_1, \dots, z_n) , we choose disjointly embedded n -disks \mathbf{E}_j ($0 \leq j \leq \ell$) with center o_j and radius 1. We represent a point $x \in \mathbf{E}_j$ by the coordinates

$$y(x) = (y_1(x), \dots, y_n(x)) = (z_1(x), \dots, z_n(x)) - o_j.$$

Next we extend \widetilde{dg} to a homomorphism $H : TN \rightarrow f^*(TP)$ such that H is of rank $\geq p - 1$ and is of rank $p - 1$ exactly on a finite number of spheres embedded in \mathbf{E}_j 's. Consider the following cases to define $\Psi^{\mathbf{E}} : \cup_{j=0}^{\ell} \mathbf{E}_j \rightarrow \text{Hom}(\mathbf{R}^n, \mathbf{R}^n)$, where \mathbf{G} refers to $[(n - p + 1)/2]$ for short.

Case I: $n > p \geq 2$ and n is odd.

- (IA: $m = 0$, $\mathbf{G} \equiv 1(2)$ and $\ell = \mathbf{G}$),
- (IB: $m = 0$, $\mathbf{G} \equiv 0(2)$ and $\ell = \mathbf{G} + 1$),
- (IC: $m = 1$, $\mathbf{G} \equiv 0(2)$ and $\ell = \mathbf{G}$),
- (ID: $m = 1$, $\mathbf{G} \equiv 1(2)$ and $\ell = \mathbf{G} + 1$).

In the cases (IA, IB, IC, ID) we set

$$\Psi_x^{\mathbf{E}} = (I_{-1}^n \mathcal{T}) \circ \mathbf{i}^j(y(x)) \quad \text{for } x \in \mathbf{E}_j \ (0 \leq j \leq \ell).$$

Case II: $n > p \geq 2$ and n is even.

(IIA: $m \geq 0$, $\mathbf{G} \equiv 0(2)$ and $\ell = \mathbf{G} + m + 1$).

$$\Psi_x^{\mathbf{E}} = \begin{cases} (I_{-1}^n \mathcal{T}) \circ \mathbf{i}^j(y(x)) & \text{for } x \in \mathbf{E}_j \ (0 \leq j \leq \mathbf{G} + 1), \\ (I_{-1}^n \mathcal{T})(y(x)) & \text{for } x \in \mathbf{E}_j \ (\mathbf{G} + 1 < j \leq \mathbf{G} + m + 1). \end{cases}$$

(IIB: $m \geq 0$, $\mathbf{G} \equiv 1(2)$ and $\ell = \mathbf{G} + m$).

$$\Psi_x^{\mathbf{E}} = \begin{cases} (I_{-1}^n \mathcal{T}) \circ \mathbf{i}^j(y(x)) & \text{for } x \in \mathbf{E}_j \ (0 \leq j \leq \mathbf{G}), \\ (I_{-1}^n \mathcal{T})(y(x)) & \text{for } x \in \mathbf{E}_j \ (\mathbf{G} < j \leq \mathbf{G} + m). \end{cases}$$

(IIC: $m < 0$, $\mathbf{G} \equiv 0(2)$ and $\ell = \mathbf{G} + |m| + 1$).

$$\Psi_x^{\mathbf{E}} = \begin{cases} (I_{-1}^n \mathcal{T}) \circ \mathbf{i}^j(y(x)) & \text{for } x \in \mathbf{E}_j \ (0 \leq j \leq \mathbf{G} + 1), \\ (I_{-1}^n \mathcal{T}) \circ \mathbf{i}^1(y(x)) & \text{for } x \in \mathbf{E}_j \ (\mathbf{G} + 1 < j \leq \mathbf{G} + |m| + 1). \end{cases}$$

(IID: $m < 0$, $\mathbf{G} \equiv 1(2)$ and $\ell = \mathbf{G} + |m|$).

$$\Psi_x^{\mathbf{E}} = \begin{cases} (I_{-1}^n \mathcal{T}) \circ \mathbf{i}^j(y(x)) & \text{for } x \in \mathbf{E}_j \ (0 \leq j \leq \mathbf{G}), \\ (I_{-1}^n \mathcal{T}) \circ \mathbf{i}^1(y(x)) & \text{for } x \in \mathbf{E}_j \ (\mathbf{G} < j \leq \mathbf{G} + |m|). \end{cases}$$

Case III: $n = p \geq 2$ and n is an odd number except for 3 and 7.

(IIIA: $m = 0$ and $\ell = 1$)

$$\Psi_x^{\mathbf{E}} = (I_{-1}^n \mathcal{T})(y(x)) \quad \text{for } x \in \mathbf{E}_j \ (j = 0, 1).$$

(IIIB: $m = 1$ and $\ell = 0$)

$$\Psi_x^{\mathbf{E}} = (I_{-1}^n \mathcal{T})(y(x)) \quad \text{for } x \in \mathbf{E}_0.$$

Case IV: $n = p$, $n = 3, 7$, $m = 0$ and $\ell = 0$.

$$\Psi_x^{\mathbf{E}} = (I_{-1}^n \mathcal{T})(y(x)) \quad \text{for } x \in \mathbf{E}_0.$$

Case V: $n = p \geq 2$ and n is even.

(Case VA: $m > 0$ and $\ell = m - 1$)

$$\Psi_x^{\mathbf{E}} = (I_{-1}^n \mathcal{T})(y(x)) \quad \text{for } x \in \mathbf{E}_j \ (0 \leq j \leq m - 1).$$

(Case VB: $m = 0$ and $\ell = 1$)

$$\Psi_x^{\mathbf{E}} = (I_{-1}^n \mathcal{T}) \circ \mathbf{i}^j(y(x)) \quad \text{for } x \in \mathbf{E}_j \ (0 \leq j \leq 1).$$

(Case VC: $m < 0$ and $\ell = |m| - 1$)

$$\Psi_x^{\mathbf{E}} = (I_{-1}^n \mathcal{T}) \circ \mathbf{i}^1(y(x)) \quad \text{for } x \in \mathbf{E}_j \ (0 \leq j \leq |m| - 1).$$

We can extend Ψ and $\Psi^{\mathbf{E}}$ to a homomorphism $\Psi_U : \theta_U^n \rightarrow \theta_U^n$ so that $\Psi_U|_{\mathbf{E}_j} : \mathbf{E}_j \rightarrow \text{Hom}(\mathbf{R}^n, \mathbf{R}^n)$ coincides with $\Psi^{\mathbf{E}}|_{\mathbf{E}_j}$. In fact, in $\text{Int}\mathcal{D}$, connect the base point $(0, \dots, 0, 1)$ of \mathbf{E}_0 with the base points $(0, \dots, 0, 1)$ of the other \mathbf{E}_j 's ($j \neq 0$) by paths, which are disjoint except at $(0, \dots, 0, 1)$ of \mathbf{E}_0 . By the definition of $\Psi^{\mathbf{E}}$ we have that the sum $\Psi^{\mathbf{E}}|_{\partial\mathbf{E}_0} + \dots + \Psi^{\mathbf{E}}|_{\partial\mathbf{E}_\ell}$ and $\Psi^{\mathbf{E}}|_{\partial\mathcal{D}}$ are homotopic to each other when regarded as maps $S^{n-1} \rightarrow GL^+(n)$. Then it is an elementary consequence of the homotopy theory that Ψ and $\Psi^{\mathbf{E}}$ are extended to Ψ_U as maps $U \rightarrow \text{Hom}(\mathbf{R}^n, \mathbf{R}^n)$ so that $\Psi_U|(U \setminus (\cup_{j=0}^\ell \text{Int}\mathbf{E}_j))$ is a map into $GL^+(n)$. For $n \geq p \geq 2$ let $\pi_{\mathbf{R}^p} : \mathbf{R}^n \rightarrow \mathbf{R}^p$ be the canonical projection onto the first p components. Then we set

$$\begin{aligned} H(\mathbf{v}_x) &= (x, d_x g(\mathbf{v}_x)) && \text{for } \mathbf{v}_x \in T_x(N \setminus \text{Int}\mathcal{D}), \\ H(t_N^{-1}(x, \mathbf{v})) &= t_P^{-1}(x, \pi_{\mathbf{R}^p} \circ \Psi_x(\mathbf{v})) && \text{for } x \in U, \mathbf{v} \in \mathbf{R}^n. \end{aligned} \quad (3.2)$$

This is well defined by the property (ii). In particular, we have $H(t_N^{-1}(x, \mathbf{v})) = t_P^{-1}(x, \pi_{\mathbf{R}^p} \circ \Psi_x^{\mathbf{E}}(\mathbf{v}))$ for $x \in \mathbf{E}_j$ ($0 \leq j \leq \ell$), $\mathbf{v} \in \mathbf{R}^n$. We note that if $n > p$, then $\pi_{\mathbf{R}^p}(I_{-1}^\ell \mathcal{T}(y)(\mathbf{v})) = \pi_{\mathbf{R}^p}(\mathcal{T}(y)(\mathbf{v}))$ and $\pi_{\mathbf{R}^p}(I_{-1}^\ell I_{-1}^\ell \mathcal{T}(y) I_{-1}^\ell(\mathbf{v})) = \pi_{\mathbf{R}^p}(\mathcal{T}(y) I_{-1}^\ell(\mathbf{v}))$ for $y \in \mathbf{R}^n$, $\mathbf{v} \in \mathbf{R}^n$.

In \mathbf{E}_j , let $S_{\mathbf{E}_j}^{p-1}$ denote the $(p-1)$ -sphere consisting of all points $(y_1, \dots, y_p, 0, \dots, 0)$ with $2(y_1^2 + \dots + y_p^2) = 1$. By Lemma 3.3, we have that H is of rank p outside of $\cup_{j=0}^\ell S_{\mathbf{E}_j}^{p-1}$ and that H is of rank $p-1$ on $\cup_{j=0}^\ell S_{\mathbf{E}_j}^{p-1}$. Hence, H defines a section $s_H : N \rightarrow \Omega^{n-p+1}(N, P)$.

Now we are ready to define a section $s \in \Gamma^{tr}(N, P)$ satisfying the assumption of Theorem 2.4. Under the identification (1.2), we first define $s(x) = (x, f(x); H_x, B_x)$ for $x \in \mathbf{E}_j$ as follows.

Let $n > p \geq 2$. Define the integer $I(j)$ to be $I(j) = j$ for $j \leq \mathbf{G}$ and $I(j) = 0$ for $j > \mathbf{G}$. Then we set

$$B_x = -(y_1(x)\Delta[4; I(j)], \dots, y_p(x)\Delta[4; I(j)]),$$

where if $x \in S_{\mathbf{E}_j}^{p-1}$, then we use the notation $c(x) = (c_1(x), \dots, c_n(x))$ in place of $y(x) = (y_1(x), \dots, y_n(x))$ and write $B_x = -(c_1(x)\Delta[4; I(j)], \dots, c_p(x)\Delta[4; I(j)])$. Recall that

$$\begin{aligned} H_x &= \pi_{\mathbf{R}^p} \circ (I_{-1}^n \mathcal{T}) \circ \mathbf{i}^i(y(x)) \\ &= \begin{cases} \pi_{\mathbf{R}^p} \circ (I_{-1}^n \mathcal{T})(y(x)) & \text{if } i \text{ is even,} \\ \pi_{\mathbf{R}^p} \circ (\mathcal{T} I_{-1}^n)(y(x)) & \text{if } i \text{ is odd.} \end{cases} \end{aligned}$$

By Lemma 3.3, if $x \in S_{\mathbf{E}_j}^{p-1}$, then $\text{Ker}H_x$ is generated by the vectors $\mathbf{c}(x)$, $\mathbf{e}_{p+1}, \dots, \mathbf{e}_n$ and $\text{Cok}H_x$ is generated and oriented by $-\dot{\mathbf{c}}(x)$. Furthermore, we have

$$\begin{aligned} q(s(x))(\mathbf{c}(x), \mathbf{c}(x)) &= 2(-\dot{\mathbf{c}}(x)), \\ q(s(x))(\mathbf{e}_k, \mathbf{c}(x)) &= 0 && \text{for } p < k \leq n, \\ q(s(x))(\mathbf{e}_k, \mathbf{e}_\ell) &= \begin{cases} 4\delta_{k\ell}(-\dot{\mathbf{c}}(x)) & \text{for } p < k \leq n - I(j) \text{ and } p < \ell \leq n, \\ -4\delta_{k\ell}(-\dot{\mathbf{c}}(x)) & \text{for } n - I(j) < k \leq n \text{ and } p < \ell \leq n. \end{cases} \end{aligned} \quad (3.3)$$

Namely, the symmetric matrix associated to $q(s(x))$ has the index $I(j)$ under the basis $\mathbf{c}(x)$, $\mathbf{e}_{p+1}, \dots, \mathbf{e}_n$.

Let $n = p \geq 2$. When $m \leq 0$ and n is even, we have to use $(I_{-1}^n \mathcal{T}) \circ \mathbf{i}^1(y(x))$ on \mathbf{E}_j for some j . By Lemma 3.3 (2), $\text{Ker}(I_{-1}^n \mathcal{T}(c(x)))$ (resp. $(I_{-1}^n \mathcal{T}) \circ \mathbf{i}^1(c(x))$) is generated by $\mathbf{c}(x)$ (resp. $I_{-1}^n(\mathbf{c}(x))$), and $\text{Cok}(I_{-1}^n \mathcal{T}(c(x)))$ (resp. $\text{Cok}((I_{-1}^n \mathcal{T}) \circ \mathbf{i}^1(y(x)))$) is generated and oriented by $-\mathbf{c}^-(x)$ (resp. $-\mathbf{c}(x)$). In the cases III, IV, VA, and VB with $j = 0$ we set

$$B_x = -(y_1(x)\Delta[4; 0], \dots, y_{n-1}(x)\Delta[4; 0], -y_n(x)\Delta[4; 0]) \quad \text{for } x \in \mathbf{E}_j.$$

Then it follows that

$$q(s(x))(\mathbf{c}(x), \mathbf{c}(x)) = 2(-\mathbf{c}^-(x)) \quad \text{on } S_{\mathbf{E}_j}^{p-1}. \quad (3.4)$$

If either $m = 0$ and $j = 1$, or $m < 0$, then we set

$$B_x = -(y_1(x)\Delta[4; 0], \dots, y_{n-1}(x)\Delta[4; 0], y_n(x)\Delta[4; 0]) \quad \text{for } x \in \mathbf{E}_j.$$

Then it follows that

$$q(s(x))(I_{-1}^n \mathbf{c}(x), I_{-1}^n \mathbf{c}(x)) = 2(-\mathbf{c}(x)) \quad \text{on } S_{\mathbf{E}_j}^{p-1}. \quad (3.5)$$

For $x \in S_{\mathbf{E}_j}^{p-1}$, $q(s(x))$ is nonsingular and hence $s(x) \in \Omega_{x, f(x)}^{n-p+1, 0}(N, P)$. If $x \notin \cup_{j=0}^{\ell} S_{\mathbf{E}_j}^{p-1}$, then H_x is nonsingular and we can extend H to a section $s \in \Gamma(N, P)$, since the fiber of $\pi_1^* |\Omega^{n-p+1, 0}(N, P)$ over $s(x)$ is contractible.

By construction, $S(s)^\iota$ is nonempty for each $0 \leq \iota \leq [(n-p+1)/2]$.

Next we see that s lies in $\Gamma^{tr}(N, P)$. By definition, $d^2(s)_\sim \circ d(s)_\sim : TN|_{S(s)} \rightarrow \text{Hom}(K(s), Q(s))$ on each $S_{\mathbf{E}_j}^{p-1}$ corresponds to the respective second intrinsic derivative $\mathbf{d}(\mathbf{T}I_{-\varepsilon}^n(\frac{1}{p}))$ or $\mathbf{d}(I_{-1}^n \mathcal{T})$ on each $S_{\mathbf{E}_j}^{p-1}$ in Lemma 3.3 (we note that \mathbf{i}^1 is a diffeomorphism). Hence, s is transverse to $\Sigma^{n-p+1}(N, P)$ on each $S_{\mathbf{E}_j}^{p-1}$. This implies the assertion.

We now consider the primary differences. Let $\mathcal{N}(s)$ be the orthogonal normal bundle of $\cup_{j=0}^{\ell} S_{\mathbf{E}_j}^{p-1}$. We show that $d(i_{\mathcal{N}(s)}|_{S_{\mathbf{E}_j}^{p-1}}, \Phi(s)|_{S_{\mathbf{E}_j}^{p-1}}) = 0$ for all \mathbf{E}_j except for **CaseVB**, $j = 1$ and **CaseVC**, $0 \leq j \leq |m| - 1$. By Lemma 3.3 and (3.2) we have $\mathcal{N}(s)_{c(x)} = K(s)_{c(x)}$, which are generated by $\mathbf{c}(x), \mathbf{e}_{p+1}, \dots, \mathbf{e}_n$ for $n > p$ and by $\mathbf{c}(x)$ for $n = p$. It follows from Lemma 3.3, (3.3), and (3.4) that $Q(s)_{c(x)}$ is generated and oriented by $-\dot{\mathbf{c}}(x)$ for $n > p$ and by $-\mathbf{c}^-(x)$ as described above for $n = p$. Furthermore, by the above fact about $d^2(s)_\sim \circ d(s)_\sim$, we have, in the case $n > p \geq 2$,

$$\begin{aligned} d_{c(x)} H(\sum_{i=1}^p c_i(x) \partial / \partial y_i)(\mathbf{c}(x)) &= 2(-\dot{\mathbf{c}}(x)), \\ d_{c(x)} H(\sum_{i=1}^p c_i(x) \partial / \partial y_i)(\mathbf{e}_k) &= \mathbf{0} \quad \text{for } p < k \leq n, \\ d_{c(x)} H(\partial / \partial y_k)(\mathbf{e}_\ell) &= \begin{cases} 2\delta_{k\ell}(-\dot{\mathbf{c}}(x)) & \text{for } p < k \leq n - I(j) \text{ and } p < \ell \leq n, \\ -2\delta_{k\ell}(-\dot{\mathbf{c}}(x)) & \text{for } n - I(j) < k \leq n \text{ and } p < \ell \leq n. \end{cases} \end{aligned}$$

Hence, we have that $i_{\mathcal{N}(s)}|_{S_{\mathbf{E}_j}^{p-1}}$ and $\Phi(s)|_{S_{\mathbf{E}_j}^{p-1}}$ are homotopic as monomorphisms $\mathcal{N}(s)_{c(x)} \rightarrow T_{c(x)}N$ by (3.3). The case $n = p$ is similar.

Finally we consider **CaseVB**, $j = 1$ and **CaseVC**, $0 \leq j \leq |m| - 1$. The kernel of $(I_{-1}^n \mathcal{T}) \circ \mathbf{i}^1(y(x))$ is generated by $I_{-1}^n(\mathbf{c}(x))$ and the map $\partial \mathbf{E}_j \rightarrow S^{n-1}$ defined by $x \mapsto \sqrt{2}I_{-1}^n(\mathbf{c}(x))$ is of degree -1 . Since the map $\partial \mathbf{E}_j \rightarrow S^{n-1}$ defined by $x \mapsto \sqrt{2}(\mathbf{c}(x))$ is of degree 1, we have that $d(i_{\mathcal{N}(s)}|_{S_{\mathbf{E}_j}^{p-1}}, \Phi(s)|_{S_{\mathbf{E}_j}^{p-1}}) = 1 - (-1) = 2$. We have a way to remove this obstruction by using Remark 4.5 and Lemma 5.6. Let $g_n : \mathbf{R}^n \rightarrow \mathbf{R}^n$ be the fold map defined by $g_n(x_1, \dots, x_n) = (x_1, \dots, x_{n-1}, x_n^2)$. By Remark 4.5, we can choose two distinct points $c_j^1(x), c_j^2(x)$ of $S_{\mathbf{E}_j}^{p-1}$ for all such j 's and respective small ball neighborhoods $U(c_j^1(x)), V(c_j^1(x))$ and $U(c_j^2(x)), V(c_j^2(x))$ with $V(c_j^1(x)) \subset \text{Int}U(c_j^1(x))$ and $V(c_j^2(x)) \subset \text{Int}U(c_j^2(x))$, which do not intersect with the other \mathbf{E}_k . Furthermore, there exists a homotopy $s_\lambda \in \Gamma^{tr}(N, P)$ such that for all j in **CaseVB**, $j = 1$ and **CaseVC**, $0 \leq j \leq |m| - 1$,

- (1) $s_0 = s$ and $S(s_\lambda) = S(s)$,
- (2) $s_\lambda|(N \setminus (U(c_j^1(x)) \cup U(c_j^2(x)))) = s|(N \setminus (U(c_j^1(x)) \cup U(c_j^2(x))))$,
- (3) $s_1|V(c_j^1(x)) = j^2 g_n|V(c_j^1(x))$ and $s_1|V(c_j^2(x)) = j^2 g_n|V(c_j^2(x))$ hold under suitable coordinates on $U(c_j^1(x)), U(c_j^2(x)), \pi_P \circ s_1(U(c_j^1(x)))$ and $\pi_P \circ s_1(U(c_j^2(x)))$, where the n -disk D_{10}^n with radius 10 in \mathbf{R}^n corresponds to those points inside $\text{Int}V(c_j^1(x))$ and $\text{Int}V(c_j^2(x))$.

We replace $s_1 = j^2 g_n$ with the section ϖ^+ given in Lemma 5.6 on $V(c_j^1(x))$ and $V(c_j^2(x))$ for each j . We denote this new section by \mathfrak{s} . Then by the additive property of the primary difference we have $d(i_{\mathcal{N}(\mathfrak{s})}|_{S_{\mathbf{E}_j}^{p-1}}, \Phi(\mathfrak{s})|_{S_{\mathbf{E}_j}^{p-1}}) = 0$.

This implies that s for the cases except for **CaseVB**, $j = 1$ and **CaseVC**, $0 \leq j \leq |m| - 1$ and \mathfrak{s} satisfy the assumption of Theorem 2.4. Therefore, the assertion of Theorem 0.3 follows from Theorem 2.4. This completes the proof. \square

We obtain another version of a theorem due to Éliášberg[E2, 5.1D and 5.4].

Corollary 3.4. *Let $n \geq p \geq 2$. Any continuous map $f : S^n \rightarrow S^p$ is homotopic to a fold-map which folds exactly on the boundaries of a finite number of disjointly embedded disks of dimension p within an embedded disk of dimension p in S^n .*

After this paper was submitted, the author was informed of the result [Sp, Theorem 5.1], which is related to Theorem 0.3. The approach of the arguments to his result seems quite different from ours.

4 Proof of Theorem 2.4

Let δ be a small positive smooth function on a manifold X equipped with a Riemannian metric and let E be a subbundle of TX . In this paper $D_\delta(E)$ always denotes the associated disk bundle of E with radius δ such that $\exp_{X,x}|D_\delta(E)_x$ is an embedding for any $x \in X$.

The method of the proof of Theorem 2.4 is technically the same as the proof of [An3, Proposition 4.6] for the case $n = p$. Nevertheless, it will be necessary in understanding Theorem 0.5 to write it noticing the arguments and tools for the case $n > p$.

Let s be a section of $\Gamma^{tr}(N, P)$ and let M be any one of $M(s)_j^t$'s. If $d(i_{\mathcal{N}(s)}|_M, \Phi(s)|_M) = 0$, then there exists a homotopy $\varphi^M(s)_\lambda : \mathcal{N}(s)|_M \rightarrow TN|_M$ relative to $M \setminus \text{Int}N_1$ in $\text{Mono}(\mathcal{N}(s)|_M, TN|_M)$ such that $\varphi^M(s)_0 = i_{\mathcal{N}(s)}|_M$ and $\varphi^M(s)_1 = \Phi(s)|_M$ by the definition of the primary difference. Let $\text{Iso}(TN|_M, TN|_M)$ denote the space consisting of all isomorphisms of T_cN , $c \in M$. We define the restriction map

$$r_M : \text{Iso}(TN|_M, TN|_M) \rightarrow \text{Mono}(\mathcal{N}(s)|_M, TN|_M)$$

by $r_M(h) = h|_{\mathcal{N}(s)_c}$, where $h : T_cN \rightarrow T_cN$. Then r_M induces a structure of a fiber bundle with fiber $\text{Iso}(\mathbf{R}^{p-1}, \mathbf{R}^{p-1}) \times \text{Hom}(\mathbf{R}^{p-1}, \mathbf{R}^{n-p+1})$. By applying the covering homotopy property of the fiber bundle r_M to the sections $id_{TN|_M}$ and the homotopy $\varphi^M(s)_\lambda$, we obtain a homotopy $\Phi^M(s)_\lambda : TN|_M \rightarrow TN|_M$ such that $\Phi^M(s)_0 = id_{TN|_M}$, $\Phi^M(s)_\lambda|_c = id_{T_cN}$ for any $c \in M \setminus \text{Int}N_1$ and $r_M \circ \Phi^M(s)_\lambda = \varphi^M(s)_\lambda$. We define $\Phi(s)_\lambda : TN|_{S(s)} \rightarrow TN|_{S(s)}$ by $\Phi(s)_\lambda|_M = \Phi^M(s)_\lambda$ and $\Phi(s)_\lambda|_c = id_{T_cN}$ for any $c \in U(C) \cap S(s)$. In the proof of the following lemma, $\Phi(s)_\lambda|_c$ ($c \in S(s)$) is regarded as a linear isomorphism of T_cN .

Let r_0 be a small positive real number with $r_0 < 1/10$.

Lemma 4.1. *Let $s \in \Gamma^{tr}(N, P)$ be a section satisfying the hypotheses of Theorem 2.4. Then there exists a homotopy s_λ relative to $N \setminus \text{Int}N_{2-4r_0}$ in $\Gamma^{tr}(N, P)$ with $s_0 = s$ satisfying*

$$(4.1.1) \text{ for any } \lambda, S(s_\lambda) = S(s),$$

$$(4.1.2) \text{ for any point } c \in S(s_1), \text{ we have } K(s_1)_c = \mathcal{N}(s)_c \text{ and } d^2(s_1)_\sim \circ d(s_1)_\sim|K(s_1) = d^2s_1|K(s_1).$$

Proof. Recall the exponential map $\exp_{N,x} : T_xN \rightarrow N$ defined near $\mathbf{0} \in T_xN$. We write an element of $\mathcal{N}(s)_c$ as (c, \mathbf{v}) . There exists a small positive number δ such that the map

$$e : D_\delta(\mathcal{N}(s))|_{S(s) \cap N_2} \rightarrow N$$

defined by $e(c, \mathbf{v}) = \exp_{N,c}(c, \mathbf{v})$ is an embedding, where $c \in S(s) \cap N_2$ and $(c, \mathbf{v}) \in D_\delta(\mathcal{N}(s)_c)$ (note that $e|_{S(s) \cap N_2}$ is the inclusion). Let $\psi : [0, \infty) \rightarrow [0, 1]$ be a decreasing smooth function such that $\psi(t) = 1$ if $t \leq \delta/10$ and $\psi(t) = 0$ if $t \geq \delta$.

If we represent $s(x) \in \Omega^{n-p+1,0}(N, P)$ by a jet $j_x^2 \sigma_x$ for a germ $\sigma_x : (N, x) \rightarrow (P, \pi_P^2 \circ s(x))$, then we define the homotopy s_λ of $\Gamma^{tr}(N, P)$ using $\Phi(s)_\lambda$ by

$$\begin{cases} s_\lambda(e(c, \mathbf{v})) \\ = j_{e(c, \mathbf{v})}^2(\sigma_{e(c, \mathbf{v})} \circ \exp_{N,c} \circ \widetilde{\Phi(s)}_{\psi(\|\mathbf{v}\|)}|_c \circ \exp_{N,c}^{-1}) & \text{if } c \in S(s) \cap N_2 \text{ and } \|\mathbf{v}\| \leq \delta, \\ s_\lambda(x) = s(x) & \text{if } x \notin \text{Im}(e). \end{cases} \quad (4.1)$$

Here, $\widetilde{\Phi(s)}_{\psi(\|\mathbf{v}\|)}|_c$ refers to $\ell(\mathbf{v}) \circ (\Phi(s)_{\psi(\|\mathbf{v}\|)}|_c) \circ \ell(-\mathbf{v})$, where $\ell(*)$ is defined in §1. If $\|\mathbf{v}\| \geq \delta$, then

$\Phi(s)_{\psi(\|\mathbf{v}\|)\lambda}|_c = \Phi(s)_0|_c$, and if $c \in S(s) \setminus \text{Int}N_{2-4r_0}$, then $\Phi(s)_\lambda|_c = \Phi(s)_0|_c$. In these cases we have

$$\begin{aligned} s_\lambda(e(c, \mathbf{v})) &= j_{e(c, \mathbf{v})}^2(\sigma_{e(c, \mathbf{v})} \circ \exp_{N, c} \circ \widetilde{\Phi}(s)_{\psi(\|\mathbf{v}\|)\lambda}|_c \circ \exp_{N, c}^{-1}) \\ &= j_{e(c, \mathbf{v})}^2(\sigma_{e(c, \mathbf{v})}) \\ &= s(e(c, \mathbf{v})). \end{aligned}$$

Hence, s_λ is well defined. Furthermore, we have that

- (1) $\pi_P^2 \circ s_\lambda(x) = \pi_P^2 \circ s(x)$,
- (2) $S(s_\lambda) = S(s)$,
- (3) if $c \in S(s)$, then we have that $\Phi(s)_1(\mathcal{N}(s)_c) = K(s)_c$,
- (4) s_λ is transverse to $\Sigma^{n-p+1, 0}(N, P)$.

The property (4.1.2) is satisfied for s_1 by (4.1) and (3). \square

For a vector bundle \mathcal{F} over Σ and a map $j : S \rightarrow \Sigma$, the induced bundle map $j^*(\mathcal{F}) \rightarrow \mathcal{F}$ over j is denoted by $j^\mathcal{F}$ in the following.

The following lemma is proved similarly as in [An3, Lemma 6.2] by using the Hirsch Immersion Theorem [H1], and its proof is left to the reader.

Lemma 4.2. *Let s be a section of $\Gamma^{\text{tr}}(N, P)$ satisfying the property (4.1.2) for s (in place of s_1) of Lemma 4.1. Then there exists a homotopy s_λ relative to $N \setminus \text{Int}N_{2-4r_0}$ in $\Gamma^{\text{tr}}(N, P)$ with $s_0 = s$ such that*

- (4.2.1) $S(s_\lambda) = S(s)$ for any λ ,
- (4.2.2) $\pi_P^2 \circ s_1|_{S(s_1)}$ is an immersion into P such that $d(\pi_P^2 \circ s_1|_{S(s_1)}) : TS(s_1) \rightarrow TP$ is equal to $(\pi_P^2 \circ s_1)^{TP} \circ d^1 s_1|_{TS(s_1)}$, where $(\pi_P^2 \circ s_1)^{TP} : (\pi_P^2 \circ s_1)^*TP \rightarrow TP$ is the canonical induced bundle map.

Here we give two lemmas necessary for the proof of Theorem 2.4. Their proofs are elementary and so are left to the reader.

Lemma 4.3. *Let $\pi : E \rightarrow S$ be a smooth $(n - p + 1)$ -dimensional vector bundle with metric over a $(p - 1)$ -dimensional manifold, where S is identified with the zero-section. Let $f_i : E \rightarrow P$ ($i = 1, 2$) be fold-maps which fold exactly on S such that*

- (i) $f_1|_S = f_2|_S$,
- (ii) $d_c f_1 = d_c f_2$ and $d_c^2 f_1 = d_c^2 f_2$ for any $c \in S$,
- (iii) $K(j^2 f_i)_c$ are tangent to $\pi^{-1}(c)$ for any $c \in S$.

Let $\eta : S \rightarrow [0, 1]$ be any smooth function. Then there exists a positive function $\varepsilon : S \rightarrow \mathbf{R}$ such that $\exp_{P, f_1(c)}((1 - \eta(c)) \exp_{P, f_1(c)}^{-1}(f_1(\mathbf{v}_c)) + \eta(c) \exp_{P, f_2(c)}^{-1}(f_2(\mathbf{v}_c)))$, which is denoted simply by $((1 - \eta)f_1 + \eta f_2)(\mathbf{v}_c)$, is contained in a convex neighborhood of $f_1(c) = f_2(c)$ in P for any $c \in S$ and $\mathbf{v}_c \in \pi^{-1}(c)$ with $\|\mathbf{v}_c\| \leq \varepsilon(c)$, and that the map $(1 - \eta)f_1 + \eta f_2$ is a fold-map which folds exactly on S and satisfies $d_c((1 - \eta)f_1 + \eta f_2) = d_c f_i$ and $d_c^2((1 - \eta)f_1 + \eta f_2) = d_c^2 f_i$.

Lemma 4.4. *Let $\pi : E \rightarrow S$ be a smooth $(n - p + 1)$ -dimensional vector bundle with metric over a $(p - 1)$ -dimensional manifold, where S is identified with the zero-section, and let (Ω, Σ) be a pair of a smooth manifold and its submanifold of codimension $n - p + 1$. Let $\varepsilon : S \rightarrow \mathbf{R}$ be a positive smooth function. Let $h_i : D_\varepsilon(E) \rightarrow (\Omega, \Sigma)$ ($i = 0, 1$) be smooth maps such that $S = h_0^{-1}(\Sigma) = h_1^{-1}(\Sigma)$, $h_0|_S = h_1|_S$ and that h_i are transverse to Σ . Assume that for any $c \in S$, the isomorphisms $T_c E / T_c S \rightarrow T_{h_i(c)} \Omega / T_{h_i(c)} \Sigma$ induced from $d_c(h_i)$ coincide with each other. Then for a sufficiently small positive function $\varepsilon : S \rightarrow \mathbf{R}$, there exists a homotopy $h_\lambda : (D_\varepsilon(E), S) \rightarrow (\Omega, \Sigma)$ between h_0 and h_1 such that*

- (1) $h_\lambda|_S = h_0|_S$, $h_\lambda^{-1}(\Sigma) = h_0^{-1}(\Sigma)$ for any λ ,
- (2) h_λ is smooth and is transverse to Σ for any λ .

Proof of Theorem 2.4. By Lemmas 4.1 and 4.2 we may assume that s satisfies (4.1.2) and (4.2.2), where s_1 is replaced by s . In particular, we have $\mathcal{N}(s) = K(s)$. Since s is an embedding, we can choose a Riemannian metric on $\Omega^{n-p+1, 0}(N, P)$ so that the induced metric by s coincides with the metric on N

near $S(s)$. We set $E(S(s)) = \exp_N(D_{\delta \circ s}(K(s)))$, where $\delta : \Sigma^{n-p+1,0}(N, P) \rightarrow \mathbf{R}$ is a sufficiently small positive function such that $\delta \circ s|_{(S(s) \cap N_2)}$ is constant. This becomes a tubular neighborhood of $S(s)$.

We first prove the following assertion:

(A) There exists a homotopy h_λ relative to $N \setminus \text{Int}N_{2-2r_0}$ in $\Gamma^{tr}(N, P)$ with $h_0 = s$ satisfying the following.

(1) $h_\lambda \in \Gamma^{tr}(N, P)$ and $S(h_\lambda)^\iota = S(s)^\iota$ for any λ and ι .

(2) We have a fold-map $G : (N \setminus \text{Int}N_{2-2r_0}) \cup E(S(s)) \rightarrow P$ with $j^2G = h_1$.

Take any Riemannian metric on P . If we identify $Q(s)$ with the orthogonal normal line bundle to the immersion $\pi_P^2 \circ s|_{S(s)} : S(s) \rightarrow P$, then $\exp_P \circ (\pi_P^2 \circ s|_{S(s)})^{TP} |D_\gamma(Q(s))$ is an immersion for some positive function γ . In the proof we express a point of $E(S(s))$ as \mathbf{v}_c , where $c \in S(s)$, $\mathbf{v}_c \in K(s)_c$ and $\|\mathbf{v}_c\| \leq \delta(s(c))$. In the proof we say that a smooth homotopy

$$k_\lambda : (E(S(s)), \partial E(S(s))) \rightarrow (\Omega^{n-p+1,0}(N, P), \Sigma^{n-p}(N, P))$$

has the property (C) if it satisfies that for any λ

(C-1) $k_\lambda^{-1}(\Sigma^{n-p+1,0}(N, P)) = S(s)$, and $k_\lambda|_{S(s)} = k_0|_{S(s)}$,

(C-2) k_λ is smooth and transverse to $\Sigma^{n-p+1,0}(N, P)$.

We have the quadratic form $q(s) : S^2K(s) \rightarrow Q(s)$ defined in §1 such that

$$q(s)_c(\mathbf{v}_c, \mathbf{w}_c) = (d_c^2 s(\mathbf{v}_c))(\mathbf{w}_c) \quad \text{for any point } c \in S(s).$$

If we choose δ sufficiently small compared with γ , then we can define the fold-map $g_0 : E(S(s)) \rightarrow P$ by

$$g_0(\mathbf{v}_c) = \exp_{P, \pi_P^2 \circ s(c)} \circ (\pi_P^2 \circ s|_{S(s)})^{TP} (q(s)_c(\mathbf{v}_c, \mathbf{v}_c)). \quad (4.2)$$

Now we need to modify g_0 by using Lemma 4.3 so that g_0 is compatible with g . Let $\eta : S(s) \rightarrow \mathbf{R}$ be a smooth function such that

(i) $0 \leq \eta(c) \leq 1$ for $c \in S(s)$,

(ii) $\eta(c) = 0$ for $c \in S(s) \setminus \text{Int}N_{2-3r_0}$,

(iii) $\eta(c) = 1$ for $c \in S(s) \cap N_{2-4r_0}$.

Then consider the map $G : (N \setminus \text{Int}N_{2-2r_0}) \cup E(S(s)) \rightarrow P$ defined by

$$\begin{cases} G(x) = g(x) & \text{if } x \in N \setminus \text{Int}N_{2-2r_0}, \\ G(\mathbf{v}_c) = (1 - \eta(c))g(\mathbf{v}_c) + \eta(c)g_0(\mathbf{v}_c) & \text{if } \mathbf{v}_c \in E(S(s)). \end{cases}$$

Without loss of generality we may assume that G is well-defined on a neighborhood of $(N \setminus \text{Int}N_{2-2r_0}) \cup E(S(s))$ by replacing δ and $E(S(s))$ by smaller ones. It follows from Lemma 4.3 that G is a fold-map defined on a neighborhood of $(N \setminus \text{Int}N_{2-2r_0}) \cup E(S(s))$, that $G|_{E(S(s))}$ folds exactly on $S(s)$, and that $d_c(G) = d_c(g_0)$ and $d_c^2(G) = d_c^2(g_0)$ for all $c \in S(s)$. Furthermore, we note that if $c \in S(s) \setminus N_{2-2r_0}$, then $G(\mathbf{v}_c) = g(\mathbf{v}_c)$.

Next we construct a homotopy H_λ relative to $N \setminus \text{Int}N_{2-2r_0}$ in $\Gamma^{tr}((N \setminus \text{Int}N_{2-2r_0}) \cup E(S(s)), P)$ satisfying the property (C) such that $H_0 = s|(N \setminus \text{Int}N_{2-2r_0}) \cup E(S(s))$ and $H_1 = j^2G$ on $(N \setminus \text{Int}N_{2-2r_0}) \cup E(S(s))$. This construction is quite similar to that in [An3, Proof of Proposition 4.6], while we write it down for completeness.

Set $\exp_\Omega = \exp_{\Omega^{n-p+1,0}(N, P)}$ for simplicity. By applying Lemma 4.4 to the sections s and $\exp_\Omega \circ ds \circ (\exp_N |D_\delta(K(s)))^{-1}$ on $E(S(s))$, we first obtain a homotopy $h'_\lambda \in \Gamma^{tr}(E(S(s)), P)$ with $h'_0 = s$ and $h'_1 = \exp_\Omega \circ ds \circ (\exp_N |D_\delta(K(s)))^{-1}$ on $E(S(s))$ satisfying the properties (1) and (2) of Lemma 4.4. Let $p_\Omega : T\Omega^{n-p+1,0}(N, P)|_{\Sigma^{n-p+1,0}(N, P)} \rightarrow T\Omega^{n-p+1,0}(N, P)|_{\Sigma^{n-p+1,0}(N, P)}/T\Sigma^{n-p+1,0}(N, P)$ be the canonical projection.

We have $K(s) = \mathcal{N}(s)$ and $d^2(s)_\sim \circ d(s)_\sim |K(s) = d^2 s |K(s)$. This yields that $p_\Omega \circ ds |K(s)$ and $p_\Omega \circ (s|S(s))^\mathbf{K} : K(s) \rightarrow T\Omega^{n-p+1,0}(N, P)|_{\Sigma^{n-p+1,0}(N, P)}/T\Sigma^{n-p+1,0}(N, P)$ coincide with each other. By Lemma 4.4 we can construct a homotopy h''_λ in $\Gamma^{tr}(E(S(s)), P)$ with the property (C) such that $h''_0 = h'_1$ and $h''_1 = \exp_\Omega \circ (s|S(s))^\mathbf{K} \circ (\exp_N |D_\delta(K(s)))^{-1}$ on $E(S(s))$. By pasting h'_λ and h''_λ we obtain a homotopy $h_\lambda \in$

$\Gamma^{tr}(E(S(s)), P)$ satisfying the property (C) with $h_0^1 = s$ and $h_1^1 = \exp_\Omega \circ (s|S(s))^{\mathbf{K}} \circ (\exp_N |D_\delta(K(s)))^{-1}$ on $E(S(s))$.

We now recall the additive structure of $J^2(N, P)$ in (1.2). Then we have the homotopy $j_\lambda : S(s) \rightarrow J^2(N, P)$ defined by

$$j_\lambda(c) = (1 - \lambda)s(c) + \lambda j^2 G(c) \quad \text{covering } \pi_P^2 \circ s|S(s) : S(s) \rightarrow P,$$

where $\pi_P^2 \circ s|S(s)$ is the immersion as in (4.2.2). Since $K(s)_c = K(j^2 G)_c$ and $Q(s)_c = Q(j^2 G)_c$ by the construction of $\pi_P^2 \circ s|S(s)$ and the fold-map G , it follows that for any $c \in S(s)$ we have $K(j_\lambda)_c = K(s)_c$ and $Q(j_\lambda)_c = Q(s)_c$. Hence, we have that

$$d_c^i(j_\lambda) = (1 - \lambda)d_c^i(s) + \lambda d_c^i(j^2 G) = d_c^i(s) = d_c^i(j^2 G).$$

This implies that j_λ is a map of $S(s)$ into $\Sigma^{n-p+1,0}(N, P)$. Therefore, the homotopy of bundle maps $(j_\lambda)^{\mathbf{K}} : K(s) \rightarrow (\mathbf{K} \subset) T\Omega^{n-p+1,0}(N, P)$ induces the homotopy h_λ^2 satisfying the property (C) defined by

$$h_\lambda^2 = \exp_\Omega \circ (j_\lambda)^{\mathbf{K}} \circ (\exp_N |D_\delta(K(s)))^{-1} |E(S(s))$$

such that $h_0^2 = h_1^1 = \exp_\Omega \circ (s|S(s))^{\mathbf{K}} \circ (\exp_N |D_\delta(K(s)))^{-1}$ and $h_1^2 = \exp_\Omega \circ (j^2 G|S(s))^{\mathbf{K}} \circ (\exp_N |D_\delta(K(s)))^{-1}$ on $E(S(s))$.

By applying Lemma 4.4 to $j^2 G|E(S(s))$ similarly as h_λ^1 , we have a homotopy h_λ^3 satisfying the property (C) such that $h_0^3 = h_1^2 = \exp_\Omega \circ (j^2 G|S(s))^{\mathbf{K}} \circ (\exp_N |D_\delta(K(s)))^{-1}$ and $h_1^3 = j^2 G$ on $E(S(s))$.

Furthermore, we need to modify the homotopy obtained by pasting h_λ^1, h_λ^2 and h_λ^3 on $(N_2 \setminus \text{Int}N_{2-4r_0}) \cap E(S(s))$ to a homotopy H'_λ in $\Gamma^{tr}(N_2 \cap E(S(s)), P)$ satisfying the property (C) such that H'_λ coincides with $j^2 G$ on $N_2 \cap E(S(s))$ and $H'_\lambda|((N_2 \setminus \text{Int}N_{2-2r_0}) \cap E(S(s))) = s|((N_2 \setminus \text{Int}N_{2-2r_0}) \cap E(S(s)))$. Then we can extend H'_λ to the homotopy H_λ in $\Gamma^{tr}((N \setminus \text{Int}N_{2-2r_0}) \cup E(S(s)), P)$ satisfying the property (C) so that $H_\lambda(x) = s(x)$ for $x \in N \setminus \text{Int}N_{2-2r_0}$.

By applying the homotopy extension property to s and H_λ , we obtain an extended homotopy with $h_0 = s$,

$$h_\lambda : (N, S(s)) \rightarrow (\Omega^{n-p+1,0}(N, P), \Sigma^{n-p+1,0}(N, P)).$$

Hence, h_λ is a required homotopy in $\Gamma^{tr}(N, P)$ in the assertion (A).

We apply Theorem 2.2 for the section $\pi_1^2 \circ h_1$ and G . Since $J^1(N, P)$ is canonically identified with $\text{Hom}((\pi_N)^*(TN), (\pi_P)^*(TP))$, we may regard $\pi_1^2 \circ h_1$ as a homomorphism in $\mathfrak{m}(N, P; S(s)^0, \dots, S(s)^{\lfloor (n-p+1)/2 \rfloor}, N \setminus \text{Int}N_{2-r_0}, G)$. By Theorem 2.2 we obtain a homotopy $B_\lambda : TN \rightarrow TP$ relative to $N \setminus \text{Int}N_{2-r_0}$ of $\mathfrak{m}(N, P; S(s)^0, \dots, S(s)^{\lfloor (n-p+1)/2 \rfloor}, N \setminus \text{Int}N_{2-r_0}, G)$ and a fold-map $f : N \rightarrow P$ with $S(f) = S(h_1)$ such that $B_0 = \pi_1^2 \circ h_1$ and $B_1 = df$. The homomorphism $B_\lambda : TN \rightarrow TP$ in $\mathfrak{m}(N, P; S^0, \dots, S^{\lfloor (n-p+1)/2 \rfloor}, N \setminus \text{Int}N_{2-r_0}, G)$ satisfies, by definition, that for any point $c \in S(s)^\iota$ and any λ there exist a small neighborhood U_c^λ and a fold-map $f_{U_c^\lambda} : U_c^\lambda \rightarrow P$ such that $df_{U_c^\lambda} = B_\lambda|TU_c^\lambda$ and $S(j^2 f_{U_c^\lambda})^\iota = S(s)^\iota \cap U_c^\lambda$. Then this homotopy is lifted to a homotopy \widetilde{B}_λ relative to $N \setminus \text{Int}N_{2-r_0}$ in $\Gamma(N, P)$ such that

- (1) $\widetilde{B}_0 = h_1$,
- (2) $\widetilde{B}_1 = j^2 f$,
- (3) $\pi_1^2 \circ \widetilde{B}_\lambda = B_\lambda$,
- (4) for any point $c \in S(s)$, $d_c^2(\widetilde{B}_\lambda(c)) = d_c^2 f_{U_c^\lambda}$,

since any fiber of $\pi_1^2 : \Omega^{n-p+1,0}(N, P) \setminus \Sigma^{n-p+1,0}(N, P) \rightarrow J^1(N, P) \setminus \Sigma^{n-p+1}(N, P)$ is contractible and so on. Finally we obtain the required homotopy s_λ by pasting h_λ and \widetilde{B}_λ .

By the construction, we have that $S(s_\lambda) = S(s)$ and $Q(s_\lambda) = Q(s)$ for all λ . This proves Theorem 2.4 (3). \square

Remark 4.5. Let $g^\iota : \mathbf{R}^n \rightarrow \mathbf{R}^p$ be the fold map defined by $g^\iota(x_1, \dots, x_n) = (x_1, \dots, x_{p-1}, x_p^2 + \dots + x_{n-\iota}^2 - x_{n-\iota+1}^2 - \dots - x_n^2)$. Let $s \in \Gamma^{tr}(N, P)$ satisfy the same assumption of Proposition 2.5. Then by the argument in the above proof (in particular, by (4.2)) we can prove the following. Given a point c of $M(s)_j^\iota$, there exist small ball neighborhoods $U(c), V(c)$ of c with $V(c) \subset \text{Int}U(c)$ and a homotopy $s_\lambda \in \Gamma^{tr}(N, P)$ such that $U(c)$ does not intersect all the other $M(s)_j^\iota$'s and that

- (1) $s_0 = s$ and $S(s_\lambda) = S(s)$,
- (2) $s_\lambda|(N \setminus U(c)) = s|(N \setminus U(c))$,
- (3) $s_1|V(c) = j^2 g^t|V(c)$ under suitable coordinates of $U(c)$ and $\pi_p^2 \circ s_1(U(c))$.

5 Proof of Proposition 2.5

Let X be an $i \times j$ matrix and Y be a $k \times \ell$ matrix. Then $X \dot{+} Y$ denotes the $(i+k) \times (j+\ell)$ matrix, which is the direct sum of X and Y . Let D_r^k be the k -disk of radius r in \mathbf{R}^k . For a point $x = (x_1, \dots, x_n) \in \mathbf{R}^n$ ($n > p$), set $\dot{x} = (x_1, \dots, x_p)$ and $\star x = (x_{p+1}, \dots, x_n)$. Let $\varkappa : [0, \infty) \rightarrow [0, 1]$ be a decreasing smooth function such that $\varkappa(t) = 1$ for $0 \leq t \leq 1/10$, $0 < \varkappa(t) < 1$ for $1/10 < t < 1$, and $\varkappa(t) = 0$ for $t \geq 1$. Using the identification $J^2(n, p) \cong \text{Hom}(\mathbf{R}^n, \mathbf{R}^p) \oplus \text{Hom}(S^2 \mathbf{R}^n, \mathbf{R}^p)$ in (1.4), we express an element of $J^2(n, p)$ as $(\mathbf{A}_{p \times n}; \mathbf{B}_{n \times n}^1, \dots, \mathbf{B}_{n \times n}^p)$, where $\mathbf{A}_{p \times n}$ is a $p \times n$ matrix and $\mathbf{B}_{n \times n}^j$ are $n \times n$ symmetric matrices. Similarly, $(A_{p \times p}; B_{p \times p}^1, \dots, B_{p \times p}^p)$ expresses an element of $J^2(p, p)$. Set

$A_{p \times p}^\varkappa(x) = \varkappa(\|\dot{x}\|)A_{p \times p} + (1 - \varkappa(\|\dot{x}\|))((E_{p-1}) \dot{+} (2x_p))$ and $\mathbf{B}_{n \times n}^p = B_{p \times p}^p \dot{+} \Delta(\overbrace{2, \dots, 2}^{n-p-\iota}, \overbrace{-2, \dots, -2}^\iota)$ with $0 \leq \iota \leq [(n-p+1)/2]$. Set

$$\mathbf{A}_{p \times n}^{\varkappa, \iota}(x) = \begin{pmatrix} A_{p \times p}^\varkappa(x) & \mathbf{0}_{(p-1) \times (n-p)} \\ 2x_{p+1}, \dots, 2x_{n-\iota}, -2x_{n-\iota+1}, \dots, -2x_n \end{pmatrix} \in \text{Hom}(\mathbf{R}^n, \mathbf{R}^p),$$

$$\mathbf{B}_{n \times n}^{\varkappa, j}(x) = \varkappa(\|\dot{x}\|)(B_{p \times p}^j \dot{+} \mathbf{0}_{(n-p) \times (n-p)}) \quad \text{for } 1 \leq j \leq p-1,$$

$$\mathbf{B}_{n \times n}^{\varkappa, \iota, p}(x) = \varkappa(\|\dot{x}\|)(\mathbf{B}_{n \times n}^p) + (1 - \varkappa(\|\dot{x}\|))\Delta(\overbrace{0, \dots, 0}^{p-1}, \overbrace{2, \dots, 2}^{n-p+1-\iota}, \overbrace{-2, \dots, -2}^\iota).$$

For $n > p \geq 3$, we define the map $\mathcal{J}_{p,n}^\iota(x) : J^2(p, p) \rightarrow J^2(n, p)$ by

$$\mathcal{J}_{p,n}^\iota(x)(A_{p \times p}; B_{p \times p}^1, \dots, B_{p \times p}^p) = (\mathbf{A}_{p \times n}^{\varkappa, \iota}(x); \mathbf{B}_{n \times n}^{\varkappa, 1}(x), \dots, \mathbf{B}_{n \times n}^{\varkappa, p-1}(x), \mathbf{B}_{n \times n}^{\varkappa, \iota, p}(x)). \quad (5.1)$$

Let $\mu : \mathbf{R}^p \rightarrow \mathbf{R}$ be a smooth map such that $\mu^{-1}(0)$ is connected and that $\mu(\dot{x}) = 2x_p$ outside of D_4^p . Let μ have 0 as a regular value for a while. Then $\mu^{-1}(0)$ is a $(p-1)$ -dimensional submanifold of \mathbf{R}^p such that $(\mathbf{R}^p \setminus D_4^p) \cap \mu^{-1}(0) = \mathbf{R}^{p-1} \times 0 \setminus D_4^p$. Let $N(\mu^{-1}(0))$ be the orthogonal normal line bundle of $\mu^{-1}(0)$ in \mathbf{R}^p , which is oriented by $\text{grad} \mu$, and let $\mathbf{e}(N(\mu^{-1}(0))_c)$ be the unit vector consistent with the given orientation of $N(\mu^{-1}(0))_c$. We often identify $\mu^{-1}(0)$, $N(\mu^{-1}(0))$ and $\mathbf{e}(N(\mu^{-1}(0))_c)$ with $\mu^{-1}(0) \times \mathbf{0}_{n-p}$, the normal bundle of $\mu^{-1}(0) \times \mathbf{0}_{n-p}$ in $\mathbf{R}^p \times \mathbf{0}_{n-p}$ and its unit vector consistent with the given orientation respectively. We orient $\mu^{-1}(0)$ so that the juxtaposition of an oriented basis of $T_c \mu^{-1}(0)$ and $\mathbf{e}(N(\mu^{-1}(0))_c)$ is compatible with the canonical orientation of \mathbf{R}^p . We have the map $\mathbf{e}(\mu^{-1}(0)) : \mu^{-1}(0) \rightarrow S^{p-1}$ defined by $\mathbf{e}(\mu^{-1}(0))(c) = \mathbf{e}(N(\mu^{-1}(0))_c)$, and the induced homomorphism

$$\mathbf{e}(\mu^{-1}(0))^* : H^{p-1}(S^{p-1}, \mathbf{e}_p; \mathbf{Z}) \rightarrow H^{p-1}(\mu^{-1}(0), \mu^{-1}(0) \setminus D_4^p; \mathbf{Z}) \cong \mathbf{Z}.$$

Let $[\mu^{-1}(0)]^c \in H^{p-1}(\mu^{-1}(0), \mu^{-1}(0) \setminus D_4^p; \mathbf{Z})$ and $[S^{p-1}]^c \in H^{p-1}(S^{p-1}, \mathbf{e}_p; \mathbf{Z})$ denote the dual classes of the fundamental classes $[\mu^{-1}(0)]$ and $[S^{p-1}]$ respectively. The integer $\text{deg}(\mathbf{e}(\mu^{-1}(0)))$ such that $\mathbf{e}(\mu^{-1}(0))^*([S^{p-1}]^c) = \text{deg}(\mathbf{e}(\mu^{-1}(0)))[\mu^{-1}(0)]^c$ is called the degree of $\mathbf{e}(\mu^{-1}(0))$.

We give another interpretation of $\text{deg}(\mathbf{e}(\mu^{-1}(0)))$. There are two monomorphisms $i_{N(\mu^{-1}(0))}$ and $\mathbf{n}_{\mu^{-1}(0)}$ in $\text{Mono}(N(\mu^{-1}(0)), T\mathbf{R}^p|_{\mu^{-1}(0)})$, where $i_{N(\mu^{-1}(0))}$ is the inclusion and $\mathbf{n}_{\mu^{-1}(0)}$ is defined by $\mathbf{n}_{\mu^{-1}(0)}(\mathbf{e}(N(\mu^{-1}(0))_c)) = (c, \mathbf{e}_p)$ for $c \in \mu^{-1}(0)$. It is clear that if $c \in \mu^{-1}(0) \setminus D_4^p$, then $i_{N(\mu^{-1}(0))}(\mathbf{e}(N(\mu^{-1}(0))_c)) = \mathbf{n}_{\mu^{-1}(0)}(\mathbf{e}(N(\mu^{-1}(0))_c)) = (c, \mathbf{e}_p)$. We regard $i_{N(\mu^{-1}(0))}$ and $\mathbf{n}_{\mu^{-1}(0)}$ as sections of the fiber bundle $\text{Mono}(N(\mu^{-1}(0)), T\mathbf{R}^p|_{\mu^{-1}(0)})$ over $\mu^{-1}(0)$. Then in the obstruction theory ([Ste, §37.5]), the primary difference

$d(i_{N(\mu^{-1}(0))}, \mathbf{n}_{\mu^{-1}(0)})$ in $H^{p-1}(\mu^{-1}(0), \mu^{-1}(0) \setminus D_4^p; \pi_{p-1}(\text{Mono}(\mathbf{R}, \mathbf{R}^p)))$ is defined to be the unique obstruction so that $i_{N(\mu^{-1}(0))}$ and $\mathbf{n}_{\mu^{-1}(0)}$ are homotopic as sections of $\text{Mono}(N(\mu^{-1}(0)), T\mathbf{R}^p|_{\mu^{-1}(0)})$ relative to $\mu^{-1}(0) \setminus D_4^p$.

We prove the following lemma.

Lemma 5.1. *Under the identification $H^{p-1}(\mu^{-1}(0), \mu^{-1}(0) \setminus D_4^p; \pi_{p-1}(\text{Mono}(\mathbf{R}, \mathbf{R}^p))) \cong H^{p-1}(\mu^{-1}(0), \mu^{-1}(0) \setminus D_4^p; \mathbf{Z}) \cong \mathbf{Z}$, the primary difference $d(i_{N(\mu^{-1}(0))}, \mathbf{n}_{\mu^{-1}(0)})$ coincides with $\deg(\mathbf{e}(\mu^{-1}(0)))$.*

Proof. Consider a triangulation of $\mu^{-1}(0)$ such that $\mu^{-1}(0) \cap D_4^p$ is a subcomplex and take a base point of $\mu^{-1}(0)$ outside D_4^p . Let Z be a $(p-1)$ -simplex. Then there exists an isomorphism $\phi_Z : Z \times (\mathbf{0}_{p-1} \times \mathbf{R}) \rightarrow N(\mu^{-1}(0))|_Z$ induced from a curve connecting Z and the base point. Since $N(\mu^{-1}(0))$ is a trivial line bundle, we may assume that ϕ_Z is defined by $\phi_Z(c, \mathbf{e}_p) = \mathbf{e}(N(\mu^{-1}(0))_c)$ for any $c \in Z$. Then $\{i_{N(\mu^{-1}(0))} \circ \phi_Z\}$ and $\{\mathbf{n}_{\mu^{-1}(0)} \circ \phi_Z\}$ induce the elements $[i_{N(\mu^{-1}(0))}]$ and $[\mathbf{n}_{\mu^{-1}(0)}]$ of $H^{p-1}(\mu^{-1}(0), \mu^{-1}(0) \setminus D_4^p; \pi_{p-1}(\text{Mono}(\mathbf{R}, \mathbf{R}^p)))$ respectively. It is obvious that $[\mathbf{n}_{\mu^{-1}(0)}]$ is the null element and that $[i_{N(\mu^{-1}(0))}]$ corresponds to $\deg(\mathbf{e}(\mu^{-1}(0)))[\mu^{-1}(0)]^c$. Consider the following exact sequence of cohomology groups with the coefficient $\pi_{p-1}(\text{Mono}(\mathbf{R}, \mathbf{R}^p))$:

$$\begin{aligned} H^{p-1}((\mu^{-1}(0), \mu^{-1}(0) \setminus D_4^p) \times [0, 1]) &\rightarrow H^{p-1}((\mu^{-1}(0), \mu^{-1}(0) \setminus D_4^p) \times \{0, 1\}) \\ \xrightarrow{\delta} H^p((\mu^{-1}(0), \mu^{-1}(0) \setminus D_4^p) \times ([0, 1], \{0, 1\})) &\cong H^{p-1}(\mu^{-1}(0), \mu^{-1}(0) \setminus D_4^p). \end{aligned}$$

Here, $\delta([i_{N(\mu^{-1}(0))}] \oplus (-[\mathbf{n}_{\mu^{-1}(0)}]))$ corresponds to $d(i_{N(\mu^{-1}(0))}, \mathbf{n}_{\mu^{-1}(0)})$. This proves the lemma. \square

We set

$$\begin{aligned} g_p(x_1, \dots, x_p) &= (x_1, \dots, x_{p-1}, x_p^2), \\ g^\iota(x_1, \dots, x_n) &= (x_1, \dots, x_{p-1}, x_p^2 + \dots + x_{n-\iota}^2 - x_{n-\iota+1}^2 - \dots - x_n^2). \end{aligned}$$

In the following definitions (5.2) and (5.3), μ may not have 0 as a regular value. Under the identification (1.6), define the section $\omega(\mu) : \mathbf{R}^p \rightarrow \Omega^{1,0}(\mathbf{R}^p, \mathbf{R}^p)$ by

$$\omega(\mu)(\dot{x}) = (\dot{x}, g_p(\dot{x}); E_{p-1} \dot{+} (\mu(\dot{x}); \overbrace{\mathbf{0}_{p \times p}, \dots, \mathbf{0}_{p \times p}}^{p-1}, \Delta(\overbrace{0, \dots, 0}^{p-1}, 2))). \quad (5.2)$$

Using (1.6), define the section $\mathcal{J}^\iota(\omega(\mu)) \in \Gamma(\mathbf{R}^n, \mathbf{R}^p)$ by

$$\begin{aligned} \mathcal{J}^\iota(\omega(\mu))(x) &= (x, g^\iota(x); \mathcal{J}_{p,n}^\iota(x)(\pi_\Omega \circ \omega(\mu)(\dot{x}))) \quad \text{for } n > p > 2, \\ \mathcal{J}^\iota(\omega(\mu)) &= \omega(\mu) \quad \text{for } n = p > 2. \end{aligned} \quad (5.3)$$

If we set $\mu^\star(x) = \varkappa(\|\dot{x}\|)\mu(\dot{x}) + 2(1 - \varkappa(\|\dot{x}\|))x_p$, then it follows that

- (i) if either $\|\dot{x}\| \geq 1$ or $\|\dot{x}\| \geq 4$, then $\mu^\star(x) = 2x_p$,
- (ii) if $\|\dot{x}\| \leq 1/10$, then $\mu^\star(x) = \mu(\dot{x})$.

By (5.1), $\mathcal{J}_{p,n}^\iota(x)(\pi_\Omega \circ \omega(\mu)(\dot{x}))$ is written as $(\mathbf{A}_{p \times n}^{\varkappa, \iota}(x); \mathbf{B}^1, \dots, \mathbf{B}^p)$, where

$$\begin{aligned} \mathbf{A}_{p \times n}^{\varkappa, \iota}(x) &= \begin{pmatrix} E_{p-1} & \mathbf{0}_{(p-1) \times (n-p+1)} \\ 0, \dots, 0, & \mu^\star(x), 2x_{p+1}, \dots, 2x_{n-\iota}, -2x_{n-\iota+1}, \dots, -2x_n \end{pmatrix} \in \text{Hom}(\mathbf{R}^n, \mathbf{R}^p), \\ \mathbf{B}^j &= \mathbf{0}_{n \times n} \quad \text{for } 1 \leq j \leq p-1, \\ \mathbf{B}^p &= \Delta(\overbrace{0, \dots, 0}^{p-1}, \overbrace{2, \dots, 2}^{n-p+1-\iota}, \overbrace{-2, \dots, -2}^\iota). \end{aligned} \quad (5.4)$$

Therefore, we have

- (1) if $\|x\| \geq 10$, then $\mu^\star(x) = 2x_p$ and $\mathcal{J}^\iota(\omega(\mu))(x) = j^2 g^\iota(x)$,
- (2) $S(\mathcal{J}^\iota(\omega(\mu))) = \mu^{-1}(0) \times \mathbf{0}_{n-p}$, by (ii) and the fact that if $\|\dot{x}\| \neq 0$, then $\text{rank} \mathbf{A}_{p \times n}^{\varkappa, \iota}(x) = p$.

On any point $c \in S(\mathcal{J}^\iota(\omega(\mu)))$, the 2-jet

$$\pi_\Omega \circ \mathcal{J}^\iota(\omega(\mu))(c) = (E_{p-1} \dot{+} (\mathbf{0}_{n-p+1}); \mathbf{0}_{n \times n}, \dots, \mathbf{0}_{n \times n}, \mathbf{B}^p)$$

is represented by the germ $g^\iota : (\mathbf{R}^n, 0) \rightarrow (\mathbf{R}^p, 0)$. Hence, $K(\mathcal{J}^\iota(\omega(\mu)))_c$ and $Q(\mathcal{J}^\iota(\omega(\mu)))_c$ are generated and oriented by $\mathbf{e}_p, \dots, \mathbf{e}_n$ and \mathbf{e}_p respectively. Therefore, we have a canonical isomorphism $\text{Hom}(K(\mathcal{J}^\iota(\omega(\mu)))_c, Q(\mathcal{J}^\iota(\omega(\mu)))_c) \cong \mathbf{R}^{n-p+1}$.

We choose $\mathcal{N}(\omega(\mu))$ to be $N(\mu^{-1}(0))$, and then $i_{N(\mu^{-1}(0))} = i_{\mathcal{N}(\omega(\mu))}$. Let

$$m(p, n) : \text{Mono}(N(\mu^{-1}(0)), T\mathbf{R}^p|_{\mu^{-1}(0)}) \rightarrow \\ \text{Mono}(N(\mu^{-1}(0)) \oplus (\mathbf{0}_p \times T\mathbf{R}^{n-p})|_{\mu^{-1}(0) \times \mathbf{0}_{n-p}}, T\mathbf{R}^n|_{\mu^{-1}(0) \times \mathbf{0}_{n-p}})$$

for $p > 2$ be the fiber map defined by

$$m(p, n)(h)(c, \mathbf{v} + a_{p+1}\mathbf{e}_{p+1} + \dots + a_n\mathbf{e}_n) = (c, h(\dot{c}, \mathbf{v}) + a_{p+1}\mathbf{e}_{p+1} + \dots + a_n\mathbf{e}_n),$$

where $h \in \text{Mono}(N(\mu^{-1}(0))_{\dot{c}}, T_{\dot{c}}\mathbf{R}^p)$, $\dot{c} \in \mu^{-1}(0)$ and $\mathbf{v} \in N(\mu^{-1}(0))_{\dot{c}}$.

Set

$$\mathfrak{B}^1(\pi_{p-1}) = \mathfrak{B}(\pi_{p-1}(\text{Mono}(N(\mu^{-1}(0))_{\dot{c}}, T_{\dot{c}}\mathbf{R}^p))), \text{ for } \dot{c} \in \mu^{-1}(0), \\ \mathfrak{B}^2(\pi_{p-1}) = \mathfrak{B}(\pi_{p-1}(\text{Mono}((N(\mu^{-1}(0)) \oplus (\mathbf{0}_p \times T\mathbf{R}^{n-p}))_c, T_c\mathbf{R}^n))), \text{ for } c \in \mu^{-1}(0) \times \mathbf{0}_{n-p}.$$

Then $m(p, n)$ induces the fiberwise homomorphism $m(p, n)' : \mathfrak{B}^1(\pi_{p-1}) \rightarrow \mathfrak{B}^2(\pi_{p-1})$ of the trivial local coefficients, and the epimorphism

$$m(p, n)'_* : H^{p-1}(\mu^{-1}(0), \mu^{-1}(0) \setminus D_4^p; \mathfrak{B}^1(\pi_{p-1})) \\ \rightarrow H^{p-1}(\mu^{-1}(0) \times \mathbf{0}_{n-p}, (\mu^{-1}(0) \setminus D_4^p) \times \mathbf{0}_{n-p}; \mathfrak{B}^2(\pi_{p-1})).$$

By the definition of the primary difference we have the following lemma.

Lemma 5.2. *Let $n > p > 2$. We have*

$$m(p, n)'_*(d(i_{N(\mu^{-1}(0))}, \mathbf{n}_{\mu^{-1}(0)})) = d(i_{\mathcal{N}(\mathcal{J}^\iota(\omega(\mu)))}, \Phi(\mathcal{J}^\iota(\omega(\mu)))).$$

Proof. Recall the monomorphism $i_{\mathcal{N}(\mathcal{J}^\iota(\omega(\mu)))}$ defined in §2. It is easy to see that $m(p, n)(i_{N(\mu^{-1}(0))}) = i_{\mathcal{N}(\mathcal{J}^\iota(\omega(\mu)))}$. Next we show that $m(p, n)(\mathbf{n}_{\mu^{-1}(0)})$ is homotopic to $\Phi(\mathcal{J}^\iota(\omega(\mu)))$. In fact, $m(p, n)(\mathbf{n}_{\mu^{-1}(0)})(\mathbf{e}(N(\mu^{-1}(0))_{\dot{c}})) = \mathbf{e}_p$, $m(p, n)(\mathbf{n}_{\mu^{-1}(0)})(\mathbf{e}_\ell) = \mathbf{e}_\ell$ for $\ell > p$ and $\Phi(\mathcal{J}^\iota(\omega(\mu)))(\mathbf{e}_\ell) = \mathbf{e}_\ell$ for $\ell > p$. Hence, it suffices to show $\Phi(\mathcal{J}^\iota(\omega(\mu)))(\mathbf{e}(N(\mu^{-1}(0))_{\dot{c}})) = (\|\text{grad}\mu(\dot{c})\|/2)m(p, n)(\mathbf{n}_{\mu^{-1}(0)})(\mathbf{e}(N(\mu^{-1}(0))_{\dot{c}}))$.

In its proof we use the notation introduced in [B, §1]. Let $Z_{j,\ell}$ be the coordinate corresponding to the (j, ℓ) component of a $p \times n$ matrix. We have, around $c \in S(\mathcal{J}^\iota(\omega(\mu)))$,

$$\left(d(\mathcal{J}^\iota(\omega(\mu))) \left(\sum_{i=1}^n a_i \frac{\partial}{\partial x_i} \right) \right) (Z_{j,\ell}) \\ = \left(\sum_{i=1}^n a_i \frac{\partial}{\partial x_i} \right) (Z_{j,\ell} \circ \mathcal{J}^\iota(\omega(\mu))) \\ = \begin{cases} (\sum_{i=1}^n a_i \frac{\partial}{\partial x_i})(\text{constant}) = 0 & \text{for } 0 \leq j \leq p-1 \text{ and } j = p, 1 \leq \ell \leq p-1, \\ (\sum_{i=1}^n a_i \frac{\partial}{\partial x_i})(\mu(\dot{x})) & \text{for } j = \ell = p, \\ (\sum_{i=1}^n a_i \frac{\partial}{\partial x_i})(2x_\ell) = 2a_\ell & \text{for } j = p \text{ and } p < \ell \leq n - \iota, \\ (\sum_{i=1}^n a_i \frac{\partial}{\partial x_i})(-2x_\ell) = -2a_\ell & \text{for } j = p \text{ and } n - \iota < \ell \leq n. \end{cases}$$

From the definition of the intrinsic derivative, it follows that

$$d^2(\mathcal{J}^\iota(\omega(\mu)))_{\sim} \circ d(\mathcal{J}^\iota(\omega(\mu)))_{\sim}(\text{grad}\mu(\dot{c}))(\mathbf{e}_p) = \|\text{grad}\mu(\dot{c})\|^2 \mathbf{e}_p, \\ d^2(\mathcal{J}^\iota(\omega(\mu)))_{\sim} \circ d(\mathcal{J}^\iota(\omega(\mu)))_{\sim}(\text{grad}\mu(\dot{c}))(\mathbf{e}_\ell) = 0 \text{ for } p < \ell \leq n, \\ d^2(\mathcal{J}^\iota(\omega(\mu)))_{\sim} \circ d(\mathcal{J}^\iota(\omega(\mu)))_{\sim}(\mathbf{e}_k)(\mathbf{e}_\ell) = \begin{cases} 2\delta_{k\ell}\mathbf{e}_p & \text{for } p < k \leq n - \iota \text{ and } p < \ell \leq n, \\ -2\delta_{k\ell}\mathbf{e}_p & \text{for } n - \iota < k \leq n \text{ and } p < \ell \leq n. \end{cases} \quad (5.5)$$

These formulas prove that $\mathcal{J}^\iota(\omega(\mu))$ is transverse to $\Sigma^{n-p+1}(\mathbf{R}^n, \mathbf{R}^p)$ when 0 is a regular value of μ . Since the symmetric matrix associated to $d^2(\mathcal{J}^\iota(\omega(\mu)))_c : K(\mathcal{J}^\iota(\omega(\mu)))_c \rightarrow \text{Hom}(K(\mathcal{J}^\iota(\omega(\mu)))_c, Q(\mathcal{J}^\iota(\omega(\mu)))_c)$ under the basis $\mathbf{e}_p, \dots, \mathbf{e}_n$ is equal to $\Delta(\overbrace{2, \dots, 2}^{n-p+1-\iota}, \overbrace{-2, \dots, -2}^\iota)$ by (5.4), it follows from the definition of $\Phi(\mathcal{J}^\iota(\omega(\mu)))$ in (2.3) that

$$\begin{aligned} & \Phi(\mathcal{J}^\iota(\omega(\mu)))(\text{grad}\mu(\dot{c})) \\ &= i_{K(\mathcal{J}^\iota(\omega(\mu)))} \circ (d^2(\mathcal{J}^\iota(\omega(\mu)))|_{K(\mathcal{J}^\iota(\omega(\mu)))})^{-1} \\ & \quad \circ d^2(\mathcal{J}^\iota(\omega(\mu)))_{\sim} \circ d(\mathcal{J}^\iota(\omega(\mu)))_{\sim}(\text{grad}\mu(\dot{c})) \\ &= i_{K(\mathcal{J}^\iota(\omega(\mu)))}(\|\text{grad}\mu(\dot{c})\|^2/2)\mathbf{e}_p \\ &= (\|\text{grad}\mu(\dot{c})\|^2/2)\mathbf{e}_p. \end{aligned}$$

This is what we want. □

We have proved the following lemma in [An3, Lemma 7.2].

Lemma 5.3. *Let $p \geq 3$. For $i = 1, \dots, p-1$, there exist functions $\mu_\lambda^i : \mathbf{R}^p \rightarrow \mathbf{R}$, $\lambda \in \mathbf{R}$, which are smooth with respect to the variables x_1, \dots, x_p and λ such that*

- (1) $\mu_\lambda^i(\dot{x}) = 2x_p$ if $\lambda \leq 0$ or $\|\dot{x}\| \geq 4$,
- (2) $\mu_\lambda^i(\dot{x}) = \mu_1^i(\dot{x})$ if $\lambda \geq 1$,
- (3) if $|\lambda - (1/2)| \geq 1/2$, then 0 is a regular value of μ_λ^i ,
- (4) if $p \geq 3$ and $1 \leq i < p-1$ or if $p = 3$ and $i = 2$, then the manifold $(\mu_1^i)^{-1}(0)$ is a connected oriented manifold,
- (5) μ_1^i has a unique point $(0, \dots, 0, 1) \in \mathbf{R}^p$ such that $\mathbf{e}(S(\omega(\mu_1^i)))(0, \dots, 0, 1) = -\mathbf{e}_p$ and the degree of $\mathbf{e}(S(\omega(\mu_1^i)))$ is equal to $(-1)^i$.

Remark 5.4. *We explain how $S(\omega(\mu_1^i))$ in Lemma 5.3 is constructed from $\mathbf{R}^{p-1} \times 0$. If $p \geq 3$ and $1 \leq i < p-1$ (resp. $p = 3$ and $i = 2$), then $S(\omega(\mu_1^i))$ is constructed by doing the surgery by an i -handle (resp. three disjoint and non-linking 1-handles) attached to $\mathbf{R}^{p-1} \times 0$ within an embedded p -disk in \mathbf{R}^p , and hence $S(\omega(\mu_1^i))$ is connected and oriented. When $p = 3$ and $i = 2$, this process of the surgery is different from the usual method (see the details in [An3, Lemma 7.2]).*

As for the case $p = 2$, we have the following lemma.

Let A^+ (resp. $A^{+'}$) be $[-4, 4] \times [-3, 5]$ (resp. $[-\pi, \pi] \times [-\sqrt{2} - 1, 4]$), and let A^- (resp. $A^{-'}$) be $[-4, 4] \times [-5, 3]$ (resp. $[-\pi, \pi] \times [-4, \sqrt{2} + 1]$). Let $\sigma : \mathbf{R}^2 \rightarrow \mathbf{R}^2$ be the fold-map defined by $\sigma(y_1, y_2) = (y_1, y_2^2)$.

Lemma 5.5. *There exists a homotopy ω_λ^\pm relative to $\mathbf{R}^2 \setminus D_8^2$ in $\Gamma(\mathbf{R}^2, \mathbf{R}^2)$ such that*

- (1) $\omega_0^\pm = j^2\sigma$,
- (2) $\omega_1^\pm \in \Gamma^{tr}(\mathbf{R}^2, \mathbf{R}^2)$,
- (3) $S(\omega_1^\pm)$ is the union of $\mathbf{R} \times 0$ and the circle $C(0, \pm 2)$ centered at $(0, \pm 2)$ with radius $1/\sqrt{2}$,
- (4) $d(i_{N(\mathbf{R} \times 0)}, \Phi(\omega_1^\pm)|_{\mathbf{R} \times 0}) = \mp 1$ and $d(i_{N(C(0, \pm 2))}, \Phi(\omega_1^\pm)|_{C(0, \pm 2)}) = 0$.

Proof. Let $GL^+(2)$ (resp. $GL^-(2)$) refer to the set of the regular 2×2 matrices with positive (resp. negative) determinants, which is provided with the orientation induced from S^1 by the map $U \mapsto U\mathbf{e}_2/\|U\mathbf{e}_2\|$.

Let $h^\pm : \mathbf{R}^2 \rightarrow \mathbf{R}^2$ be the fold-map defined by $h^\pm(y_1, y_2) = e^{((1/2)-y_1^2-y_2^2)}(y_1, -(\pm y_2))$. We have the Jacobian matrix

$$Jh^+(y_1, y_2) = e^{((1/2)-y_1^2-y_2^2)} \begin{pmatrix} 1 - 2y_1^2 & -2y_1y_2 \\ 2y_1y_2 & 2y_2^2 - 1 \end{pmatrix} = ((1) \dot{+} (-1))Jh^-(y_1, y_2),$$

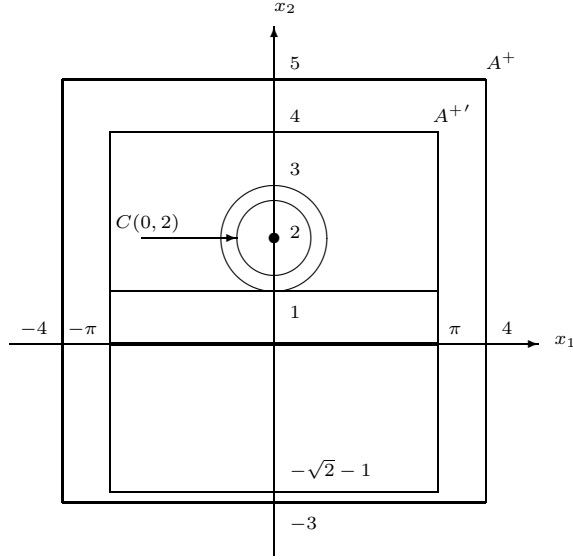

whose determinant is equal to $e^{(1-2(y_1^2+y_2^2))} (2(y_1^2+y_2^2)-1)$. Therefore, h^\pm folds exactly on the circle $S_{1/\sqrt{2}}^1$ with radius $1/\sqrt{2}$ and h^+ (resp. h^-) preserves (resp. reverses) the orientation outside of $S_{1/\sqrt{2}}^1$ and reverses (resp. preserves) the orientation inside of $S_{1/\sqrt{2}}^1$. Since

$$Jh^\pm(\cos \theta, \sin \theta) = e^{-1/2} \begin{pmatrix} -\cos 2\theta & -\sin 2\theta \\ \pm \sin 2\theta & \pm(-\cos 2\theta) \end{pmatrix},$$

$$Jh^\pm((1/\sqrt{2})(\cos \theta, \sin \theta)) = \begin{pmatrix} \sin^2 \theta & -\sin \theta \cos \theta \\ \pm \sin \theta \cos \theta & \pm(-\cos^2 \theta) \end{pmatrix},$$

$Jh^\pm|_{S^1} : S^1 \rightarrow GL^\pm(2)$ is of degree $-(\pm 2)$. It follows that $K(j^2 h^\pm)_{(1/\sqrt{2})(\cos \theta, \sin \theta)}$ is generated by ${}^t(\cos \theta, \sin \theta)$ and that $Q(j^2 h^\pm)_{(1/\sqrt{2})(\cos \theta, \sin \theta)}$ is generated and oriented by ${}^t(-\cos \theta, \pm \sin \theta)$. Indeed, since $d^2/dt^2(e^{1/2-t^2/2}(t/\sqrt{2})(\cos \theta, -(\pm \sin \theta))) = (1/\sqrt{2})(t^3 - 3t)e^{1/2-t^2/2}(\cos \theta, -(\pm \sin \theta))$, we have

$$\begin{aligned} \frac{d^2}{dt^2}(h^\pm((t/\sqrt{2})(\cos \theta, \sin \theta)))|_{t=1} &= \frac{d^2}{dt^2}(e^{1/2-t^2/2}(t/\sqrt{2})(\cos \theta, -(\pm \sin \theta)))|_{t=1} \\ &= \sqrt{2}(-\cos \theta, \pm \sin \theta). \end{aligned} \quad (5.6)$$

Let

$$\begin{aligned} z^+(x_1, x_2) &= (((1 - 1/\sqrt{2})x_2 + 1/\sqrt{2}) \cos(x_1 + 3\pi/2), ((1 - 1/\sqrt{2})x_2 + 1/\sqrt{2}) \sin(x_1 + 3\pi/2)), \\ z^-(x_1, x_2) &= ((-(1 - 1/\sqrt{2})x_2 + 1/\sqrt{2}) \cos(-x_1 + \pi/2), (-(1 - 1/\sqrt{2})x_2 + 1/\sqrt{2}) \sin(-x_1 + \pi/2)). \end{aligned}$$

Then z^+ (resp. z^-) maps the segments $[-\pi, \pi] \times 0$, $[-\pi, \pi] \times 1$ and $[-\pi, \pi] \times (-\sqrt{2}-1)$ (resp. $[-\pi, \pi] \times 0$, $[-\pi, \pi] \times (-1)$ and $[-\pi, \pi] \times (\sqrt{2}+1)$) to the circles centered at $(0,0)$ with radii $1/\sqrt{2}$ and 1 , and to the point $(0,0)$ respectively.

Let $D(0, \pm 2)$ be the 2-disk centered at $(0, \pm 2)$ with radius 1. Let $M(2)$ be the space consisting of all 2×2 matrices. We define maps $\mathbf{a}^\pm : A^{\pm'} \rightarrow M(2)$ so that $\mathbf{a}^\pm(A^{\pm'} \setminus (C(0, \pm 2) \cup [-\pi, \pi] \times 0)) \subset GL(2)$ by setting

$$\begin{aligned} \mathbf{a}^+(x_1, x_2) &= Jh^+(z^+(x_1, x_2)) && \text{for } (x_1, x_2) \in [-\pi, \pi] \times [-\sqrt{2} - 1, 1], \\ \mathbf{a}^+(x_1, x_2) &= Jh^+(x_1, x_2 - 2) && \text{for } (x_1, x_2) \in D(0, 2), \\ \mathbf{a}^+(x_1, x_2) &= e^{-1/2}E_2 && \text{for } \begin{cases} x_1 = \pm\pi \text{ and } 1 \leq x_2 \leq 4, \text{ or} \\ -\pi \leq x_1 \leq \pi \text{ and } x_2 = 4, \text{ or} \\ x_1 = 0 \text{ and } 3 \leq x_2 \leq 4, \end{cases} \\ \mathbf{a}^-(x_1, x_2) &= Jh^-(z^-(x_1, x_2)) && \text{for } (x_1, x_2) \in [-\pi, \pi] \times [-1, \sqrt{2} + 1], \\ \mathbf{a}^-(x_1, x_2) &= Jh^-(x_1, x_2 + 2) && \text{for } (x_1, x_2) \in D(0, -2), \\ \mathbf{a}^-(x_1, x_2) &= e^{-1/2}((1) \dot{+} (-1)) && \text{for } \begin{cases} x_1 = \pm\pi \text{ and } -4 \leq x_2 \leq -1, \text{ or} \\ -\pi \leq x_1 \leq \pi \text{ and } x_2 = -4, \text{ or} \\ x_1 = 0 \text{ and } -4 \leq x_2 \leq -3. \end{cases} \end{aligned}$$

We here give the properties for \mathbf{a}^\pm :

(1) if $-\pi \leq x_1 \leq \pi$, then

$$\begin{aligned} \mathbf{a}^+(x_1, 1) &= Jh^+(z^+(x_1, 1)) = Jh^+(\cos(x_1 + 3\pi/2), \sin(x_1 + 3\pi/2)), \\ \mathbf{a}^-(x_1, -1) &= Jh^-(z^-(x_1, -1)) = Jh^-(\cos(-x_1 + \pi/2), \sin(-x_1 + \pi/2)), \end{aligned}$$

(2) if $-\sqrt{2} - 1 \leq x_2 \leq 1$ for \mathbf{a}^+ and $-1 \leq x_2 \leq \sqrt{2} + 1$ for \mathbf{a}^- , then

$$\begin{aligned} \mathbf{a}^\pm(\pi, x_2) &= \mathbf{a}^\pm(-\pi, x_2) = Jh^\pm(0, (1 - 1/\sqrt{2})x_2 \pm 1/\sqrt{2}) \\ &= e^{a^\pm(x_2)}((1) \dot{+} (\pm 2\{(1 - 1/\sqrt{2})x_2 \pm 1/\sqrt{2}\}^2 \mp 1)) \end{aligned}$$

with $a^\pm(x_2) = 1/2 - \{(1 - 1/\sqrt{2})x_2 \pm 1/\sqrt{2}\}^2$,

(3) $\mathbf{a}^\pm(0, \pm 1) = \mathbf{a}^\pm(\pi, \pm 1) = \mathbf{a}^\pm(-\pi, \pm 1) = \mathbf{a}^\pm(0, \pm 3) = e^{-1/2}((1) \dot{+} (\pm 1))$,

(4) if $-\pi \leq x_1 \leq \pi$, then

$$\mathbf{a}^\pm(x_1, \mp(\sqrt{2} + 1)) = Jh^\pm(0, 0) = e^{1/2}((1) \dot{+} (\mp 1)).$$

By noting these facts, we can extend this to the space $A^{+'}$ (resp. $A^{-'}$) by using a suitable retraction of $[-\pi, \pi] \times [1, 4] \setminus \text{Int}D(0, 2)$ onto $\partial D(0, 2) \cup 0 \times [3, 4]$ (resp. of $[-\pi, \pi] \times [-4, -1] \setminus \text{Int}D(0, -2)$ onto $\partial D(0, -2) \cup 0 \times [-4, -3]$).

Furthermore, there exists an extended map $\widetilde{\mathbf{a}}^\pm : A^\pm \rightarrow M(2)$ of \mathbf{a}^\pm as follows:

(i) if $(x_1, x_2) \in A^{\pm'}$, then $\widetilde{\mathbf{a}}^\pm(x_1, x_2) = \mathbf{a}^\pm(x_1, x_2)$,

(ii) if $(x_1, x_2) \notin A^{\pm'}$, then

(ii-1) $\widetilde{\mathbf{a}}^\pm(x_1, x_2) = ((1) \dot{+} (2x_2))$ on ∂A^\pm ,

(ii-2) $\widetilde{\mathbf{a}}^\pm(x_1, x_2) \in GL^+(2)$ if $x_2 > 0$, and $\widetilde{\mathbf{a}}^\pm(x_1, x_2) \in GL^-(2)$ if $x_2 < 0$,

(ii-3) if $\pi \leq |x_1| \leq 4$, and $-\sqrt{2} - 1 < x_2 < 1$ for \mathbf{a}^+ and $-1 < x_2 < \sqrt{2} + 1$ for \mathbf{a}^- , then

$$\begin{aligned} \widetilde{\mathbf{a}}^\pm(x_1, x_2) &= \varphi_{[\pi, 4]}(|x_1|) \begin{pmatrix} 1 & 0 \\ 0 & 2x_2 \end{pmatrix} \\ &+ (1 - \varphi_{[\pi, 4]}(|x_1|))e^{a^\pm(x_2)} \begin{pmatrix} 1 & 0 \\ 0 & \pm 2\{(1 - 1/\sqrt{2})x_2 \pm 1/\sqrt{2}\}^2 \mp 1 \end{pmatrix}, \end{aligned}$$

where $\varphi_{[\pi, 4]} : [\pi, 4] \rightarrow [0, 1]$ is an increasing smooth function such that $\varphi_{[\pi, 4]}(t) = 0$ if $t \leq \pi + 1/10$, and $\varphi_{[\pi, 4]}(t) = 1$ if $t \geq 4 - 1/10$. In particular, $\widetilde{\mathbf{a}}^\pm(x_1, 0) = (1) \dot{+} (0)$ if $\pi \leq |x_1| \leq 4$.

Note in (ii-3) that if we set $\phi^\pm(|x_1|, x_2) = 2x_2\varphi_{[\pi, 4]}(|x_1|) + (\pm 2\{(1 - 1/\sqrt{2})x_2 \pm 1/\sqrt{2}\}^2 \mp 1)(1 - \varphi_{[\pi, 4]}(|x_1|))e^{a^\pm(x_2)}$, then $\phi^\pm(|x_1|, x_2)$ and x_2 become positive, zero and negative at the same time and $d/dx_2(\phi^\pm(|x_1|, x_2))|_{x_2=0} = 2\varphi_{[\pi, 4]}(|x_1|) + 2(\sqrt{2} - 1)(1 - \varphi_{[\pi, 4]}(|x_1|)) > 0$.

We now define a section $\omega^\pm \in \Gamma^{tr}(\mathbf{R}^2, \mathbf{R}^2)$, which will be the required section ω_1^\pm , under the identification (1.6). By considering (5.6), we first set

- (1) if $(x_1, x_2) \in A^\pm$, then $\pi_1^2 \circ \omega^\pm(x_1, x_2) = ((x_1, x_2), \sigma(x_1, x_2); \widetilde{\mathbf{a}}^\pm(x_1, x_2))$,
- (2) if $(x_1, x_2) \in D(0, \pm 2)$, then $\omega^\pm(x_1, x_2) = ((x_1, x_2), \sigma(x_1, x_2); \pi_\Omega \circ j^2 h^\pm(x_1, x_2 - (\pm 2)))$,
- (3⁺) if $(x_1, x_2) \in [-\pi, \pi] \times [-\sqrt{2} - 1, 1/2]$, then

$$\begin{aligned} & \omega^+(x_1, x_2) \\ &= ((x_1, x_2), \sigma(x_1, x_2); \widetilde{\mathbf{a}}^+(x_1, x_2); -\cos(x_1 + 3\pi/2)\Delta(2, 2), \sin(x_1 + 3\pi/2)\Delta(2, 2)), \end{aligned}$$

- (3⁻) if $(x_1, x_2) \in [-\pi, \pi] \times [-1/2, \sqrt{2} + 1]$, then

$$\begin{aligned} & \omega^-(x_1, x_2) \\ &= ((x_1, x_2), \sigma(x_1, x_2); \widetilde{\mathbf{a}}^-(x_1, x_2); -\cos(-x_1 + \pi/2)\Delta(2, 2), -\sin(-x_1 + \pi/2)\Delta(2, 2)), \end{aligned}$$

- (4) if $\pi \leq |x_1| \leq 4$, then

$$\omega^\pm(x_1, 0) = ((x_1, 0), \sigma(x_1, 0); \widetilde{\mathbf{a}}^\pm(x_1, 0); \Delta(0, 0), \Delta(\rho(|x_1|), 2)),$$

where $\rho: [\pi, 4] \rightarrow [0, 2]$ is a decreasing smooth function such that $\rho(t) = 2$ for $t \leq \pi + 1/10$, $0 < \rho(t) < 2$ for $\pi + 1/10 < t < 4 - 1/10$ and $\rho(t) = 0$ for $4 - 1/10 \leq t$,

- (5) if $(x_1, x_2) \in \mathbf{R}^2 \setminus A^\pm$, then $\omega^\pm(x_1, x_2) = j^2 \sigma(x_1, x_2)$,

and then extend this to a section $\omega^\pm: \mathbf{R}^2 \rightarrow J^2(\mathbf{R}^2, \mathbf{R}^2)$ arbitrarily by using π_1^2 .

We have to show $\omega^\pm \in \Gamma^{tr}(\mathbf{R}^2, \mathbf{R}^2)$. It is easy to see that $S(\omega^\pm)$ consists of $\mathbf{R} \times 0$ and $C(0, \pm 2)$. We first show $\omega^\pm \in \Gamma(\mathbf{R}^2, \mathbf{R}^2)$. Let $(x_1, 0) \in [-\pi, \pi] \times 0$. Since $Q(\omega^\pm)_{(x_1, 0)}$ is oriented so that $q(\omega^\pm)$ is positive definite, $K(\omega^\pm)_{(x_1, 0)}$ is generated by $\mathbf{v}^\pm(x_1)$ and $Q(\omega^\pm)_{(x_1, 0)}$ is generated and oriented by $\mathbf{w}^\pm(x_1)$, where

$$\begin{aligned} \mathbf{v}^+(x_1) &= {}^t(\cos(x_1 + 3\pi/2), \sin(x_1 + 3\pi/2)), & \mathbf{v}^+(\pm\pi) &= {}^t(0, 1), \\ \mathbf{w}^+(x_1) &= {}^t(-\cos(x_1 + 3\pi/2), \sin(x_1 + 3\pi/2)), & \mathbf{w}^+(\pm\pi) &= {}^t(0, 1), \\ \mathbf{v}^-(x_1) &= {}^t(-\cos(-x_1 + \pi/2), -\sin(-x_1 + \pi/2)), & \mathbf{v}^-(\pm\pi) &= {}^t(0, 1), \\ \mathbf{w}^-(x_1) &= {}^t(-\cos(-x_1 + \pi/2), -\sin(-x_1 + \pi/2)), & \mathbf{w}^-(\pm\pi) &= {}^t(0, 1) \end{aligned}$$

(see §1). We have

$$\begin{aligned} & (d_{(x_1, 0)}^2 \omega^+)(\mathbf{v}^+(x_1))(\mathbf{v}^+(x_1)) \\ &= ({}^{-t}\mathbf{v}^+(x_1) \cos(x_1 + 3\pi/2)\Delta(2, 2) \mathbf{v}^+(x_1), {}^t\mathbf{v}^+(x_1) \sin(x_1 + 3\pi/2)\Delta(2, 2) \mathbf{v}^+(x_1)) \\ &= 2\mathbf{w}^+(x_1), \end{aligned} \tag{5.7}$$

and similarly $(d_{(x_1, 0)}^2 \omega^-)(\mathbf{v}^-(x_1))(\mathbf{v}^-(x_1)) = 2\mathbf{w}^-(x_1)$. Let $(x_1, 0) \in ([-4, -\pi] \cup [\pi, 4]) \times 0$. Then $K(\omega^\pm)_{(x_1, 0)}$ is generated by ${}^t(0, 1)$, $Q(\omega^\pm)_{(x_1, 0)}$ is generated and oriented by ${}^t(0, 1)$ and $(d_{(x_1, 0)}^2 \omega^\pm)({}^t(0, 1))({}^t(0, 1)) = 2 {}^t(0, 1)$. By the definition (2) of ω^\pm we have that $\omega^\pm(x_1, x_2) \in \Sigma^{1,0}(\mathbf{R}^2, \mathbf{R}^2)$ for $(x_1, x_2) \in C(0, \pm 2)$. Hence, we have $\omega^\pm \in \Gamma(\mathbf{R}^2, \mathbf{R}^2)$.

Next we show the transversality. Since $(x_1, x_2) \mapsto h^\pm(x_1, x_2 - (\pm 2))$ is a fold-map around $C(0, \pm 2)$, and since $\pi_1^2 \circ \pi_\Omega \circ \omega^\pm(x_1, x_2) = Jh^\pm(z^\pm(x_1, x_2))$ and z^\pm is an immersion around $[-\pi, \pi] \times 0$, ω^\pm is transverse to $\Sigma^1(\mathbf{R}^2, \mathbf{R}^2)$ on $C(0, \pm 2)$ and on $[-\pi, \pi] \times 0$. Let $(x_1, 0) \in ([-4, -\pi] \cup [\pi, 4]) \times 0$. Then we have that the (2, 2) component of $d_{(x_1, 0)}(\widetilde{\mathbf{a}}^\pm)(\partial/\partial x_2)$ is equal to $d/dx_2(\phi^\pm(|x_1|, x_2))|_{x_2=0} > 0$ by the comment exactly below (ii-3). By this observation and (5), ω^\pm is transverse to $\Sigma^1(\mathbf{R}^2, \mathbf{R}^2)$ at $(x_1, 0)$ for $|x_1| > \pi$. Hence, $\omega^\pm \in \Gamma^{tr}(\mathbf{R}^2, \mathbf{R}^2)$.

We prove the assertion Lemma 5.5 (4) for ω^\pm . Since $(x_1, x_2) \mapsto h^\pm(x_1, x_2 - (\pm 2))$ is a fold-map around $C(0, \pm 2)$, we have $d(i_{N(C(0, \pm 2))}, \Phi(\omega^\pm))|_{C(0, \pm 2)} = 0$. Next we show $d(i_{N(\mathbf{R} \times 0)}, \Phi(\omega^\pm))|_{\mathbf{R} \times 0} = \mp 1$. We

know that $i_{N([-π, π] \times 0)}$ is the inclusion. If we prove that $\Phi(\omega^\pm)_{(x_1, 0)}(\mathbf{e}_2) = i_{K(\omega^\pm)} \circ (d^2(\omega^\pm)|_{K(\omega^\pm)})^{-1} \circ (d^2(\omega^\pm)_{\sim} \circ d(\omega^\pm)_{\sim}|_{(x_1, 0)})(\mathbf{e}_2)$ is equal to $(\sqrt{2} - 1)\mathbf{v}^\pm(x_1)$ for $|x_1| \leq \pi$, then we have

$$d(i_{N([-π, π] \times 0)}, \Phi(\omega^\pm)|_{[-π, π] \times 0}) = \mp 1. \quad (5.8)$$

In fact, let p_Q be the orthogonal projection of \mathbf{R}^2 onto the space generated by $\mathbf{w}^\pm(x_1)$. If we regard $d_{(x_1, 0)}\mathbf{a}^\pm : T_{(x_1, 0)}\mathbf{R}^2 \rightarrow T_{\mathbf{a}^\pm(x_1, 0)}M(2)$ as a map $T_{(x_1, 0)}\mathbf{R}^2 \rightarrow M(2)$, then we have, by the definition of the intrinsic derivative, that $((d^2(\omega^\pm)_{\sim} \circ d(\omega^\pm)_{\sim}|_{(x_1, 0)})(\mathbf{e}_2))(\mathbf{v}^\pm(x_1))$ is equal to $p_Q((d_{(x_1, 0)}\mathbf{a}^\pm(\partial/\partial x_2))\mathbf{v}^\pm(x_1))$. In the following calculation let $a = x_1 + 3\pi/2$ and $b = (1 - 1/\sqrt{2})x_2 + 1/\sqrt{2}$ for ω^+ , and let $a = -x_1 + \pi/2$ and $b = -(1 - 1/\sqrt{2})x_2 + 1/\sqrt{2}$ for ω^- . Since $\mathbf{v}^\pm(x_1) = \pm {}^t(\cos a, \sin a)$ is independent of x_2 , $p_Q((d_{(x_1, 0)}\mathbf{a}^\pm(\partial/\partial x_2))\mathbf{v}^\pm(x_1))$ is equal to the value at $(x_1, 0)$ of

$$\begin{aligned} & p_Q(\partial/\partial x_2(\mathbf{a}^\pm(x_1, x_2)\mathbf{v}^\pm(x_1))) \\ &= p_Q(\partial/\partial x_2(Jh^\pm(z^\pm(x_1, x_2))\mathbf{v}^\pm(x_1))) \\ &= p_Q(\partial/\partial x_2(Jh^\pm(b \cos a, b \sin a)\mathbf{v}^\pm(x_1))) \\ &= p_Q\left(\frac{\partial}{\partial x_2}\left(e^{1/2-b^2}\begin{pmatrix} 1 - 2b^2 \cos^2 a & -2b^2 \sin a \cos a \\ \pm 2b^2 \sin a \cos a & \pm(2b^2 \sin^2 a - 1) \end{pmatrix}\begin{pmatrix} \pm \cos a \\ \pm \sin a \end{pmatrix}\right)\right) \\ &= \pm \partial/\partial x_2(e^{1/2-b^2}(-(2b^2 - 1) \cos a, \pm(2b^2 - 1) \sin a)) \\ &= \pm(\partial/\partial x_2(e^{1/2-b^2}(2b^2 - 1)))\mathbf{w}^\pm(x_1). \end{aligned}$$

The coefficient of $\mathbf{w}^\pm(x_1)$ at $(x_1, 0)$ is equal to $2(\sqrt{2} - 1)$. By (3 $^\pm$) we have $\Phi(\omega^\pm)_{(x_1, 0)}(\mathbf{e}_2) = (\sqrt{2} - 1)\mathbf{v}^\pm(x_1)$. This proves the assertion Lemma 5.5 (4), since the map $(x_1, 0) \rightarrow \mathbf{v}^\pm(x_1)$ is of degree ± 1 .

Finally we construct a homotopy $\pi_\Omega \circ \omega^\pm(\lambda) : \mathbf{R}^2 \rightarrow \Omega^{1,0}(2, 2)$, $\lambda \in [0, 1]$. First we set $\pi_\Omega \circ \omega^\pm(t) = \pi_\Omega \circ j^2\sigma$, $\pi_\Omega \circ \omega^\pm(1 - t) = \pi_\Omega \circ \omega^\pm$ for sufficiently small t with $t \geq 0$, and $\pi_\Omega \circ \omega^\pm(\lambda)|_{(\mathbf{R}^2 \setminus A^\pm)} = \pi_\Omega \circ j^2\sigma|_{(\mathbf{R}^2 \setminus A^\pm)}$. Since $\pi_2(\Omega^{1,0}(2, 2)) \cong \pi_2(SO(3)) \cong \{0\}$ ([An2]), this can be extended to the whole space $\mathbf{R}^2 \times [0, 1]$. Then we obtain the required homotopy $\omega_\lambda^\pm \in \Gamma(\mathbf{R}^2, \mathbf{R}^2)$ defined by $\omega_\lambda^\pm(x_1, x_2) = ((x_1, x_2), \sigma(x_1, x_2); \pi_\Omega \circ \omega^\pm(\lambda)(x_1, x_2))$. This completes the proof. \square

For $n > 2$, we can construct a section $\varpi^\pm \in \Gamma^{tr}(\mathbf{R}^n, \mathbf{R}^n)$ such as $\omega^\pm \in \Gamma^{tr}(\mathbf{R}^2, \mathbf{R}^2)$ by generalizing the method given in the proof of Lemma 5.5 as follows. However, we cannot assert that ϖ^\pm is homotopic to j^2g_n in $\Gamma(\mathbf{R}^n, \mathbf{R}^n)$. The proof is left to the reader.

Lemma 5.6. *For $n \geq 2$, there exists a section $\varpi^\pm \in \Gamma^{tr}(\mathbf{R}^n, \mathbf{R}^n)$ satisfying the properties:*

- (1) $\varpi^\pm|_{(\mathbf{R}^n \setminus D_g^n)} = j^2g_n|_{(\mathbf{R}^n \setminus D_g^n)}$ and $\pi_{\mathbf{R}^n}^2 \circ \varpi^\pm = g_n$,
- (2) $S(\varpi^\pm)$ is the union of $\mathbf{R}^{n-1} \times 0$ and the $(n-1)$ -sphere $C(\mathbf{0}_{n-1}, \pm 2)$ centered at $(\mathbf{0}_{n-1}, \pm 2)$ with radius $1/\sqrt{2}$,
- (3) $d(i_{N(\mathbf{R}^{n-1} \times 0)}, \Phi(\varpi^\pm)|_{\mathbf{R}^{n-1} \times 0}) = \mp 1$ and $d(i_{N(C(\mathbf{0}_{n-1}, \pm 2))}, \Phi(\varpi^\pm)|_{C(\mathbf{0}_{n-1}, \pm 2)}) = 0$.

By applying μ_λ^i in Lemma 5.3 to (5.3) for $p > 2$ and by using Lemma 5.5 for $p = 2$, we prove the following.

Proposition 5.7. *Let $n \geq p \geq 2$. (1) If $p \geq 3$, then the homotopy $\mathcal{J}^\nu(\omega(\mu_\lambda^i))$ ($1 \leq i \leq p-1$) relative to $\mathbf{R}^n \setminus \text{Int}D_{10}^n$ in $\Gamma(\mathbf{R}^n, \mathbf{R}^p)$ satisfies that*

- (1-i) $\mathcal{J}^\nu(\omega(\mu_\lambda^i)) = j^2g^\nu$,
- (1-ii) $\mathcal{J}^\nu(\omega(\mu_\lambda^i))$ is a smooth section transverse to $\Sigma^{n-p+1,0}(\mathbf{R}^n, \mathbf{R}^p)$ and $S(\mathcal{J}^\nu(\omega(\mu_\lambda^i))) = (\mu_\lambda^i)^{-1}(0) \times \mathbf{0}_{n-p}$ is connected, where $p \geq 3$ and $1 \leq i < p-1$, or $p = 3$ and $i = 2$,
- (1-iii) if $p \geq 3$ and $1 \leq i < p-1$, then $d(i_{N(\mathcal{J}^\nu(\omega(\mu_\lambda^i)))}, \Phi(\mathcal{J}^\nu(\omega(\mu_\lambda^i))))$ is equal to $(-1)^i$,
- (1-iv) if $p = 3$ and $i = 2$, then $d(i_{N(\mathcal{J}^\nu(\omega(\mu_\lambda^i)))}, \Phi(\mathcal{J}^\nu(\omega(\mu_\lambda^i)))) = 1$.
- (2) If $p = 2$, then there exists a homotopy $\mathcal{J}^\nu(\omega_\lambda^\pm)$ relative to $\mathbf{R}^n \setminus \text{Int}D_{10}^n$ in $\Gamma(\mathbf{R}^n, \mathbf{R}^2)$ such that
 - (2-i) $\mathcal{J}^\nu(\omega_\lambda^\pm) = j^2g^\nu$,
 - (2-ii) $\mathcal{J}^\nu(\omega_\lambda^\pm)$ is transverse to $\Sigma^{n-1,0}(\mathbf{R}^n, \mathbf{R}^2)$ and $S(\mathcal{J}^\nu(\omega_\lambda^\pm))$ consists of $\mathbf{R} \times \mathbf{0}_{n-1}$ and the circle $C(0, \pm 2) \times \mathbf{0}_{n-2}$ (denoted by $\mathbf{C}(0, \pm 2)$ for short),

$$(2\text{-iii}) \quad d(i_{\mathcal{N}(\mathcal{J}^\iota(\omega_1^\pm))}|_{\mathbf{R} \times \mathbf{0}_{n-1}}, \Phi(\mathcal{J}^\iota(\omega_1^\pm))|_{\mathbf{R} \times \mathbf{0}_{n-1}}) = \mp 1,$$

$$(2\text{-iv}) \quad d(i_{\mathcal{N}(\mathcal{J}^\iota(\omega_1^\pm))}|_{\mathbf{C}(0, \pm 2)}, \Phi(\mathcal{J}^\iota(\omega_1^\pm))|_{\mathbf{C}(0, \pm 2)}) = 0.$$

(3) The line bundles $Q(\mathcal{J}^\iota(\omega(\mu_1^i)))$ for $p > 2$ and $Q(\mathcal{J}^\iota(\omega_1^\pm))$ for $p = 2$ are trivial and oriented, whose induced orientations on $S(\mathcal{J}^\iota(\omega(\mu_1^i))) \setminus D_{10}^n$ and $S(\mathcal{J}^\iota(\omega_1^\pm)) \setminus D_{10}^n$ are given by \mathbf{e}_p .

Proof. The proof for the case $n = p$ is easier. Hence, we assume that $n > p \geq 2$.

(1-i) By Lemma 5.3 we have $\mu_0^i(\dot{x}) = 2x_p$. Hence, we have $\mathcal{J}^\iota(\omega(\mu_0^i)) = j^2 g^t$.

(1-ii) It is clear that $S(\mathcal{J}^\iota(\omega(\mu_1^i))) = (\mu_1^i)^{-1}(0) \times \mathbf{0}_{n-p}$, which is connected by Lemma 5.3 (4). The first assertion follows from the fact stated just below (5.5).

(1-iii, iv) Set $L = (\mu_1^i)^{-1}(0)$. By Lemmas 5.1 and Lemma 5.3 we have $d(i_{N(L)}, \mathbf{n}_L) = \deg(\mathbf{e}(L)) = (-1)^i$. By Lemma 5.2 we have $d(i_{\mathcal{N}(\mathcal{J}^\iota(\omega(\mu_1^i)))}, \Phi(\mathcal{J}^\iota(\omega(\mu_1^i)))) = m(p, n)'_*(d(i_{N(L)}, \mathbf{n}_L))$, which is equal to $(-1)^i$.

(2) The proof is rather long. Under the identification (1.6), we define $\mathcal{J}^\iota(\omega_\lambda^\pm) : \mathbf{R}^n \rightarrow \Omega^{n-1,0}(\mathbf{R}^n, \mathbf{R}^2)$ by

$$\mathcal{J}^\iota(\omega_\lambda^\pm)(x) = (x, g^t(x); \mathcal{J}_{2,n}^\iota(\pi_\Omega \circ \omega_\lambda^\pm)(x, \lambda)),$$

where $\mathcal{J}_{2,n}^\iota(\pi_\Omega \circ \omega_\lambda^\pm)(x, \lambda) = (\mathbf{A}_{2 \times n}^\iota(x, \lambda); \mathbf{B}_{n \times n}^{\iota,1}(x, \lambda), \mathbf{B}_{n \times n}^{\iota,2}(x, \lambda))$ is defined as follows.

First, we may assume that if $\lambda \geq 9/10$, then $\omega_\lambda^\pm(\dot{x}) = \omega_1^\pm(\dot{x})$. For the oriented vector $\mathbf{e}(Q(\omega_\lambda^\pm))$ we can construct an extended vector field $\mathbf{e}_{\omega^\pm}(\dot{x}, \lambda) = {}^t(e_{\omega^\pm}^1(\dot{x}, \lambda), e_{\omega^\pm}^2(\dot{x}, \lambda)) \in T_{\dot{x}} \mathbf{R}^2$ with $\dot{x} \in \mathbf{R}^2$ and $\lambda \in [0, 1]$ with the following properties.

► $\mathbf{e}_{\omega^\pm}(\dot{x}, \lambda)$ is continuous with respect to \dot{x} and λ .

► If $\dot{c} \in S(\omega_\lambda^\pm)$, then $\mathbf{e}_{\omega^\pm}(\dot{c}, \lambda) = \mathbf{e}(Q(\omega_\lambda^\pm))_{\dot{c}}$. In particular, if $\dot{c} \notin \text{Int} A^\pm$ in addition, then $\mathbf{e}_{\omega^\pm}(\dot{c}, \lambda) = {}^t(0, 1)$.

► If either $\lambda = 0$ or $\dot{x} \notin \text{Int} A^\pm$, then $\mathbf{e}_{\omega^\pm}(\dot{x}, \lambda) = {}^t(0, 1)$.

► $\mathbf{e}_{\omega^\pm}(\dot{x}, \lambda)$ is smooth around $\lambda = 0$.

► If $\lambda \geq 9/10$, then $\mathbf{e}_{\omega^\pm}(\dot{c}, \lambda) = \mathbf{e}_{\omega^\pm}(\dot{c}, 1)$.

This is possible since the subset consisting of all $(S(\omega_\lambda^\pm), \lambda)$ in $\mathbf{R}^2 \times \mathbf{R}$ is a closed set. In the following argument we need to extend the domain $[0, 1]$ of λ to $(-\infty, 1]$ by setting $\omega_\lambda^\pm = \omega_0^\pm$ and $\mathbf{e}_{\omega^\pm}(\dot{c}, \lambda) = \mathbf{e}_{\omega^\pm}(\dot{c}, 0)$ for $\lambda < 0$. Suppose that $\pi_\Omega \circ \omega_\lambda^\pm(\dot{x})$ is written as

$$(A_{2 \times 2}(\dot{x}, \lambda); B_{2 \times 2}^1(\dot{x}, \lambda), B_{2 \times 2}^2(\dot{x}, \lambda)) \quad (5.9)$$

under the identification (1.6). We define the $2 \times n$ matrix $\mathbf{A}_{2 \times n}^\iota(x, \lambda)$ for $x \in \mathbf{R}^n$ and $\lambda \in [0, 1]$ to be

$$\left(\begin{array}{c} A_{2 \times 2}(\dot{x}, \lambda - \|\dot{x}^\star\|^2) \\ e_{\omega^\pm}^1(\dot{x}, \lambda - \|\dot{x}^\star\|^2)(2x_3, \dots, 2x_{n-l}, -2x_{n-l+1}, \dots, -2x_n) \\ e_{\omega^\pm}^2(\dot{x}, \lambda - \|\dot{x}^\star\|^2)(2x_3, \dots, 2x_{n-l}, -2x_{n-l+1}, \dots, -2x_n) \end{array} \right), \quad (5.10)$$

which satisfies the following properties.

(A1) If $\dot{x} \notin \text{Int} A^\pm$, then

$$\mathbf{A}_{2 \times n}^\iota(x, \lambda) = \begin{pmatrix} 1 & \mathbf{0}_{1 \times (n-1)} \\ 0 & (2x_2, \dots, 2x_{n-l}, -2x_{n-l+1}, \dots, -2x_n) \end{pmatrix}.$$

(A2) If $x_2 \neq 0$ or $\|\dot{x}^\star\| \neq 0$, and $\dot{x} \notin \text{Int} A^\pm$, then $\text{rank} \mathbf{A}_{2 \times n}^\iota(x, \lambda) = 2$.

(A3) If $\dot{x} \in A^\pm$ and $\|\dot{x}^\star\| \neq 0$, then $\text{rank} \mathbf{A}_{2 \times n}^\iota(x, \lambda) = 2$.

(A4) If $\dot{x} \in A^\pm$ and $\|\dot{x}^\star\| = 0$, then

$$\mathbf{A}_{2 \times n}^\iota(x, \lambda) = (A_{2 \times 2}(\dot{x}, \lambda), \mathbf{0}_{2 \times (n-2)}),$$

which is of rank 1 if and only if $A_{2 \times 2}(\dot{x}, \lambda)$ is of rank 1.

(A5) If $\|\dot{x}\| \geq 1$, then $\pi_\Omega \circ \omega_{\lambda - \|\dot{x}\|^2}^\pm = \pi_\Omega \circ \omega_0^\pm = \pi_\Omega \circ j^2\sigma$, and hence,

$$\mathbf{A}_{2 \times n}^t(x, \lambda) = \mathbf{A}_{2 \times n}^t(x, 0) = \begin{pmatrix} 1 & \mathbf{0}_{1 \times (n-1)} \\ 0 & (2x_2, \dots, 2x_{n-\iota}, -2x_{n-\iota+1}, \dots, -2x_n) \end{pmatrix}.$$

The properties (A2) and (A3) follow from the fact that if $\text{rank } A_{2 \times 2}(\dot{x}, \lambda - \|\dot{x}\|^2) = 1$, then the two column vectors of $A_{2 \times 2}(\dot{x}, \lambda - \|\dot{x}\|^2)$ is orthogonal to the nonzero vector $\mathbf{e}_{\omega^\pm}(\dot{x}, \lambda - \|\dot{x}\|^2)$.

We set, for $j = 1, 2$,

$$\mathbf{B}_{n \times n}^{t,j}(x, \lambda) = \begin{pmatrix} B_{2 \times 2}^j(\dot{x}, \lambda - \|\dot{x}\|^2) & \mathbf{0}_{2 \times (n-2)} \\ \mathbf{0}_{(n-2) \times 2} & e_{\omega^\pm}^j(\dot{x}, \lambda - \|\dot{x}\|^2) \Delta[2; \iota] \end{pmatrix}, \quad (5.11)$$

where $\Delta[2; \iota]$ is, here, an $(n-2) \times (n-2)$ matrix. These two matrices have the following property.

(B1) If $\dot{x} \notin A^\pm$, or $\|\dot{x}\| \geq 1$, then $\mathbf{B}_{n \times n}^{t,1}(x, \lambda) = \mathbf{0}_{n \times n}$ and $\mathbf{B}_{n \times n}^{t,2}(x, \lambda) = (0) \dot{+} (2) \dot{+} \Delta[2; \iota]$.

We show $\mathcal{J}^\iota(\omega_\lambda^\pm) \in \Gamma(\mathbf{R}^n, \mathbf{R}^2)$. Take a point (c, λ) such that $\text{rank} \mathbf{A}_{2 \times n}^t(c, \lambda) = 1$. If $\dot{c} \notin \text{Int} A^\pm$, then $c = (c_1, 0, \dots, 0)$ by (A1), and if $\dot{c} = (c_1, c_2) \in A^\pm$, then $c = (c_1, c_2, 0, \dots, 0)$ and $\text{rank} A_{2 \times 2}(\dot{c}, \lambda) = 1$ by (A3) and (A4). Set $\mathbf{e}(\mathbf{A}_{2 \times n}^t(c, \lambda)) = (\mathbf{e}(K(\omega_\lambda^\pm)_c), 0, \dots, 0)$. Here, let \mathbf{e}' be a vector orthogonal to $K(\omega_\lambda^\pm)_c$. We orient $K(\omega_\lambda^\pm)_c$ so that the juxtapositions $(\mathbf{e}', \mathbf{e}(K(\omega_\lambda^\pm)_c))$ and $(A_{2 \times 2}(\dot{c}, \lambda)(\mathbf{e}'), \mathbf{e}(Q(\omega_\lambda^\pm)_c))$ induce the canonical orientation of \mathbf{R}^2 . Then the kernel of $\mathbf{A}_{2 \times n}^t(c, \lambda)$ is generated by $\mathbf{e}(\mathbf{A}_{2 \times n}^t(c, \lambda)), \mathbf{e}_3, \dots, \mathbf{e}_n$. From the above definition of $\mathcal{J}^\iota(\omega_\lambda^\pm)$ and the fact that $\omega_\lambda^\pm \in \Gamma(\mathbf{R}^2, \mathbf{R}^2)$ it follows that

$$q(\mathcal{J}^\iota(\omega_\lambda^\pm))_c(\mathbf{e}(\mathbf{A}_{2 \times n}^t(c, \lambda)), \mathbf{e}(\mathbf{A}_{2 \times n}^t(c, \lambda))) = q(\omega_\lambda^\pm)_c(\mathbf{e}(K(\omega_\lambda^\pm)_c), \mathbf{e}(K(\omega_\lambda^\pm)_c)) \quad (5.12)$$

is a positive multiple of $\mathbf{e}(Q(\omega_\lambda^\pm)_c)$ (see the equality just below (5.15) for $\lambda = 1$). Therefore, $Q(\mathcal{J}^\iota(\omega_\lambda^\pm))_c$ is generated and oriented by $\mathbf{e}(Q(\omega_\lambda^\pm)_c)$. Furthermore, we have, by (5.11),

$$\begin{aligned} q(\mathcal{J}^\iota(\omega_\lambda^\pm))_c(\mathbf{e}(\mathbf{A}_{2 \times n}^t(c, \lambda)), \mathbf{e}_j) &= \mathbf{0} & \text{for } 2 < j \leq n, \\ q(\mathcal{J}^\iota(\omega_\lambda^\pm))_c(\mathbf{e}_k, \mathbf{e}_\ell) &= 2\delta_{k\ell} \mathbf{e}(Q(\omega_\lambda^\pm)_c) & \text{for } 2 < k \leq n - \iota \text{ and } 2 < \ell \leq n, \\ q(\mathcal{J}^\iota(\omega_\lambda^\pm))_c(\mathbf{e}_k, \mathbf{e}_\ell) &= -2\delta_{k\ell} \mathbf{e}(Q(\omega_\lambda^\pm)_c) & \text{for } n - \iota < k \leq n \text{ and } 2 < \ell \leq n. \end{aligned} \quad (5.13)$$

This shows that $q(\mathcal{J}^\iota(\omega_\lambda^\pm))_c$ is nonsingular and that the index of $q(\mathcal{J}^\iota(\omega_\lambda^\pm))_c$ is equal to ι . Hence, we have $\mathcal{J}^\iota(\omega_\lambda^\pm) \in \Gamma(\mathbf{R}^n, \mathbf{R}^2)$.

Now we are ready to prove (2-i) to (2-iv). It follows from (A1, 5) and (B1) that if either $\dot{x} \notin \text{Int} A^\pm$ or $\|\dot{x}\| \geq 1$, then we have $\mathcal{J}^\iota(\omega_\lambda^\pm)(x) = j^2 g^\iota(x)$ for any $\lambda \in [0, 1]$.

(2-i) From (A1, 4, 5) and (5.11) it follows that $\mathcal{J}^\iota(\omega_0^\pm)(x) = j^2 g^\iota(x)$.

(2-ii) If $\|\dot{x}\| \neq 0$, then $\mathcal{J}^\iota(\omega_1^\pm)(x)$ is a non-singular jet, and hence $S(\mathcal{J}^\iota(\omega_1^\pm))$ consists of $\mathbf{R} \times \mathbf{0}_{n-1}$ and $C(0, \pm 2) \times \mathbf{0}_{n-2}$ by Lemma 5.5 (3) and (5.9). In (5.10) $A_{2 \times 2}(\dot{x}, \lambda - \|\dot{x}\|^2)$ and $\mathbf{e}_\omega(\dot{x}, \lambda - \|\dot{x}\|^2)$ do not depend on the variables x_3, \dots, x_n around $\lambda = 1$, where $\|\dot{x}\|$ is sufficiently small so that $\lambda - \|\dot{x}\|^2 > 9/10$. Hence $\mathcal{J}^\iota(\omega_1^\pm)$ is transverse to $\Sigma^{n-p+1}(\mathbf{R}^n, \mathbf{R}^2)$ by Lemma 5.5 (2). See also the proof of (2-iv) below.

(2-iii) Note that $K(\mathcal{J}^\iota(\omega_1^\pm))_c$ and $Q(\mathcal{J}^\iota(\omega_1^\pm))_c$ are identified with $K(\omega_1^\pm)_c \times \mathbf{0}_{n-2} \oplus \mathbf{0}_2 \times \mathbf{R}^{n-2}$ and $Q(\omega_1^\pm)_c$ respectively. We define

$$m(2, n) : \text{Mono}(K(\omega_1^\pm)|_{\mathbf{R} \times 0}, TR^2|_{\mathbf{R} \times 0}) \rightarrow \text{Mono}(K(\mathcal{J}^\iota(\omega_1^\pm))|_{\mathbf{R} \times \mathbf{0}_{n-1}}, TR^n|_{\mathbf{R} \times \mathbf{0}_{n-1}})$$

by $m(2, n)(h) = h \oplus id_{\mathbf{0}_2 \times \mathbf{R}^{n-2}}$, where $h \in \text{Mono}(K(\omega_1^\pm)|_{\mathbf{R} \times 0}, TR^2|_{\mathbf{R} \times 0})$. Furthermore, the canonical map

$$\overline{m(2, n)} : \text{Mono}(\mathbf{R}, \mathbf{R}^2) \rightarrow \text{Mono}(\mathbf{R} \oplus \mathbf{R}^{n-2}, \mathbf{R}^n)$$

defined similarly as $m(2, n)$, induces a surjection

$$\overline{m(2, n)_*} : \pi_1(\text{Mono}(\mathbf{R}, \mathbf{R}^2)) \rightarrow \pi_1(\text{Mono}(\mathbf{R} \oplus \mathbf{R}^{n-2}, \mathbf{R}^n)).$$

From the proof of (5.8) it follows that

$$\begin{aligned} (i_{\mathcal{N}(\mathcal{J}^\nu(\omega_1^\pm))|_{\mathbf{R} \times \mathbf{0}_{n-1}}})(\mathbf{e}_\ell) &= \mathbf{e}_\ell && \text{for } 2 \leq \ell \leq n, \\ (\Phi(\mathcal{J}^\nu(\omega_1^\pm))|_{\mathbf{R} \times \mathbf{0}_{n-1}})(\mathbf{e}_\ell) &= \mathbf{e}_\ell && \text{for } 2 < \ell \leq n, \\ (\Phi(\mathcal{J}^\nu(\omega_1^\pm))|_{\mathbf{R} \times \mathbf{0}_{n-1}})(x_1, 0)(\mathbf{e}_2) &= (\sqrt{2} - 1)\mathbf{v}^\pm(x_1) && \text{for } |x_1| \leq \pi. \end{aligned}$$

Therefore, we obtain that

$$d(i_{\mathcal{N}(\mathcal{J}^\nu(\omega_1^\pm))|_{\mathbf{R} \times \mathbf{0}_{n-1}}}, \Phi(\mathcal{J}^\nu(\omega_1^\pm))|_{\mathbf{R} \times \mathbf{0}_{n-1}}) = \mp 1.$$

(2-iv) Let $c^\pm(\theta) = ((1/\sqrt{2})\cos\theta, (1/\sqrt{2})\sin\theta \pm 2, \mathbf{0}_{n-2}) \in \mathbf{C}(0, \pm 2)$, $\dot{c}^\pm(\theta) = ((1/\sqrt{2})\cos\theta, (1/\sqrt{2})\sin\theta \pm 2)$ and $\mathbf{e}(\theta) = {}^t(\cos\theta, \sin\theta, \mathbf{0}_{n-2})$. If we prove

$$\begin{aligned} \Phi(\mathcal{J}^\nu(\omega_1^\pm))_{c^\pm(\theta)}(\mathbf{e}(\theta)) &= \mathbf{e}(\theta), \\ \Phi(\mathcal{J}^\nu(\omega_1^\pm))_{c^\pm(\theta)}(\mathbf{e}_\ell) &= \mathbf{e}_\ell && \text{for } 2 < \ell \leq n, \end{aligned} \quad (5.14)$$

then we have $d(i_{\mathcal{N}(\mathcal{J}^\nu(\omega_1^\pm))|_{\mathbf{C}(0, \pm 2)}}, \Phi(\mathcal{J}^\nu(\omega_1^\pm))|_{\mathbf{C}(0, \pm 2)}) = 0$. In fact, $K(\omega_1^\pm)_{\dot{c}^\pm(\theta)}$ is generated by the vector ${}^t(\cos\theta, \sin\theta)$, and $Q(\omega_1^\pm)_{\dot{c}^\pm(\theta)}$ is generated and oriented by ${}^t(-\cos\theta, \pm\sin\theta)$. If p_Q is the orthogonal projection of \mathbf{R}^2 onto the space generated by ${}^t(-\cos\theta, \pm\sin\theta)$, and if we regard $d\mathbf{a}^\pm : T_{\dot{c}^\pm(\theta)}\mathbf{R}^2 \rightarrow TM(2)$ as a map $T_{\dot{c}^\pm(\theta)}\mathbf{R}^2 \rightarrow M(2)$, then we have

$$\begin{aligned} &((d^2(\mathcal{J}^\nu(\omega_1^\pm))_{\sim} \circ d(\mathcal{J}^\nu(\omega_1^\pm))_{\sim}|_{c^\pm(\theta)})(\mathbf{e}(\theta)/\sqrt{2}))(\mathbf{e}(\theta)) \\ &= ((d^2(\omega^\pm)_{\sim} \circ d(\omega^\pm)_{\sim}|_{\dot{c}^\pm(\theta)}))((1/\sqrt{2}){}^t(\cos\theta, \sin\theta))({}^t(\cos\theta, \sin\theta)), \end{aligned} \quad (5.15)$$

which is equal to, as in (5.6),

$$\begin{aligned} &p_Q((d/dt(\mathbf{a}^\pm(\dot{c}^\pm(\theta) + ((t-1)/\sqrt{2})(\cos\theta, \sin\theta)))|_{t=1})({}^t(\cos\theta, \sin\theta))) \\ &= p_Q\left(\frac{d}{dt}\left(e^{1/2-t^2/2}\begin{pmatrix} 1-t^2\cos^2\theta & -t^2\sin\theta\cos\theta \\ \pm(t^2\sin\theta\cos\theta) & \pm(t^2\sin^2\theta-1) \end{pmatrix}\right)\begin{pmatrix} \cos\theta \\ \sin\theta \end{pmatrix}\right)\Big|_{t=1} \\ &= 2({}^t(-\cos\theta, \pm\sin\theta)). \end{aligned}$$

Since

$$((d^2(\mathcal{J}^\nu(\omega_1^\pm))_{\sim} \circ d(\mathcal{J}^\nu(\omega_1^\pm))_{\sim}|_{c^\pm(\theta)})(\mathbf{e}_k))(\mathbf{v}) = p_Q((d\mathbf{A}_{2 \times n}^t(c^\pm(\theta), 1)(\partial/\partial x_k)(\mathbf{v}))|_{c^\pm(\theta)})$$

for $\mathbf{v} \in K(\mathcal{J}^\nu(\omega_1^\pm))$ and since

$$\partial/\partial x_k(\mathbf{A}_{2 \times n}^t(c^\pm(\theta), 1)) = \begin{cases} \begin{pmatrix} \mathbf{0}_{2 \times (k-1)} & 2e_{\omega^\pm}^1(\dot{c}^\pm(\theta), 1) & \mathbf{0}_{2 \times (n-k)} \\ & 2e_{\omega^\pm}^2(\dot{c}^\pm(\theta), 1) & \end{pmatrix} & \text{for } 2 < k \leq n - \iota, \\ \begin{pmatrix} \mathbf{0}_{2 \times (k-1)} & -2e_{\omega^\pm}^1(\dot{c}^\pm(\theta), 1) & \mathbf{0}_{2 \times (n-k)} \\ & -2e_{\omega^\pm}^2(\dot{c}^\pm(\theta), 1) & \end{pmatrix} & \text{for } n - \iota < k \leq n, \end{cases}$$

by (5.10), we have

$$((d^2(\mathcal{J}^\nu(\omega_1^\pm))_{\sim} \circ d(\mathcal{J}^\nu(\omega_1^\pm))_{\sim}|_{c^\pm(\theta)})(\mathbf{e}_k))({}^t(\cos\theta, \sin\theta)) = \mathbf{0} \quad \text{for } 2 < k \leq n,$$

$$\begin{aligned}
& ((d^2(\mathcal{J}^\iota(\omega_1^\pm)) \sim \circ d(\mathcal{J}^\iota(\omega_1^\pm)) \sim |_{c^\pm(\theta)})(\mathbf{e}_k))(\mathbf{e}_\ell) \\
&= \begin{cases} 2\delta_{k\ell}({}^t(-\cos\theta, \pm\sin\theta)) & \text{for } 2 < k \leq n - \iota \text{ and } 2 < \ell \leq n, \\ -2\delta_{k\ell}({}^t(-\cos\theta, \pm\sin\theta)) & \text{for } n - \iota < k \leq n \text{ and } 2 < \ell \leq n. \end{cases} \quad (5.16)
\end{aligned}$$

Thus (5.12), (5.13), (5.15) and (5.16) prove (5.14) by considering the definition of $q(s)$ via $d^2(s)$ in §1. This proves (2-iv).

(3) Let $\sigma_\lambda \in \Gamma(\mathbf{R}^n, \mathbf{R}^p)$ denote $\mathcal{J}^\iota(\omega(\mu_\lambda^i))$ for $p \geq 3$ and $\mathcal{J}^\iota(\omega_\lambda^\pm)$ for $p = 2$. Since $\sigma_0 = j^2g^t$, we orient $Q(\sigma_0) = \theta_{\mathbf{R}^{p-1} \times \mathbf{0}_{n-p+1}}$ by \mathbf{e}_p . From the construction of σ_1 , (5.2), Remark 5.4 and Lemma 5.5, it follows that $S(\sigma_1)$ is constructed in $\mathbf{R}^p \times \mathbf{0}_{n-p}$ by using $\omega(\mu_1^i)$ for $p > 2$ and ω_1^\pm for $p = 2$ so that $S(\sigma_1) = S(\omega(\mu_1^i)) \times \mathbf{0}_{n-p}$ for $p > 2$ and $S(\sigma_1) = S(\omega_1^\pm) \times \mathbf{0}_{n-2}$ for $p = 2$. Furthermore, $Q(\sigma_1)$ is canonically isomorphic to the trivial bundle $Q(\omega(\mu_1^i))$ for $p > 2$ or $Q(\omega_1^\pm)$ for $p = 2$, which has the orientation on $\mathbf{R}^{p-1} \times \mathbf{0}_{n-p+1} \setminus D_{10}^n$ given by \mathbf{e}_p . \square

Proof of Proposition 2.5. For the given section s , let M be any one of $M(s)_j^\iota$'s and set $m = d(i_{\mathcal{N}(s)}|_M, \Phi(s)|_M)$. Suppose that $m \neq 0$. By Remark 4.5 we may assume that we have a point $c \in M \setminus V(C)$, its small neighborhood U_c in $N \setminus V(C)$ with suitable coordinates $e : (\mathbf{R}^{p-1} \times \mathbf{R}^{n-p+1}, \mathbf{0}) \rightarrow (U_c, c)$, and a small neighborhood V_c of the point $\pi_P^2 \circ s(c) \in P$ with suitable coordinates such that $s \circ e$ coincides with j^2g^t on U_c . We take distinct points $c_\ell \in U_c \cap M$ with coordinates $(t_1^\ell, \dots, t_{p-1}^\ell, 0, \dots, 0)$ and disjoint embedding germs $e_\ell : (\mathbf{R}^n, \mathbf{0}) \rightarrow (U_c, c_\ell)$ such that $e_\ell(x) = (x_1 + t_1^\ell, \dots, x_{p-1} + t_{p-1}^\ell, x_p, \dots, x_n)$ ($1 \leq \ell \leq |m|$). Let $\sigma_\lambda \in \Gamma(\mathbf{R}^n, \mathbf{R}^p)$ denote $\mathcal{J}^\iota(\omega(\mu_\lambda^i))$ for $p \geq 3$ and $\mathcal{J}^\iota(\omega_\lambda^\pm)$ for $p = 2$ (if necessary, we have to change the scale) respectively in Proposition 5.7 such that

$$d(i_{\mathcal{N}(\sigma_1)}, \Phi(\sigma_1)) = -m/|m|.$$

For each $e_\ell(\mathbf{R}^n)$, we can construct the homotopy $\sigma(e_\ell)_\lambda \in \Gamma(e_\ell(\mathbf{R}^n), P)$ defined by $\sigma(e_\ell)_\lambda(x) = \sigma_\lambda(e_\ell^{-1}(x))$.

By using $\sigma(e_\ell)_\lambda$'s for each $M(s)_j^\iota$, we have a homotopy s_λ in $\Gamma(N, P)$ defined by

$$\begin{aligned}
s_\lambda|_{e_\ell(\mathbf{R}^n)} &= \sigma(e_\ell)_\lambda && \text{on each } e_\ell(\mathbf{R}^n), \\
s_\lambda|(U_c \setminus \cup_{\ell=1}^{|m|} e_\ell(\mathbf{R}^n)) &= s|(U_c \setminus \cup_{\ell=1}^{|m|} e_\ell(\mathbf{R}^n)) && \text{on each } U_c \text{ for } M(s)_j^\iota, \\
s_\lambda &= s && \text{outside of all } U_c \text{ for } M(s)_j^\iota.
\end{aligned}$$

Then it is easy to see by the additive property of the primary difference that $d(i_{\mathcal{N}(s_1)}|_{M(s_1)_j^\iota}, \Phi(s_1)|_{M(s_1)_j^\iota})$ is equal to 0 for all j and ι . Thus we have proved (1), (2) and (3) of Proposition 2.5.

(4) The triviality of $Q(s_1)$ follows from the above construction of s_1 and Proposition 5.7 (3). \square

References

- [An1] Y. Ando, On the elimination of Morin singularities, J. Math. Soc. Japan 37(1985), 471-487.
- [An2] Y. Ando, The homotopy type of the space consisting of regular jets and folding jets in $J^2(n, n)$, Japanese J. Math. 24(1998), 169-181.
- [An3] Y. Ando, Fold-maps and the space of base point preserving maps of spheres, J. Math. Kyoto Univ. 41(2002), 691-735.
- [B] J. M. Boardman, Singularities of differentiable maps, IHES Publ. Math. 33(1967), 21-57.
- [B-R] O. Burch and G. de Rham, Sur certaines applications g en eriques d'une vari et e close   3 dimensions dans le plan, Enseignement Math. 20(1974), 275-292.
- [E1] J. M.  eliašberg, On singularities of folding type, Math. USSR. Izv. 4(1970), 1119-1134.
- [E2] J. M.  eliašberg, Surgery of singularities of smooth mappings, Math. USSR. Izv. 6(1972), 1302-1326.

- [G1] M. Gromov, Stable mappings of foliations into manifolds, *Math. USSR. Izv.* 3(1969), 671-694.
- [G2] M. Gromov, *Partial Differential Relations*, Springer-Verlag, 1986.
- [H1] M. Hirsch, Immersions of manifolds, *Trans. Amer. Math. Soc.* 93(1959), 242-276.
- [H2] M. Hirsch, *Differential Topology*, Springer-Verlag, 1976.
- [K-N] S. Kobayashi and K. Nomizu, *Foundations of Differential Geometry*, Vol.1, Interscience Publishers, 1963.
- [L1] H. I. Levine, Elimination of cusps, *Topology* 3(1965), 263-296.
- [L2] H. I. Levine, Singularities of differentiable maps, *Proc. Liverpool Singularities Symposium*, Springer Lecture Notes 192(1971), 1-85.
- [P] A. Phillips, Submersions of open manifolds, *Topology* 6(1967), 171-206.
- [Sa1] O. Saeki, Notes on the topology of folds, *J. Math. Soc. Japan* 44(1992), 551-566.
- [Sa2] O. Saeki, Fold maps on 4-manifolds, preprint.
- [S-S] O. Saeki and K. Sakuma, Special generic maps of 4-manifolds and compact complex analytic surfaces, *Math. Ann.* 313(1999), 617-633.
- [Sp] D. Spring, Directed embeddings and the simplification of singularities, *Commun. Contemp. Math.* 4(2002), 107-144.
- [Ste] N. Steenrod, *The Topology of Fibre Bundles*, Princeton Univ. Press, 1951.
- [T] R. Thom, Les singularités des applications différentiables, *Ann. Inst. Fourier* 6(1955-56), 43-87.
- [W] C. T. C. Wall, Classification problems in differential topology-III: Applications to special cases, *Topology* 3(1965), 291-304.

Department of Mathematics, Faculty of Science,
 Yamaguchi University, Yamaguchi 753-8512, Japan
 e-mail: andoy@po.cc.yamaguchi-u.ac.jp