

# Zigzag periodic nanotube in magnetic field

Evgeny Korotyaev <sup>\*</sup>      Igor Lobanov <sup>†</sup>

2nd July 2018

## Abstract

We consider the magnetic Schrödinger operator on the so-called zigzag periodic metric graph (a quasi 1D continuous model of zigzag nanotubes) with a periodic potential. The magnetic field (with the amplitude  $B \in \mathbb{R}$ ) is uniform and it is parallel to the axis of the nanotube. The spectrum of this operator consists of an absolutely continuous part (spectral bands separated by gaps) plus an infinite number of eigenvalues with infinite multiplicity. We describe all compactly supported eigenfunctions with the same eigenvalue. We define a Lyapunov function, which is analytic on some Riemann surface. On each sheet, the Lyapunov function has the same properties as in the scalar case, but it has branch points, which we call resonances. We prove that all resonances are real. We determine the asymptotics of the periodic and anti-periodic spectrum and of the resonances at high energy. We show that endpoints of the gaps are periodic or anti-periodic eigenvalues or resonances (real branch points of the Lyapunov function). We describe the spectrum as functions of  $B$ . For example, if  $B \rightarrow B_{k,m} = \frac{4(\frac{\pi}{2} - \frac{\pi k}{N} + \pi m)}{\sqrt{3} \cos \frac{\pi}{2N}}$ ,  $k = 1, 2, \dots, N, m \in \mathbb{Z}$ , then some spectral band shrinks into a flat band i.e., an eigenvalue of infinite multiplicity.

## 1 Introduction and main results

Consider the Schrödinger operator  $\mathcal{H} = (-i\nabla - \mathcal{A})^2 + q$  on the so-called zigzag periodic metric graph  $\Gamma^{(N)}$ ,  $N \geq 1$  with a periodic potential  $q$  and with a uniform magnetic field  $\mathcal{B} = B(0, 0, 1) \in \mathbb{R}^3$ ,  $B \in \mathbb{R}$ . The corresponding vector potential  $\mathcal{A}$  is given by

$$\mathcal{A}(x) = \frac{1}{2}[\mathcal{B}, x] = \frac{B}{2}(-x_2, x_1, 0), \quad x = (x_1, x_2, x_3) \in \mathbb{R}^3. \quad (1.1)$$

For each integer  $m \geq 1$  we define the finite group  $\mathbb{Z}_m = \mathbb{Z}/(m\mathbb{Z})$ . The graph  $\Gamma^{(N)}$  is a union

---

<sup>\*</sup>Institut für Mathematik, Humboldt Universität zu Berlin, Rudower Chaussee 25, 12489 Berlin, Germany, e-mail: evgeny@math.hu-berlin.de

<sup>†</sup>Mathematical Faculty, Mordovian State University, 430000 Saransk, Russia, e-mail: lobanov@math.mrsu.ru

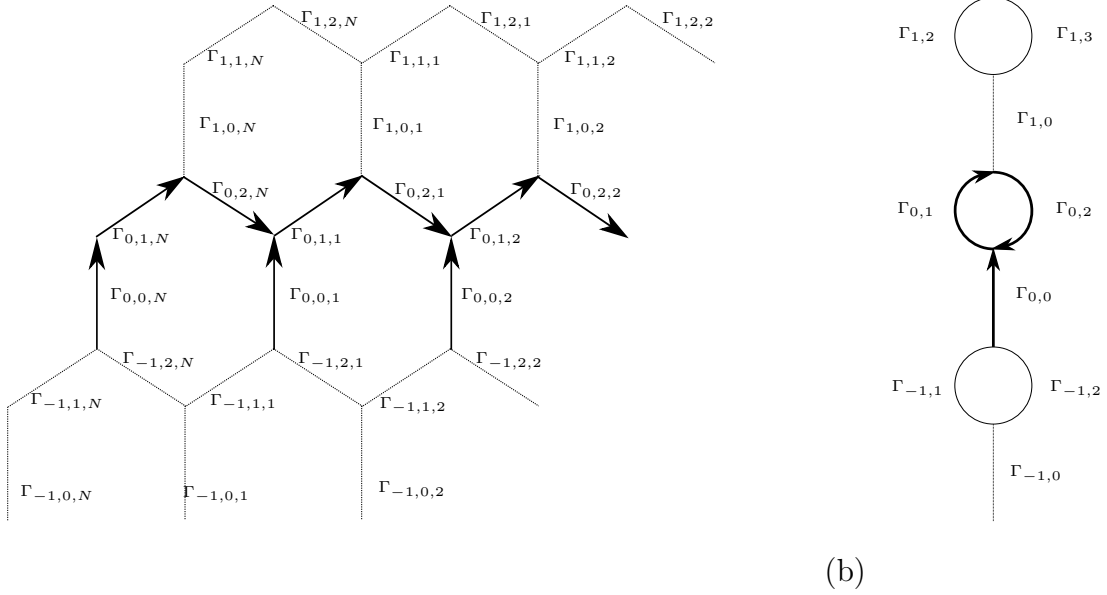

Figure 1: Zigzag graph  $\Gamma^{(N)}$  for (a)  $N = 3$ ; (b)  $N = 1$ . The fundamental domain  $\Gamma_0$  is marked by a bold line.

of edges  $\Gamma_\omega$  and is given by

$$\Gamma^{(N)} = \cup_{\omega \in \mathcal{Z}} \Gamma_\omega, \quad \omega = (n, j, k) \in \mathcal{Z} = \mathbb{Z} \times \mathbb{Z}_3 \times \mathbb{Z}_N, \quad (1.2)$$

$$\Gamma_\omega = \{r = r_\omega^0 + te_\omega, \quad t \in [0, 1]\}, \quad e_\omega = r_\omega^1 - r_\omega^0, \quad r_\omega^0, r_\omega^1 \in \mathbb{R}^3, \quad |e_\omega| = 1,$$

$$r_{\omega_1}^0 = r_\omega^1 = r_{\omega_2}^0, \quad \text{where } \omega_1 = (n+1, 0, k), \quad \omega = (n, 1, k), \quad \omega_2 = (n, 2, k), \quad (1.3)$$

$$r_{\omega_3}^1 = r_\omega^0 = r_{\omega_4}^1, \quad \text{where } \omega_3 = (n, 0, k), \quad \omega_4 = (n, 2, k-1), \quad (1.4)$$

see Fig. 1 and 2. Each edge  $\Gamma_\omega$  is a segment with length  $|\Gamma_\omega| = 1$ . We have the coordinate  $r_\omega = r_\omega^0 + te_\omega$  and the local coordinate  $t \in [0, 1]$ . Introduce the vertex set of  $\Gamma^{(N)}$  by  $V^{(N)} = \{v : v = r_\omega^j, j = 0, 1, \omega = (n, 0, k) \in \mathcal{Z}\}$ . For a function  $f(x), x \in \Gamma$  we define a function  $f_\omega = f|_{\Gamma_\omega}, \omega \in \mathcal{Z}$ . We identify each function  $f_\omega$  on  $\Gamma_\omega$  with a function on  $[0, 1]$  by using the local coordinate  $t \in [0, 1]$  in  $r_\omega = r_\omega^0 + te_\omega$ . Our operator  $\mathcal{H}$  on the graph  $\Gamma^{(N)}$  acts in the Hilbert space  $L^2(\Gamma^{(N)}) = \sum_\omega \oplus L^2(\Gamma_\omega)$ . Then acting on the edge  $\Gamma_\omega$ ,  $\mathcal{H}$  is the ordinary differential operator given by (see [ARZ], [Ku])

$$(\mathcal{H}f)_\omega = -\partial_\omega^2 f_\omega(t) + q(t)f_\omega(t), \quad \partial_\omega = \frac{d}{dt} - ia_\omega, \quad a_\omega(t) = (\mathcal{A}(r_\omega^0 + te_\omega), e_\omega), \quad (1.5)$$

where below in Sect. 2 we will show that

$$a_{n,0,k} = 0, \quad a = a_{n,1,k} = a_{n,2,k} = \frac{B\sqrt{3}}{4} \cos \frac{\pi}{2N}, \quad \text{all } (n, k) \in \mathbb{Z} \times \mathbb{Z}_N. \quad (1.6)$$

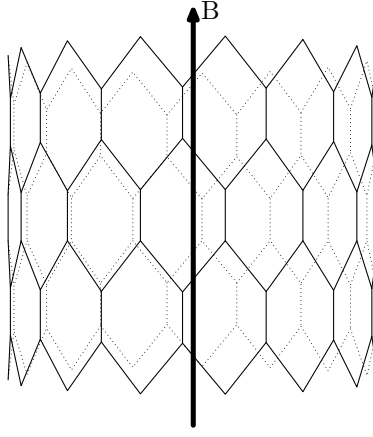

Figure 2: The zigzag graph  $\Gamma$  subjected to the uniform magnetic field  $B$ .

and  $f_\omega, f''_\omega \in L^2(\Gamma_\omega)$ ,  $\omega \in \mathcal{Z}$ ;  $q \in L^2(0, 1)$  and  $f \in \mathfrak{D}(\mathcal{H})$  satisfies the following

**The Kirchhoff Magnetic Boundary Conditions:** each  $f \in \mathfrak{D}(\mathcal{H})$  is continuous on  $\Gamma^{(N)}$  and satisfies

$$-\partial_{\omega_3} f'_{\omega_3}(1) + \partial_\omega f'_\omega(0) - \partial_{\omega_4} f'_{\omega_4}(1) = 0, \quad \partial_{\omega_1} f'_{\omega_1}(0) - \partial_\omega f'_\omega(1) + \partial_{\omega_2} f'_{\omega_2}(0) = 0, \quad (1.7)$$

all  $\omega_1 = (n+1, 0, k)$ ,  $\omega = (n, 1, k)$ ,  $\omega_2 = (n, 2, k)$ ,  $\omega_3 = (n, 0, k)$ ,  $\omega_4 = (n, 2, k-1) \in \mathcal{Z}$ ,

i.e., the sum of external magnetic derivatives of  $f$  at each vertex of  $\Gamma^{(N)}$  is equal to 0.

In Theorem 1.1 we will show that the operator  $\mathcal{H}$  is unitary equivalent to the operator  $H = \sum_1^N \oplus H_k$ . The operator  $H_k$  on the graph  $\Gamma^{(1)}$  acts in the Hilbert space  $L^2(\Gamma^{(1)})$ . In the case  $N = 1$  we will write  $\Gamma_{n,j} = \Gamma_{n,j,1}$  since  $k = 1$  only. Thus  $\Gamma^{(1)} = \cup_{(n,j) \in \mathbb{Z} \times \mathbb{Z}_3} \Gamma_{n,j}$ . Acting on the edge  $\Gamma_{n,j}$ ,  $H_k$  is the ordinary differential operator given by

$$(H_k f)_{n,j} = -f''_{n,j} + q f_{n,j}, \quad f_{n,j} : [0, 1] \rightarrow \mathbb{C} \quad (1.8)$$

on the vector functions  $f = (f_{n,j})$ ,  $(n, j) \in \mathbb{Z} \times \mathbb{Z}_3$ , which satisfy the Kirchhoff conditions

$$f_{n,0}(1) = f_{n,1}(0) = e^{ia} s^k f_{n,2}(1), \quad f_{n+1,0}(0) = e^{ia} f_{n,1}(1) = f_{n,2}(0), \quad s = e^{i\frac{2\pi}{N}}, \quad (1.9)$$

$$-f'_{n,0}(1) + f'_{n,1}(0) - e^{ia} s^k f'_{n,2}(1) = 0, \quad f'_{n+1,0}(0) - e^{ia} f'_{n,1}(1) + f'_{n,2}(0) = 0. \quad (1.10)$$

Introduce the space  $C(\Gamma^{(N)})$  of complex continuous functions on  $\Gamma^{(N)}$  and the Sobolev space  $W^2(\Gamma^{(N)}) = \left\{ f \in C(\Gamma^{(N)}) : f \text{ satisfies conditions (1.9),(1.10), } f, f'' \in L^2(\Gamma^{(N)}) \right\}$ .

If  $q = 0$ , then we denote our operator  $H_k$  by  $H_{0k}$ . The operator  $H_{0k}$  is self-adjoint on  $\mathfrak{D}(H_{0k}) = W^2(\Gamma^{(1)})$  [Ca1]. The operator  $H_k$  is self-adjoint with  $\mathfrak{D}(H_k) = \mathfrak{D}(H_{0k})$ , see Sect.3.

In 1936 such operators were used to model aromatic molecules by Pauling [Pa]. In 1953 Ruedenberg and Scherr [RS] described this model in details. We are going to consider in the framework of this model carbon nanotube, i.e. quasi-one-dimensional materials made

of  $sp^2$ -hybridized carbon networks [RS]. Our graph  $\Gamma^{(N)}$  is a wrapped honeycomb lattice (see Fig (2)), i.e.,  $\Gamma^{(N)}$  is a single wall zigzag nanotube [Ha]. For applications of our model spectral and analysis of these operators see the liter. in [ARZ], [Ku].

We reduce the spectral problem on the graph to some matrix problem on  $\mathbb{R}$ . In order to describe this we define the fundamental subgraph  $\Gamma_0$  by  $\Gamma_0 = \cup_{j=0}^2 \cup_{k=1}^N \Gamma_{0,j,k}$ , Thus  $\cup_{k=1}^N \Gamma_{0,0,k}$  contains only "vertical" edges  $\Gamma_{0,0,k}$ ;  $\cup_{k=1}^N \Gamma_{0,1,k}$  and  $\cup_{k=1}^N \Gamma_{0,2,k}$  contains only edges  $\Gamma_{0,j,k}$  with positive and negative projections on the vector  $(0, 0, 1) \in \mathbb{R}^3$ , see Fig. 1. On  $\Gamma^{(N)}$ , the group  $\mathbb{Z}$  acts via

$$p \circ \Gamma_{n,j,k} = \Gamma_{n+p,j,k}, \quad n, p \in \mathbb{Z}, \quad (n, j, k) \in \mathcal{Z}. \quad (1.11)$$

Thus  $\Gamma_0$  is a fundamental domain associated with this group action.

There are two methods to study periodic differential operators. The direct integral analysis usually used for partial differential operators [ReS] gives general information about the spectrum, but no detailed results. The method of ordinary differential operators, based on the Floquet matrix analysis, gives detailed results, but even for the Schrödinger operator with periodic 2x2 matrix potentials on the real line there are a lot of open problems [BBK].

We reduce the spectral problem on the graph to some matrix problem on  $\mathbb{R}$ . For the operator  $H_k$  we construct the fundamental solutions  $\Theta_k(x, \lambda) = (\Theta_{k,\alpha}(x, \lambda))_{\alpha \in \mathcal{Z} \times \mathbb{Z}_3}$ , and  $\Phi_k(x, \lambda) = (\Phi_{k,\alpha}(x, \lambda))_{\alpha \in \mathcal{Z} \times \mathbb{Z}_3}$ ,  $(x, \lambda) \in \mathbb{R} \times \mathbb{C}$  which satisfy

$$-f''_{n,j} + qf_{n,j} = \lambda f_{n,j}, \quad \text{the Kirchhoff Boundary Conditions (1.9),(1.10)}, \quad (1.12)$$

$$\Theta_{k,\alpha}(0, \lambda) = \Phi'_{k,\alpha}(0, \lambda) = 1, \quad \Theta'_{k,\alpha}(0, \lambda) = \Phi_{k,\alpha}(0, \lambda) = 0, \quad \alpha = (0, 0). \quad (1.13)$$

We introduce the monodromy matrix

$$\mathcal{M}_k(\lambda) = \begin{pmatrix} \Theta_{k,\omega}(0, \lambda) & \Phi_{k,\omega}(0, \lambda) \\ \Theta'_{k,\omega}(0, \lambda) & \Phi'_{k,\omega}(0, \lambda) \end{pmatrix}, \quad \omega = (1, 0). \quad (1.14)$$

We introduce the monodromy matrix, similar to the case of Schrödinger operators with periodic matrix potentials on the real line, see [YS]. After this, roughly speaking, using the approach from [BK],[BBK],[CK] we introduce the Laypunov functions and study the properties of these functions, similar to the case of the Schrödinger operator with a periodic matrix potential on the real line. This is a crucial point of our analysis. Here we essentially use the results and techniques from the papers [BK], [BBK],[CK]. The recent papers [BBK],[CK] are devoted to the the Schrödinger operator with a periodic matrix potential (a standard case) on the real line. Remark that Carlson [Ca] studied the monodromy operator to analyze the Schrödinger operator on a product of graphs.

Recall the needed properties of the equation  $-f'' + q(x)f = \lambda f$  on the real line with a periodic potential  $q(x+1) = q(x)$ ,  $x \in \mathbb{R}$ . In this case we introduce the fundamental solutions  $\vartheta(x, \lambda)$  and  $\varphi(x, \lambda)$ ,  $x \in \mathbb{R}$  satisfying  $\vartheta(0, \lambda) = \varphi(0, \lambda) = 1$ ,  $\vartheta'(0, \lambda) = \varphi'(0, \lambda) = 0$ . The corresponding monodromy matrix  $\mathcal{M}(\lambda)$  and the Lyapunov function  $\Delta$  are given by

$$\mathcal{M}(\lambda) = \begin{pmatrix} \vartheta(1, \lambda) & \varphi(1, \lambda) \\ \vartheta'(1, \lambda) & \varphi'(1, \lambda) \end{pmatrix}, \quad \Delta(\lambda) = \frac{1}{2}(\varphi'(1, \lambda) + \vartheta(1, \lambda)), \quad \lambda \in \mathbb{C}. \quad (1.15)$$

Let  $\mu_n, n \geq 1$ , be the Dirichlet spectrum of the problem  $-y'' + qy = \lambda y, y(0) = y(1) = 0$  on the unit interval  $[0, 1]$  and define the set  $\sigma_D = \{\mu_n, n \geq 1\}$ . Recall that  $\sigma_D = \{\lambda \in \mathbb{C} : \varphi(1, \lambda) = 0\}$ . Let  $\nu_n, n \geq 0$ , be the Neumann spectrum of equation  $-y'' + qy$  for the boundary condition  $y'(0) = y'(1) = 0$ . Define

$$F = 2\Delta^2 + \frac{\varphi(1, \cdot)\vartheta'(1, \cdot)}{4} - 1, \quad c_k = \cos(a + \frac{\pi k}{N}), \quad s_k = \sin(a + \frac{\pi k}{N}), \quad (1.16)$$

$k = 0, 1, \dots, N$ . We formulate our first result about the fundamental solutions  $\Theta_k, \Phi_k$ .

**Theorem 1.1.** *i) The operator  $\mathcal{H}$  is unitary equivalent to the operator  $H = \sum_1^N \oplus H_k$ .  
ii) Let  $c_k = \cos(a + \frac{\pi k}{N}) \neq 0$  for some  $(k, a) \in \mathbb{Z}_N \times \mathbb{R}$ . Then for any  $\lambda \in \mathbb{C} \setminus \sigma_D$  there exist unique fundamental solutions  $\Theta_k, \Phi_k$  of the system (1.12) with conditions (1.13) and each function  $\Theta_k(x, \lambda), \Phi_k(x, \lambda), x \in \Gamma^{(1)}$  is meromorphic in  $\lambda \in \mathbb{C} \setminus \sigma_D$ . Moreover, each matrix  $\mathcal{M}_k(\lambda)$  satisfies*

$$\mathcal{M}_k = \mathcal{R}^{-1} \mathcal{T}_k \mathcal{R} \mathcal{M}, \quad \mathcal{T}_k = \frac{s^{-\frac{k}{2}}}{2c_k} \begin{pmatrix} 2\Delta & 1 \\ 4\Delta^2 - 4c_k^2 & 2\Delta \end{pmatrix}, \quad \mathcal{R} = \begin{pmatrix} 1 & 0 \\ 0 & \varphi(1, \cdot) \end{pmatrix}, \quad (1.17)$$

$$\det \mathcal{M}_k = s^{-k}, \quad \text{Tr } \mathcal{M}_k = \frac{2s^{-\frac{k}{2}}(F + s_k^2)}{c_k} \quad (1.18)$$

and the function  $D_k(\tau, \lambda) = \det(\mathcal{M}_k(\lambda) - \tau I_2)$  is entire with respect to  $\lambda, \tau \in \mathbb{C}$ .

Remark that in contrast to the Schrödinger operator with periodic matrix potentials on the real line (see [YS] or [CK]), the monodromy matrix  $\mathcal{M}_k$  has poles at the points  $\lambda \in \sigma_D$ , which are eigenvalues of  $H_k$ , see Theorem 1.2. However,  $\mathcal{M}_k$  is similar to the entire matrix-valued function. Define the subspace  $\mathcal{H}_k(\lambda) = \{\psi \in \mathfrak{D}(H_k) : H_k \psi = \lambda \psi\}$  for  $\lambda \in \sigma(H_k), k \in \mathbb{Z}_N$ . If some  $\lambda_0 \in \mathbb{R}$  is an eigenvalue of  $H_k$  with infinite multiplicity, then we say that  $\{\lambda_0\}$  is a flat band. In Theorem 1.2 and 1.3 we describe all flat bands.

**Theorem 1.2.** *Let  $(\lambda, a, k) \in \sigma_D \times \mathbb{R} \times \mathbb{Z}_N$ . Then*

*i) Every eigenfunction from  $\mathcal{H}_k(\lambda)$  vanishes at all vertexes of  $\Gamma^{(1)}$ .*

*ii) Let the function  $\psi^{(0)}$  be given by :*

*if  $\eta = 1 - e^{2ia} s^k \varphi'(1, \lambda)^2 \neq 0$ , then*

$$\begin{aligned} \psi_{n,j}^{(0)} = 0, \text{ for all } n \neq 0, -1, j \in \mathbb{Z}_3, \quad \text{and} \quad \psi_{0,0}^{(0)} = \eta \varphi_t, \quad \psi_{0,1}^{(0)} = \varphi_1' \varphi_t, \quad \psi_{0,2}^{(0)} = e^{ia} \varphi_1'^2 \varphi_t, \\ \psi_{-1,0}^{(0)} = 0, \quad \psi_{-1,1}^{(0)} = -e^{ia} s^k \varphi_1' \varphi_t, \quad \psi_{-1,2}^{(0)} = -\varphi_t, \quad t \in [0, 1], \end{aligned} \quad (1.19)$$

*if  $\eta = 0$ , then*

$$\psi_{0,0}^{(0)} = 0, \quad \psi_{0,1}^{(0)}(t) = \varphi_t, \quad \psi_{0,2}^{(0)}(t) = e^{ia} \varphi_1' \varphi_t, \quad t \in [0, 1], \quad \psi_{n,j}^{(0)} = 0, \text{ all } n \neq 0, j \in \mathbb{Z}_3. \quad (1.20)$$

*Then each  $\psi^{(n)} = (\psi_{n-m,j}^{(0)})_{(m,j) \in \mathbb{Z} \times \mathbb{Z}_3} \in \mathcal{H}_k(\lambda), n \in \mathbb{Z}$  and each  $f \in \mathcal{H}_k(\lambda)$  has the form*

$$f = \sum_{n \in \mathbb{Z}} \widehat{f}_n \psi^{(n)}, \quad \widehat{f}_n = \begin{cases} \eta^{-1} f'_{n,0}(0) & \text{if } \eta \neq 0 \\ f'_{n,1}(0) & \text{if } \eta = 0 \end{cases}, \quad (\widehat{f}_n)_{-\infty}^{\infty} \in \ell^2 \quad (1.21)$$

*and the mapping  $f \rightarrow \{\widehat{f}_n\}$  is a linear isomorphism between  $\mathcal{H}_k(\lambda)$  and  $\ell^2$ .*

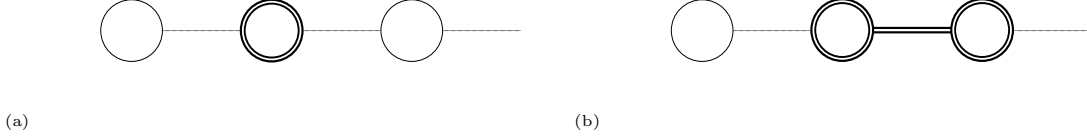

Figure 3: The supports of the eigenfunction  $\psi^{(0)}$  corresponding to an eigenvalue contained in  $\sigma_D$ : (a)  $\eta = 1 - e^{2ia} s^k \varphi'(1, \lambda)^2 = 0$ ; (b)  $\eta \neq 0$ . The support of the eigenfunction  $\psi^{(0)}$  corresponding to an eigenvalue belonging to  $\sigma_{AP}$  coincides with one shown on the figure (b).

For a self-adjoint operator  $H$  we define the set

$$\sigma_\infty(H) = \{\lambda : \lambda \in \sigma_{pp}(H) \text{ is of infinite multiplicity}\}.$$

We define the **singular magnetic field** by  $\tilde{a}_{k,m} = \frac{\pi}{2} - \frac{\pi k}{N} + \pi m, (k, m) \in \mathbb{Z}_N \times \mathbb{Z}$  and **singular energy**  $\lambda \in \sigma_{AP} = \{\lambda \in \mathbb{R} : F(\lambda) = -1\}$ . Note that  $\sigma_D \cap \sigma_{AP} = \emptyset$ , see Sect.4 and Theorem 4.2. Let  $\tilde{\lambda}_n, n \geq 1$  be the zeros of  $F(\lambda) = -1$ . Due to Theorem 4.2, all  $\tilde{\lambda}_n$  are real and have asymptotics  $\tilde{\lambda}_n = \pi^2 n^2 + O(n)$  as  $n \rightarrow \infty$ . We describe the operator  $H_k(a)$  for the case of **singular magnetic field**.

**Theorem 1.3.** *Let  $c_k = \cos(a + \frac{\pi k}{N}) = 0$  for some  $(k, a) \in \mathbb{Z}_N \times \mathbb{R}$ . Then*

$$\sigma(H_k(a)) = \sigma_\infty(H_k(a)) = \sigma_D \cup \sigma_{AP}, \quad \text{where } \sigma_{AP} = \{\lambda \in \mathbb{R} : F(\lambda) = -1\}. \quad (1.22)$$

If in addition for some  $\lambda \in \sigma_{AP}$  a function  $\psi^{(0)}$  is given by

$$\begin{aligned} \psi_{0,0}^{(0)}(t) &= \varphi_t C_1 + \vartheta_t C_2, & \psi_{0,1}^{(0)}(t) &= \vartheta_t - \varphi_t \frac{\vartheta_1}{\varphi_1}, & \psi_{0,2}^{(0)}(t) &= -\frac{\varphi_t}{\varphi_1} e^{ia}, \\ \psi_{-1,0}^{(0)} &= 0, & \phi_{-1,1}(t) &= \frac{\varphi_t}{\varphi_1} e^{-ia} C_1, & \psi_{-1,2}^{(0)}(t) &= (\vartheta_t - \varphi_t \frac{\vartheta_1}{\varphi_1}) C_1, \end{aligned} \quad t \in [0, 1], \quad (1.23)$$

$$\psi_{n,j}^{(0)} = 0, \text{ any } n \neq -1, 0, j = 1, 2, \quad C_1 = \varphi_1' + 2\Delta, \quad C_2 = -\vartheta_1' - \frac{2\vartheta_1 \Delta}{\varphi_1}, \quad (1.24)$$

then each  $\psi^{(n)} = (\psi_{n-m,j}^{(0)})_{(m,j) \in \mathbb{Z} \times \mathbb{Z}_3} \in \mathcal{H}_k(\lambda), n \in \mathbb{Z}$  and each  $f \in \mathcal{H}_k(\lambda)$  has the form

$$f = \sum_{n \in \mathbb{Z}} \hat{f}_n \psi^{(n)}, \quad \hat{f}_n = \frac{f_{n,1}(0)}{C_2}, \quad (\hat{f}_n)_{-\infty}^\infty \in \ell^2 \quad (1.25)$$

and the mapping  $f \rightarrow \{\hat{f}_n\}$  is a linear isomorphism between  $\mathcal{H}_k(\lambda)$  and  $\ell^2$ .

Below we will sometimes write  $\mathcal{M}_k(\lambda, a, q), F_k(\lambda, a, q), \dots$ , instead of  $\mathcal{M}_k(\lambda), F_k(\lambda), \dots$ , when several magnetic fields and potentials are being dealt with. Let  $\tau_{k,\pm}$  be the eigenvalues of  $\mathcal{M}_k, k \in \mathbb{Z}_N$ . Using (1.18) we deduce that

$$\tau_{k,-} - \tau_{k,+} = s^{-k}, \quad \tau_{k,-} + \tau_{k,+} = \text{Tr } \mathcal{M}_k = \frac{2s^{-\frac{k}{2}}}{c_k} (F + s_k^2). \quad (1.26)$$

If  $k = 0$ , then we can introduce the standard entire Lyapunov function  $F_0$  by

$$F_0 = \frac{\text{Tr } \mathcal{M}_0}{2} = \frac{1}{2}(\tau_{0,+} + \frac{1}{\tau_{0,+}}) = \frac{F + s_0^2}{c_0}. \quad (1.27)$$

The asymptotics of the fundamental solutions  $\vartheta, \varphi$ , imply (see [KL])

$$F(\lambda, q) = \Delta_0^0(\lambda) + \frac{O(e^{|\text{Im } \sqrt{\lambda}|})}{\sqrt{\lambda}}, \quad \Delta_0^0(\lambda) = \frac{9 \cos 2\sqrt{\lambda} - 1}{8} \quad \text{as } |\lambda| \rightarrow \infty,$$

where  $\Delta_0^0$  is  $F$  at  $q = 0$ . In particular, if  $q = 0$ , then we get  $F_0(\lambda, a, 0) = \frac{\Delta_0^0 + s_0^2}{c_0}$ .

If  $k \neq 0$ , then we define the Lyapunov functions  $F_{k,\pm} = \frac{1}{2}(\tau_{k,\pm} + \frac{1}{\tau_{k,\pm}})$ , (see [BBK],[CK]). But in this case the Lyapunov functions are not entire, in general (see [BBK],[CK]). Below we prove the following identities

$$F_{k,\pm} = \frac{1}{2}(\tau_{k,\pm} + \frac{1}{\tau_{k,\pm}}) = T_k \pm \sqrt{R_k}, \quad T_k = \frac{c_{0k}}{c_k}(F + s_k^2), \quad R_k = \frac{s_{0k}^2}{c_k^2} \left( c_k^2 - (F + s_k^2)^2 \right), \quad (1.28)$$

where  $s_{0,k} = \sin \frac{\pi k}{N}$ ,  $c_{0,k} = \cos \frac{\pi k}{N}$ . Introduce the two sheeted Riemann surface  $\mathfrak{R}_k$  (of infinite genus) defined by  $\sqrt{R_k}$ . The functions  $F_{k,\pm}, k \in \overline{N-1}$  are the branches of  $F_k = T_k + \sqrt{R_k}$  on the Riemann surface  $\mathfrak{R}_k$ , where the set  $\overline{N} = \{1, 2, \dots, N\}$ .

**Theorem 1.4.** *Let  $c_k = \cos(a + \frac{\pi k}{N}) \neq 0$  for some  $(k, a) \in \mathbb{Z}_N \times \mathbb{R}$ . Then*

*i) The Lyapunov functions  $F_{k,\pm}, k \neq 0$  satisfy (1.28).*

*ii) The following identities hold:*

$$\sigma(H_k) = \sigma_\infty(H_k) \cup \sigma_{ac}(H_k), \quad \sigma_\infty(H_k) = \sigma_D, \quad \sigma_{ac}(H_k) = \{\lambda \in \mathbb{R} : F_k(\lambda) \in [-1, 1]\}. \quad (1.29)$$

*iii) Let some  $\lambda \in \mathbb{R}$  be not a branch point of  $F_k$  and let  $F_k(\lambda) \in (-1, 1)$ . Then  $F'_k(\lambda) \neq 0$ .*

**Remark.** 1) If we know  $F_0$ , then we determine all  $F_k, \rho_k, k \in \overline{N-1}$  by (1.28). 2) If we know  $\rho_k$  for some  $k \in \overline{N-1}$ , then we determine all  $F_k, \rho_k, k \in \overline{N}$  by (1.28).

Consider  $H_0$ . Using the definition (1.27) we obtain  $F_0(\cdot, -a) = F_0(\cdot, a) = -F_0(\cdot, a + \pi)$  for  $\cos a \neq 0$  and  $F_0(\cdot, a + \frac{\pi}{2}) = -F_0(\cdot, \frac{\pi}{2} - a)$  for  $a \in \mathbb{C} \setminus \pi\mathbb{Z}$ . Due to this symmetry it is sufficient to consider the case  $a \in [0, \frac{\pi}{2})$ . The value  $\tilde{a}_{0,m} = \frac{\pi}{2} + \pi m$  is a singular magnetic field for  $H_0$ . The important case  $a = 0$  for odd  $N$  was studied in [KL], the case of  $N$  even is studied in Sect. 4. The results for both these cases are formulated in Sect. 4.

Let  $a \in (0, \frac{\pi}{2})$ . Let  $D_0(\cdot, \tau) = \det(\mathcal{M}_0 - \tau I_2), \tau \in \mathbb{C}$  and let  $\lambda_{0,n}^\pm = \lambda_{0,n}^\pm(a)$  be the zeros of  $D_0(\lambda, 1)D_0(\lambda, -1)$ , where  $I_N, N \geq 1$  is the identity  $N \times N$  matrix. The zeros of  $D_0(\lambda, 1)$  (and  $D_0(\lambda, -1)$ ) counted with multiplicity are the periodic (anti-periodic) eigenvalues for the equation  $-y'' + qy = \lambda y$  on  $\Gamma^{(1)}$  with periodic (anti-periodic) boundary conditions. Below we will show that  $\lambda_{0,n}^\pm = \lambda_{0,n}^\pm(a)$  satisfy for  $a \in (0, \frac{\pi}{2})$ :

$$F_0(\lambda_{0,n}^\pm) = (-1)^n, \quad \lambda_{0,0}^+ < \lambda_{0,1}^- < \lambda_{0,1}^+ < \lambda_{0,2}^- < \lambda_{0,2}^+ < \lambda_{0,3}^- < \lambda_{0,3}^+ < \lambda_{0,4}^- < \lambda_{0,4}^+ < \dots \quad (1.30)$$

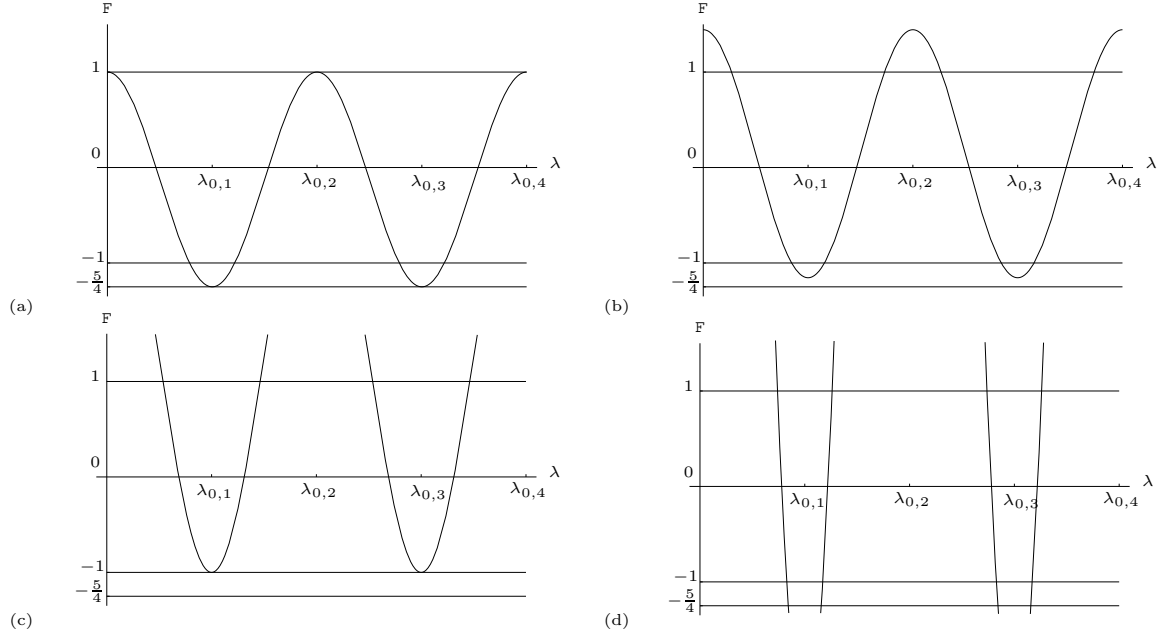

Figure 4: The function  $F_0(\lambda, a)$  for (a)  $a = 0$ ; (b)  $a = \frac{\pi}{6}$ ; (c)  $a = \frac{\pi}{3}$ ; (d)  $a \uparrow \frac{\pi}{2}$ .

$$\lambda_{0,n}^{\pm} = \left(\frac{\pi n}{2} \pm \phi_n\right)^2 + q_0 + \frac{o(1)}{n}, \quad \phi_{2n} = f_0, \quad \phi_{2n-1} = \frac{\pi}{2} - f_1 \quad \text{as } n \rightarrow \infty, \quad (1.31)$$

where  $f_s = \frac{1}{2} \arccos \frac{1+(-1)^s 8c_0 - 8s_0^2}{9} \in [0, \frac{\pi}{2}]$ ,  $s = 0, 1$ . If  $a = 0$ , then  $\lambda_{0,2n}^- \leq \lambda_{0,2n}^+$ ,  $n \geq 1$ , see Sect.4. Introduce the gaps  $\gamma_{0,n}(a)$  and the spectral bands  $\sigma_{0,n}(a)$  of  $H_0(a)$  by

$$\gamma_{0,n}(a) = (\lambda_{0,n}^-(a), \lambda_{0,n}^+(a)), \quad \sigma_{0,n}(a) = [\lambda_{0,n-1}^+(a), \lambda_{0,n}^-(a)], \quad n \geq 1.$$

The following theorem describes the basic properties of  $H_0$ .

**Theorem 1.5.** *Let  $a \in (0, \frac{\pi}{2})$ . Then the function  $F_0(\lambda, a) = (F(\lambda) + s_0^2)/c_0$  satisfies*

i) *The function  $\frac{\partial}{\partial \lambda} F_0(\lambda, a)$  has only real simple zeros  $\lambda_{0,n} = \lambda_{0,n}(a)$ ,  $n \geq 1$ , which are separated by the simple zeros  $\eta_{0,n} = \eta_{0,n}(a)$  of  $F_0(\lambda, a)$ :  $\eta_{0,1} < \lambda_{0,1} < \eta_{0,2} < \lambda_{0,2} < \eta_{0,3} < \dots$  and satisfy for all  $n \geq 1$ :*

$$\nu_n, \mu_n \in \gamma_{0,2n}, \quad F_0(\lambda_{0,2n}, a) \geq \frac{1 + s_0^2}{c_0} > 1, \quad F_0(\lambda_{0,2n-1}, a) \leq -\frac{1 + 4c_0^2}{4c_0} \leq -1. \quad (1.32)$$

Moreover, if  $c_0 \neq \frac{1}{2}$ , then  $F_0(\lambda_{0,2n-1}, a) \leq -\frac{1+4c_0^2}{4c_0} < -1$ . The periodic and anti-periodic eigenvalues satisfy (1.30).

ii) *Each even gap  $\gamma_{0,2n}(a) = (\lambda_{0,2n}^-, \lambda_{0,2n}^+)$ ,  $n \geq 1$  is open and satisfies*

$$\gamma_{0,2n}(a) \subset \gamma_{0,2n}(a_1), \quad 0 < a < a_1 < \frac{\pi}{2}. \quad (1.33)$$

*Odd gaps  $\gamma_{0,m}(a) = (\lambda_{0,m}^-(a), \lambda_{0,m}^+(a))$ ,  $m = 2n - 1$ ,  $n \geq 1$  satisfy*

$$\gamma_{0,m}(a) \supset \gamma_{0,m}(a_1), \quad 0 \leq a < a_1 \leq \frac{\pi}{3} \quad \text{and} \quad \gamma_{0,m}(a) \subset \gamma_{0,m}(a_1), \quad \frac{\pi}{3} \leq a < a_1 < \frac{\pi}{2}. \quad (1.34)$$



Moreover, if  $a = \frac{\pi}{3}$  and  $q \in L_{\text{even}}^2(0, 1)$ , then all  $\gamma_{0,2n-1}(a) = \emptyset$ ,  $n \geq 1$ .

iii) The asymptotics (1.31) hold true.

iv) Let  $a \uparrow \frac{\pi}{2}$ . Then each band  $\sigma_{0,n}(a) \rightarrow \tilde{\sigma}_n = \{\tilde{\lambda}_n\}$  (recall  $F(\tilde{\lambda}_n) = -1$ ) and  $\tilde{\sigma}_n$  is a flat band for  $H_0(\frac{\pi}{2})$  and

$$\lambda_{0,n}^-(a), \lambda_{0,n-1}^+(a) = \tilde{\lambda}_n + \frac{c_0 + O(c_0^2)}{F'(\tilde{\lambda}_n)} \quad \text{as } a \uparrow \frac{\pi}{2}. \quad (1.35)$$

**Remark.** 1) If  $a = \frac{\pi}{2}$ , then by Theorem 1.3,  $\sigma(H_0(\frac{\pi}{2})) = \sigma_\infty(H_0(\frac{\pi}{2})) = \sigma_{AP} \cup \sigma_D$ . By Theorem 1.4, 1.5,  $\sigma(H_0(a)) = \sigma_{ac}(H_0(a)) \cup \sigma_\infty(H_0(a))$ ,  $\sigma_\infty(H_0(a)) = \sigma_D$  for all  $a \in (0, \frac{\pi}{2})$ . The asymptotics (1.33) give the asymptotics of shrinking bands, as  $a \uparrow \frac{\pi}{2}$ . Moreover, if  $\frac{\pi}{2} - a > 0$  is increasing then the spectral bands are increasing too.

2) If  $a \in (0, \frac{\pi}{2})$ , then all even gaps  $\gamma_{0,2n}$  are open. If  $a \uparrow \frac{\pi}{2}$ , then each band shrinks to the flat band.

3) If firstly  $a = \frac{\pi}{2}$ , then by Theorem 1.3, all bands are flat. If secondly,  $a < \frac{\pi}{2}$ , then by iv), each flat band  $\tilde{\sigma}_n$  becomes ordinary band from  $\sigma_{ac}(H(a))$ .

Consider the operator  $H_k, k \neq 0$  for the case  $c_k \neq 0$ . Let  $D_k(\cdot, \tau) = \det(\mathcal{M}_k - \tau I_2)$ ,  $\tau \in \mathbb{C}, k \in \overline{N-1}$ . Let  $\lambda_{k,n}^\pm = \lambda_{k,n}^\pm(a)$  and  $\mu_{k,n}^\pm = \mu_{k,n}^\pm(a), n \geq 0$  be the zeros of  $D_k(\lambda, 1)$  and  $D_k(\lambda, -1)$ . In Theorem 1.6 we will show that the periodic eigenvalues  $\lambda_{k,n}^\pm$  and the anti-periodic eigenvalues  $\mu_{k,n}^\pm$  satisfy the equations  $F_k(\lambda_{k,n}^\pm) = 1, F_k(\mu_{k,n}^\pm) = -1$  and

$$F(\lambda_{k,n}^\pm) = c_{0k}c_k - s_k^2 \in (-\frac{5}{4}, 1), \quad F(\mu_{k,n}^\pm) = -c_{0k}c_k - s_k^2 \in (-\frac{5}{4}, 1), \quad (1.36)$$

and a labeling is given by: each  $\lambda_{k,n}^\pm, \mu_{k,n}^\pm$  is simple and

$$\lambda_{k,0}^+ < \lambda_{k,1}^- < \lambda_{k,1}^+ < \lambda_{k,2}^- < \lambda_{k,2}^+ \dots, \quad \mu_{k,0}^+ < \mu_{k,1}^- < \mu_{k,1}^+ < \mu_{k,2}^- < \mu_{k,2}^+ \dots, \quad (1.37)$$

$$\lambda_{k,n}^\pm = (\pi n \pm \phi_{k,0})^2 + q_0 + \frac{o(1)}{n}, \quad \mu_{k,n}^\pm = (\pi n \pm \phi_{k,1})^2 + q_0 + \frac{o(1)}{n}, \quad \text{as } n \rightarrow \infty, \quad (1.38)$$

$$\phi_{k,s} = \frac{1}{2} \arccos \frac{1 + 8((-1)^s c_{0k}c_k - s_k^2)}{9} \in [0, \frac{\pi}{2}] \quad s = 0, 1.$$

Let  $r_{k,n}^\pm, k \in \overline{N-1}, n \geq 0$  be the zeros of  $R_k$ , which defined by (1.28). A zero of  $R_k, k \in \overline{N-1}$  is called a **resonance** of  $H_k$ . Below we will show that these resonances satisfy the equations

$$F(r_{k,2n}^\pm) = |c_k| - s_k^2, \quad F(r_{k,2n+1}^\pm) = -|c_k| - s_k^2, \quad k \in \overline{N-1}, n \geq 0, \quad (1.39)$$

they are real and labeling is given by

$$r_{k,0}^+ < r_{k,1}^- < r_{k,1}^+ < r_{k,2}^- < r_{k,2}^+ < \dots, \quad |c_k| \neq \frac{1}{2}, |c_k| \neq 1, \quad (1.40)$$

$$r_{k,0}^+ < r_{k,1}^- < r_{k,1}^+ < r_{k,2}^- \leq r_{k,2}^+ < r_{k,3}^- < r_{k,3}^+ < r_{k,4}^- \leq r_{k,4}^+ < \dots, \quad |c_k| = 1, \quad (1.41)$$

$$r_{k,0}^+ < r_{k,1}^- \leq r_{k,1}^+ < r_{k,2}^- < r_{k,2}^+ < r_{k,3}^- \leq r_{k,3}^+ < \dots, \quad |c_k| = \frac{1}{2}. \quad (1.42)$$

The resonances  $r_{k,n}^\pm$ , satisfy

$$r_{k,n}^\pm = \left(\frac{\pi n}{2} \pm \phi_n\right)^2 + q_0 + o(n^{-1}), \quad \phi_{2n} = f_0, \phi_{2n-1} = \frac{\pi}{2} - f_1, \quad f_s = \frac{\arccos Y_s}{2} \in [0, \frac{\pi}{2}], \quad (1.43)$$

$Y_s = \frac{1+(-1)^s 8|c_k| - 8s^2}{9}$ ,  $s = 0, 1$  as  $n \rightarrow \infty$ . We describe the spectral properties of  $H_k$  in terms of the Lyapunov functions.

**Theorem 1.6.** *i) Let  $\mathfrak{S}_k(a) = \{\lambda \in \mathbb{R} : (F(\lambda) + s_k^2)^2 \leq c_k^2\}$  for some  $(k, a) \in \mathbb{Z}_N \times \mathbb{R}$ . Then the following identities hold*

$$\sigma(H_k(a)) = \mathfrak{S}_k(a) \cup \sigma_D = \sigma(H_{k-1}(a + \frac{\pi}{N})), \quad \mathfrak{S}_k(a) = \begin{cases} \sigma_{ac}(H_k(a)) & \text{if } c_k \neq 0 \\ \sigma_{AP} & \text{if } c_k = 0 \end{cases}. \quad (1.44)$$

*ii) Let  $c_k = \cos(a + \frac{\pi k}{N}) \neq 0$  for some  $(k, a) \in \overline{N-1} \times \mathbb{R}$ . Then the resonances  $r_{k,n}^\pm$ ,  $n \geq 0$  satisfy Eq. (1.39) and the estimates (1.40)-(1.43). Moreover, the spectral bands  $\sigma_{k,n}$  and the gaps  $\gamma_{k,n}$ ,  $n \geq 1$  for the operator  $H_k$  are given by*

$$\sigma_{ac}(H_k(a)) = \cup_{n=1}^{\infty} \sigma_{k,n}(a), \quad \sigma_{k,n}(a) = [r_{k,n-1}^+(a), r_{k,n}^-(a)], \quad \gamma_{k,n}(a) = (r_{k,n}^-(a), r_{k,n}^+(a)). \quad (1.45)$$

*iii) Let  $c_k \neq 0$  for some  $(k, a) \in \overline{N-1} \times \mathbb{R}$ . The periodic  $\lambda_{k,n}^\pm$  and anti-periodic eigenvalues  $\mu_{k,n}^\pm$ ,  $n \geq 0$  satisfy (1.36)- (1.38) and  $\lambda_{k,n}^\pm, \mu_{k,n}^\pm \in \sigma_{k,n}(a)$ .*

*iii) Let  $a \rightarrow \tilde{a}_{k,m} = \frac{\pi}{2} - \frac{\pi k}{N} + \pi m$  for some  $(k, m) \in \overline{N-1} \times \mathbb{Z}$ . Then each band  $\sigma_{k,n}(a) \rightarrow \tilde{\sigma}_n = \{\tilde{\lambda}_n\}$  and  $\tilde{\sigma}_n$  is a flat band for  $H_k(\tilde{a}_{k,m})$  and*

$$r_{k,n-1}^+(a), r_{k,n}^-(a) = \tilde{\lambda}_n + \frac{c_0 + O(c_0^2)}{F'(\tilde{\lambda}_n)} \quad \text{as } a \rightarrow \tilde{a}_{k,m}. \quad (1.46)$$

Note that in the matrix case (see [BBK]) the resonances in general have non-zero imaginary part. The fact that all our resonances are real is a peculiarity of the high symmetry of a zigzag periodic graph.

The spectrum of the operator  $H = H(a)$ ,  $a \in \mathbb{R}$  consists of an absolutely continuous part (spectral band  $S_n(a)$ ,  $n \geq 1$  separated by gaps  $G_n(a)$ ,  $n \geq 1$ ) plus an infinite number of eigenvalues with infinite multiplicity, and we will show the following identities

$$\sigma(H(a)) = \sigma_{ac}(H(a)) \cup \sigma_\infty(H(a)), \quad (1.47)$$

$$\sigma_{ac}(H(a)) = \cup_{n \geq 1} S_n(a), \quad S_n(a) = [E_{n-1}^+(a), E_n^-(a)], \quad G_n(a) = (E_n^-(a), E_n^+(a)), \quad (1.48)$$

where  $S_n(a), G_n(a)$  are given by (1.53), (1.54).

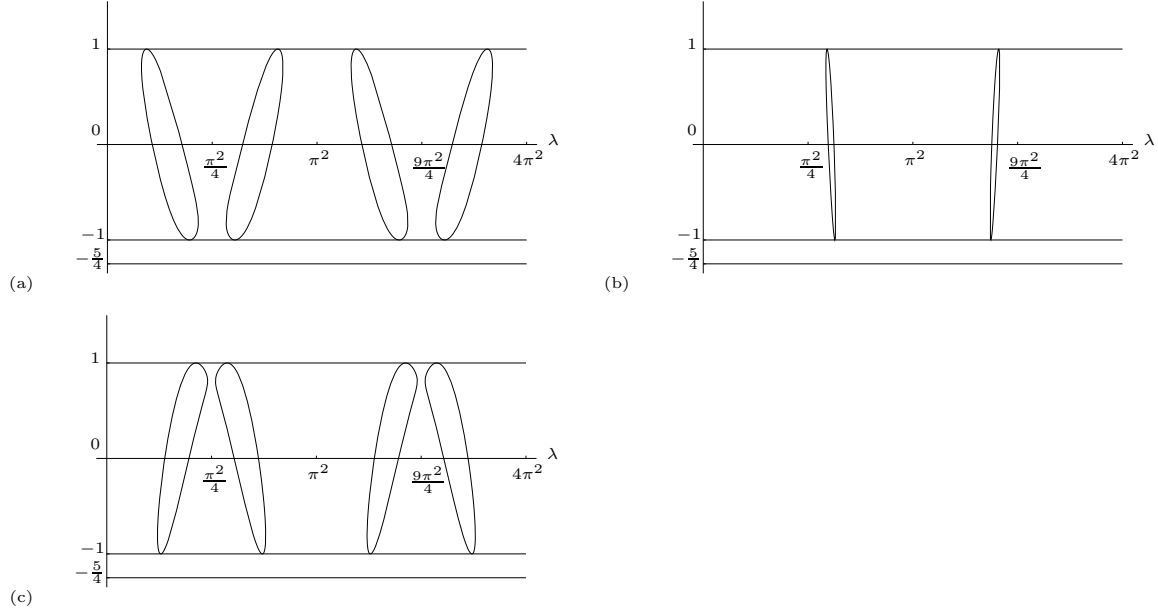

Figure 5: The function  $F_{1,\pm}(\lambda, a)$  for (a)  $a = 0$ ; (b)  $a = \frac{\pi}{3}$ ; (c)  $a = \frac{\pi}{2}$ .

**Theorem 1.7.** *i) The following identities hold*

$$\sigma(H(a + \frac{\pi}{N})) = \sigma(H(a)), \quad a \in \mathbb{R}. \quad (1.49)$$

*ii) Let  $a \in (0, \frac{\pi}{N})$ . Then all gaps  $G_n(a) = (E_n^-(a), E_n^+(a))$  for even  $n \geq 2$  satisfy*

$$G_n(0) \subset G_n(a) \subset G_n(a'), \quad \text{if } 0 < a < a' < \frac{\pi}{N}, \quad (1.50)$$

$$F(E_n^\pm(a)) = c_+ - 1 + c_+^2, \quad c_+ = \cos a_+, \quad a_+ = \max\{a, \frac{\pi}{N} - a\}. \quad (1.51)$$

*In particular, if  $a_+ = a$ , then  $E_n^\pm(a)$  are periodic eigenvalues. If  $a_+ = \frac{\pi}{N} - a$ , then  $E_n^\pm(a)$  are resonances. Moreover,*

$$E_n^\pm(a) = (\frac{\pi n}{2} \pm \phi_0)^2 + q_0 + \frac{o(1)}{n}, \quad \phi_0 = \frac{1}{2} \arccos \frac{1 + 8(c_+ - 1 + c_+^2)}{9} \in [0, \frac{\pi}{2}]. \quad (1.52)$$

*iii) Let  $a \in (0, \frac{\pi}{N})$  and  $n \geq 1$  be odd. Let  $\frac{jN}{3} = k_j + \tilde{k}_j, \tilde{k}_j \in [0, 1), j = 1, 2$ , for some integer  $k_j \geq 0$ .*

*If  $a \in \tilde{A} = \{\tilde{k}_1, \tilde{k}_2\}$ , then each gap  $|G_n(a)| \geq 0$  and  $|G_n(a)| \rightarrow 0$  as  $n \rightarrow \infty$ .*

*If  $a \notin \tilde{A}$ , then each gap  $|G_n(a)| > 0$  and  $|G_n(a)| \rightarrow \infty$  as  $n \rightarrow \infty$ .*

*iv) There exists  $\varepsilon > 0$  such that: each gap  $G_n(a) \subset G_n(a')$  and each spectral bands  $S_n(a') \subset S_n(a)$  for all  $0 \leq a < a' \leq \varepsilon, n \geq 1$ .*

*iv) Let  $a \in (0, \frac{\pi}{N})$  for even  $N$  and  $a \in (0, \frac{\pi}{N}) \setminus \{\frac{\pi}{2N}\}$  for odd  $N$ . Then*

$$S_n(a) = \cup_{k=1}^N \sigma_{k,n}(a), \quad S_n^N(a) = \cap_{k=1}^N \sigma_{k,n} \neq \emptyset, \quad \text{all } n \geq 1, \quad (1.53)$$

v) Let  $a_m = \frac{\pi}{2} - \frac{\pi m}{N} \in [0, \frac{\pi}{N}]$  for some  $m \in \overline{N}$ . Then

$$S_n(a_m) = \cup_{k=1, k \neq m}^N \sigma_{k,n}(a_m), \quad \cap_{k=1, k \neq m}^N \sigma_{k,n} \neq \emptyset, \quad \text{all } n \geq 1, \quad (1.54)$$

and

$$S_n^N(a) \rightarrow \tilde{\sigma}_n = \{\tilde{\lambda}_n\} \quad \text{as } a \rightarrow a_m. \quad (1.55)$$

We present the plan of the paper. In Sect. 2 we construct the fundamental solutions  $\Theta, \Phi$  and describe the basic properties of the monodromy operator. In Sect. 3 we prove Theorem 1.2 about the eigenfunctions. In Sect. 4 we prove the basic properties of the Lyapunov functions  $F_k$  for the case  $a = 0$ . These functions are important to study the functions  $F_k, k \in \mathbb{Z}_N, a \in \mathbb{R}$ . In Sect. 5 we prove the basic properties of the Lyapunov function  $F_k, k \in \overline{N}$ . In Sect.6 we shortly recall the results about the direct integral.

## 2 Fundamental solutions

In this Section we study the fundamental solutions for the operator  $H_k, k \in \mathbb{Z}_N$ .

**Lemma 2.1.** *The identities (1.6) hold and  $R_N = \frac{\sqrt{3}}{4 \sin \frac{\pi}{2N}}$  is the radius of the tube  $\Gamma^{(N)}$ .*

**Proof.** Identity  $\mathcal{A} = \frac{B}{2}[e_0, r_\omega^0 + te_\omega], e_0 = (0, 0, 1) \in \mathbb{R}^3$  yields

$$a_\omega(t) = \frac{B}{2}([e_0, r_\omega^0 + te_\omega], e_\omega) = \frac{B}{2}([e_0, r_\omega^0], e_\omega) = a_\omega(0) = a_\omega, \quad \text{any } t \in [0, 1]. \quad (2.1)$$

The definition  $e_{n,0,k} = e_0$  gives  $a_{n,0,k} = 0$ . Consider other cases. Let  $\omega = (0, 1, 1)$ . Using the simple properties of the tube  $\Gamma^{(N)}$  (see Fig. 1) we deduce that the vector  $e_\omega$  has the form  $e_\omega = (e'_\omega, e''_\omega, \frac{1}{2}) \in \mathbb{R}^3$ . We will determine  $e'_\omega, e''_\omega$ .

The vectors  $e_\alpha, \alpha = (0, 1, k), k \in \mathbb{Z}_N$  joint the points  $r_\alpha^0, r_\alpha^1$ . The points  $r_\alpha^0, \alpha = (0, 1, k), k \in \mathbb{Z}_N$  belong to the vertices of the N-rectangle. The points  $r_\alpha^1, \alpha = (0, 1, k), k \in \mathbb{Z}_N$  belong to vertices of the another N-rectangle, turned by the angle  $\frac{\pi}{2N}$ . Then there exists a coordinate system in  $\mathbb{R}^3$  such that the vector

$$e_\alpha = (R_N \cos \phi, R_N \sin \phi, \frac{1}{2}) - (R_N, 0, 0) \in \mathbb{R}^3, \quad \phi = \frac{\pi}{N}.$$

Thus the identity  $|e_\alpha| = 1$  yields

$$1 = |e_\alpha|^2 = R_N^2(1 - \cos \phi)^2 + R_N^2 \sin^2 \phi + \frac{1}{4},$$

which yields  $R_N = \frac{\sqrt{3}}{4 \sin \frac{\phi}{2}}$ . We rewrite the vector  $r_\alpha^0$  in the form  $r_\alpha^0 = Ce_0 + r_1$  for some  $C \in \mathbb{R}$ , where  $r_1 \perp e_0$  and  $r_1 = R_N(1, 0, 0)$ . Then using (2.1) we obtain

$$a_\alpha = \frac{B}{2}([e_0, r_\alpha^0], e_\alpha) = \frac{B}{2}([e_0, r_1], e_\alpha) = \frac{B}{2} \det \begin{pmatrix} R_N(\cos \phi - 1) & R_N \sin \phi & \frac{1}{2} \\ 0 & 0 & 1 \\ 1 & 0 & 0 \end{pmatrix} = \frac{BR_N}{2} \sin \phi,$$

which yields  $a_\alpha = \frac{B\sqrt{3}}{4} \cos \frac{\pi}{2N}$ . The proof of other cases are similar. ■

Let  $H_{0k}$  be the operator  $H_k$  at  $q = 0$ . Recall that  $H_{0k}, \mathfrak{D}(H_{0k}) = W^2(\Gamma^{(1)})$  is self-adjoint [Ca1]. Let  $\|f\|^2 = \int_{\Gamma^{(1)}} |f(x)|^2 dx$  and let  $\|f_\omega\|_0^2 = \int_0^1 |f_\omega(t)|^2 dt$  for  $f_\omega \in L^2(\Gamma_\omega), \omega \in \mathcal{Z}$ . Repeating the standard arguments from [KL] for the case  $a = 0$  we obtain

$$\|qf\|^2 \leq \varepsilon \|H_{0k}f\|^2 + \left( \frac{\|q\|_0^2}{\varepsilon} + 2\|q\|_0 \right) \|f\|^2, \quad \text{all } f \in \mathfrak{D}(H_{0k}), \quad (2.2)$$

for any constant  $0 < \varepsilon < 1$ . Then by the Kato-Rellich Theorem (see 162 p. [ReS1]),  $H_k = H_{0k} + q$  is self-adjoint on  $\mathfrak{D}(H_{0k})$  and essentially self-adjoint on any core of  $H_{0k}$ .

**Proof of Theorem 1.1.** i) We need a modification. We define the unitary operator  $\mathcal{U}$  and a modified operator  $H$  by

$$(\mathcal{U}f)_\omega = e^{ita_\omega} f_\omega, \omega \in \mathcal{Z}, \quad H = \mathcal{U}^* \mathcal{H} \mathcal{U} \quad (2.3)$$

in  $L^2(\Gamma^{(N)})$ . Then acting on the edge  $\Gamma_\omega$ ,  $H$  is the ordinary differential operator given by

$$(Hf)_\omega = -f''_\omega + qf_\omega, \quad f_\omega, f''_\omega \in L^2(\Gamma_\omega), \quad \omega \in \mathcal{Z}, \quad (2.4)$$

where  $f \in \mathfrak{D}(H)$  (see below) satisfies the Sturm-Liouville type of boundary conditions

**The Modified Kirchhoff Boundary Conditions.** Each  $f \in \mathfrak{D}(H)$  is continuous on  $\Gamma^{(N)} \setminus V^{(N)}$  and satisfies

$$f_{\omega_3}(1) = f_\omega(0) = e^{ia_\omega} f_{\omega_4}(1), \quad f_{\omega_1}(0) = e^{ia_\omega} f_\omega(1) = f_{\omega_2}(0), \quad (2.5)$$

$$-f'_{\omega_3}(1) + f'_\omega(0) - e^{ia_\omega} f'_{\omega_4}(1) = 0, \quad f'_{\omega_1}(0) - e^{ia_\omega} f'_\omega(1) + f'_{\omega_2}(0) = 0, \quad (2.6)$$

all  $\omega_1 = (n+1, 0, k), \omega = (n, 1, k), \omega_2 = (n, 2, k), \omega_3 = (n, 0, k), \omega_4 = (n, 2, k-1) \in \mathcal{Z}$ .

We will obtain another representation of  $H$ . The function  $f$  in (2.4)-(2.6) is a vector function  $f = (f_\omega), \omega = (n, j, k) \in \mathcal{Z}$ . We define a vector-valued function  $f_{n,j} = (f_{n,j,k})_k^N$ , where each  $f_{n,j}, (n, j) \in \mathbb{Z} \times \mathbb{Z}_3$  is an  $\mathbb{C}^N$ -vector, which satisfies the equation

$$-f''_{n,j} + qf_{n,j} = \lambda f_{n,j}, \quad (2.7)$$

and the Kirchhoff boundary conditions (which follow from (2.5)-(2.6))

$$f_{n,0}(1) = f_{n,1}(0) = e^{ia} \mathcal{S} f_{n,2}(1), \quad f_{n+1,0}(0) = e^{ia} f_{n,1}(1) = f_{n,2}(0), \quad (2.8)$$

$$-f'_{n,0}(1) + f'_{n,1}(0) - e^{ia} \mathcal{S} f'_{n,2}(1) = 0, \quad f'_{n+1,0}(0) - e^{ia} f'_{n,1}(1) + f'_{n,2}(0) = 0, \quad (2.9)$$

for all  $n \in \mathbb{Z}$ . Recall that the constant  $a \in \mathbb{R}$  is given by (1.6) and the unitary operator  $\mathcal{S}$  in  $\mathbb{C}^N$  is defined by

$$\mathcal{S}(h_1, h_2, \dots, h_N)^\top = (h_N, h_1, \dots, h_{N-1})^\top, \quad h = (h_n)_1^N \in \mathbb{C}^N.$$

We need more detail representation of  $H$ . We have

$$\mathcal{S} = \sum_1^N s^k \mathcal{P}_k, \quad \mathcal{P}_k h = e_k(h, e_k), \quad e_k = \frac{1}{N^{\frac{1}{2}}}(1, s^{-k}, s^{-2k}, \dots, s^{-kN+k}), h \in \mathbb{C}^N, \quad (2.10)$$

where  $e_k$  is an eigenvector of  $\mathcal{S}$  and  $\mathcal{S}e_k = s^k e_k$  and recall  $s = e^{i\frac{2\pi}{N}}$ . The operators  $\mathcal{S}$  and  $H$  commute, then  $H = \sum_1^N \oplus H_k$ ,  $H_k = H\mathcal{P}_k$ . Using (2.8) and (2.9) we deduce that the operator  $H_k$  on the graph  $\Gamma^{(1)}$  acts in the Hilbert space  $L^2(\Gamma^{(1)})$ . Then acting on the edge  $\Gamma_\omega$ ,  $H_k$  is the ordinary differential operator given by

$$(H_k f)_{n,j} = -f''_{n,j} + q(t)f_{n,j}, \quad f_{n,j} : [0, 1] \rightarrow \mathbb{C} \quad (2.11)$$

on the vector functions  $f = (f_{n,j})$ ,  $(n, j) \in \mathbb{Z} \times \mathbb{Z}_3$ , which satisfy the boundary conditions

$$f_{n,0}(1) = f_{n,1}(0) = e^{ia} s^k f_{n,2}(1), \quad f_{n+1,0}(0) = e^{ia} f_{n,1}(1) = f_{n,2}(0), \quad s = e^{i\frac{2\pi}{N}}, \quad (2.12)$$

$$-f'_{n,0}(1) + f'_{n,1}(0) - e^{ia} s^k f'_{n,2}(1) = 0, \quad f'_{n+1,0}(0) - e^{ia} f'_{n,1}(1) + f'_{n,2}(0) = 0. \quad (2.13)$$

ii) For fixed  $k \in \mathbb{Z}_N$  we consider the system

$$-f'' + qf = \lambda f, \quad \lambda \in \mathbb{C}, \quad f \in C^1(\Gamma^{(1)} \setminus V^{(1)}) \text{ and } f \text{ satisfies (2.12) and (2.13)}. \quad (2.14)$$

Suppose  $f$  satisfies (2.14) and we know  $f_{0,0}(0)$  and  $f'_{0,0}(0)$ . Here we will determine the solution of this system.

Any solution  $f$  of the equation  $-f'' + qf = \lambda f$  satisfies

$$f(t) = \vartheta_t f(0) + \frac{\varphi_t}{\varphi_1} (f(1) - \vartheta_1 f(0)), \quad t \in [0, 1], \quad (2.15)$$

$$f'(0) = \frac{f(1) - \vartheta_1 f(0)}{\varphi_1}, \quad f'(1) = \frac{\varphi'_1 f(1) - f(0)}{\varphi_1}, \quad (2.16)$$

where  $\vartheta_t = \vartheta(1, \lambda)$ ,  $\varphi_t = \varphi(1, \lambda)$ , ... Substituting (2.16) into the first Eq. in (2.13) at  $n = 0$ , we obtain

$$-\varphi_1 f'_{0,0}(1) + (f_{0,1}(1) - \vartheta_1 f_{0,1}(0)) - e^{ia} s^k (\varphi'_1 f_{0,2}(1) - f_{0,2}(0)) = 0.$$

Using (2.12), we obtain

$$\varphi_1 f'_{0,0}(1) + (a^{-ia} f_{1,0}(0) - \vartheta_1 f_{0,0}(1)) - e^{ia} s^k (\varphi'_1 e^{-ia} s^{-k} f_{0,0}(1) - f_{1,0}(0)) = 0, \quad (2.17)$$

which implies

$$-\varphi_1 f'_{0,0}(1) + u f_{1,0}(0) - 2\Delta f_{0,0}(1) = 0, \quad u = a^{-ia} + e^{ia} s^k = 2c_k s^{\frac{k}{2}}. \quad (2.18)$$

If we assume that  $c_k \neq 0$ , then we obtain **the first basic identity**

$$f_{1,0}(0) = \frac{\varphi_1}{u} f'_{0,0}(1) + \frac{2\Delta}{u} f_{0,0}(1), \quad u = 2c_k s^{\frac{k}{2}}, \quad c_k = \cos\left(a + \frac{\pi k}{N}\right). \quad (2.19)$$

Substituting (2.16) into the second Eq. in (2.13) at  $n = 0$ , we get

$$\varphi_1 f'_{1,0}(0) - e^{ia}(\varphi'_1 f_{0,1}(1) - f_{0,1}(0)) + (f_{0,2}(1) - \vartheta_1 f_{0,2}(0)) = 0.$$

Using (2.12), we obtain

$$\varphi_1 f'_{1,0}(0) - e^{ia}(\varphi'_1 e^{-ia} f_{1,0}(0) - f_{0,0}(1)) + (e^{-ia} s^{-k} f_{0,0}(1) - \vartheta_1 f_{1,0}(0)) = 0, \quad (2.20)$$

which yields

$$\varphi_1 f'_{1,0}(0) = 2\Delta f_{1,0}(0) - u_2 f_{0,0}(1), \quad u_2 = e^{-ia} s^{-k} + e^{ia} = 2c_k s^{-\frac{k}{2}}. \quad (2.21)$$

Then substituting (2.19) into (2.21), we obtain **the second basic identity**

$$f'_{1,0}(0) = \frac{4(\Delta^2 - c_k^2)}{u\varphi_1} f_{0,0}(1) + \frac{2\Delta}{u} f'_{0,0}(1), \quad u = 2c_k s^{\frac{k}{2}}. \quad (2.22)$$

Substituting consequently  $f = \Theta_k$  and  $f = \Phi_k$  into (2.19) and into (2.22), and after this  $\Theta_{k,\omega}(0, \lambda)$ ,  $\Theta'_{k,\omega}(0, \lambda)$ , .. into  $\mathcal{M}_k(\lambda) = \begin{pmatrix} \Theta_{k,\alpha}(0, \lambda) & \Phi_{k,\alpha}(0, \lambda) \\ \Theta'_{k,\alpha}(0, \lambda) & \Phi'_{k,\alpha}(0, \lambda) \end{pmatrix}$ ,  $\alpha = (1, 0)$ , we obtain (1.17).

Using (1.17) we obtain  $\det \mathcal{T}_k = \frac{s^{-k} 4c_k^2}{4c_k^2} = s^{-k}$ ,  $\det \mathcal{M}_k = \det \mathcal{T}_k M = s^{-k}$ , since  $\det M = 1$ .

Moreover, using  $\mathcal{R}\mathcal{M}\mathcal{R}^{-1} = \begin{pmatrix} \vartheta_1 & 1 \\ \varphi_1 \vartheta'_1 & \varphi'_1 \end{pmatrix}$ ,  $\mathcal{R} = \begin{pmatrix} 1 & 0 \\ 0 & \varphi_1 \end{pmatrix}$ , we obtain

$$\begin{aligned} \text{Tr } \mathcal{M}_k &= \text{Tr } \mathcal{R}^{-1} \mathcal{T}_k \mathcal{R} \mathcal{M} = \frac{2s^{-\frac{k}{2}}}{c_k} \text{Tr} \begin{pmatrix} 2\Delta & 1 \\ 4\Delta^2 - 4c_k^2 & 2\Delta \end{pmatrix} \begin{pmatrix} \vartheta_1 & 1 \\ \varphi_1 \vartheta'_1 & \varphi'_1 \end{pmatrix} \\ &= \frac{2s^{-\frac{k}{2}}}{c_k} \left( 2\Delta \vartheta_1 + \varphi_1 \vartheta'_1 + 4(\Delta^2 - c_k^2) + 2\Delta \varphi'_1 \right) = \frac{2s^{-\frac{k}{2}}}{c_k} \left( 2\Delta^2 + \frac{\varphi_1 \vartheta'_1}{4} - c_k^2 \right) = \frac{2s^{-\frac{k}{2}}(F + s_k^2)}{c_k} \end{aligned}$$

which gives (1.18). ■

### 3 Eigenfunctions of $H$ , Proof of Theorem 1.2, 1.3

**Proof of Theorem 1.2.** Let  $\varphi_1 = \varphi(1, \lambda)$ ,  $\varphi'_1 = \varphi'(1, \lambda)$ , ..

i) Here we use arguments from [KL]. Let  $H_k \psi = \lambda \psi$  for some eigenfunction  $\psi$  and some  $\lambda \in \sigma_D$ . For each  $\psi_\omega, \omega = (n, j) \in \mathbb{Z} \times \mathbb{Z}_3$ , we have  $\psi_\omega(t) = \psi_\omega(0) + \int_0^t \psi'_\omega(s) ds$ ,  $t \in [0, 1]$ . Then  $|\psi_\omega(0)| \leq |\psi_\omega(x)| + \int_0^1 |\psi'_\omega(t)| dt$  and integrating over  $x \in [0, 1]$ , using the Hölder inequality, we obtain

$$|\psi_\omega(0)| \leq \int_0^1 (|\psi_\omega(t)| + |\psi'_\omega(t)|) dt \leq \|\psi_\omega\|_0 + \|\psi'_\omega\|_0 = o(1), \quad \text{as } n \rightarrow \pm\infty, \quad (3.1)$$

since  $\psi \in \mathcal{H}_k(\lambda)$ . Furthermore, each restriction  $\psi_\omega$  has the form  $\psi_\omega(t) = a_\omega \vartheta(t, \lambda) + b_\omega \varphi(t, \lambda), t \in [0, 1]$  for some constants  $a_\omega, b_\omega$ , which implies  $\psi_\omega(1) = \psi_\omega(0)\vartheta_1$ . The Kirchhoff conditions give  $\psi_{n+1,0}(0) = \psi_{n,1}(1) = \vartheta_1 \psi_{n,1}(0) = \vartheta_1 \psi_{n,0}(1) = \vartheta_1^2 \psi_{n,0}(0)$ , which yields

$$\psi_{0,0} = \vartheta_1^{2n} \psi_{-n,0}(0), \quad \text{all } n \in \mathbb{Z}. \quad (3.2)$$

Let  $|\vartheta_1| \leq 1$ , the proof for the case  $|\vartheta_1| > 1$  is similar. Then (3.2), (3.1) imply  $\psi_{0,0} = \vartheta_1^{2n} \psi_{-n,0}(0) = o(1)$  as  $n \rightarrow +\infty$ . Thus (3.2) gives  $\psi_{n,0}(1) = 0$  for all  $n \in \mathbb{Z}$ . Finally,  $\psi$  vanishes on all vertexes of  $\Gamma^{(1)}$ , since the set of all ends of vertexes  $\Gamma_{n,0}, n \in \mathbb{Z}$  coincides with the vertex set of  $\Gamma^{(1)}$ .

ii) Let  $A = 1/\eta, \eta = 1 - e^{i2a} s^k \varphi_1'^2$ . We will construct the eigenfunction  $\psi^0$ . Define a function  $\phi$  by:  $\phi_{n,j} = 0$  for all  $n \neq 0, -1$  and any  $j \in \mathbb{Z}_3$  and  $\phi_{0,0} = \varphi_t, \phi_{0,j} = C_1 \varphi_t, \phi_{0,j} = C_2 \varphi_t, t \in [0, 1]$ . Then the Kirchhoff Conditions (2.13) at  $n = 0$  give

$$-\varphi_1' + C_1 - e^{ia} s^k C_2 \varphi_1' = 0, \quad -e^{ia} C_1 \varphi_1' + C_2 = 0,$$

which yields  $C_1 = A\varphi_1', C_2 = Ae^{ia} \varphi_1'^2$ .

Let  $\phi_{-1,0} = 0, \phi_{-1,1} = C_3 \varphi_t, \phi_{-1,2} = C_4 \varphi_t, t \in [0, 1]$ . Then the Kirchhoff Conditions (2.13) at  $n = -1$  give

$$1 - C_3 e^{ia} \varphi_1' + C_4 = 0, \quad C_3 - e^{ia} s^k C_4 \varphi_1' = 0,$$

which yields  $C_4 = -A, C_3 = -Ae^{ia} s^k \varphi_1'$ .

Let  $\|f\|^2 = \int_{\Gamma^{(1)}} f^2(x) dx$ . Using (1.19)-(1.20), we deduce that  $\psi^{(0)}$  is an eigenfunction of  $H_k$  with the norm given by

$$\int_{\Gamma} |\psi^{(0)}(x)|^2 dx = C \int_0^1 |\varphi(x, \lambda)|^2 dx, \quad C = |\eta|^2 + 1 + \varphi_1'^2 + 2\varphi_1'^4.$$

The operator  $H_k$  is 1-periodic, then each  $\psi^{(n)}, n \in \mathbb{Z}$  is an eigenfunction. We will show that the sequence  $\psi^{(n)}, n \in \mathbb{Z}$  forms a basis for  $\mathcal{H}_k(\lambda)$ . The functions  $\psi^{(n)}$  are linearly independent, since  $\Gamma_{n,0} \subset \text{supp } \psi^{(n)} \setminus \text{supp } \psi^{(m)}$  for every  $n \neq m$ .

For any  $f \in \mathcal{H}_k(\lambda)$  we will show the identity (1.21), i.e.,

$$f = \widehat{f}, \quad \widehat{f} = \sum_{n \in \mathbb{Z}} \widehat{f}_n \psi^{(n)}, \quad \widehat{f}_n = \frac{f'_{n,0}(0)}{\eta}. \quad (3.3)$$

From (3.3) and  $\lambda \in \sigma_D$  we deduce that

$$\widehat{f}|_{\Gamma_{n,0}} = f|_{\Gamma_{n,0}} = \widehat{f}_n \varphi \quad \text{all } n \in \mathbb{Z}. \quad (3.4)$$

We will prove the following simple properties of  $\widehat{f}$ :

$$\widehat{f} \in W_{loc}^2(\Gamma^{(1)}), \quad \sum |\widehat{f}_n|^2 < \infty, \quad \widehat{f} \in L^2(\Gamma^{(1)}). \quad (3.5)$$

Each function  $\psi^{(n)} \in W_{loc}^2(\Gamma^{(1)}), n \in \mathbb{Z}$ , then we get  $\widehat{f} \in W_{loc}^2(\Gamma^{(1)})$ .



Let  $\Gamma^0 = \cup_{n \in \mathbb{Z}} \Gamma_{n,0}$ . Using the identity (3.4), we obtain

$$\int_{\Gamma^0} |f(x)|^2 dx = \int_{\Gamma^0} |\widehat{f}(x)|^2 dx = \sum_{n \in \mathbb{Z}} |\widehat{f}_n|^2 \int_{\Gamma_{n,0}} |\psi^{(n)}(x)|^2 dx = \|\psi^{(0)}\|^2 \sum_{n \in \mathbb{Z}} |\widehat{f}_n|^2$$

which yields  $\{\widehat{f}_n\} \in \ell^2$  and  $\sum_{n \in \mathbb{Z}} |\widehat{f}_n|^2 \leq \|f\|^2$ . We will show  $\|\widehat{f}\|^2 = \int_{\Gamma^{(1)}} |f(x)|^2 dx < \infty$ . Using  $\psi^{(n)}\psi^{(m)} = 0$  for  $|n - s| > 1$  we have

$$\begin{aligned} \bar{f}f &= \sum_{n,m \in Y} \overline{\widehat{f}_n \widehat{f}_m} \overline{\psi^{(n)}\psi^{(m)}}, \quad Y = \{n, m \in \mathbb{Z} : |n - s| \leq 1\}, \\ \|f\|^2 &= \int_{\Gamma} \bar{f}(x)f(x) dx = \sum_{n,m \in Y} \overline{\widehat{f}_n \widehat{f}_m} (\psi^{(n)}, \psi^{(m)}) \leq \sum_{n,m \in Y} |\widehat{f}_n| |\widehat{f}_m| \|\psi^{(n)}\| \|\psi^{(m)}\| \\ &= \|\psi^{(0)}\|^2 \sum_{n,m \in Y} |\widehat{f}_n| |\widehat{f}_m| \leq 3 \|\psi^{(0)}\|^2 \sum_{n \in \mathbb{Z}} |\widehat{f}_n|^2 \end{aligned} \quad (3.6)$$

which yields  $\|\widehat{f}\|^2 \leq 3 \|\psi^{(0)}\|^2 \sum_{n \in \mathbb{Z}} |\widehat{f}_n|^2$ . We have proved the properties (3.5).

Consider the function  $u = f - \widehat{f}$ . The properties (3.5) and (3.3) give

$$u \in W_{loc}^2(\Gamma), \quad u \in L^2(\Gamma), \quad u|_{\Gamma^0} = 0.$$

Define the function  $u_0 = u|_{\Gamma_{0,0}}$  and  $u_0|_{\Gamma \setminus \Gamma_{0,0}} = 0$ . We deduce that the function  $u_0$  is an eigenfunction and has a compact support  $\Gamma_{0,0}$ . But the Kirchhoff boundary conditions (1.9)-(1.10) yields  $u_0 = 0$ .

iii) Let  $e^{i2a} s^k \varphi_1'^2 = 1$ . Then  $e^{i2a} s^k = 1 = \varphi_1'^2$ . Let  $\phi_{n,0} = 0, \phi_{0,1} = \varphi_t, \phi_{0,2} = C\varphi_t$ . Then the Kirchhoff conditions (1.10) at  $n = 0$  yield:  $1 - e^{ia} s^k C \varphi_1' = 0, -e^{ia} \varphi_1' + C = 0$ , and thus  $C = e^{ia} \varphi_1'$

The operator  $H_k$  is periodic, then each  $\psi^{(n)}, n \in \mathbb{Z}$  is an eigenfunction. We will show that the sequence  $\psi^{(n)}, n \in \mathbb{Z}$  forms a basis for  $\mathcal{H}_k(\lambda)$ . The functions  $\psi^{(n)}$  are linearly independent, since  $\text{supp } \psi^{(n)} \cap \text{supp } \psi^{(m)} = \emptyset$  for all  $n \neq m$ .

For any  $f \in \mathcal{H}_k(\lambda)$  we will show the identity (1.20), i.e.,

$$f = \widehat{f}, \quad \widehat{f} = \sum_{n \in \mathbb{Z}} \widehat{f}_n \psi^{(n)}, \quad \widehat{f}_n = f'_{n,1}(0). \quad (3.7)$$

From (3.7) and  $\lambda \in \sigma_D$  we deduce that

$$\widehat{f}|_{\Gamma_{n,1}} = f|_{\Gamma_{n,1}} = \widehat{f}_n \varphi \quad \text{all } n \in \mathbb{Z}. \quad (3.8)$$

Using the arguments from ii) we obtain the following properties of  $\widehat{f}$ :

$$\widehat{f} \in W_{loc}^2(\Gamma^{(1)}), \quad \sum |\widehat{f}_n|^2 < \infty, \quad \widehat{f} \in L^2(\Gamma^{(1)}). \quad (3.9)$$

Consider the function  $u = f - \widehat{f}$ . The properties (3.9) and (3.7) give

$$u \in W_{loc}^2(\Gamma^{(1)}), \quad u \in L^2(\Gamma^{(1)}), \quad u|_{\Gamma_{n,1}} = 0 \quad \text{all } n \in \mathbb{Z}. \quad (3.10)$$

The function  $u = 0$  at all vertices of  $\Gamma^{(1)}$  and then  $u_\alpha = C_\alpha \varphi_t$ ,  $\alpha = (n, j)$ ,  $n \in \mathbb{Z}$ ,  $j = 0, 2$ . Assume that  $C_{0,0} = C$ . Then the Kirchhoff boundary conditions (1.10) yields  $C_{n,0} = -C_{n,2} = -C$  and  $C_{n,0} = C_{n+1,0} = C$ , which give  $C = 0$  since  $u \in L^2(\Gamma^{(1)})$ . ■

**Proof of Theorem 1.3.** If  $c_k = 0$ , then by (6.1),  $\sigma(H_k(a)) = \sigma_\infty(H_k(a))$ . The case  $\lambda \in \sigma_D$  is described by Theorem 1.2.

Consider eigenfunctions  $-\phi'' + q\phi = \lambda\phi$  on  $\Gamma^{(1)}$  under the condition  $c_k = 0$ ,  $\lambda \notin \sigma_D$ . Then (2.18) and (2.21) give

$$\phi'_{n,0}(0) = \frac{2\Delta}{\varphi_1} \phi_{n,0}(0), \quad \phi'_{n,0}(1) = -\frac{2\Delta}{\varphi_1} \phi_{n,0}(1), \quad \text{all } n \in \mathbb{Z}, \quad (3.11)$$

which under the condition  $\phi_{0,0}(1) = 1$  yields

$$\phi_{0,0}(t) = \vartheta_t C_1 + \varphi_t C_2, \quad C_1 = \varphi'_1 + 2\Delta = f_{0,0}(0), \quad C_2 = -\vartheta'_1 - \frac{2\vartheta_1 \Delta}{\varphi_1} = f'_{0,0}(0). \quad (3.12)$$

Then the identities (3.12) imply

$$\frac{\phi'_{0,0}(0)}{\phi_{0,0}(0)} = -\frac{\vartheta'_1 + \frac{2\vartheta_1 \Delta}{\varphi_1}}{\varphi'_1 + 2\Delta} = \frac{2\Delta}{\varphi_1}, \quad (3.13)$$

and then

$$4\Delta^2 + 2\Delta(\varphi'_1 + \vartheta_1) + \varphi_1 \vartheta'_1 = 0, \quad 2\Delta^2 + \frac{\varphi_1 \vartheta'_1}{4} = 0. \quad (3.14)$$

Then only for  $\lambda \in \sigma_{AP}$  there exists a solution of  $-\phi'' + q\phi = \lambda\phi$ .

Consider an eigenfunction  $-\phi'' + q\phi = \lambda\phi$ ,  $\lambda \in \sigma_{AP}$ . Assume that  $\phi_{n,0} = 0$  for all  $n \neq 0$ . Then we get

$$1 = \phi_{0,0}(1) = \phi_{0,1}(0) = -e^{-ia} \phi_{0,2}(1), \quad \phi_{1,0}(0) = \phi_{0,1}(1) = \phi_{0,2}(0) = 0, \quad (3.15)$$

which yields

$$\phi_{0,0}(t) = \varphi_t C_1 + \vartheta_t C_2, \quad \phi_{0,1}(t) = \vartheta_t - \varphi_t \frac{\vartheta_1}{\varphi_1}, \quad \phi_{0,2}(t) = -\frac{\varphi_t}{\varphi_1} e^{ia}, \quad t \in [0, 1]. \quad (3.16)$$

The direct calculation shows that the Kirchhoff Boundary Conditions (1.10) hold.

Consider another boundary. The Kirchhoff Boundary Conditions (1.9) at  $n = -1$  give

$$\phi_{-1,0}(1) = 0 = \phi_{-1,1}(0) = \phi_{0,2}(1), \quad C_1 = \phi_{0,0}(0) = e^{ia} \phi_{-1,1}(0) = \phi_{-1,2}(0), \quad (3.17)$$

which yields

$$\phi_{-1,1}(t) = \frac{\varphi_t}{\varphi_1} e^{-ia} C_1, \quad \phi_{-1,2}(t) = (\vartheta_t - \varphi_t \frac{\vartheta_1}{\varphi_1}) C_1, \quad C_1 = \varphi'_1 + 2\Delta. \quad (3.18)$$

The direct calculation shows that the Kirchhoff Boundary Conditions (1.10) hold at  $n = -1$ .

The operator  $H_k$  is periodic, hence each  $\psi^{(n)}, n \in \mathbb{Z}$  is an eigenfunction. We will show that the sequence  $\psi^{(n)}, n \in \mathbb{Z}$  forms a basis for  $\mathcal{H}_k(\lambda)$ . The functions  $\psi^{(n)}$  are linearly independent, since  $\text{supp } \psi^{(n)} \setminus \text{supp } \psi^{(m)} = \Gamma_{n,0}$  for every  $n \neq m$ .

For any  $f \in \mathcal{H}_k(\lambda)$  we will show the identity (1.25), i.e.,

$$f = \widehat{f}, \quad \widehat{f} = \sum_{n \in \mathbb{Z}} \widehat{f}_n \phi^{(n)}, \quad \widehat{f}_n = \frac{f_{n,0}(0)}{C_2}. \quad (3.19)$$

The function  $f$  satisfies (3.11), since  $F(\lambda) = -1$ . From (3.11) and (3.12) we deduce that

$$f_{0,0}(t) = C(\vartheta_t C_1 + \varphi_t C_2) = C\phi_{0,0}(t), \quad C_1 = \varphi'_1 + 2\Delta, \quad C_2 = -\vartheta'_1 - \frac{2\vartheta_1 \Delta}{\varphi_1}, \quad (3.20)$$

which yields

$$\widehat{f}|_{\Gamma_{n,0}} = f|_{\Gamma_{n,0}} = \widehat{f}_n \phi^{(n)} \quad \text{all } n \in \mathbb{Z}. \quad (3.21)$$

Using the arguments from the proof of Theorem 1.2 we obtain the following properties of  $\widehat{f}$ :

$$\widehat{f} \in W_{loc}^2(\Gamma^{(1)}), \quad \sum |\widehat{f}_n|^2 < \infty, \quad \widehat{f} \in L^2(\Gamma^{(1)}). \quad (3.22)$$

Consider the function  $u = f - \widehat{f}$ . The properties (3.22) and (3.21) give

$$u \in W_{loc}^2(\Gamma^{(1)}), \quad u \in L^2(\Gamma^{(1)}), \quad u|_{\Gamma^0} = 0. \quad (3.23)$$

Define the function  $u_0 = u|_{\Gamma_{0,0}}$  and  $u_0|_{\Gamma \setminus \Gamma_{0,0}} = 0$ . We deduce that the function  $u_0$  is an eigenfunction and has a compact support  $\Gamma_{0,0}$ . But the Kirchhoff boundary conditions yields  $u_0 = 0$ . ■

## 4 The magnetic fields $B = 0$

In this section we consider only the case  $a = 0$ . Each integer  $N$  has the form  $N = 2m + 1$  or  $N = 2m + 2, m \geq 0$ . Recall that the results for the case  $a = 0$  and  $N$  odd was obtained in [KL].

Let  $\tau_{k,\pm}$  be the eigenvalues of  $\mathcal{M}_k, k \in \mathbb{Z}_N, k \neq \frac{N}{2}$ . Using (1.18) we deduce that

$$\tau_{k,-} \tau_{k,+} = s^{-k}, \quad \tau_{k,-} + \tau_{k,+} = \text{Tr } \mathcal{M}_k = s^{-k} \text{Tr } \mathcal{M}_{-k}, \quad \tau_{-k,+} = \tau_{k,-} s^k, \quad \tau_{-k,-} = \tau_{k,+} s^k. \quad (4.1)$$

If  $k = 0$  (or  $k = N$ ), then we can introduce the standard entire Lyapunov function

$$\Delta_0 = F = \frac{\text{Tr } \mathcal{M}_0}{2} = \frac{1}{2}(\tau_{0,+} + \frac{1}{\tau_{0,+}}) = \Delta^2 + \frac{\varphi_1 \vartheta'_1}{4} - 1.$$

If  $k \neq 0$ , then we define the Lyapunov functions  $\Delta_{k,\pm} = \frac{1}{2}(\tau_{k,\pm} + \frac{1}{\tau_{k,\pm}})$  (see [BBK],[CK]) and using (4.1) we get  $\Delta_{-k,\pm} = \Delta_{k,\pm}$ . Below we prove the following identities

$$\Delta_{k,\pm} = \frac{1}{2}(\tau_{k,\pm} + \frac{1}{\tau_{k,\pm}}) = \xi_k \pm \sqrt{\rho_k}, \quad \xi_k = \Delta_0 + s_k^2, \quad \rho_k = \frac{s_{0k}^2}{c_{0k}^2}(c_{0k}^2 - \xi_k^2), \quad k \neq \frac{N}{2}. \quad (4.2)$$

If  $q = 0$ , then we denote the corresponding functions by  $\Delta_k^0, \rho_k^0, \dots$ . In particular, we have

$$\Delta_0^0(\lambda) = \frac{9 \cos 2\sqrt{\lambda} - 1}{8}, \quad \xi_k^0 = \Delta_0^0 + s_{0k}^2, \quad \rho_k^0 = \frac{s_{0k}^2}{c_{0k}^2} (c_{0k}^2 - (\xi_k^0)^2). \quad (4.3)$$

Introduce the two sheeted Riemann surface  $\mathfrak{R}_k$  (of infinite genus) defined by  $\sqrt{\rho_k}$ . The functions  $\Delta_{k,\pm}, k \in \overline{m}$ , are the branches of  $\Delta_k = \xi_k + \sqrt{\rho_k}$  on the Riemann surface  $\mathcal{R}_k$ .

**Theorem 4.1.** *If  $a = 0, k = \frac{N}{2} \in \mathbb{Z}$ , then following identities hold:*

$$\sigma(H_k) = \sigma_\infty(H_k) = \sigma_D \cup \sigma_{AP}. \quad (4.4)$$

Moreover, if  $k = 0, 1, \dots, m, k \neq \frac{N}{2}$ , then

i) The Lyapunov functions  $\Delta_{k,\pm}, k \in \overline{m}$  satisfy (4.2).

ii) For each  $k = 0, 1, \dots, m$  the following identities hold:

$$\sigma(H_k) = \sigma_\infty(H_k) \cup \sigma_{ac}(H_k), \quad \sigma_\infty(H_k) = \sigma_D, \quad \sigma_{ac}(H_k) = \{\lambda \in \mathbb{R} : \Delta_k(\lambda) \in [-1, 1]\}. \quad (4.5)$$

iii) If  $\Delta_k(\lambda) \in (-1, 1)$  for some  $\lambda \in \mathbb{R}, k = 0, \dots, m$  and  $\lambda$  is not a branch point of  $\Delta_k$ , then  $\Delta'_k(\lambda) \neq 0$ .

**Remark.** 1) If we know  $\Delta_0$ , then we determine all  $\Delta_k, \rho_k, k = -m, \dots, m$  by (4.2). 2) If we know  $\rho_j$  for some  $j = 1, \dots, m$ , then we determine all  $\Delta_k, \rho_k, k = -m, \dots, m$  by (4.2).

**Proof.** The proof of  $k = \frac{N}{2} \in \mathbb{Z}$  follows from Theorem 1.3. The case  $k = 0, 1, \dots, m$  and  $N$  is odd was proved in [KL]. The proof for even  $N$  is similar. ■

Recall that a zero of  $\rho_k = R_k|_{a=0}, k \in \overline{m}$  is called a **resonance** of  $H_k$ .

Let  $D_0(\cdot, \tau) = \det(\mathcal{M}_0 - \tau I_2), \tau \in \mathbb{C}$  and let  $\lambda_{0,n}^\pm$  be the zeros of  $D_0(\lambda, 1)D_0(\lambda, -1)$ . The zeros of  $D_0(\lambda, 1)$  ( and  $D_0(\lambda, -1)$ ) counted with multiplicity are the periodic (anti-periodic) eigenvalues for the equation  $-y'' + qy = \lambda y$  on  $\Gamma$  with periodic (anti-periodic) boundary conditions. Below we will show that  $\lambda_{0,n}^\pm$  satisfy

$$\Delta_0(\lambda_{0,n}^\pm) = (-1)^n, \quad \lambda_{0,0}^+ < \lambda_{0,1}^- < \lambda_{0,1}^+ < \lambda_{0,2}^- \leq \lambda_{0,2}^+ < \lambda_{0,3}^- < \lambda_{0,3}^+ < \lambda_{0,4}^- \leq \lambda_{0,4}^+ < \dots \quad (4.6)$$

Introduce the gaps  $\gamma_{0,n} = (\lambda_{0,n}^-, \lambda_{0,n}^+), n \geq 1$ . We need the following results from [KL] about  $F = \Delta_0$ .

**Theorem 4.2.** *Let  $a = 0$ . Then the function  $F = \Delta_0$  is entire and has the following properties:*

i) The function  $\Delta'_0$  has only real simple zeros  $\lambda_{0,n}, n \geq 1$ , which are separated by the simple zeros  $\eta_{0,n}$  of  $\Delta_0$ :  $\eta_{0,1} < \lambda_{0,1} < \eta_{0,2} < \lambda_{0,2} < \eta_{0,3} < \dots$  and satisfy

$$\nu_n, \mu_n \in \gamma_{0,2n}, \quad \Delta_0(\lambda_{0,2n}) \geq 1, \quad \Delta_0(\lambda_{0,2n-1}) \leq -\frac{5}{4}, \quad \text{for any } n \geq 1. \quad (4.7)$$

ii) The periodic and anti-periodic eigenvalues  $\lambda_{0,n}^\pm, n \geq 0$  satisfy (4.6) and have asymptotics

$$\lambda_{0,2n+1}^\pm = \left(\pi \frac{2n+1}{2} \pm \phi\right)^2 + q_0 + \frac{o(1)}{n}, \quad \lambda_{2n}^\pm = (\pi n)^2 + q_0 \pm \left| |\hat{q}_n|^2 - \frac{\hat{q}_{sn}^2}{9} \right|^{\frac{1}{2}} + \frac{O(1)}{n}, \quad (4.8)$$

$\phi = \arcsin \frac{1}{3} \in [0, \frac{\pi}{2}]$  and  $\hat{q}_n = \int_0^1 q(t) e^{i2\pi nt} dt$ ,  $\hat{q}_{sn} = \text{Im } \hat{q}_n$ . Moreover,  $(-1)^n \Delta_0(\lambda) \geq 1$  for all  $\lambda \in [\lambda_{0,n}^-, \lambda_{0,n}^+]$  and  $\lambda_{0,n} \in [\lambda_{0,n}^-, \lambda_{0,n}^+]$ .  
iii)  $|\gamma_n| = |\mu_n - \nu_n|$  iff  $\gamma_n = \gamma_{0,2n}$ .  
iv)  $\gamma_{0,2n} \subset \gamma_n$  for all  $n \geq 1$ . Moreover, for fixed  $n \geq 1$  we have  $\gamma_{0,2n} = \emptyset$  iff  $\gamma_n = \emptyset$ .  
v)  $\Delta_0(\lambda_{1+2n}) = -\frac{5}{4}$  for all  $n \geq 0$  iff  $q \in L_{\text{even}}^2(0, 1)$ .

**Consider the case**  $k \in \overline{m}$ ,  $m \geq 1$ . Let  $D_k(\cdot, \tau) = \det(\mathcal{M}_k - \tau I_2)$ ,  $\tau \in \mathbb{C}$ . Let  $\lambda_{k,2n}^\pm$  and  $\lambda_{k,2n+1}^\pm$ ,  $n \geq 0$  be the zeros of  $D_k(\lambda, 1)$  and  $D_k(\lambda, -1)$ . Below we will show that the periodic eigenvalues  $\lambda_{k,2n}^\pm$  and the anti-periodic eigenvalues  $\lambda_{k,2n+1}^\pm$  satisfy the equations  $\Delta_k(\lambda_{k,n}^\pm) = (-1)^n$ . In Theorem 4.3 we show that  $\lambda_{k,n}^\pm$  satisfy the equations

$$\Delta_0(\lambda_{k,2n}^\pm) = \cos \frac{2\pi k}{N}, \quad \Delta_0(\lambda_{k,2n+1}^\pm) = -1, \quad k \in \overline{m}, \quad (4.9)$$

and labeling is given by: each  $\lambda_{k,n}^\pm$  is double and

$$\lambda_{0,0}^+ < \lambda_{1,0}^+ < \lambda_{2,0}^+ < \dots < \lambda_{m,0}^+ < \lambda_{0,1}^- < \lambda_{0,1}^+ < \lambda_{m,2}^- < \lambda_{m-1,2}^- < \dots < \lambda_{0,2}^- \leq \lambda_{0,2}^+ < \dots, \quad (4.10)$$

$$\lambda_{0,2n-1}^\pm = \lambda_{k,2n-1}^\pm, \quad (k, n) \in \overline{m} \times \mathbb{N}. \quad (4.11)$$

The periodic eigenvalues  $\lambda_{k,2n}^\pm$ ,  $k = 1, \dots, m$ ,  $n \geq 0$  (i.e.,  $\Delta_k(\lambda_{k,2n}^\pm) = 1$ ) satisfy

$$\lambda_{k,2n}^\pm = (\pi n \pm \phi_k)^2 + q_0 + \frac{o(1)}{n}, \quad \phi_k = \frac{1}{2} \arccos \frac{1 + 8c_{2k}}{9} \in [0, \frac{\pi}{2}] \quad \text{as } n \rightarrow \infty. \quad (4.12)$$

Let  $r_{k,n}^\pm$ ,  $k \in \overline{m}$ ,  $n \geq 0$  be the zeros of  $\rho_k$ . Note that there are no resonances for the cases  $N = 1, 2$ . Below we will show that these resonances satisfy the equations

$$\Delta_0(r_{k,2n}^\pm) = c_k - s_k^2, \quad \Delta_0(r_{k,2n+1}^\pm) = -c_k - s_k^2, \quad k \in \overline{m}, \quad (4.13)$$

they are real and labeling is given by

$$r_{k,0}^+ < r_{k,1}^- < r_{k,1}^+ < r_{k,2}^- < r_{k,2}^+ < \dots, \quad k \neq \frac{N}{3}, \quad (4.14)$$

$$r_{k,0}^+ < r_{k,1}^- \leq r_{k,1}^+ < r_{k,2}^- < r_{k,2}^+ < r_{k,3}^- \leq r_{k,3}^+ \dots, \quad k = \frac{N}{3}. \quad (4.15)$$

The resonances  $r_{k,n}^\pm$  (for  $k \in \overline{m}$ ,  $k \neq \frac{N}{3}$ ) satisfy

$$r_{k,n}^\pm = \left(\frac{\pi n}{2} \pm b_{k,n}\right)^2 + q_0 + o(n^{-1}), \quad \text{as } n \rightarrow \infty, \quad b_{k,2n} = \phi_{k,0}, \quad b_{k,2n+1} = \frac{\pi}{2} - \phi_{k,1}, \quad (4.16)$$

$\phi_{k,s} = \frac{1}{2} \arccos \frac{1 + (-1)^s 8c_k - 8s_k^2}{9} \in [0, \frac{\pi}{2}]$ ,  $s = 0, 1$ . We describe the spectral properties of  $H_k$ .

**Theorem 4.3.** *Let  $a = 0$ .*

*i) The periodic and anti-periodic eigenvalues  $\lambda_{k,n}^\pm, k \in \overline{m}, n \geq 0$  satisfy Eq. (4.9) and the relations (4.10)- (4.12).*

*ii) The resonances  $r_{k,n}^\pm, k \in \overline{m}, n \geq 0$  satisfy Eq. (4.13) and estimates (4.14)-(4.16).*

*iii) For  $n \geq 1, k \in \overline{m}$  the following identities are fulfilled:*

$$\sigma_{ac}(H) = \cup_{n \geq 1} S_n = \cup_0^N \sigma_k, \quad S_n = [E_{n-1}^+, E_n^-] = \cup_{k=0}^m \sigma_{k,n}, \quad \cap_{k=0}^m \sigma_{k,n} \neq \emptyset, \quad (4.17)$$

$$\sigma_{0,n} = [\lambda_{0,n-1}^+, \lambda_{0,n}^-], \quad \text{and} \quad \lambda_{k,n}^\pm \in \sigma_{k,n} = [r_{k,n-1}^+, r_{k,n}^-], \quad (4.18)$$

$$G_n = (E_n^-, E_n^+) = \cap_0^m \gamma_{k,n}, \quad G_{2n} = \gamma_{0,2n}. \quad (4.19)$$

*iv)  $G_{2n} = \emptyset$  iff  $\gamma_n = \emptyset$ . Moreover,  $G_{2n} = o(1)$  as  $n \rightarrow \infty$ .*

*v) If  $p = \frac{N}{3} \in \mathbb{Z}$ , then  $G_{2n+1} = \emptyset$  for all  $n \geq 0$  iff  $q \in L_{\text{even}}(0, 1)$ . Moreover, each odd gap  $G_n$  has the form  $G_n = (r_{p,n}^-, r_{p,n}^+)$  ( $n \geq 1$  is odd) and  $r_{p,n}^\pm$  satisfy*

$$r_{p,n}^\pm = \pi^2 \frac{n^2}{4} + q_0 \pm |\tilde{q}_{cn}| + o(n^{-1}) \quad \text{as} \quad n \rightarrow \infty, \quad \tilde{q}_{cn} = \int_0^1 q(t) \cos \pi n t dt. \quad (4.20)$$

*vi) If  $\frac{N}{3} \notin \mathbb{Z}$ , then each gap  $G_{2n+1} \neq \emptyset, n \geq 0$  and  $|G_{2n+1}| \rightarrow \infty$  as  $n \rightarrow \infty$ .*

*vii) The operator  $H$  has only a finite number of non degenerate gaps  $G_n$  iff  $\frac{N}{3} \in \mathbb{Z}$  and  $q$  is an even finite gap potential for the operator  $-y'' + qy$  on the real line.*

**Proof.** The case  $N$  odd was proved in [KL]. The proof for the even  $N$  is similar. ■

Note that in the matrix case (see [BBK]) the resonances in general have non-zero imaginary part. That all resonances are real is a peculiarity of the high symmetry of a zigzag periodic graph.

Below we need following results from [KL].

**Lemma 4.4.** *Let  $c \in [-\frac{5}{4}, 1]$ . Then Eq.  $F(\lambda) = c, \lambda \in \mathbb{C}$  has only real zeros, which satisfy*

*i) If  $c \in (-\frac{5}{4}, 1)$ . Then these zeros  $z_n^\pm$  are given by*

$$z_0^+ < z_1^- < z_1^+ < z_2^- < \dots \quad \text{and} \quad \sqrt{z_n^\pm} = u_n^\pm + \frac{q_0}{2u_n^\pm} + \frac{o(1)}{n^2}, \quad \text{as} \quad n \rightarrow \infty. \quad (4.21)$$

where  $u_n^\pm = \pi n \pm u_0^+, n \geq 1$  and  $u_0^+ = \frac{\arccos \frac{1+8c}{9}}{2} \in [0, \frac{\pi}{2}], u_0^+ < u_1^- < u_1^+ < u_2^- < \dots$

Moreover, the zeros  $z_n^\pm$  have another representation given by:  $x_n^- = z_{n+1}^+, x_n^+ = z_n^-$ , and

$$x_1^- < x_1^+ < x_2^- < x_2^+ < x_3^- < \dots \quad \sqrt{x_n^\pm} = v_n^\pm + \frac{q_0}{2v_n^\pm} + \frac{o(1)}{n^2} \quad \text{as} \quad n \rightarrow \infty, \quad (4.22)$$

where  $v_n^\pm = \pi(n - \frac{1}{2}) \pm (\frac{\pi}{2} - u_0^+)$ .

*ii) If  $c = 1$ . Then these zeros  $z_n^\pm$  are given by*

$$z_0^+ < z_1^- \leq z_1^+ < z_2^- \leq z_2^+ < \dots \quad \text{and} \quad \sqrt{z_n^\pm} = \pi n + \frac{q_0}{2\pi n} + \frac{o(1)}{n^2}, \quad \text{as} \quad n \rightarrow \infty. \quad (4.23)$$

*iii) If  $c = -\frac{5}{4}$ . Then these zeros  $x_n^\pm$  are given by*

$$x_1^- \leq x_1^+ < x_2^- \leq x_2^+ < \dots \quad \text{and} \quad \sqrt{x_n^\pm} = \pi(n - \frac{1}{2}) + \frac{q_0}{2\pi n} + \frac{o(1)}{n^2}, \quad \text{as} \quad n \rightarrow \infty. \quad (4.24)$$

## 5 Lyapunov functions, Proof of Theorem 1.4-1.7

We recall that  $\vartheta(x, \lambda)$ ,  $\varphi(x, \lambda)$ ,  $x \in \mathbb{R}$  are the fundamental solutions of Eq.  $-y'' + qy = \lambda y$ ,  $\lambda \in \mathbb{C}$ , on the real line such that  $\vartheta(0, \lambda) = \varphi'(0, \lambda) = 1$ ,  $\vartheta'(0, \lambda) = \varphi(0, \lambda) = 1$ . For each  $x \in \mathbb{R}$  the functions  $\vartheta, \vartheta', \varphi, \varphi'$  are entire in  $\lambda \in \mathbb{C}$ . Moreover, the following asymptotics are fulfilled:

$$\vartheta(x, \lambda) = \cos \sqrt{\lambda}x + O\left(\frac{e^{|\operatorname{Im} \sqrt{\lambda}|x}}{\sqrt{\lambda}}\right), \quad \varphi(x, \lambda) = \frac{\sin \sqrt{\lambda}x}{\sqrt{\lambda}} + O\left(\frac{e^{|\operatorname{Im} \sqrt{\lambda}|x}}{|\lambda|}\right),$$

$$\Delta(\lambda) = \cos \sqrt{\lambda} + \frac{q_0 \sin \sqrt{\lambda}}{2\sqrt{\lambda}} + O\left(\frac{e^{|\operatorname{Im} \sqrt{\lambda}|}}{|\lambda|}\right), \quad q_0 = \frac{1}{2} \int_0^1 q(t)dt, \quad (5.1)$$

as  $|\lambda| \rightarrow \infty$ , uniformly on bounded sets of  $(x; q) \in [0, 1] \times L_C^2(0, 1)$  (see [PT]).

A great number of papers is devoted to the inverse spectral theory and a priori estimates for the Hill operator: [M], [GT],[KK], [Ko] etc. We recall some needed below results about the Hill operator from [M],... The sequence  $\lambda_0^+ < \lambda_1^- \leq \lambda_1^+ < \dots$  is the spectrum of equation  $-y'' + qy$  with periodic boundary conditions of period 2, that is  $f(x+2) = f(x)$ ,  $x \in \mathbb{R}$ . Here equality means that  $\lambda_n^- = \lambda_n^+$  is an eigenvalue of multiplicity 2. Note that  $\Delta(\lambda_n^\pm) = (-1)^n$ ,  $n \geq 1$ . The lowest eigenvalue  $\lambda_0^+$  is simple,  $\Delta(\lambda_0^+) = 1$ , and the corresponding eigenfunction has period 1. The eigenfunctions corresponding to  $\lambda_n^\pm$  have period 1 if  $n$  is even, and they are anti-periodic, that is  $f(x+1) = -f(x)$ ,  $x \in \mathbb{R}$ , if  $n$  is odd. The derivative of the Lyapunov function has a zero  $\lambda_n$  in the "closed gap"  $[\lambda_n^-, \lambda_n^+]$ , that is  $\Delta'(\lambda_n) = 0$ . Recall that  $\mu_n$  and  $\nu_n$  are the Dirichlet and Neumann eigenvalues. It is well-known that  $\mu_n, \nu_n \in [\lambda_n^-, \lambda_n^+]$  and  $\nu_0 \leq 0$ . Moreover, a potential  $q$  is even, i.e.,  $e \in L_{even}^2(0, 1)$  iff  $|\gamma_n| = |\mu_n - \nu_n|$  for all  $n \geq 1$  (see [GT] or [KK] or [Ko]).

Similarly to the case of periodic Schrödinger operators on  $\mathbb{R}$ , we determine the spectrum of  $H$  in terms of the Lyapunov function  $F_k = T_k + \sqrt{R_k}$ .

**Proof of Theorem 1.4.** i) Fix a eigenvalue  $\tau_k$  of  $\mathcal{M}_k$ . Due to (1.17),(1.18) the characteristic equation for  $\mathcal{M}_k$  has the form  $\det(\mathcal{M}_k - \tau I_2) = \tau^2 - \operatorname{Tr} \mathcal{M}_k \tau + s^{-k} = 0$ . Then eigenvalues  $\tau_k^\pm$  of  $\mathcal{M}_k$  are given by

$$\tau_k^\pm = s^{-\frac{k}{2}}(w_k \pm i\sqrt{1-w_k^2}), \quad w_k = \frac{F + s_k^2}{c_k} = \frac{s^{\frac{k}{2}}}{2} \operatorname{Tr} \mathcal{M}_k. \quad (5.2)$$

Each eigenvalue  $\tau_k^\pm$  defines the Lyapunov function  $F_k^\pm$  by  $F_k^\pm = \frac{1}{2} \left( \tau_k^\pm + \frac{1}{\tau_k^\pm} \right)$ . Due to  $\tau_k^+ \tau_k^- = s^{-k}$ , we obtain

$$\begin{aligned} F_k^\pm &= \frac{\tau_k^\pm + s^k \tau_k^\mp}{2} = \frac{1}{2} \left( \frac{w_k \pm i\sqrt{1-w_k^2}}{s^{\frac{k}{2}}} + (w_k \mp i\sqrt{1-w_k^2}) s^{\frac{k}{2}} \right) \\ &= \frac{s^{\frac{k}{2}} + s^{-\frac{k}{2}}}{2} w_k \pm i \frac{s^{-\frac{k}{2}} - s^{\frac{k}{2}}}{2} \sqrt{1-w_k^2} = c_{0k} w_k \pm s_{0k} \sqrt{1-w_k^2}, \end{aligned} \quad (5.3)$$

where  $s_{0k} = \sin \frac{k\pi}{N}$ ,  $c_{0k} = \cos \frac{k\pi}{N}$ . Finally,

$$F_k^\pm = T_k \pm \sqrt{R_k}, \quad T_k = \frac{c_{0k}}{c_k}(F + s_k^2), \quad R_k = s_{0k}^2 \left(1 - w_k^2\right) = \frac{s_{0k}^2}{c_k^2} \left(c_k^2 - (F + s_k^2)^2\right).$$

ii) The standard arguments (see [Ca1] and Teorem 6.1) yield  $\sigma_{sc}(H_k) = \emptyset$  and  $\sigma_{ac}(H_k) = \{\lambda \in \mathbb{R} : F_k(\lambda) \in [-1, 1]\}$ .

iii) Let  $F_k'(\lambda_0) = 0$  and  $F_k(\lambda_0) \in (-1, 1)$  for some  $\lambda_0 \in \sigma_k, k = 0, \dots, N$ . Then we have the Tailor series  $F_k(\lambda) = F_k(\lambda_0) + t^p \frac{F_k^{(p)}(\lambda_0)}{p!} + O(t^{p+1})$ , as  $t = \lambda - \lambda_0 \rightarrow 0$ , where  $F_k^{(p)}(\lambda_0) \neq 0$  for some  $p \geq 1$ . By the Implicit Function Theorem, there exists some curve  $Y \subset \{\lambda : |\lambda - \lambda_0| < \varepsilon\} \cap \mathbb{C}_+, Y \neq \emptyset$ , for some  $\varepsilon > 0$  such that  $F_k(\lambda) \in (-1, 1)$  for any  $\lambda \in Y$ . Thus we have a contradiction with (1.25). ■

**Proof of Theorem 1.5.** Recall the identities

$$F_0 = \frac{1}{2} \text{Tr } \mathcal{M}_0 = \frac{F + s_0^2}{c_0}, \quad F = 2\Delta^2 + \frac{\varphi(1, \cdot)\vartheta'(1, \cdot)}{4} - 1 = \frac{9\Delta^2 - \Delta_-^2 - 5}{4}, \quad (5.4)$$

where  $\Delta_- = \frac{1}{2}(\varphi'(1, \cdot) - \vartheta(1, \cdot))$ . Recall that we consider the case:  $a \in (0, \frac{\pi}{2})$

i) The results of i) follow from (5.4) and Theorem 4.2.

ii) We determine the equation for periodic eigenvalues for the case  $c_k >$  and  $a \in (0, \frac{\pi}{2})$ . We have

$$F_0(\lambda) = \pm 1 \Leftrightarrow F(\lambda) = \pm c_0 - s_0^2,$$

where  $c_0 - s_0^2 \in (-1, 1)$ ,  $-c_0 - s_0^2 \in [-\frac{5}{4}, -1)$ . Then the properties of  $F$  from Theorem 4.2 give that all even gaps  $\gamma_{0,2n}(a) = (\lambda_{0,2n}^-(a), \lambda_{0,2n}^+(a))$  are open and satisfy  $\gamma_{0,2n}(a) \subset \gamma_{0,2n}(a_1)$ ,  $a < a_1 < \frac{\pi}{2}$ .

Consider the odd gaps  $\gamma_{0,m}(a) = (\lambda_{0,m}^-(a), \lambda_{0,m}^+(a))$ ,  $m = 2n - 1$ . Then the properties of  $F$  from Theorem 4.2 give

$$\gamma_{0,m}(a) \supset \gamma_{0,m}(a_1), \quad 0 \leq a < a_1 < \frac{\pi}{3}, \quad \text{and} \quad \gamma_{0,m}(a) \subset \gamma_{0,m}(a_1), \quad \frac{\pi}{3} \leq a < a_1 < \frac{\pi}{2}.$$

If  $a = \frac{\pi}{3}$ , then  $c_0 + s_0^2 = \frac{5}{4}$  and the properties of  $F$  from Theorem 4.2 give that  $|\gamma_{0,m}(a)| \geq 0$ . Moreover, if in addition,  $q \in L_{even}^2(0, 1)$ , then all odd  $\gamma_{0,m}(a) = \emptyset, m \geq 1$ .

iii) Repeating the standard arguments (see [KL]) we determine asymptotics (1.31).

iv) Consider the case:  $c_0 \downarrow 0$  or  $a \uparrow \frac{\pi}{2}$ . The spectral bands are defined by

$$\sigma_{0,n}(a) = (\lambda_{0,n-1}^+(a), \lambda_{0,n}^-(a)), \quad F(\lambda_{0,2n}^\pm) = c_0 - s_0^2, \quad F(\lambda_{0,2n-1}^\pm) = -c_0 - s_0^2.$$

Using  $F(\tilde{\lambda}_n) = -1$  we obtain

$$F(\lambda_{0,n}^-(a)) - F(\tilde{\lambda}_n) = c_0 - s_0^2 + 1 = c_0(1 - c_0) \rightarrow 0,$$

and  $F'(\tilde{\lambda}_n) \neq 0$  yields  $\lambda_{0,n}^-(a) = \tilde{\lambda}_n + \frac{c_0 + O(c_0^2)}{F'(\tilde{\lambda}_n)}$  as  $a \uparrow \frac{\pi}{2}$ . Similar arguments give  $\lambda_{0,n-1}^- = \tilde{\lambda}_{0,2n+1}^- + c_0(1 + O(c_0))/F'(\tilde{\lambda}_n)$  as  $a \uparrow \frac{\pi}{2}$ . Thus we have (1.35). ■



We consider the Lyapunov function  $F_k, k \neq N$ .

**Proof of Theorem 1.6.** Recall

$$F_k^\pm = T_k \pm \sqrt{R_k}, \quad T_k = \frac{c_{0k}}{c_k}(F + s_k^2) \quad R_k = \frac{s_{0k}^2}{c_k^2} \left( c_k^2 - (F + s_k^2)^2 \right), \quad k \in \overline{N-1},$$

where  $c_{0k} = \cos \frac{\pi k}{N}, s_{0k} = \sin \frac{\pi k}{N}$ . For the case  $c_k \neq 0$  these definitions yield :

$$T_k(\lambda, a + \pi) = -T_k(\lambda, a), \quad R_k(\lambda, a + \pi) = R_k(\lambda, a), \quad \lambda \in \mathbb{C}. \quad (5.5)$$

ii) We determine the equation for resonances for the case  $k \in \overline{N-1}$ . If  $R_k(\lambda) < 0$ , then  $F_k(\lambda)$  is not real and then  $\lambda \notin \sigma(H_k)$ . We have

$$R_k < 0 \quad \Leftrightarrow \quad c_k^2 < (F + s_k^2)^2 \quad \Leftrightarrow \quad F + s_k^2 > |c_k| \quad \text{or} \quad F + s_k^2 < -|c_k|. \quad (5.6)$$

Consider the first case:  $n$  is **even**, i.e.,  $r_{k,2n}^\pm, n \in \mathbb{Z}$ . We have

$$F + s_k^2 > |c_k| \quad \Leftrightarrow \quad F > f_k^+ = |c_k| - s_k^2 \in [-1, 1], \quad k \in \overline{N-1}. \quad (5.7)$$

The resonances  $r_{k,n}^\pm$  are zeros of Eq.  $F(\lambda) = f_k^+ \in [-1, 1], \lambda \in \mathbb{C}$ . Lemma 4.4 gives that all these resonances are real and labeling is given by (1.40)-(1.42) and  $r_{k,n}^\pm$  satisfy asymptotics (1.31).

Consider the second case: the **odd** gaps  $\gamma_{k,n} = (r_{k,n}^-, r_{k,n}^+)$ , i.e.,  $n \in \mathbb{Z}$  is odd. We have

$$F + s_k^2 < -|c_k| \quad \Leftrightarrow \quad F < f_k^- = -|c_k| - s_k^2 \in \left[-\frac{5}{4}, -1\right), \quad k \in \overline{N-1}. \quad (5.8)$$

The resonances  $r_{k,n}^\pm$  are zeros of Eq.  $F(\lambda) = f_k^- \in \left[-\frac{5}{4}, -1\right), \lambda \in \mathbb{C}$ . Lemma 4.4 gives that all these resonances are real and labeling is given by (1.40)-(1.42) and  $r_{k,n}^\pm$  satisfy asymptotics (1.31). In order to prove (1.45) below we will show that if  $R_k(\lambda) \geq 0$ , then  $F_k(\lambda) \in [-1, 1]$ .

iii) Using (1.17),(1.18), we obtain the equation for periodic (anti-periodic) eigenvalues

$$0 = \det(\mathcal{M}_k \mp I_2) = 1 \mp \text{Tr } M_k + s^{-k} = 1 + s^{-k} \mp 2 \frac{F + s_k^2}{s^{\frac{k}{2}} c_k} = 2s^{-\frac{k}{2}} \left( c_{0k} \mp \frac{(F + s_k^2)}{c_k} \right),$$

which yields the equations

$$F(\lambda_n^\pm) = c_{0k} c_k - s_k^2 \in \left(-\frac{5}{4}, 1\right) \quad \text{for periodic eigenvalues } \lambda_n^\pm, n \geq 0, \quad (5.9)$$

$$F(\mu_n^\pm) = -c_{0k} c_k - s_k^2 \in \left(-\frac{5}{4}, 1\right) \quad \text{for anti - periodic eigenvalues } \mu_n^\pm, n \geq 0. \quad (5.10)$$

These equations and Lemma 4.4 give that all these eigenvalues are real and labeling is given by (1.36)-(1.38) and they satisfy asymptotics (1.31). Note that  $\lambda_n^\pm, \mu_n^\pm$  are simple since  $F'(\lambda_n^\pm) \neq 0, F'(\mu_n^\pm) \neq 0$ , see Theorem 4.2.

We will show  $\mu_n^\pm, \lambda_n^\pm \in \sigma_{k,n}$  and (1.45). Recall

$$F_k = c_{0k}w_k + s_{0k}\sqrt{1-w_k^2}, \quad w_k = \frac{F+s_k^2}{c_k}, \quad w_k(\lambda_n^\pm) = c_{0k}, \quad w_k(\mu_n^\pm) = -c_{0k}. \quad (5.11)$$

Then at  $\lambda = \lambda_n^\pm$  we get

$$F'_k(\lambda) = w'_k(\lambda) \left( c_{0k} - s_{0k} \frac{w_k(\lambda)}{\sqrt{1-w_k^2(\lambda)}} \right) = 0, \quad F''_k(\lambda) \neq 0. \quad (5.12)$$

and similar arguments yield  $F'_k(\mu_n^\pm) = 0, F''_k(\mu_n^\pm) \neq 0$ . This shows that there are no classical gaps,  $\mu_n^\pm, \lambda_n^\pm \in \sigma_{k,n}$  and there exist only resonance gaps. Thus we obtain (1.45).

i) Using (5.6) we obtain  $s(H_k(a)) = \{\lambda \in \mathbb{R} : (F(\lambda) + s_k^2)^2 \leq c_k^2\} \cup \sigma_D$ ,  $k \in \mathbb{Z}_N$ . and  $\sigma(H_k(a + \frac{\pi}{N})) = \sigma(H_{k+1}(a)) \cup \sigma_D$ ,  $(k, a) \in \mathbb{Z}_N \times \mathbb{R}$ , which yields (1.44).

iv) The proof of the case  $\sigma_{k,n} \rightarrow \tilde{\sigma}_n$  as  $a \rightarrow a_{k,m}$  repeats the case  $\sigma_{0,n} \rightarrow \tilde{\sigma}_n$  as  $a \uparrow \frac{\pi}{2}$ , see the proof of Theorem 1.5. ■

**Proof of Theorem 1.7.** i) Using (1.44) we get (1.49).

ii) Consider the case  $a \in (0, \frac{\pi}{N})$  and the gaps  $G_n$  for even  $n$ . Recall that for  $\lambda \in \gamma_{k,n}$  we have obtained in the proof of Theorem 1.6

$$F(\lambda) + s_k^2 > |c_k| \quad \Leftrightarrow \quad F(\lambda) > f_k^+ = |c_k| - s_k^2 \in [-1, 1], \quad k \in \overline{N-1}. \quad (5.13)$$

The resonances  $r_{k,n}^\pm$  are zeros of Eq.  $F(\lambda) = f_k^+ \in [-1, 1], \lambda \in \mathbb{C}$ . Then we deduce that

$$1 > f_0^+ > f_1^+ > f_2^+ > \dots > f_{p_0}^+, \quad 1 > f_{N-1}^+ > f_{N-2}^+ > \dots > f_{p_0-1}^+,$$

where  $\frac{\pi}{2} - a - \frac{\pi p_0}{N} \in (0, 1)$  for some integer  $p_0 \geq 0$ , which yields for  $n = 0$

$$\lambda_{0,0}^+ < r_{1,0}^+ < r_{2,0}^+ < \dots < r_{p_0,0}^+, \quad r_{N-1,0}^+ < r_{N-2,0}^+ < \dots < r_{p_0-1,0}^+,$$

for  $n \geq 2$

$$r_{p_0,n}^- < r_{p_0-2,n}^- < \dots < r_{1,n}^- < \lambda_{0,n}^- < \lambda_{0,n}^+ < r_{1,n}^+ < r_{2,n}^+ < \dots < r_{p_0,n}^+,$$

$$r_{p_0+1,n}^- < r_{p_0+2,n}^- < \dots < r_{N-1,n}^- < r_{N-1,n}^+ < r_{N-2,n}^+ < \dots < r_{p_0+1,n}^+,$$

and

$$\gamma_{0,n} \subset \gamma_{1,n} \subset \dots \subset \gamma_{p_0-1,n} \subset \gamma_{p_0,n}, \quad \gamma_{N-1,n} \subset \dots \subset \gamma_{p_0+2,n} \subset \gamma_{p_0+1,n}, \quad (5.14)$$

$$G_n = \gamma_{N-1,n} \cap \gamma_{0,n}. \quad (5.15)$$

Due to (5.15) the even gaps are associated with  $f_0^+ \approx 1$  and  $f_{N-1}^+ \approx 1$  and in these two cases (5.15) gives

$$f_0^+ = \cos a - \sin^2 a < 1, \quad f_{N-1}^+ = \cos(a - \frac{\pi}{N}) - \sin^2(a - \frac{\pi}{N}) < 1. \quad (5.16)$$

Thus the even gaps  $G_n(a) = (E_n^-(a), E_n^+(a))$  are determined by

$$F(E_n^\pm(a)) = \cos a_+ - \sin^2 a_+ < 1, \quad a_+ = \max\{a, \frac{\pi}{N} - a\} \in (0, \frac{\pi}{N}).$$

Thus Lemma 4.4 yields  $G_n(a) \neq \emptyset$  and (1.52), in particular,  $|G_n| \rightarrow \infty$  as  $n \rightarrow \infty$ .

iii) We consider the case of **odd** gaps  $\gamma_{k,n} = (r_{k,n}^-, r_{k,n}^+)$ , i.e.,  $n \in \mathbb{Z}$  is odd. For  $\lambda \in \gamma_{k,n}$  we have

$$F(\lambda) + s_k^2 < -|c_k| \quad \Leftrightarrow \quad F(\lambda) < f_k^- = -|c_k| - s_k^2 \in (-\frac{5}{4}, -1), \quad k \in \overline{N-1}. \quad (5.17)$$

From Theorem 1.6 we deduce that these resonances (i.e., the zeros of  $R_k$ ) are zeros of Eq.  $F(\lambda) = f_k^- \in [-\frac{5}{4}, -1], \lambda \in \mathbb{C}$ . Moreover, by Theorem 1.4, they are real and simple. We get

$$\lambda_{0,n}^- < r_{1,n}^- < r_{2,n}^- < \dots < r_{p_1,n}^- < r_{p_1,n}^+ < r_{p_1-1,n}^+ < \dots < r_{1,n}^+ < \lambda_{0,n}^+, \quad (5.18)$$

$$r_{p_0,n}^- < r_{p_0-1,n}^- < \dots < r_{p_1+2,n}^- < r_{p_1+1,n}^- < r_{p_1+1,n}^+ < r_{p_1+2,n}^+ < \dots < r_{p_0-1,n}^+ < r_{p_0,n}^+, \quad (5.19)$$

and

$$r_{p_0+1,n}^- < r_{p_0+2,n}^- < \dots < r_{p_2,n}^- < r_{p_2,n}^+ < r_{p_2-1,n}^+ < \dots < r_{p_0+1,n}^+, \quad (5.20)$$

$$r_{N-1,n}^- < r_{N-2,n}^- < \dots < r_{p_2+1,n}^- < r_{p_2+1,n}^+ < r_{p_2+2,n}^+ < \dots < r_{N-2,n}^+ < r_{N-1,n}^+, \quad (5.21)$$

where  $\frac{j\pi}{3} - a - \frac{\pi p_j}{N} \in (0, 1), j = 1, 2$  for some integer  $p_j \geq 0$ . Thus we obtain

$$\gamma_{p_1,n} \subset \gamma_{p_1-1,n} \subset \dots \subset \gamma_{1,n} \subset \gamma_{0,n}, \quad \gamma_{p_1+1,n} \subset \gamma_{p_1+2,n} \subset \dots \subset \gamma_{p_0-1,n} \subset \gamma_{p_0,n}, \quad (5.22)$$

$$\gamma_{p_2,n} \subset \gamma_{p_2+1,n} \subset \dots \subset \gamma_{p_0+2,n} \subset \gamma_{p_0,n}, \quad \gamma_{p_2+1,n} \subset \gamma_{p_2+2,n} \subset \dots \subset \gamma_{N-2,n} \subset \gamma_{N-1,n}, \quad (5.23)$$

$$G_n = \gamma_{p_1,n} \cap \gamma_{p_1+1,n} \cap \gamma_{p_2,n} \cap \gamma_{p_2+1,n}. \quad (5.24)$$

Then we obtain the odd gaps by  $G_n(a) = (E_n^-(a), E_n^+(a))$ , where  $E_n^\pm(a)$  are determined by

$$F(E_n^\pm(a)) = \min\{f_{p_1}^-, f_{p_1+1}^-, f_{p_2}^-, f_{p_2+1}^-\}, \quad f_k^- = -|c_k| - s_k^2. \quad (5.25)$$

We will specify (5.25).

A) If  $p_1 = \frac{N}{3} - 1 \in \mathbb{Z}$ , then we get  $p_2 = 2p_1 + 1$  and

$$a + \frac{\pi p_1}{N} = \frac{\pi}{3} - \varepsilon_1, \quad \varepsilon_1 = \frac{\pi}{N} - a \in (0, \frac{\pi}{N}) \quad a + \frac{\pi p_2}{N} = \frac{2\pi}{3} - \varepsilon_1,$$

and

$$c_{p_1} = \cos(\frac{\pi}{3} - \varepsilon_1) \neq \frac{1}{2}, \quad c_{p_1+1} = \cos(\frac{\pi}{3} - \varepsilon_1 + \frac{\pi}{N}) \neq \frac{1}{2}, \quad (5.26)$$

$$c_{p_2} = \cos\left(\frac{2\pi}{3} - \varepsilon_1\right) \neq -\frac{1}{2}, \quad c_{p_2+1} = \cos\left(\frac{2\pi}{3} - \varepsilon_1 + \frac{\pi}{N}\right) \neq -\frac{1}{2}. \quad (5.27)$$

Then due to (5.25) and Lemma 4.4 all odd gaps are open  $|G_n| > 0$  and  $|G_n| \rightarrow \infty$  as  $n \rightarrow \infty$ .

B) If  $p_2 = \frac{2N}{3} - 1 \in \mathbb{Z}$ ,  $\frac{N}{3} \notin \mathbb{Z}$ , then  $p_2$  is even and we get  $p_1 = p_2/2 = \frac{N}{3} - \frac{1}{2}$  and

$$a + \frac{\pi p_2}{N} = \frac{2\pi}{3} - \varepsilon_1, \quad a + \frac{\pi p_1}{N} = \frac{\pi}{3} + \left(a - \frac{\pi}{2N}\right)$$

which give

$$c_{p_1} = \cos\left(\frac{\pi}{3} + \left(a - \frac{\pi}{2N}\right)\right) \approx \frac{1}{2}, \quad c_{p_1+1} = \cos\left(\frac{\pi}{3} + \left(a + \frac{\pi}{2N}\right)\right) \neq \frac{1}{2}, \quad (5.28)$$

$$c_{p_2} = \cos\left(\frac{2\pi}{3} - \varepsilon_1\right) \neq -\frac{1}{2}, \quad c_{p_2+1} = \cos\left(\frac{2\pi}{3} - \varepsilon_1 + \frac{\pi}{N}\right) \neq -\frac{1}{2}. \quad (5.29)$$

Then due to (5.25) and Lemma 4.4 we obtain:

if  $a = \frac{\pi}{2N}$ , then all odd gaps are  $|G_n| \geq 0$  and  $|G_n| \rightarrow 0$  as  $n \rightarrow \infty$ .

If  $a \neq \frac{\pi}{2N}$ , then all odd gaps are open  $|G_n| > 0$  and  $|G_n| \rightarrow \infty$  as  $n \rightarrow \infty$ .

C) Let  $\frac{2N}{3} \notin \mathbb{Z}$ . Let  $\frac{jN}{3} = k_j + \tilde{k}_j$ ,  $\tilde{k}_j \in (0, 1)$ ,  $k_j \in \mathbb{Z}$ ,  $j = 1, 2$ . We have

$$a + \frac{\pi k_j}{N} = \frac{j\pi}{3} + w_j, \quad w_j \equiv a - \frac{\pi \tilde{k}_j}{N} \in \left(-\frac{\pi}{N}, \frac{\pi}{N}\right),$$

which give

$$c_{k_j} = \cos\left(\frac{j\pi}{3} + w_j\right), \quad c_{k_j \pm 1} = \cos\left(\frac{j\pi}{3} + w_j \pm \frac{\pi}{N}\right) \neq -(-1)^j \frac{1}{2}. \quad (5.30)$$

If  $a \in \tilde{A} = \left\{\frac{\pi \tilde{k}_1}{N}, \frac{\pi \tilde{k}_2}{N}\right\}$ , then  $c_{k_1} = \frac{1}{2}$ , or  $c_{k_2} = -\frac{1}{2}$ . Thus we obtain the odd gaps  $G_n(a) = (E_n^-(a), E_n^+(a))$ , where  $E_m^\pm(a)$  are determined by

$$F(E_m^\pm(a)) = \min\{f_{p_1}, f_{p_1-1}, f_{p_2}, f_{p_2-1}\} = -\frac{5}{4},$$

and by Lemma 4.4,  $|G_n| \geq 0$  and  $|G_n| \rightarrow 0$  as  $n \rightarrow \infty$ .

If  $a \notin \tilde{A}$ , then we obtain the odd gaps  $G_n(a) = (E_n^-(a), E_n^+(a))$ , where  $E_m^\pm(a)$  are determined by (5.25):

$$F(E_m^\pm(a)) = \min\{f_{p_1}, f_{p_1-1}, f_{p_2}, f_{p_2-1}\} > -\frac{5}{4},$$

Thus by Lemma 4.4,  $|G_n| > 0$  and  $|G_n| \rightarrow \infty$  as  $n \rightarrow \infty$ .

iv) In our case  $c_k \neq 0$  for all  $k = 1, \dots, N$ . Then each spectral band  $\sigma_{k,n} \neq \emptyset$  for  $H_k(a)$  and due to (5.18)-(5.21), (5.22)-(5.24) we have (1.53).

v) Let  $a_m = \frac{\pi}{2} - \frac{\pi m}{N} \in [0, \frac{\pi}{N}]$  for some  $k = m \in \overline{N}$ ,  $N \geq 1$ . Then  $c_m = 0$  and in this case by Theorem 1.3, instead of  $\sigma_{m,n}$  we have a flat band  $\tilde{\sigma}_n\{\tilde{\lambda}_n\}$ . All other spectral bands  $\sigma_{k,n} \neq \emptyset$  for  $k \neq m$  and due to (5.18)-(5.21), (5.22)-(5.24) we have (1.54).

Using Theorem 1.6 iii), we obtain (1.55). ■

## 6 Appendix: the direct integral

We shortly recall the well known results about the properties of point spectrum and the absence of singular continuous spectrum (see [GN]).

**Theorem 6.1.** *For each  $(k, a) \in \overline{N} \times \mathbb{R}$  the following identities hold:*

$$\sigma(H_k) = \sigma_{ac}(H_k) \cup \sigma_\infty(H_k), \quad (6.1)$$

where the set  $\sigma_\infty(H_k)$  is discrete and does not have accumulation points,

$$\sigma(H_k) = \sigma_\infty(H_k), \quad \text{if } c_k = 0, \quad (6.2)$$

$$\sigma_{ac}(H_k) = \left\{ \lambda \in \mathbb{R} : \frac{F(\lambda) + s_k^2}{c_k} \in [-1, 1] \right\}, \quad \text{if } c_k \neq 0. \quad (6.3)$$

**Proof.** Recall that for  $N = 1$  the fundamental subgraph  $\Gamma_0$  is given by

$$\Gamma_0 = \bigcup_{j=0}^2 \Gamma_{0,j,1}, \quad \Gamma_\omega = \{r = r_\omega^0 + te_\omega, t \in [0, 1]\}, \quad r_\omega^0, r_\omega^1 = r_\omega^0 + e_\omega \in \mathbb{R}^3, \quad |e_\omega| = 1,$$

where  $\Gamma_{0,0} = \Gamma_{0,0,1}$  is a "vertical" edge;  $\Gamma_{0,1} = \Gamma_{0,1,1}$  and  $\Gamma_{0,2} = \Gamma_{0,2,1}$  are edges with positive and negative projections on the vector  $(0, 0, 1) \in \mathbb{R}^3$ , see Fig. 1. We have  $\Gamma^{(1)} = \bigcup_{n \in \mathbb{Z}} \Gamma_n$ , where  $\Gamma_n = \bigcup_{j=0}^2 \Gamma_{n,j}$ . A function  $f(x), x \in \Gamma^{(1)}$  has the form  $f(x) = f_n(s)$  for  $x, s \in \Gamma_n$ . We identify  $f_n$  on  $\Gamma_n$  with a function on  $\Gamma_0$  by using the local coordinate  $x = r_\omega + te_\omega, t \in [0, 1]$  and (1.11).

Define the space  $\mathfrak{H} = \int_{[0, 2\pi)} \oplus \mathfrak{H}_p \frac{dp}{2\pi}$ , where  $\mathfrak{H}_p = L^2(\Gamma_0)$ . Introduce the unitary operator  $U : L^2(\Gamma^{(1)}) \rightarrow \mathfrak{H}$  and the operator  $A_k$  by

$$(Uf)(p) = \sum_{n \in \mathbb{Z}} e^{inp} f_n, \quad f_n = (f_{n,j})_{(n,j) \in \mathbb{Z} \times \mathbb{Z}_n} \in L^2(\Gamma_0), \quad p \in [0, 2\pi),$$

$$A_k = UH_kU^{-1} = \int_{[0, 2\pi)} \oplus A_k(p) \frac{dp}{2\pi},$$

where an operator  $A_k(p)$  on the graph  $\Gamma_0$  acts in the Hilbert space  $L^2(\Gamma_0) = \sum_{j \in \mathbb{Z}_3} \oplus L^2(\Gamma_{0j})$ . Acting on the edge  $\Gamma_{0j}$ ,  $A_k(p)$  is the ordinary differential operator given by

$$(A_k(p)f)_j(t) = -f_j''(t) + q(t)f_j(t), \quad t \in [0, 1], \quad (6.4)$$

where  $f_j, f_j'' \in L^2(\Gamma_{0j}), j = 0, 1, 2; q \in L^2(0, 1)$  and  $f \in \mathfrak{D}(A_k(p))$  satisfies

**The Kirchhoff Boundary Conditions**

$$f_0(1) = f_1(0) = e^{ia} s^k f_2(1), \quad e^{ip} f_0(0) = e^{ia} f_1(1) = f_2(0), \quad (6.5)$$

$$-f_0'(1) + f_1'(0) - e^{ia} s^k f_2'(1) = 0, \quad e^{ip} f_0'(0) - e^{ia} f_1'(1) + f_2'(0) = 0. \quad (6.6)$$

Remark that (6.5), (6.6) follow from (1.9), (1.10), where we used:  $f_j = f_{0,j}, j = 0, 1, 2$  and  $f_{n+1,0}(0) = e^{ip}f_{n,0}(0), f'_{n+1,0}(0) = e^{ip}f'_{n,0}(0)$ .

Hence  $A_k = \int_{[0,2\pi)} \oplus A_k(p) dp$ , where the operator  $A_k(p)$  acts on the finite graph  $\Gamma_0$  containing only 3 edges. Hence  $A_k(p)$  has a discrete spectrum and denote the increasing sequence of the eigenvalues of  $A_k(p)$  by  $E_{k,n}(p), n \geq 1$ . If for some  $n \geq 1$  the eigenvalue  $E_{k,n}(p) = \text{const}$  for all  $p \in [0, 2\pi]$ , then this  $E_{k,n}(p)$  is an eigenvalue of  $A_k$  of infinite multiplicity. The well-known arguments (see [GN]) give (6.1).

We solve the equation  $A_k(p)f = \lambda f$ . Recall that any solution  $y$  of the equation  $-y'' + qy = \lambda y$  satisfies

$$y(t) = w_t y(0) + \frac{\varphi_t}{\varphi_1} y(1), \quad w_t = \vartheta_t - \frac{\varphi_t}{\varphi_1}, \quad t \in [0, 1]. \quad (6.7)$$

Let  $x = f_0(0), y = f_0(1)$ . Then using (6.5) we obtain

$$f_0(t) = w_t x + \frac{\varphi_t}{\varphi_1} y, \quad f_1(t) = w_t y + \frac{\varphi_t}{\varphi_1} e^{i(p-a)} x, \quad f_2(t) = e^{ip} w_t x + \frac{\varphi_t}{\varphi_1} e^{-ia} s^{-k} y. \quad (6.8)$$

The substitution (6.8) into (6.5) gives

$$-w'_1 x - \frac{\varphi'_1}{\varphi_1} y + w'_0 y + \frac{1}{\varphi_1} e^{i(p-a)} x - e^{ia} s^k (e^{ip} w'_1 x + \frac{\varphi'_1}{\varphi_1} e^{-ia} s^{-k} y) = 0, \quad (6.9)$$

and using  $w'_0 = -\frac{\vartheta_1}{\varphi_1}, w'_1 = -\frac{1}{\varphi_1}$  we get the first Eq.

$$x(1 + e^{i(p-a)} + e^{i(p+a)} s^k) - y(2\Delta + \vartheta_1) = 0. \quad (6.10)$$

We determine the second one. The substitution (6.8) into (6.6) gives

$$e^{ip} (w'_0 x + \frac{1}{\varphi_1} y) - e^{ia} (w'_1 y + \frac{\varphi'_1}{\varphi_1} e^{i(p-a)} x) + (e^{ip} w'_0 x + \frac{1}{\varphi_1} e^{-ia} s^{-k} y) = 0,$$

which yields the second Eq.

$$-x e^{ip} (2\Delta + \vartheta_1) + y (e^{ip} + e^{ia} + e^{-ia} s^{-k}) = 0. \quad (6.11)$$

The corresponding determinant of the systems (6.10), (6.11) has the form

$$Q = (2\Delta + \vartheta_1)(2\Delta + \varphi'_1) - (e^{-ip} + e^{-ia} + e^{ia} s^k)(e^{ip} + e^{ia} + e^{-ia} s^{-k}) = 0.$$

Using the identities

$$(2\Delta + \vartheta_1)(2\Delta + \varphi'_1) = 8\Delta^2 + \vartheta'_1 \varphi_1 + 1, \\ (e^{-ip} + e^{-ia} + e^{ia} s^k)(e^{ip} + e^{ia} + e^{-ia} s^{-k}) = 1 + 4c_k^2 + 4c_k \cos(p + \frac{\pi k}{N}),$$

we obtain

$$Q = F + s_k^2 = c_k \cos(p + \frac{\pi k}{N}), \quad p \in [0, 2\pi). \quad (6.12)$$

Thus if  $c_k = 0$ , then  $Q = 0$ , which yields (6.2). If  $c_k \neq 0$ , then we obtain (6.3).

Note that it is possible to define a modified Lyapunov function  $\tilde{F}_k$  by the identity  $\tilde{F}_k(\lambda, a) = \frac{F(\lambda) + s_k^2}{c_k} = \cos(p + \frac{\pi k}{N}), p \in \mathbb{R}$ . This function is entire. But in this case the periodic eigenvalues are defined by the Eq.  $\frac{F + s_k^2}{c_k} = \cos \frac{\pi k}{N}$ , i.e. at  $p = 2\pi n$ . We assume that we obtain such entire functions only for the zigzag graphs. ■

**Acknowledgments.** Evgeny Korotyaev was partly supported by DFG project BR691/23-1. The various parts of this paper were written at the Mittag-Leffler Institute, Stockholm and in the Erwin Schrödinger Institute for Mathematical Physics, Vienna, the first author is grateful to the Institutes for the hospitality.

## References

- [ARZ] Avron, J. E.; Raveh, A.; Zur, B. Adiabatic quantum transport in multiply connected systems. *Rev. Modern Phys.* 60 (1988), no. 4, 873–915
- [BBK] Badanin, A; Brüning, J; Korotyaev, E. The Lyapunov function for Schrödinger operator with periodic  $2 \times 2$  matrix potential, *J. Funct. Anal.* 234(2006), 106-126
- [BK] Badanin, A; Korotyaev, E. Spectral asymptotics for periodic fourth order operators, *Int. Math. Res. Not.* 45(2005), 2775-2814
- [Ca] Carlson, R. Spectral theory and spectral gaps for periodic Schrödinger operators on product graphs. Special section on quantum graphs. *Waves Random Media* 14 (2004), no. 1, S29–S45
- [Ca1] Carlson, Robert Hill's equation for a homogeneous tree. *Electron. J. Differential Equations* 1997, No. 23, 30 pp. (electronic)
- [CK] D. Chelkak; E. Korotyaev Spectral estimates for Schrödinger operator with periodic matrix potentials on the real line, will be published in *Int. Math. Res. Not.*
- [Ha] Harris P. *Carbon Nanotubes and Related Structures*, Cambridge Univ. Press., Cambridge, 1999
- [GT] Garnett J., Trubowitz E.: Gaps and bands of one dimensional periodic Schrödinger operators. *Comment. Math. Helv.* 59, 258-312 (1984)
- [GN] Gerard, C.; Nier, F. The Mourre theory for analytically fibered operators. *J. Funct. Anal.* 152 (1998), no. 1, 202–219
- [KK] Kargaev P.; Korotyaev E. The inverse problem for the Hill operator, a direct approach. *Invent. Math.* 129, no. 3, 567-593 (1997), 138, no. 1, 227 (1999).
- [Ko] Korotyaev, E. The inverse problem for the Hill operator. I *Internat. Math. Res. Notices*, 3(1997), 113–125
- [KL] Korotyaev, E.; Lobanov, I. Schrödinger operators on zigzag periodic graphs, preprint 2006
- [Ku] P. Kuchment, Graph models for waves in thin structures, *Waves in Random Media*, **12** (2002), R1-R24

- [M] Marchenko V.: Sturm-Liouville operator and applications. Basel: Birkhäuser 1986.
- [Pa] L. Pauling, The diamagnetic anisotropy of aromatic molecules, *Journal of Chemical Physics*, **4** (1936), 673-677.
- [PT] Pöschel P., Trubowitz E.: *Inverse Spectral Theory*. Boston: Academic Press, 1987.
- [ReS] Reed, M., Simon, B.: Methods of Modern Mathematical Physics, Vol.IV, Analysis of operators, Academic Press, New York, 1978
- [ReS1] Reed, M., Simon, B.: Methods of Modern Mathematical Physics, Vol.II, Fourier Analysis, Self-Adjointness, Academic Press, New York, 1975
- [RS] K. Ruedenberg and C. W. Scherr, Free-electron network model for conjugated systems. I. Theory, *The Journal of Chemical Physics*, **21** (1953), 1565-1581.
- [YS] Yakubovich, V., Starzhinskii, V. Linear differential equations with periodic coefficients. 1, 2. Halsted Press [John Wiley & Sons] New York-Toronto, 1975. Vol. 1, Vol. 2